

04-27-12 LETTING ITEM 099

STATE OF ILLINOIS  
DEPARTMENT OF TRANSPORTATION  
DIVISION OF HIGHWAYS

**PROPOSED  
HIGHWAY PLANS**

**VARIOUS ROUTES  
SECTION D5 CRACK & JOINT SEAL 2012-2  
ROUT & SEAL  
VARIOUS COUNTIES**

C-95-042-11

SEE PAGES 3-6 FOR LOCATION MAPS, GROSS & NET LENGTHS OF PROJECT BY LOCATION

|           |         |          |                    |           |
|-----------|---------|----------|--------------------|-----------|
| F.A. RTE. | SECTION | COUNTY   | TOTAL SHEETS       | SHEET NO. |
| VAR.      |         | ILLINOIS | 24                 | 1         |
|           |         |          | CONTRACT NO. 70933 |           |

D-95-042-11  
• D5 CRACK & JOINT SEAL 2012-2

FOR INDEX OF SHEETS, SEE SHEET NO. 2  
FOR SUMMARY OF QUANTITIES, SEE SHEET NO. 8

**CURRENT TRAFFIC DATA**

- LOCATION #1: F.A.I. RTE. 57 / (I-57)  
FROM COLES COUNTY LINE TO 0.3 MI. N. OF U.S. 36  
AVERAGE ADT = 18,300
- LOCATION #2: F.A.I. RTE. 72 / (I-72)  
FROM N.E. OF WHITE HEATH TO MATTIS AVE.  
AVERAGE ADT = 13,300
- LOCATION #3: F.A.P. RTE. 323 / (U.S. 36)  
FROM U.S. 150 AT CHRISMAN TO INDIANA STATE LINE  
AVERAGE ADT = 1,200
- LOCATION #4: F.A.P. RTE. 323 / (U.S. 36)  
FROM IL 49 TO U.S. 150 AT CHRISMAN  
AVERAGE ADT = 1,550

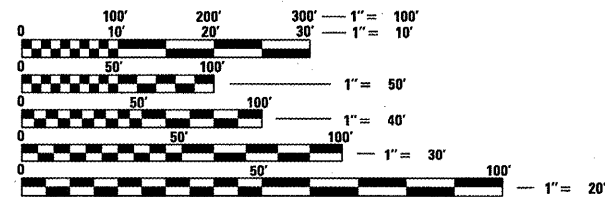
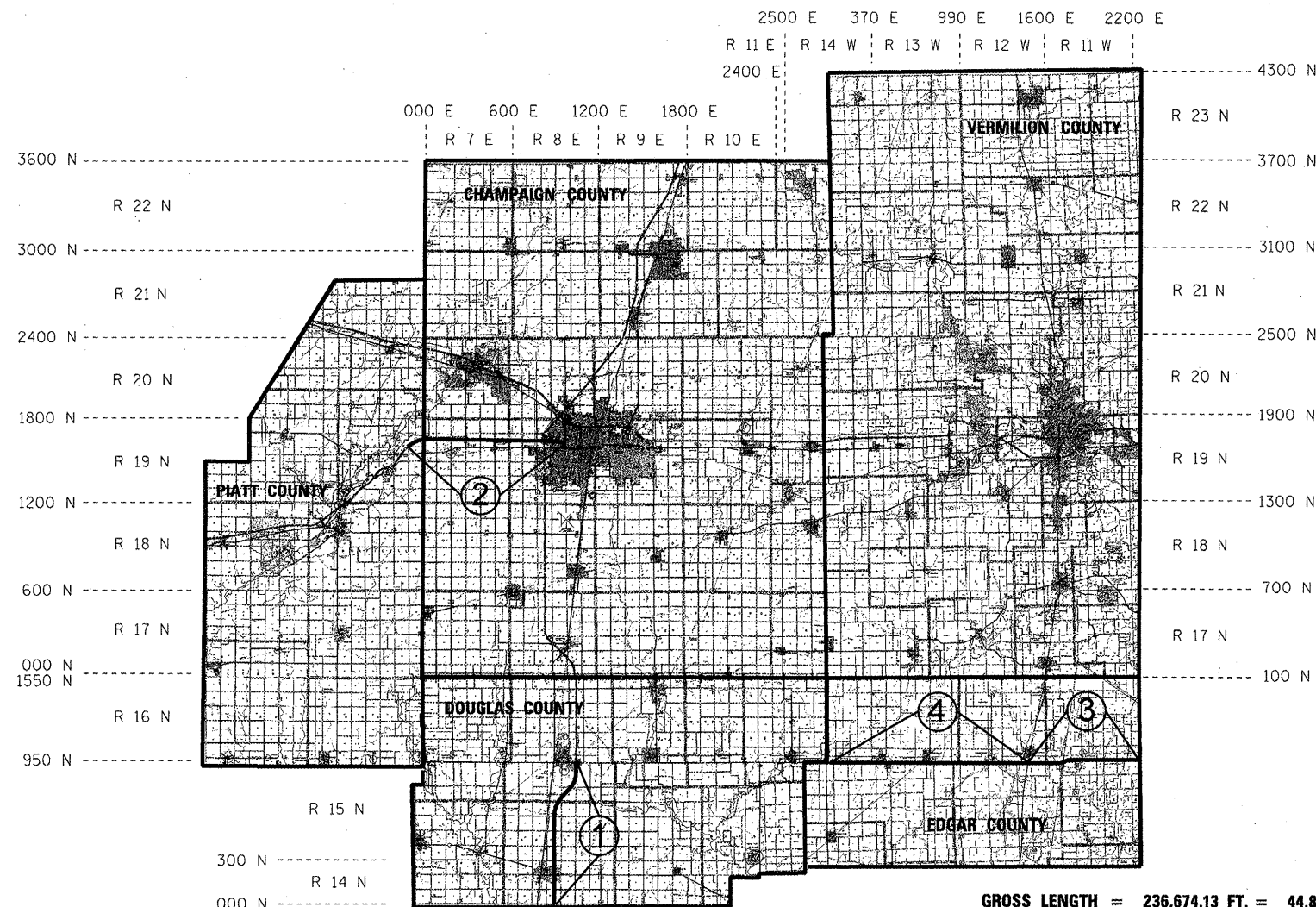
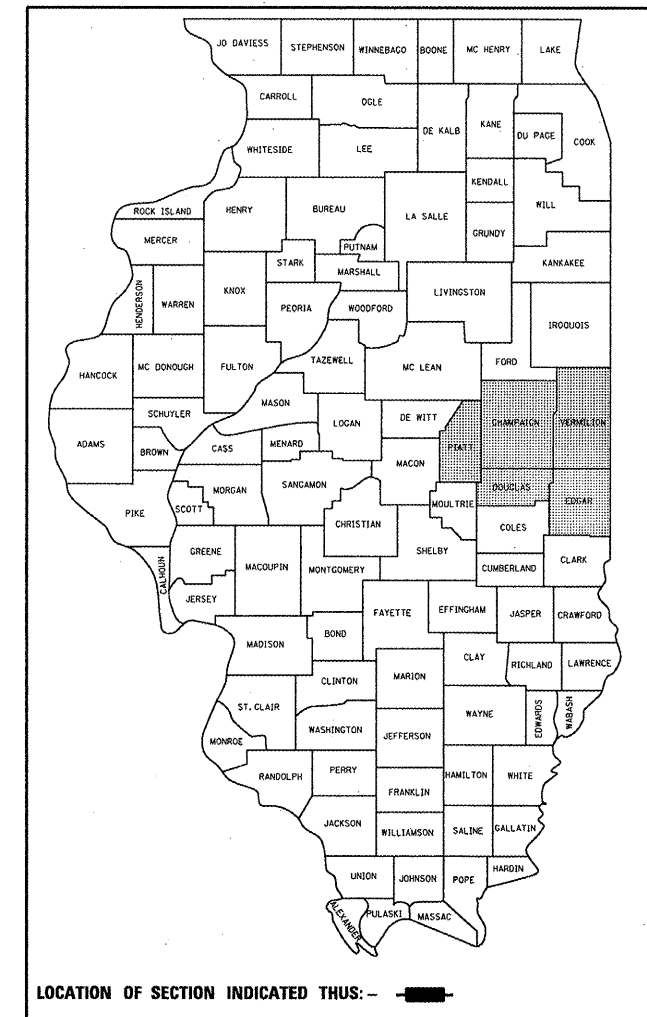

FULL SIZE PLANS HAVE BEEN PREPARED USING STANDARD ENGINEERING SCALES. REDUCED SIZED PLANS WILL NOT CONFORM TO STANDARD SCALES. IN MAKING MEASUREMENTS ON REDUCED PLANS, THE ABOVE SCALES MAY BE USED.

J.U.L.I.E.  
JOINT UTILITY LOCATION INFORMATION FOR EXCAVATION  
1-800-892-0123  
OR 811

PROJECT ENGINEER: JASON STULTS  
SQUAD LEADER: GREG EAGLIN  
DESIGNER: BYRON SMITH  
PHONE NUMBER: (217)-465-4181  
CONTRACT NO. 70933

GROSS LENGTH = 236,674.13 FT. = 44.825 MILE  
NET LENGTH = 233,988.45 FT. = 44.316 MILE

STATE OF ILLINOIS  
DEPARTMENT OF TRANSPORTATION  
DIVISION OF HIGHWAYS  
SUBMITTED 0127 2012  
Joseph E. Greene (KAC)  
DEPUTY DIRECTOR OF HIGHWAYS, REGION ENGINEER  
March 23 2012  
John D. Baranzelli, P.E.  
acting ENGINEER OF DESIGN AND ENVIRONMENT  
March 23 2012  
William R. Fry  
acting DIRECTOR OF HIGHWAYS, CHIEF ENGINEER

PRINTED BY THE AUTHORITY  
OF THE STATE OF ILLINOIS

## INDEX OF SHEETS

| <u>SHEET NO.</u> | <u>DESCRIPTION</u>   |
|------------------|--|
| 1                | COVER SHEET  |
| 2                | INDEX OF SHEETS  |
| 2                | LIST OF STANDARDS  |
| 3-6              | LOCATION MAPS  |
| 7                | GENERAL NOTES  |
| 8                | SUMMARY OF QUANTITIES  |
| 9-16             | EXISTING TYPICAL CROSS SECTIONS                                      |
| 17               | SCHEDULE OF QUANTITIES   |
| 18               | DETAIL FOR CRACK AND JOINT SEALING                                   |
| 19               | DETAIL FOR TRAFFIC CONTROL FOR RAMPS                                 |
| 20-23            | DETAIL FOR PAVEMENT MARKING AND MARKERS (RURAL & URBAN APPLICATIONS) |
| 24               | DETAIL FOR PAVEMENT MARKING (INTERSTATE & MULTI-LANE APPLICATIONS)   |

## LIST OF STANDARDS

| <u>STANDARD NO.</u> | <u>NAME OF STANDARD</u>   |
|---------------------|---|
| 000001-06           | STANDARD SYMBOLS, ABBREVIATIONS AND PATTERNS                                    |
| 001006              | DECIMAL OF AN INCH AND OF A FOOT  |
| 701306-03           | LANE CLOSURE, 2L, 2W, SLOW MOVING OPERATIONS DAY ONLY, FOR SPEEDS $\geq$ 45 MPH |
| 701311-03           | LANE CLOSURE, 2L, 2W, MOVING OPERATIONS - DAY ONLY                              |
| 701400-05           | APPROACH TO LANE CLOSURE, FREEWAY/EXPRESSWAY                                    |
| 701406-06           | LANE CLOSURE, FREEWAY/EXPRESSWAY, DAY OPERATIONS ONLY                           |
| 701411-08           | LANE CLOSURE, MULTILANE, AT ENTRANCE OR EXIT RAMP, FOR SPEEDS $\geq$ 45 MPH     |
| 701601-07           | URBAN LANE CLOSURE, MULTILANE, 1W, OR 2W, WITH NONTRAVERSABLE MEDIAN            |
| 701901-02           | TRAFFIC CONTROL DEVICES   |
| 780001-03           | TYPICAL PAVEMENT MARKINGS   |

• D5 CRACK & JOINT SEAL 2012-2

|   |  |                 |           |   |  |              |         |                    |                 |              |
|---|--|-----------------|-----------|---|--|--------------|---------|--------------------|-----------------|--------------|
| FILE NAME =<br>c:\p\work\p\uidot\piersonb\d0287987\05 | USER NAME = piersonb<br>0933-sht-gennote.dgn | DESIGNED - BS   | REVISED - | <b>STATE OF ILLINOIS<br/>DEPARTMENT OF TRANSPORTATION</b> | <b>INDEX OF SHEETS<br/>LIST OF STANDARDS</b> | F.A.<br>RTE. | SECTION | COUNTY             | TOTAL<br>SHEETS | SHEET<br>NO. |
| PLOT SCALE = 40.0000' / in.                           | PLOT DATE = 1/27/2012                        | DRAWN - BBP     | CHECKED - | REVISED -   | SCALE: NONE                                  | SHEET 1      | OF 1    | SHEETS             | STA.            | TO STA.      |
|   |  | DATE - 01/14/12 | REVISED - |   |  |              | *       | VAR.               | 24              | 2            |
|   |  |                 |           |   |  |              |         | CONTRACT NO. 70933 |                 |              |
| [ILLINOIS] FED. AID PROJECT                           |  |                 |           |   |  |              |         |                    |                 |              |

# LOCATION MAP #1

## F.A.I. ROUTE 57 (I-57) FROM COLES COUNTY LINE TO 0.3 MI N. OF U.S. 36

### DOUGLAS COUNTY / RURAL INTERSTATE

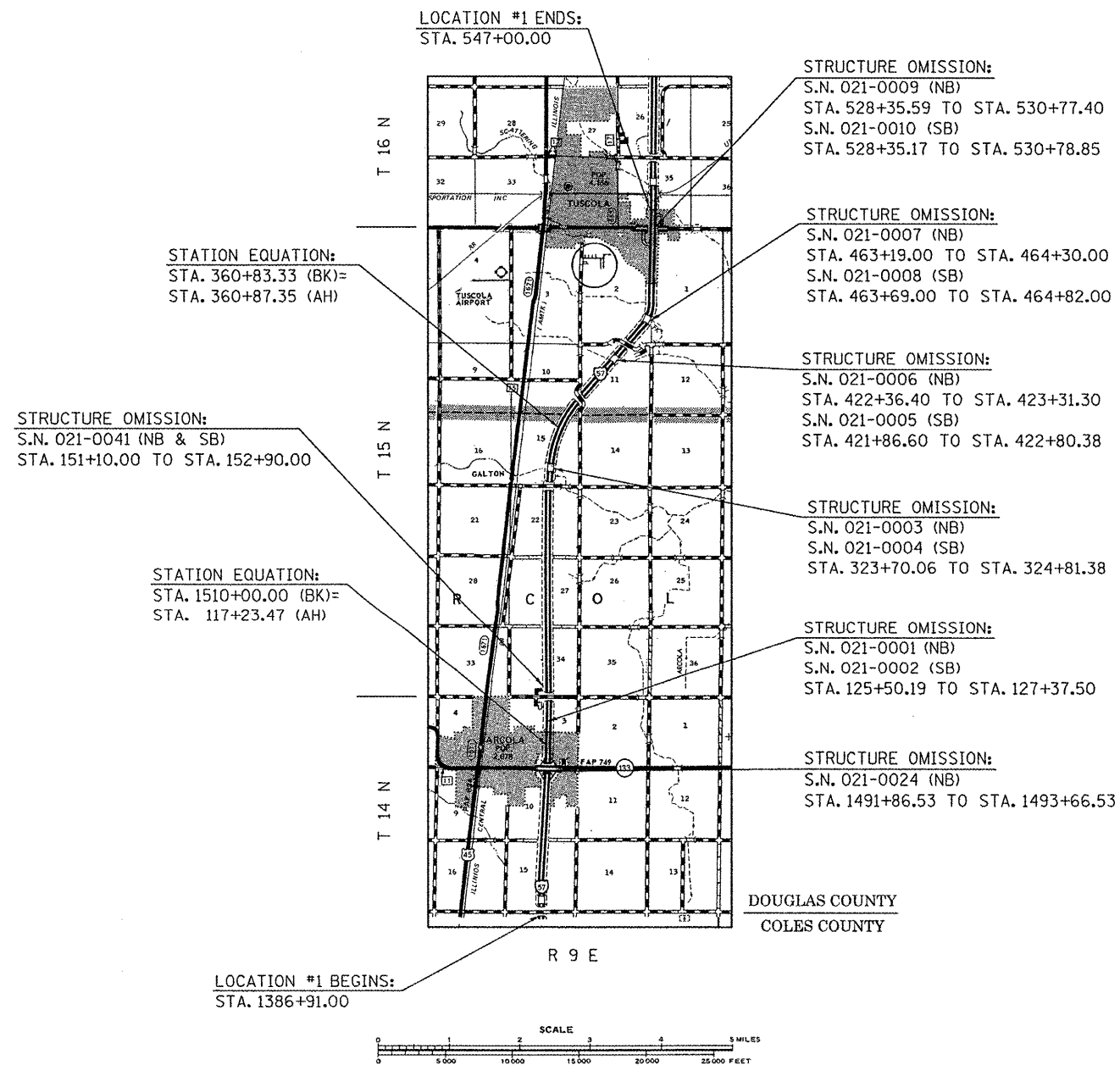

**GROSS LENGTH OF LOCATION #1 = 55,281.51 FT. = 10.470 MILES (NORTHBOUND)**  
**NET LENGTH OF LOCATION #1 = 54,175.17 FT. = 10.260 MILES (NORTHBOUND)**

• D5 CRACK & JOINT SEAL 2012-2

|  |                       |               |           |   |                        |                           |         |              |              |           |  |
|--|-----------------------|---------------|-----------|---|------------------------|---------------------------|---------|--------------|--------------|-----------|--|
| FILE NAME =                            | USER NAME = piersonbr | DESIGNED - BS | REVISED - | <b>STATE OF ILLINOIS<br/>DEPARTMENT OF TRANSPORTATION</b> | <b>LOCATION MAP #1</b> | F.A. RTE.                 | SECTION | COUNTY       | TOTAL SHEETS | SHEET NO. |  |
| ct:\p\work\p\dot\piersonbr\d0287987\05 | 0933-sht-loc_maps.dgn | DRAWN - BBP   | REVISED - |   |                        | VAR.                      | •       | VAR.         | 24           | 3         |  |
| PLOT SCALE = 40.0000 / in.             | CHECKED -             | REVISED -     | REVISED - |   |                        | CONTRACT NO. 70933        |         |              |              |           |  |
| PLOT DATE = 1/27/2012                  | DATE - 01/05/12       | REVISED -     | REVISED - |   |                        | ILLINOIS FED. AID PROJECT |         |              |              |           |  |
|  |                       |               |           | SCALE: NONE   |                        | SHEET 1 OF 1 SHEETS       |         | STA. TO STA. |              |           |  |

# LOCATION MAP #2

## F.A.I. ROUTE 72 (I-72) FROM N.E. OF WHITE HEATH TO MATTIS AVE.

### CHAMPAIGN COUNTY / RURAL & URBAN INTERSTATE

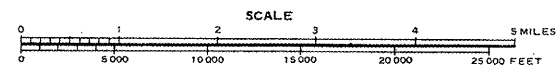
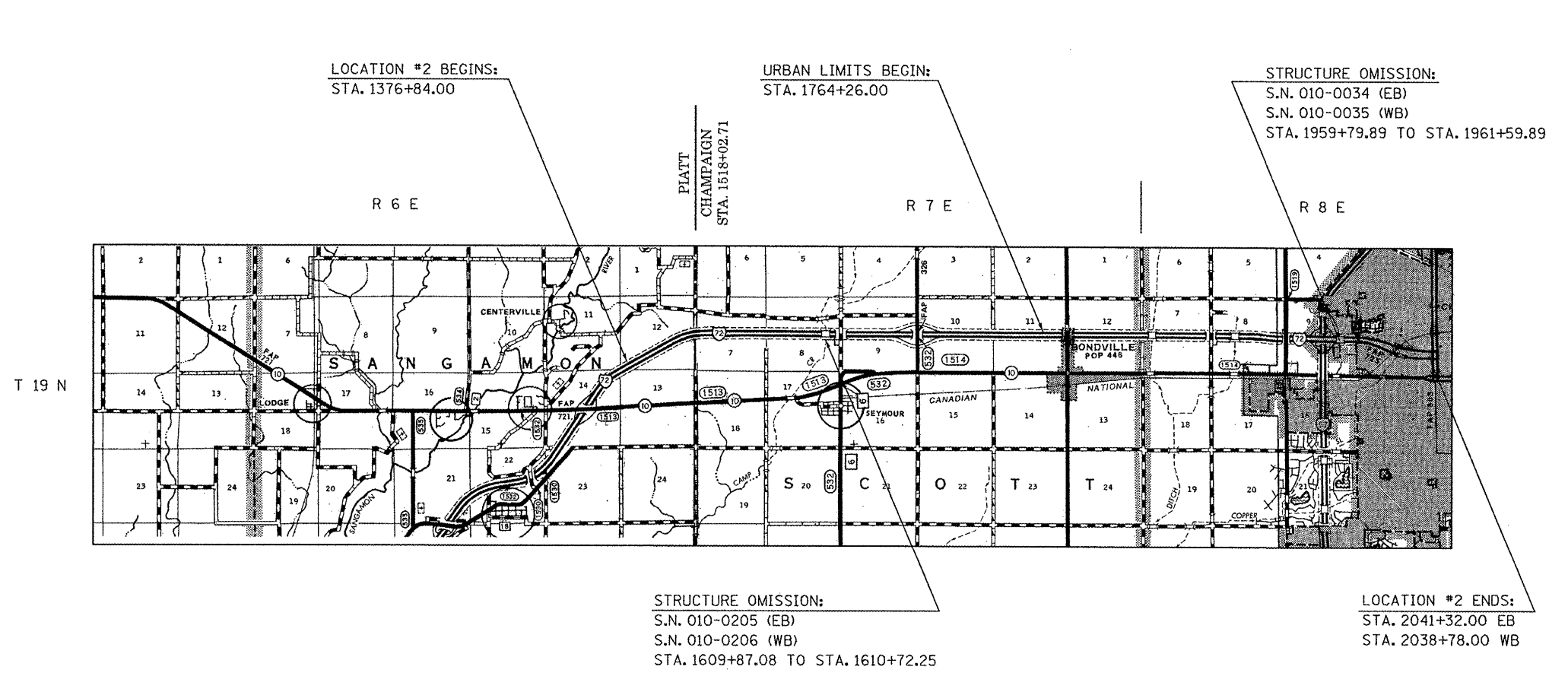

TOWNSHIP:  
CHAMPAIGN, SANGAMON, SCOTT

**GROSS LENGTH OF LOCATION #2 = 66,448.00 FT. = 12.585 MILES (EASTBOUND)**  
**NET LENGTH OF LOCATION #2 = 66,182.83 FT. = 12.535 MILES (EASTBOUND)**

• D5 CRACK & JOINT SEAL 2012-2

|  |                       |   |                 |   |                        |           |         |        |              |           |
|--|-----------------------|---|-----------------|---|------------------------|-----------|---------|--------|--------------|-----------|
| FILE NAME =  | USER NAME = piersonbr | DESIGNED - BS   | REVISED -       | <b>STATE OF ILLINOIS<br/>DEPARTMENT OF TRANSPORTATION</b> | <b>LOCATION MAP #2</b> | F.A. RTE. | SECTION | COUNTY | TOTAL SHEETS | SHEET NO. |
| ei:\pwork\p1dot\piersonbr\d0287987\050933-sh-t-loc.mps.dgn |                       | DRAWN - BBP   | REVISED -       |   |                        | VAR.      | •       | VAR.   | 24           | 4         |
|  |                       | PLOT SCALE = 40.0000 "/td> <td>CHECKED -</td> <td>REVISED -</td> <td>SCALE: NONE</td> <td>SHEET 1</td> <td>OF 1</td> <td>SHEETS</td> <td>STA.</td> <td>TO STA.</td> | CHECKED -       | REVISED -   | SCALE: NONE            | SHEET 1   | OF 1    | SHEETS | STA.         | TO STA.   |
|  |                       | PLOT DATE = 1/27/2012   | DATE - 01/05/12 | REVISED -   |                        |           |         |        |              |           |
| ILLINOIS FED. AID PROJECT                                  |                       |   |                 |   |                        |           |         |        |              |           |

# LOCATION MAP #3

## F.A.P. ROUTE 323 (U.S. 36) FROM U.S. 150 AT CHRISMAN TO INDIANA STATE LINE

### EDGAR COUNTY / RURAL 2-LANE

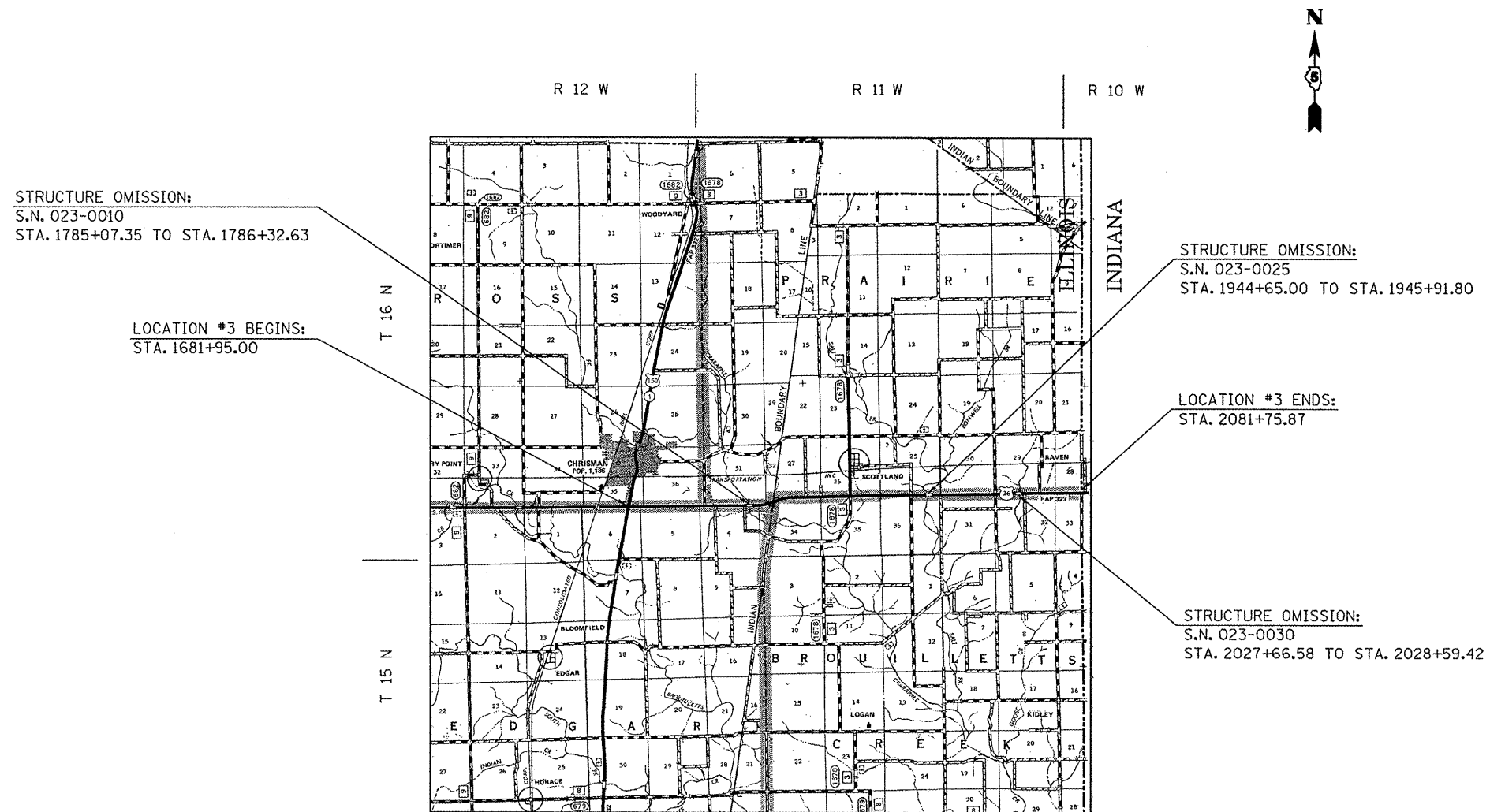

TOWNSHIP:  
EDGAR, PRAIRIE, ROSS, BROUILLETTS CREEK

**GROSS LENGTH OF LOCATION #3 = 39,980.87 FT. = 7.572 MILES**  
**NET LENGTH OF LOCATION #3 = 39,635.95 FT. = 7.507 MILES**

• D5 CRACK & JOINT SEAL 2012-2

|  |                              |                 |           |                                     |                        |           |         |        |              |                           |
|--|------------------------------|-----------------|-----------|-------------------------------------|------------------------|-----------|---------|--------|--------------|---------------------------|
| FILE NAME :                            | USER NAME : piersonbr        | DESIGNED - BS   | REVISED - | <b>STATE OF ILLINOIS</b>            | <b>LOCATION MAP #3</b> | F.A. RTE. | SECTION | COUNTY | TOTAL SHEETS | SHEET NO.                 |
| cr:\pwork\pwidot\piersonbr\d0287987\05 | 09333-sht-loc_maps.dgn       | DRAWN - BBP     | REVISED - | <b>DEPARTMENT OF TRANSPORTATION</b> | SCALE: NONE            | SHEET 1   | OF 1    | SHEETS | STA.         | TO STA.                   |
|  | PLOT SCALE * 40.0000 ' / in. | CHECKED -       | REVISED - |                                     |                        |           |         |        |              |                           |
|  | PLOT DATE * 1/27/2012        | DATE - 01/05/12 | REVISED - |                                     |                        |           |         |        |              |                           |
|  |                              |                 |           |                                     |                        |           |         |        |              | ILLINOIS FED. AID PROJECT |

# LOCATION MAP #4

## F.A.P. ROUTE 323 (U.S. 36) FROM IL 49 TO U.S. 150 AT CHRISMAN

### EDGAR COUNTY / RURAL 2-LANE

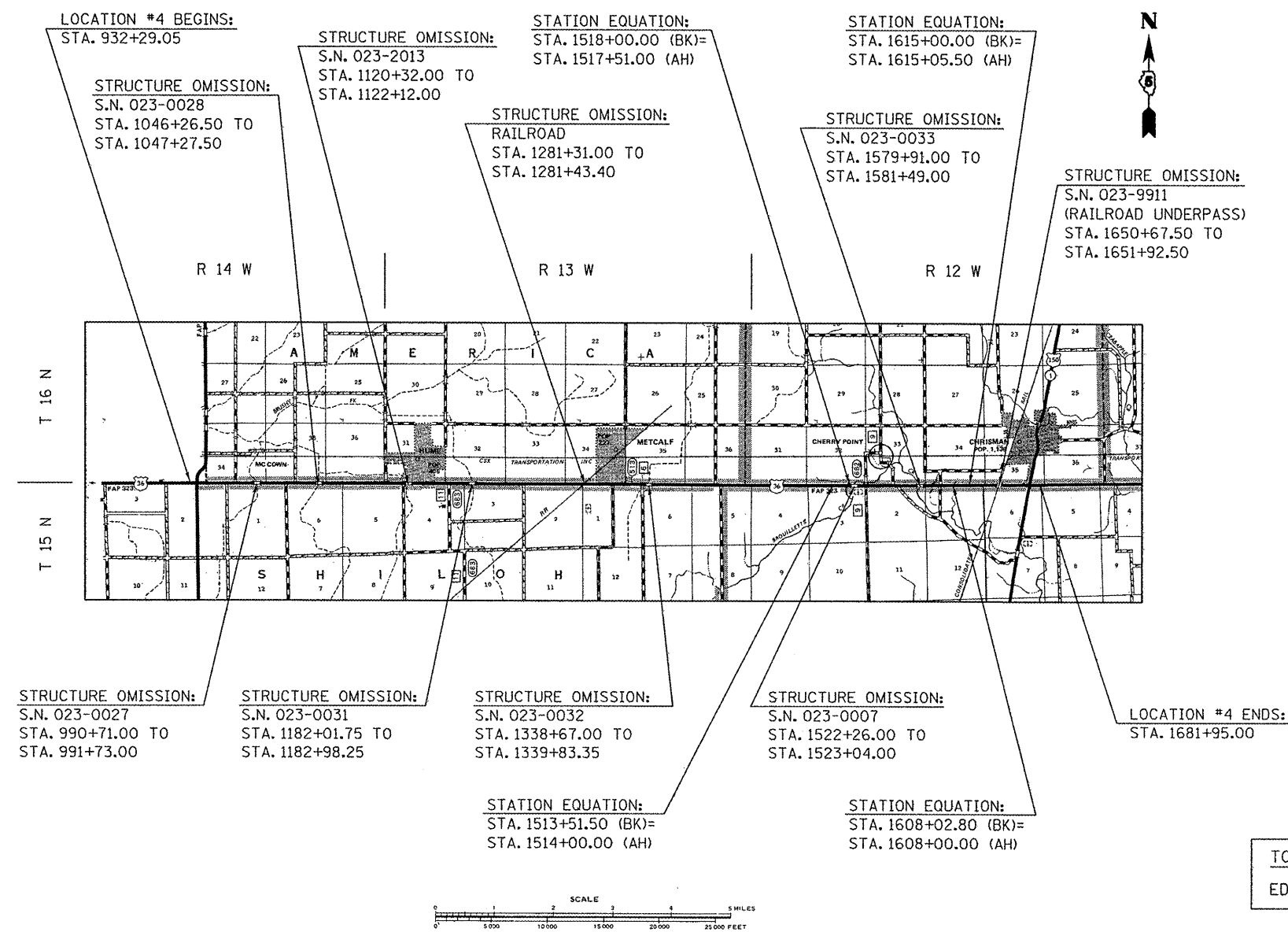

**GROSS LENGTH OF LOCATION #4 = 74,963.75 FT. = 14.198 MILES**  
**NET LENGTH OF LOCATION #4 = 73,994.50 FT. = 14.014 MILES**

|  |                        |               |                           |   |                        |           |         |        |              |           |  |
|--|------------------------|---------------|---------------------------|---|------------------------|-----------|---------|--------|--------------|-----------|--|
| FILE NAME =  | USER NAME = ppersonbr  | DESIGNED - BS | REVISED -                 | <b>STATE OF ILLINOIS<br/>DEPARTMENT OF TRANSPORTATION</b> | <b>LOCATION MAP #4</b> | F.A. RTE. | SECTION | COUNTY | TOTAL SHEETS | SHEET NO. |  |
| al:\pr-work\pvidot\piersonbr\08287987\0570933-shc-loc_maps.dgn   | 70933-shc-loc_maps.dgn | DRAWN - BBP   | REVISED -                 |   |                        | VAR.      | VAR.    | VAR.   | 24           | 6         |  |
| PLOT SCALE = 40.0000 "/td> <td>CHECKED -</td> <td>REVISED -</td> <td colspan="7" style="text-align: center;">CONTRACT NO. 70933</td> | CHECKED -              | REVISED -     | CONTRACT NO. 70933        |   |                        |           |         |        |              |           |  |
| PLOT DATE = 1/27/2012  | DATE - 01/05/12        | REVISED -     | ILLINOIS FED. AID PROJECT |   |                        |           |         |        |              |           |  |

• D5 CRACK & JOINT SEAL 2012-2

## GENERAL NOTES

G.N.-100  
ENGLISH UNITS OF MEASUREMENT SHALL GOVERN OVER AND SUPERSEDE ANY METRIC UNITS SHOWN IN THIS CONTRACT. WHERE INCLUDED, METRIC UNITS ARE FOR INFORMATION ONLY.

G.N.-100A  
ELECTRONIC FILES AND/OR ELECTRONIC SURVEY INFORMATION INCLUDING CADD FILES WILL NOT BE AVAILABLE TO THE CONTRACTOR.

G.N.-107.12A  
RAILROAD PROTECTIVE LIABILITY INSURANCE IS NOT INCLUDED IN THIS CONTRACT. ALL ROUT AND SEAL OPERATIONS SHALL STOP AT THE RAILROAD RIGHT-OF-WAY LINE UNLESS THE RAILROAD RIGHT-OF-WAY LINE IS LESS THAN 25.0 FEET FROM THE RAILROAD TRACKS, THEN THE ROUT AND SEAL OPERATIONS SHALL STOP 25.0 FEET FROM THE RAILROAD TRACKS. THE RAILROAD RIGHT-OF-WAY LINE SHALL BE DETERMINED IN THE FIELD BY THE RESIDENT ENGINEER.

G.N.-451 (SPECIAL)  
CRACK ROUTING AND FILLING CONSISTS OF BOTH LONGITUDINAL AND TRANSVERSE CRACKS. AN APPLICATION RATE OF 0.40 LBS. / FOOT WAS USED TO DETERMINE CRACK FILLING QUANTITIES.

NOTE:  
THE INTENT OF THIS PROJECT IS TO ROUT & SEAL LONGITUDINAL AND TRANSVERSE CRACKS AS DESCRIBED AT EACH LOCATION LISTED BELOW. ANY CHANGES TO THE INTENT OF THE ROUTING AND SEALING OPERATIONS SHALL BE APPROVED IN ADVANCE BY THE ENGINEER.

**LOCATION #1**  
I-57 NB & I-57 SB SHALL BE COMPLETED BEFORE PROCEEDING TO RAMP. LONGITUDINAL CRACKS ALONG CENTERLINE AND BETWEEN PAVING LANES SHALL BE ROUTED AND SEALED. LONGITUDINAL CRACKS BETWEEN EDGE OF PAVEMENT AND RAMP SHALL BE ROUTED AND SEALED. LONGITUDINAL CRACKS WITHIN PAVING LANES GREATER THAN 1/4" IN WIDTH SHALL BE ROUTED AND SEALED. LONGITUDINAL AND TRANSVERSE CRACKS ON THE RAMP SHALL BE ROUTED AND SEALED. TRANSVERSE CRACKS GREATER THAN OR EQUAL TO 1/4" IN WIDTH SHALL BE ROUTED AND SEALED. CRACKS IN PAVED SHOULDERS AND MEDIAN CROSSOVERS SHALL BE OMITTED.

LONGITUDINAL : 108,348 FOOT (ESTIMATED)  
TRANSVERSE : 7,116 FOOT (ESTIMATED)  
TOTAL : 115,464 FOOT (ESTIMATED)

**LOCATION #2**  
I-72 WB & I-72 EB SHALL BE COMPLETED BEFORE PROCEEDING TO RAMP. LONGITUDINAL CRACKS ALONG CENTERLINE AND BETWEEN PAVING LANES SHALL BE ROUTED AND SEALED. LONGITUDINAL CRACKS BETWEEN EDGE OF PAVEMENT AND RAMP SHALL BE ROUTED AND SEALED. LONGITUDINAL CRACKS WITHIN PAVING LANES GREATER THAN 1/4" IN WIDTH SHALL BE ROUTED AND SEALED. LONGITUDINAL AND TRANSVERSE CRACKS ON THE RAMP SHALL BE ROUTED AND SEALED. TRANSVERSE CRACKS GREATER THAN OR EQUAL TO 1/4" IN WIDTH SHALL BE ROUTED AND SEALED. CRACKS IN PAVED SHOULDERS AND MEDIAN CROSSOVERS SHALL BE OMITTED.

LONGITUDINAL : 135,454 FOOT (ESTIMATED)  
TRANSVERSE : 11,599 FOOT (ESTIMATED)  
TOTAL : 147,053 FOOT (ESTIMATED)

**LOCATION #3**  
LONGITUDINAL CRACKS ALONG CENTERLINE AND BETWEEN PAVING LANES SHALL BE ROUTED AND SEALED. LONGITUDINAL CRACKS WITHIN PAVING LANES GREATER THAN 1/4" IN WIDTH SHALL BE ROUTED AND SEALED. TRANSVERSE CRACKS GREATER THAN OR EQUAL TO 1/4" IN WIDTH SHALL BE ROUTED AND SEALED. CRACKS IN PAVED SHOULDER, V- GUTTER, MAILBOX TURNOUTS AND ENTRANCES SHALL BE OMITTED.

LONGITUDINAL : 40,520 FOOT (ESTIMATED)  
TRANSVERSE : 3,630 FOOT (ESTIMATED)  
TOTAL : 44,150 FOOT (ESTIMATED)

**LOCATION #4**  
LONGITUDINAL CRACKS ALONG CENTERLINE AND BETWEEN PAVING LANES SHALL BE ROUTED AND SEALED. LONGITUDINAL CRACKS WITHIN PAVING LANES GREATER THAN 1/4" IN WIDTH SHALL BE ROUTED AND SEALED. TRANSVERSE CRACKS GREATER THAN OR EQUAL TO 1/4" IN WIDTH SHALL BE ROUTED AND SEALED. CRACKS IN PAVED SHOULDER, MAILBOX TURNOUTS AND ENTRANCES SHALL BE OMITTED.

LONGITUDINAL : 105,212 FOOT (ESTIMATED)  
TRANSVERSE : 33,048 FOOT (ESTIMATED)  
TOTAL : 138,260 FOOT (ESTIMATED)

**COMMITMENTS:**  
THERE ARE NO COMMITMENTS FOR THIS CONTRACT.

• D5 CRACK & JOINT SEAL 2012-2

|  |                             |                 |           |   |                      |              |         |        |                 |                           |
|--|-----------------------------|-----------------|-----------|---|----------------------|--------------|---------|--------|-----------------|---------------------------|
| FILE NAME =                            | USER NAME = piersonbr       | DESIGNED - BS   | REVISED - | <b>STATE OF ILLINOIS<br/>DEPARTMENT OF TRANSPORTATION</b> | <b>GENERAL NOTES</b> | F.A.<br>RTE. | SECTION | COUNTY | TOTAL<br>SHEETS | SHEET<br>NO.              |
| et:\pwork\puidat\piersonbr\d8287987\05 | 70933-shit-gennote.dgn      | DRAWN - BBP     | REVISED - |   |                      | VAR.         | *       | VAR.   | 24              | 7                         |
|  | PLOT SCALE = 48.0000' / in. | CHECKED -       | REVISED - |   | SCALE: NONE          |              |         |        |                 |                           |
|  | PLOT DATE = 1/27/2012       | DATE - 01/14/12 | REVISED - |   | SHEET 1 OF 1 SHEETS  |              |         |        |                 | CONTRACT NO. 70933        |
|  |                             |                 |           |   | STA. TO STA.         |              |         |        |                 | ILLINOIS FED. AID PROJECT |

## SUMMARY OF QUANTITIES

|                         |                       |                       |
|-------------------------|-----------------------|-----------------------|
| LOCATION OF WORK:       | LOCATION#1 <b>FAI</b> | LOCATION#2 <b>FAI</b> |
|                         | LOCATION#2 <b>FAI</b> | <b>07E0J</b>          |
|                         | LOCATION#3 <b>FAP</b> |                       |
|                         | LOCATION#4 <b>FAP</b> |                       |
|                         | <b>07EDI</b>          |                       |
| COUNTY:                 | VARIOUS               | VARIOUS               |
|                         | RURAL                 | URBAN                 |
|                         | ROUT & SEAL           | ROUT & SEAL           |
| FUNDING BREAKOUT:       | 100% STATE            | 100% STATE            |
|                         |                       |                       |
| CONSTRUCTION TYPE CODE: | 0005                  | 0005                  |

| CODE NO.   | ITEM  | UNIT   | TOTAL<br>QUANTITY | QUANTITY | QUANTITY |
|------------|---|--------|-------------------|----------|----------|
| 45100100   | CRACK ROUTING (PAVEMENT)                        | FOOT   | 444927.0          | 384527.0 | 60400.0  |
| 45100200   | CRACK FILLING                                   | POUND  | 177971.0          | 153811.0 | 24160.0  |
| 67100100   | MOBILIZATION                                    | L SUM  | 1.0               | 0.8      | 0.2      |
| 70100420   | TRAFFIC CONTROL AND PROTECTION, STANDARD 701411 | EACH   | 24.0              | 16.0     | 8.0      |
| 70100460   | TRAFFIC CONTROL AND PROTECTION, STANDARD 701306 | L SUM  | 1.0               | 1.0      | 0.0      |
| 70100700   | TRAFFIC CONTROL AND PROTECTION, STANDARD 701406 | L SUM  | 1.0               | 0.8      | 0.2      |
| 70102630   | TRAFFIC CONTROL AND PROTECTION, STANDARD 701601 | L SUM  | 1.0               | 0.0      | 1.0      |
| * 78001110 | PAINT PAVEMENT MARKING - LINE 4"                | FOOT   | 28750.0           | 28750.0  | 0.0      |
| X7015005   | CHANGEABLE MESSAGE SIGN                         | CAL DA | 12.0              | 9.0      | 3.0      |

\* SPECIALTY ITEMS

• D5 CRACK & JOINT SEAL 2012-2

|   |                       |                 |           |   |                              |  |         |        |                 |              |   |
|---|-----------------------|-----------------|-----------|---|------------------------------|--|---------|--------|-----------------|--------------|---|
| FILE NAME =   | USER NAME = piersonbr | DESIGNED - BS   | REVISED - | <b>STATE OF ILLINOIS<br/>DEPARTMENT OF TRANSPORTATION</b> | <b>SUMMARY OF QUANTITIES</b> | F.A.<br>RTE.                                 | SECTION | COUNTY | TOTAL<br>SHEETS | SHEET<br>NO. |   |
| ai\pwwork\pwwork\piersonbr\08287987\0570933-sht-500.dgn |                       | DRAWN - BBP     | REVISED - |   |                              | VAR.   |         |        | VAR.            | 24           | 8 |
| PLOT SCALE = 40.0000' / in.                             |                       | CHECKED -       | REVISED - |   |                              | SCALE: NONE SHEET 1 OF 1 SHEETS STA. TO STA. |         |        |                 |              |   |
| PLOT DATE = 1/27/2012                                   |                       | DATE - 01/14/12 | REVISED - |   |                              | ILLINOIS FED. AID PROJECT CONTRACT NO. 70933 |         |        |                 |              |   |



**STATION EQUATIONS:**  
 STA. 1510+00.00 (BK) = STA. 117+23.47 (AH)  
 STA. 360+83.33 (BK) = STA. 360+87.35 (AH)

# 1 EXISTING TYPICAL CROSS SECTION

## F.A.I. ROUTE 57 (I-57) NORTHBOUND

### LOCATION #1

STATION TO STATION  
 1386+91.00 547+00.00

**STRUCTURE OMISSIONS:**  
 STA. 1491+86.53 TO STA. 1493+66.53 (S.N. 021-0024)  
 STA. 125+50.19 TO STA. 127+37.50 (S.N. 021-0001)  
 STA. 151+10.00 TO STA. 152+90.00 (S.N. 021-0041)  
 STA. 323+70.06 TO STA. 324+81.38 (S.N. 021-0003)  
 STA. 422+36.40 TO STA. 423+31.30 (S.N. 021-0006)  
 STA. 463+19.00 TO STA. 464+30.00 (S.N. 021-0007)  
 STA. 528+35.59 TO STA. 530+77.40 (S.N. 021-0009)

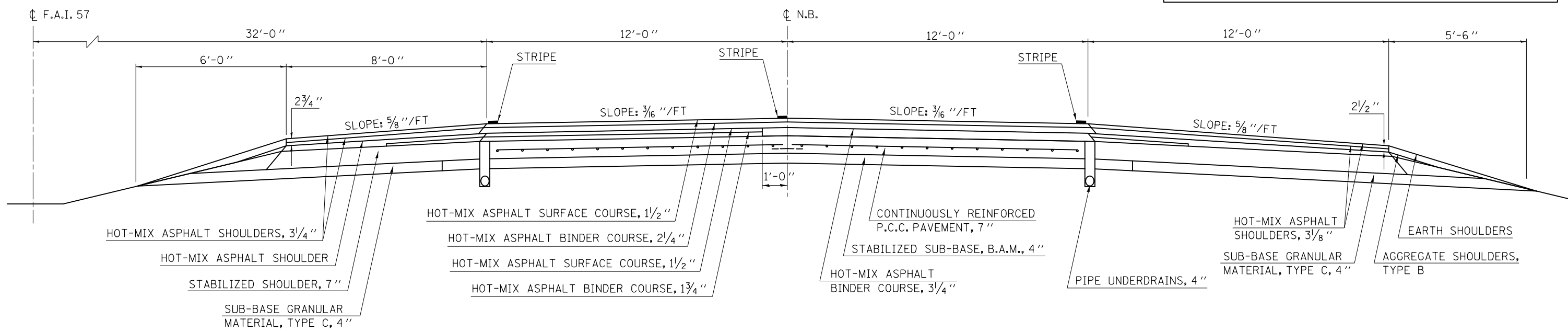

**STATION EQUATIONS:**  
 STA. 1510+00.00 (BK) = STA. 117+23.47 (AH)  
 STA. 360+83.33 (BK) = STA. 360+87.35 (AH)

# 2 EXISTING TYPICAL CROSS SECTION

## F.A.I. ROUTE 57 (I-57) SOUTHBOUND

### LOCATION #1

STATION TO STATION  
 1386+91.00 547+00.00

**STRUCTURE OMISSIONS:**  
 STA. 125+50.19 TO STA. 127+37.50 (S.N. 021-0002)  
 STA. 151+10.00 TO STA. 152+90.00 (S.N. 021-0041)  
 STA. 323+70.06 TO STA. 324+81.38 (S.N. 021-0004)  
 STA. 421+86.60 TO STA. 422+80.38 (S.N. 021-0005)  
 STA. 463+69.00 TO STA. 464+82.00 (S.N. 021-0008)  
 STA. 528+35.17 TO STA. 530+78.85 (S.N. 021-0010)

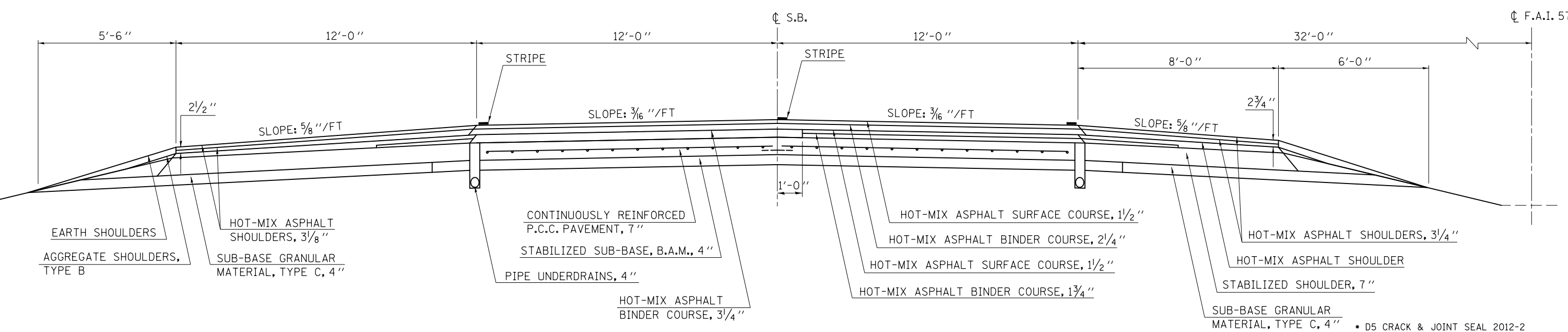

|                                      |                             |                 |           |   |                               |         |             |           |         |                           |              |           |
|--------------------------------------|-----------------------------|-----------------|-----------|---|-------------------------------|---------|-------------|-----------|---------|---------------------------|--------------|-----------|
| FILE NAME =                          | USER NAME = ppersonbr       | DESIGNED - BS   | REVISED - | <b>STATE OF ILLINOIS<br/>DEPARTMENT OF TRANSPORTATION</b> | <b>TYPICAL CROSS SECTIONS</b> |         |             | F.A. RTE. | SECTION | COUNTY                    | TOTAL SHEETS | SHEET NO. |
| ci:\pwork\pwork\personbr\d0287987\05 | 0933-sh-typical.dgn         | DRAWN - BBP     | REVISED - |   | SCALE: NONE                   | SHEET 1 | OF 2 SHEETS | STA.      | TO STA. | VAR.                      | 24           | 9         |
|                                      | PLOT SCALE = 40.0000' / in. | CHECKED -       | REVISED - |   |                               |         |             |           |         |                           |              |           |
|                                      | PLOT DATE = 1/27/2012       | DATE - 01/12/12 | REVISED - |   |                               |         |             |           |         |                           |              |           |
|                                      |                             |                 |           |   |                               |         |             |           |         | CONTRACT NO. 70933        |              |           |
|                                      |                             |                 |           |   |                               |         |             |           |         | ILLINOIS FED. AID PROJECT |              |           |

**3 EXISTING TYPICAL CROSS SECTION**  
**F.A.I. ROUTE 57 & S.B.I. 133 INTERCHANGE RAMPS**  
**LOCATION #1**

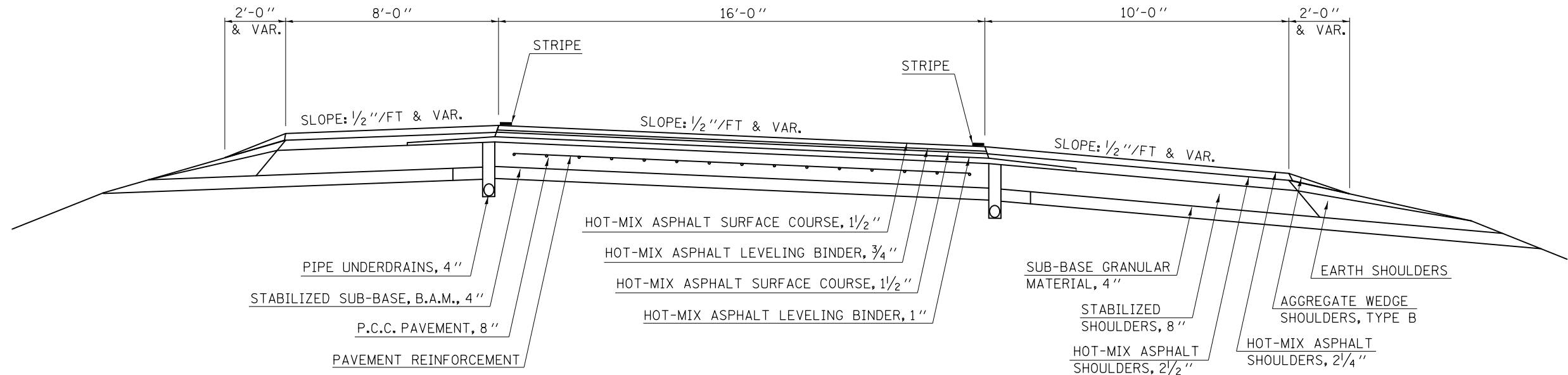

**4 EXISTING TYPICAL CROSS SECTION**  
**F.A.I. ROUTE 57 & U.S. ROUTE 36 INTERCHANGE RAMPS**  
**LOCATION #1**

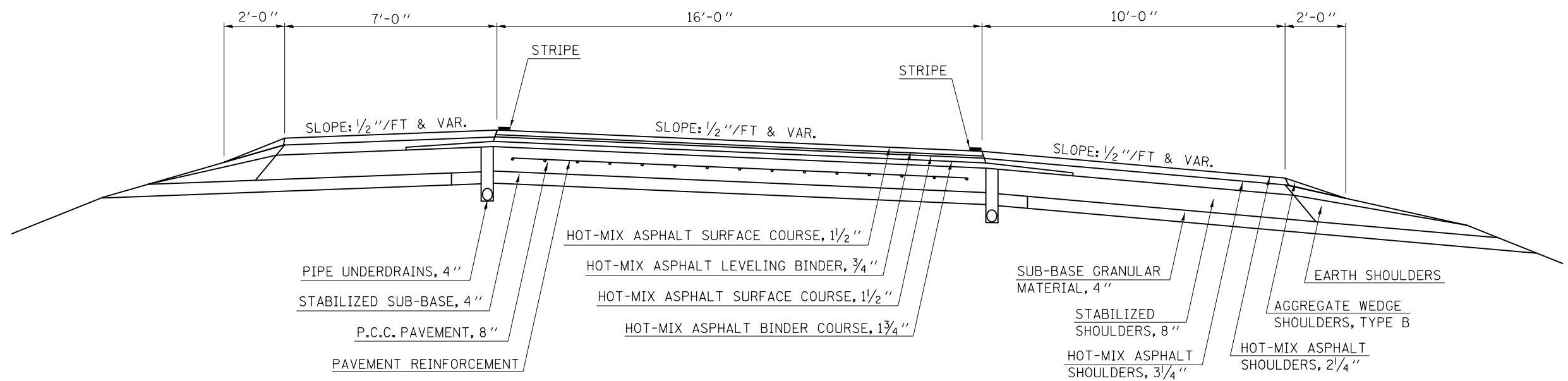

• D5 CRACK & JOINT SEAL 2012-2

|  |                       |                 |           |   |                               |                     |      |           |         |        |              |           |    |
|--|-----------------------|-----------------|-----------|---|-------------------------------|---------------------|------|-----------|---------|--------|--------------|-----------|----|
| FILE NAME =  | USER NAME = ppersonbr | DESIGNED - BS   | REVISED - | <b>STATE OF ILLINOIS<br/>DEPARTMENT OF TRANSPORTATION</b> | <b>TYPICAL CROSS SECTIONS</b> |                     |      | F.A. RTE. | SECTION | COUNTY | TOTAL SHEETS | SHEET NO. |    |
| et:\pw\work\p\dot\personbr\d0287987\0570933-sh-typical.dgn |                       | DRAWN - BBP     | REVISED - |   | SCALE: NONE                   | SHEET 2 OF 2 SHEETS | STA. | TO STA.   | VAR.    | •      | VAR.         | 24        | 10 |
| PLOT SCALE = 40.0000' / in.                                |                       | CHECKED -       | REVISED - |   | CONTRACT NO. 70933            |                     |      |           |         |        |              |           |    |
| PLOT DATE = 1/27/2012                                      |                       | DATE - 01/12/12 | REVISED - |   | ILLINOIS FED. AID PROJECT     |                     |      |           |         |        |              |           |    |

# 1 EXISTING TYPICAL CROSS SECTION

F.A.I. ROUTE 72 (I-72)

LOCATION #2

STATION TO STATION  
1376+84.00 TO 2024+85.00 (3)

STRUCTURE OMISSIONS:

STA. 1609+87.08 TO STA. 1610+72.25 (S.N. 010-0205 E. B.)  
STA. 1959+79.89 TO STA. 1961+59.89 (S.N. 010-0034 E. B.)

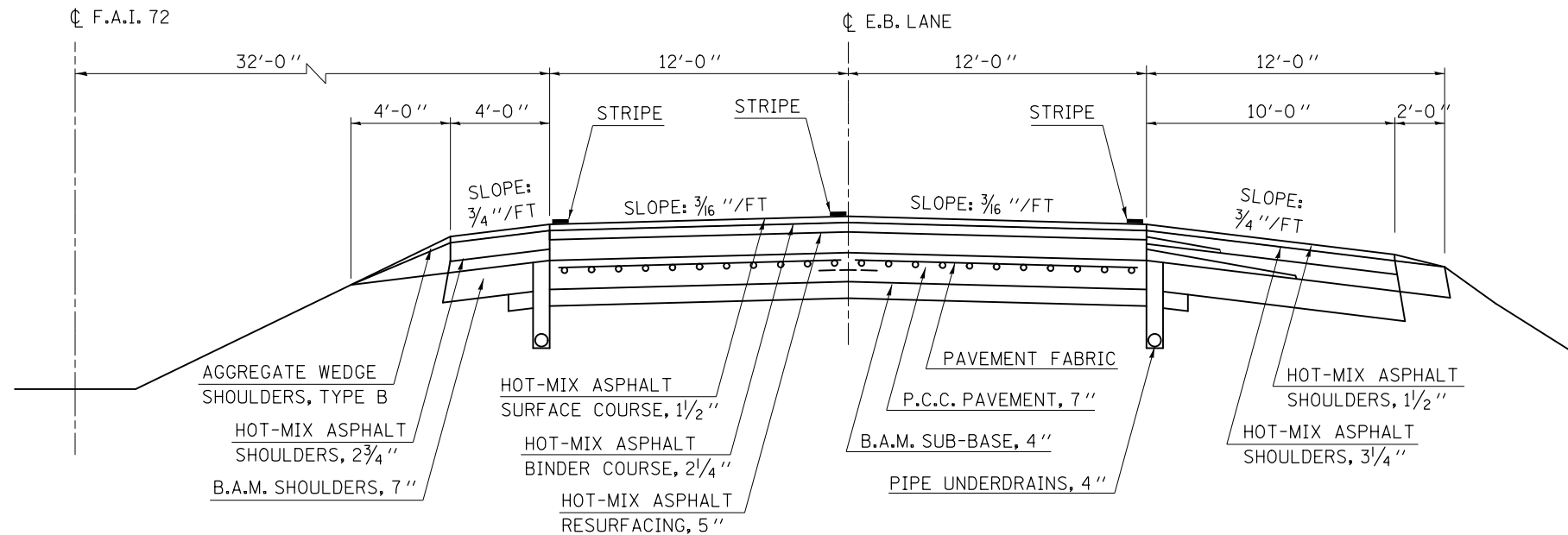

# 2 EXISTING TYPICAL CROSS SECTION

F.A.I. ROUTE 72 (I-72)

LOCATION #2

STATION TO STATION  
1376+84.00 TO 2024+98.00 (3)

STRUCTURE OMISSIONS:

STA. 1609+87.08 TO STA. 1610+72.25 (S.N. 010-0206 W. B.)  
STA. 1959+79.89 TO STA. 1961+59.89 (S.N. 010-0035 W. B.)

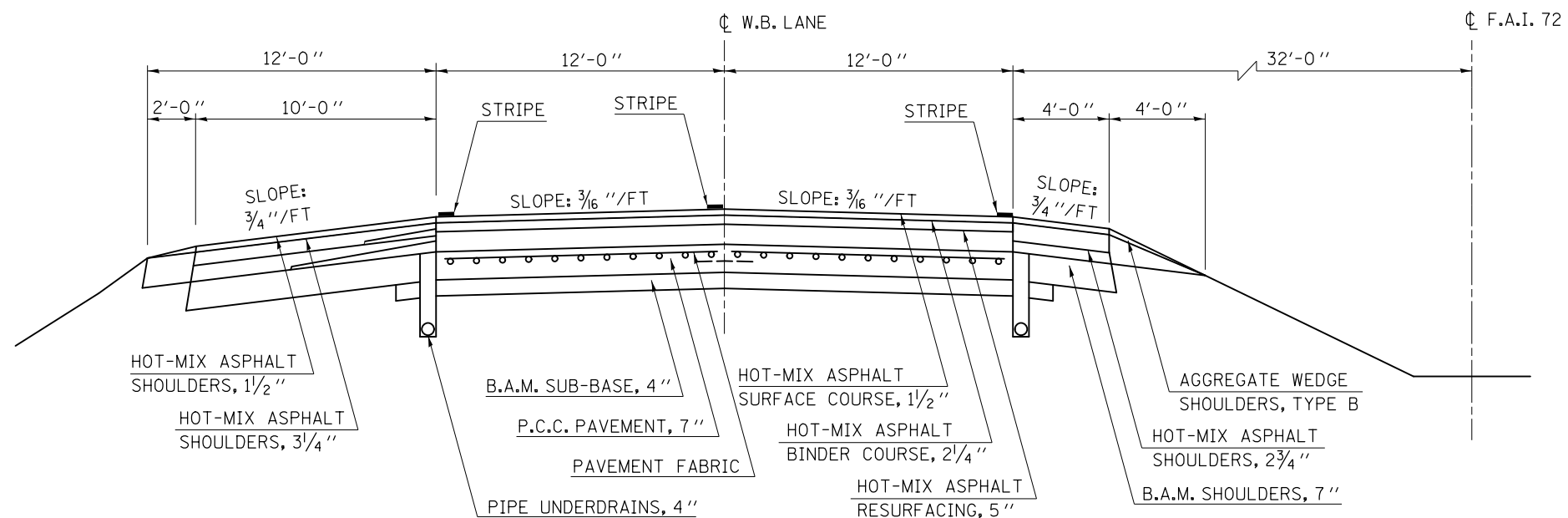

\* D5 CRACK & JOINT SEAL 2012-2

|   |                       |                 |           |
|---|-----------------------|-----------------|-----------|
| FILE NAME =   | USER NAME = ppersonbr | DESIGNED - BS   | REVISED - |
| ct:\pwork\pwork\personbr\d0287987\0570933-sh1-typical.dgn |                       | DRAWN - BBP     | REVISED - |
| PLOT SCALE = 48.0000 ' / in.                              |                       | CHECKED -       | REVISED - |
| PLOT DATE = 1/27/2012                                     |                       | DATE - 01/11/12 | REVISED - |

STATE OF ILLINOIS  
DEPARTMENT OF TRANSPORTATION

TYPICAL CROSS SECTIONS

SCALE: NONE SHEET 1 OF 2 SHEETS STA. TO STA.

| F.A. RTE.                 | SECTION | COUNTY | TOTAL SHEETS | SHEET NO. |
|---------------------------|---------|--------|--------------|-----------|
|                           |         |        | 24           | 11        |
| CONTRACT NO. 70933        |         |        |              |           |
| ILLINOIS FED. AID PROJECT |         |        |              |           |

### 3 EXISTING TYPICAL CROSS SECTION

F.A.I. ROUTE 72 (I-72)

LOCATION #2

|   | STATION       | TO | STATION       |
|---|---------------|----|---------------|
| ① | 2024+85.00 EB |    | 2041+32.00 EB |
| ② | 2024+98.00 WB |    | 2038+78.00 WB |

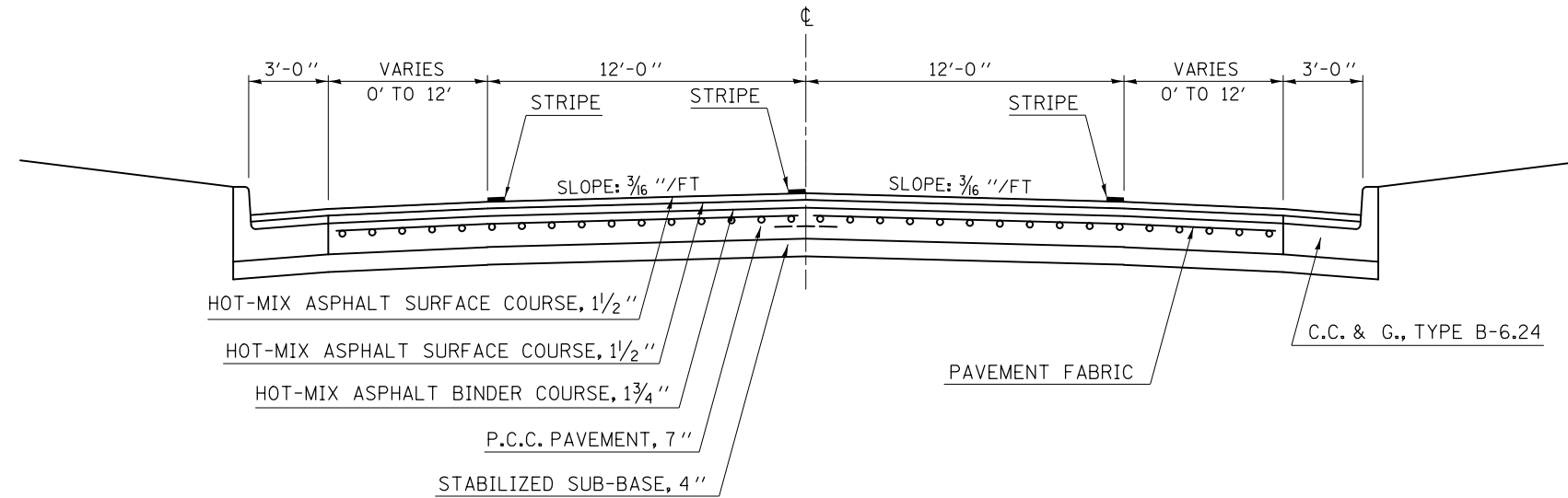

### 4 EXISTING TYPICAL CROSS SECTION

F.A.I. ROUTE 72 (I-72) RAMPS

LOCATION #2

RAMPS AT IL ROUTE 10

| STATION   | TO | STATION      |
|-----------|----|--------------|
| 100+90.00 |    | 118+19.90 WB |
| 200+00.00 |    | 219+65.00 WB |
| 300+00.00 |    | 319+65.00 EB |
| 401+00.00 |    | 418+13.90 EB |

RAMPS AT IL ROUTE 47

| STATION   | TO | STATION      |
|-----------|----|--------------|
| 500+85.00 |    | 521+40.00 WB |
| 600+00.00 |    | 617+55.00 WB |
| 700+00.00 |    | 717+20.00 EB |
| 800+50.00 |    | 821+40.00 EB |

RAMPS AT F.A.I. ROUTE 57

| STATION   | TO | STATION   |           |
|-----------|----|-----------|-----------|
| 11+15.00  |    | 14+25.00  | EB LOOP   |
| 26+68.00  |    | 32+65.00  | NB LOOP   |
| 71+53.00  |    | 74+22.00  | WB LOOP   |
| 88+00.00  |    | 92+70.00  | SB LOOP   |
| 141+00.00 |    | 152+30.86 | SB RAMP E |
| 160+00.00 |    | 167+10.00 | SB RAMP F |
| 220+80.00 |    | 232+30.68 | NB RAMP G |
| 240+00.00 |    | 247+85.00 | NB RAMP H |

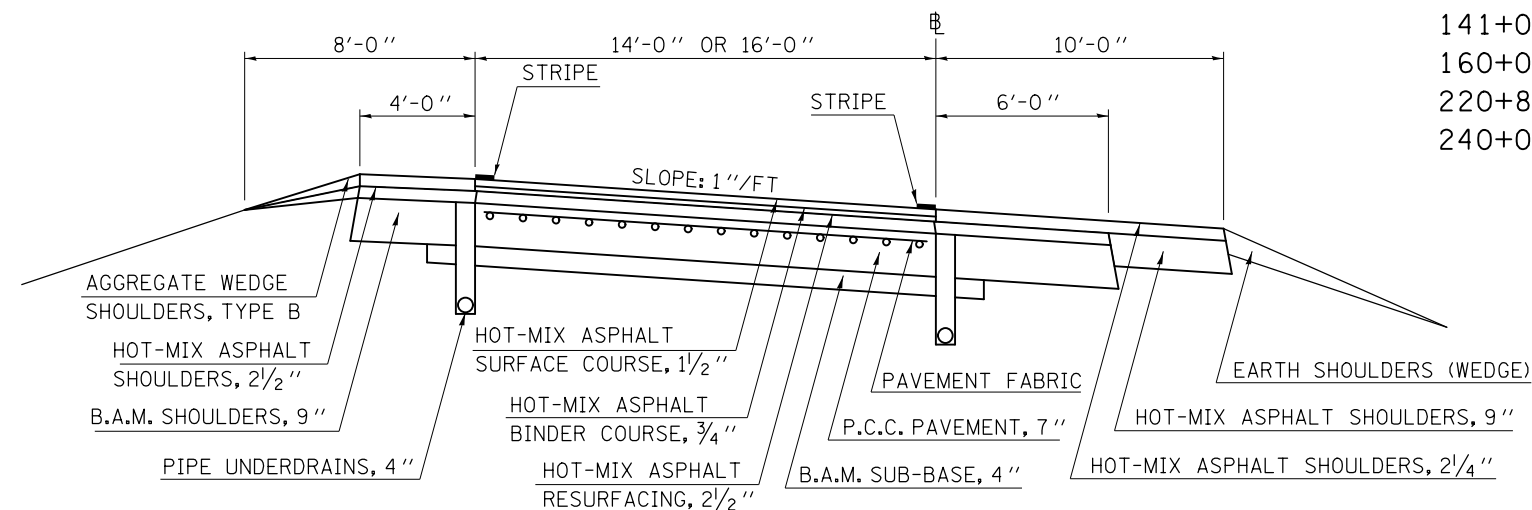

\* D5 CRACK & JOINT SEAL 2012-2

|   |                       |                 |           |   |                               |         |             |           |         |        |              |           |
|---|-----------------------|-----------------|-----------|---|-------------------------------|---------|-------------|-----------|---------|--------|--------------|-----------|
| FILE NAME =   | USER NAME = ppersonbr | DESIGNED - BS   | REVISED - | <b>STATE OF ILLINOIS<br/>DEPARTMENT OF TRANSPORTATION</b> | <b>TYPICAL CROSS SECTIONS</b> |         |             | F.A. RTE. | SECTION | COUNTY | TOTAL SHEETS | SHEET NO. |
| et:\pw\work\p\pidot\ppersonbr\d0287987\0570933-sh-typical.dgn |                       | DRAWN - BBP     | REVISED - |   | SCALE: NONE                   | SHEET 2 | OF 2 SHEETS | STA.      | TO STA. | VAR.   | 24           | 12        |
|   |                       | CHECKED -       | REVISED - |   | CONTRACT NO. 70933            |         |             |           |         |        |              |           |
|   |                       | DATE - 01/11/12 | REVISED - |   | ILLINOIS FED. AID PROJECT     |         |             |           |         |        |              |           |

# 1 EXISTING TYPICAL CROSS SECTION

F.A.P. ROUTE 323 (U.S. 36)

LOCATION #3

STATION TO STATION  
1681+95.00 1687+00.00 ②

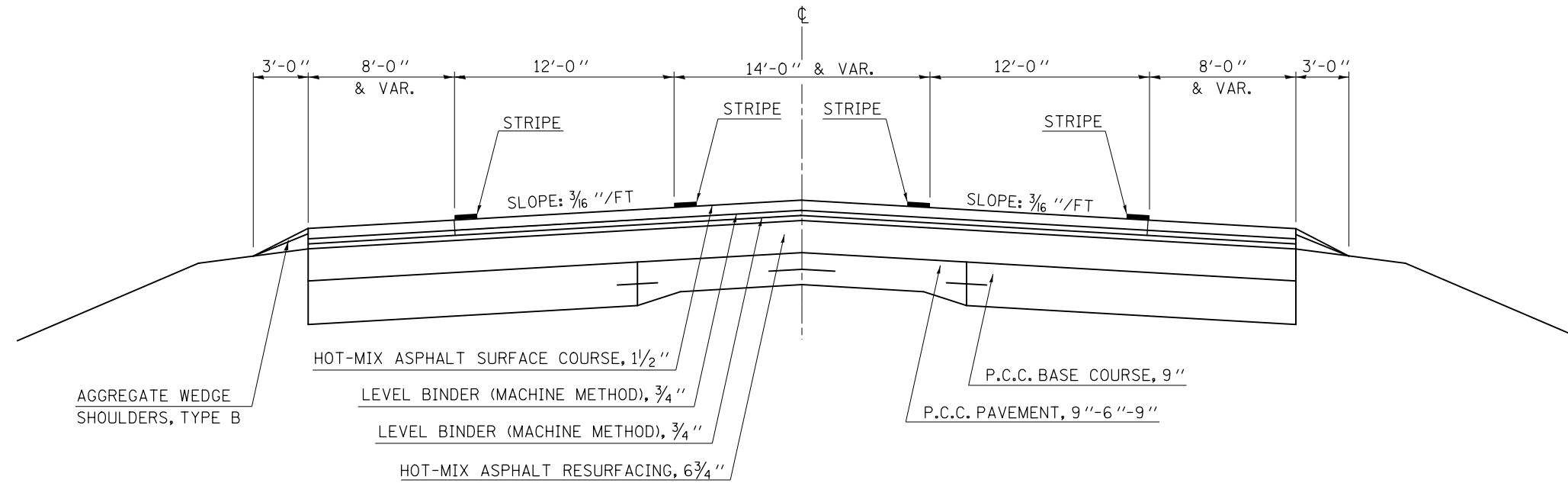

# 2 EXISTING TYPICAL CROSS SECTION

F.A.P. ROUTE 323 (U.S. 36)

LOCATION #3

STATION TO STATION  
① 1687+00.00 1782+90.00 ③  
③ 1788+50.00 1792+41.35 ④  
④ 1828+50.35 2081+75.87

STRUCTURE OMISSION:  
STA. 1944+65.00 TO STA. 1945+91.80 (S. N. 023-0025)  
STA. 2027+66.58 TO STA. 2028+59.42 (S. N. 023-0030)

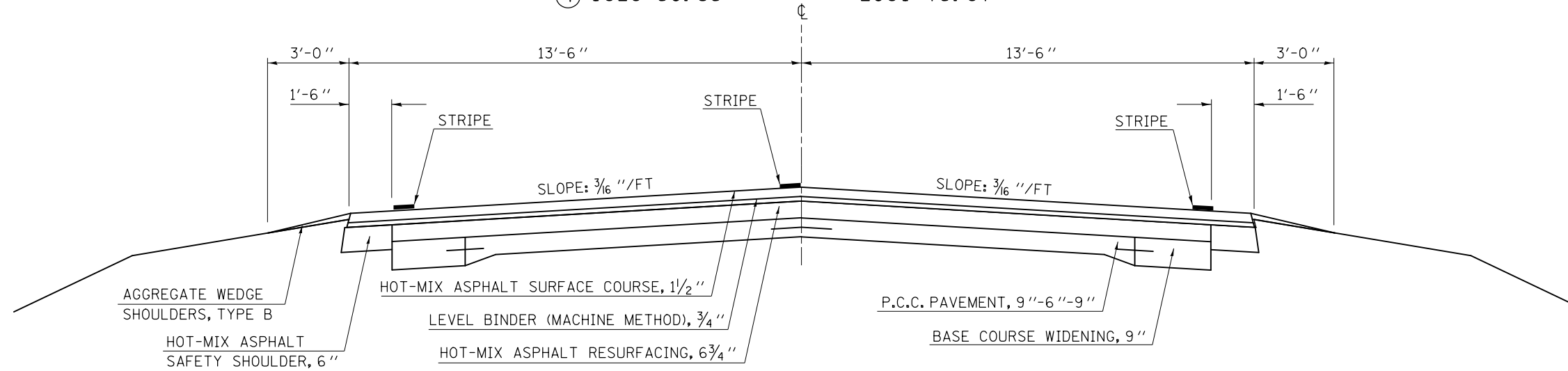

• D5 CRACK & JOINT SEAL 2012-2

|   |                       |                 |           |   |                               |         |             |           |         |                           |              |           |    |
|---|-----------------------|-----------------|-----------|---|-------------------------------|---------|-------------|-----------|---------|---------------------------|--------------|-----------|----|
| FILE NAME =   | USER NAME = ppersonbr | DESIGNED - BS   | REVISED - | <b>STATE OF ILLINOIS<br/>DEPARTMENT OF TRANSPORTATION</b> | <b>TYPICAL CROSS SECTIONS</b> |         |             | F.A. RTE. | SECTION | COUNTY                    | TOTAL SHEETS | SHEET NO. |    |
| ci:\pw\work\pwidot\ppersonbr\d0287987\0570933-sh1-typical.dgn |                       | DRAWN - BBP     | REVISED - |   | SCALE: NONE                   | SHEET 1 | OF 2 SHEETS | STA.      | TO STA. | VAR.                      |              | 24        | 13 |
| PLOT SCALE = 40.0000' / in.                                   |                       | CHECKED -       | REVISED - |   |                               |         |             |           |         |                           |              |           |    |
| PLOT DATE = 1/27/2012   |                       | DATE - 01/09/12 | REVISED - |   |                               |         |             |           |         |                           |              |           |    |
|   |                       |                 |           |   |                               |         |             |           |         | CONTRACT NO. 70933        |              |           |    |
|   |                       |                 |           |   |                               |         |             |           |         | ILLINOIS FED. AID PROJECT |              |           |    |

### 3 EXISTING TYPICAL CROSS SECTION

F.A.P. ROUTE 323 (U.S. 36)

LOCATION #3

STRUCTURE OMISSION:  
STA. 1785+07.35 TO STA. 1786+32.63 (S.N. 023-0010)

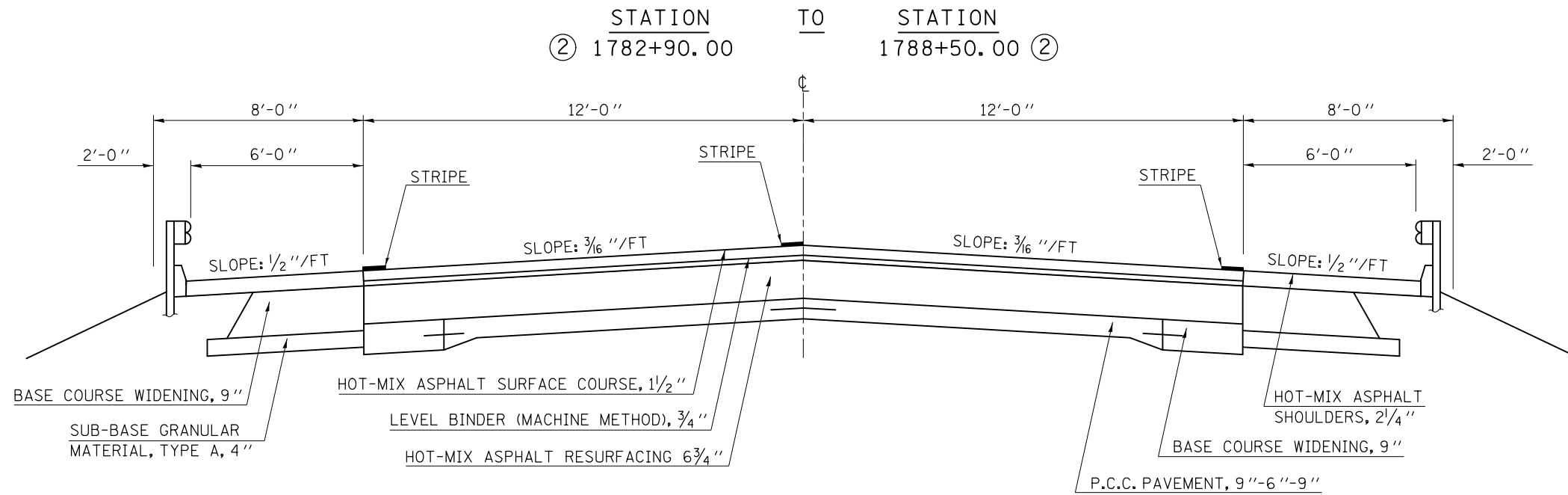

### 4 EXISTING TYPICAL CROSS SECTION

F.A.P. ROUTE 323 (U.S. 36)

LOCATION #3

STATION ② 1792+41.35 TO STATION 1828+50.35 ②

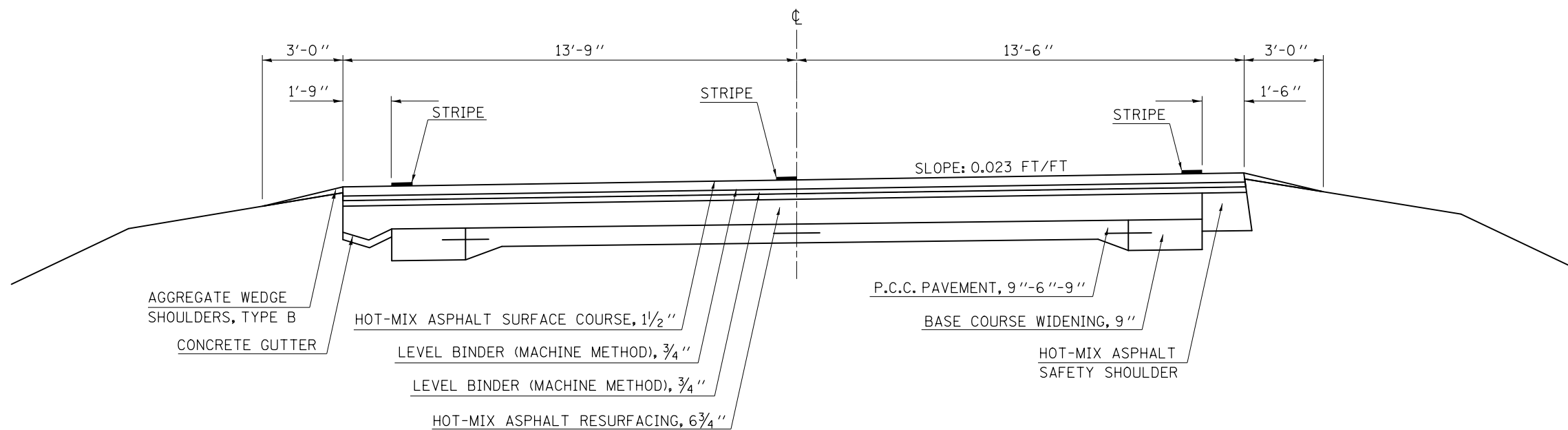

• D5 CRACK & JOINT SEAL 2012-2

|  |                       |                 |           |   |                               |         |             |           |         |        |              |                           |    |
|--|-----------------------|-----------------|-----------|---|-------------------------------|---------|-------------|-----------|---------|--------|--------------|---------------------------|----|
| FILE NAME =  | USER NAME = ppersonbr | DESIGNED - BS   | REVISED - | <b>STATE OF ILLINOIS<br/>DEPARTMENT OF TRANSPORTATION</b> | <b>TYPICAL CROSS SECTIONS</b> |         |             | F.A. RTE. | SECTION | COUNTY | TOTAL SHEETS | SHEET NO.                 |    |
| et:\pw\work\p\dot\personbr\d0287987\0570933-sh-typical.dgn |                       | DRAWN - BBP     | REVISED - |   | SCALE: NONE                   | SHEET 2 | OF 2 SHEETS | STA.      | TO STA. | VAR.   |              | 24                        | 14 |
| PLOT SCALE = 40.0000' / in.                                |                       | CHECKED -       | REVISED - |   |                               |         |             |           |         |        |              |                           |    |
| PLOT DATE = 1/27/2012                                      |                       | DATE - 01/09/12 | REVISED - |   |                               |         |             |           |         |        |              |                           |    |
|  |                       |                 |           |   |                               |         |             |           |         |        |              | CONTRACT NO. 70933        |    |
|  |                       |                 |           |   |                               |         |             |           |         |        |              | ILLINOIS FED. AID PROJECT |    |

# 1 EXISTING TYPICAL CROSS SECTION

F.A.P. ROUTE 323 (U.S. 36)

LOCATION #4

| STATION      | TO | STATION     |
|--------------|----|-------------|
| 932+29.05    |    | 944+84.70 ② |
| ② 1668+52.00 |    | 1681+95.00  |

INTERSECTION AREAS ONLY

INTERSECTION AREAS ONLY

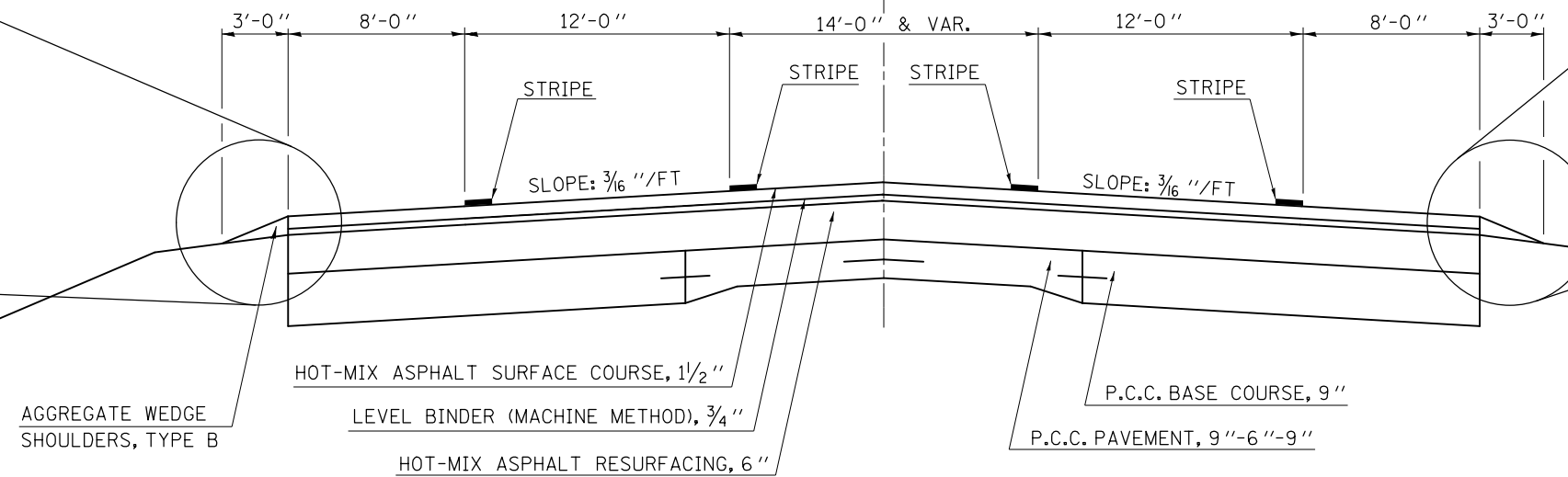
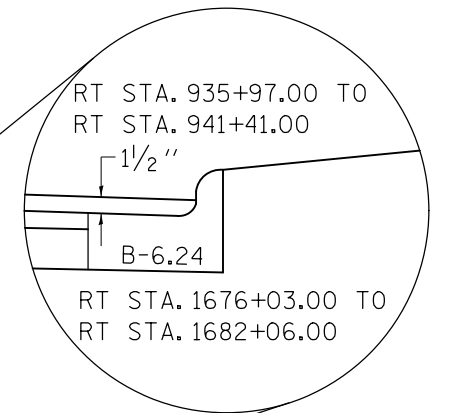
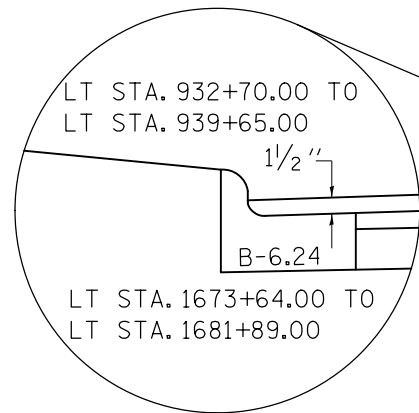

# 2 EXISTING TYPICAL CROSS SECTION

F.A.P. ROUTE 323 (U.S. 36)

LOCATION #4

| STATION      | TO | STATION      |
|--------------|----|--------------|
| ① 944+84.70  |    | 1135+25.00 ③ |
| ③ 1144+54.00 |    | 1646+45.00 ④ |
| ④ 1656+55.00 |    | 1668+52.00 ① |

STRUCTURE OMISSIONS:

|   |
|---|
| STA. 990+71.00 TO STA. 991+73.00 (S. N. 023-0027)   |
| STA. 1046+26.50 TO STA. 1047+27.50 (S. N. 023-0028) |
| STA. 1120+32.00 TO STA. 1122+12.00 (S. N. 023-0013) |
| STA. 1182+01.75 TO STA. 1182+98.25 (S. N. 023-0031) |
| STA. 1281+31.00 TO STA. 1281+43.40 (RAILROAD)       |
| STA. 1338+67.00 TO STA. 1339+83.35 (S. N. 023-0032) |
| STA. 1522+26.00 TO STA. 1523+04.00 (S. N. 023-0007) |
| STA. 1579+91.00 TO STA. 1581+49.00 (S. N. 023-0033) |

STATION EQUATIONS:

|   |
|---|
| STA. 1513+51.00 (BK) = STA. 1514+00.00 (AH) |
| STA. 1518+00.00 (BK) = STA. 1517+51.00 (AH) |
| STA. 1608+02.80 (BK) = STA. 1608+00.00 (AH) |
| STA. 1615+00.00 (BK) = STA. 1615+05.50 (AH) |

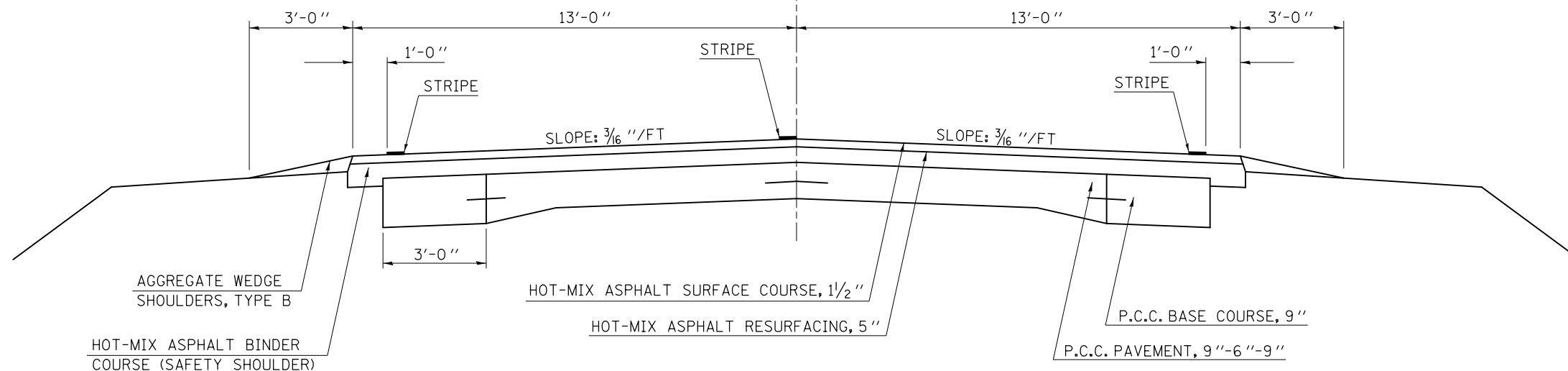

• D5 CRACK & JOINT SEAL 2012-2

| FILE NAME   | USER NAME | DESIGNED | REVISED | STATE OF ILLINOIS<br>DEPARTMENT OF TRANSPORTATION |  | TYPICAL CROSS SECTIONS                       |  | F.A. RTE.          | SECTION | COUNTY                    | TOTAL SHEETS | SHEET NO. |
|---|-----------|----------|---------|---|--|--|--|--------------------|---------|---------------------------|--------------|-----------|
| ct:\pwork\pwork\personbr\d0287987\0570933-sh1-typical.dgn | personbr  | BS       | -       |   |  | SCALE: NONE SHEET 1 OF 2 SHEETS STA. TO STA. |  | VAR.               | •       | VAR.                      | 24           | 15        |
|   |           | BBP      | -       |   |  |  |  |                    |         |                           |              |           |
|   |           |          | -       |   |  |  |  |                    |         |                           |              |           |
|   |           |          | -       |   |  |  |  |                    |         |                           |              |           |
|   |           |          | -       |   |  |  |  | CONTRACT NO. 70933 |         | ILLINOIS FED. AID PROJECT |              |           |

### 3 EXISTING TYPICAL CROSS SECTION

F.A.P. ROUTE 323 (U.S. 36)

LOCATION #4

STATION TO STATION  
 ② 1135+25.00 1144+54.00 ②

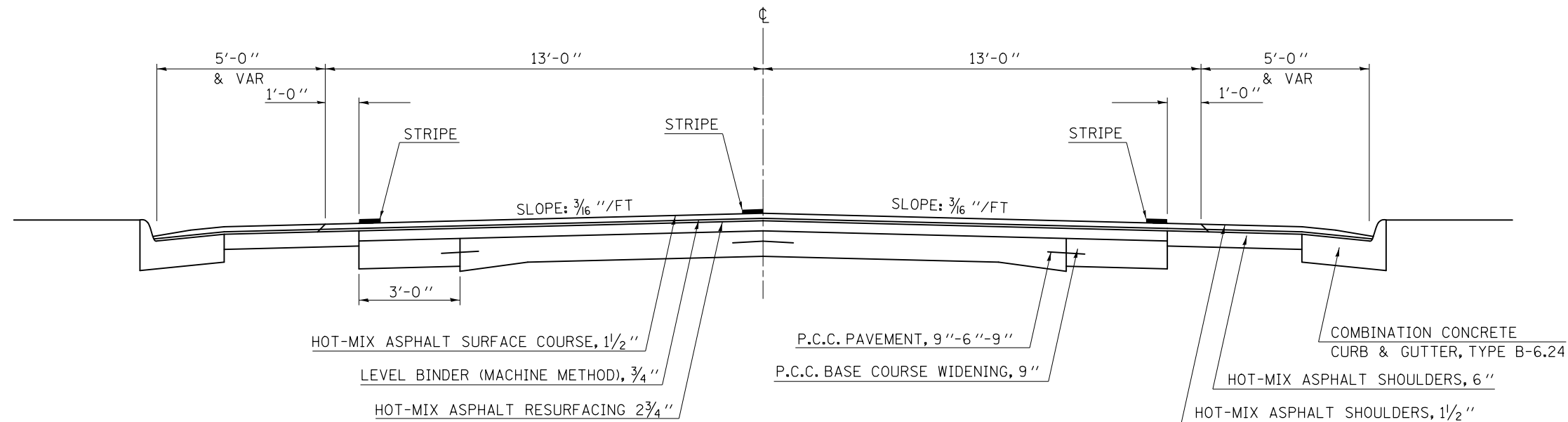

### 4 EXISTING TYPICAL CROSS SECTION

F.A.P. ROUTE 323 (U.S. 36)

LOCATION #4

STATION TO STATION  
 ② 1646+45.00 1656+55.00 ②

RAILROAD OMISSION:  
 STA. 1650+67.50 TO STA. 1651+92.50

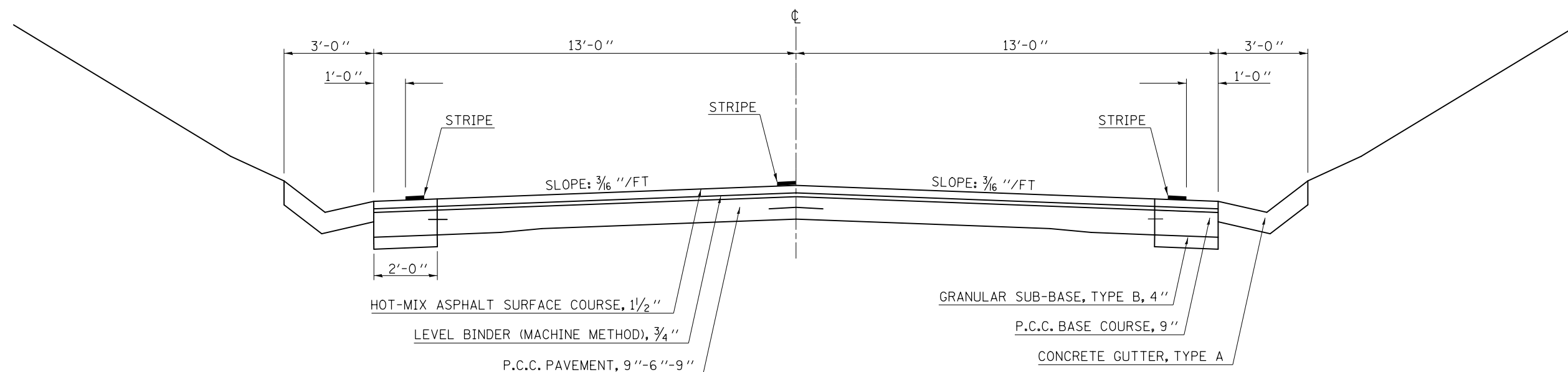

• D5 CRACK & JOINT SEAL 2012-2

|  |                             |                 |           |   |  |  |  |                    |         |                           |              |           |
|--|-----------------------------|-----------------|-----------|---|--|--|--|--------------------|---------|---------------------------|--------------|-----------|
| FILE NAME =  | USER NAME = ppersonbr       | DESIGNED - BS   | REVISED - | <b>STATE OF ILLINOIS<br/>DEPARTMENT OF TRANSPORTATION</b> | <b>TYPICAL CROSS SECTIONS</b>                |  |  | F.A. RTE.          | SECTION | COUNTY                    | TOTAL SHEETS | SHEET NO. |
| c:\pwork\work\pwork\personbr\d0287987\0570933-sh-typical.dgn | PLOT SCALE = 40.0000' / in. | DRAWN - BBP     | REVISED - |   |  |  |  | VAR.               |         |                           | 24           | 16        |
|  | PLOT DATE = 1/27/2012       | CHECKED -       | REVISED - |   | SCALE: NONE SHEET 2 OF 2 SHEETS STA. TO STA. |  |  | CONTRACT NO. 70933 |         | ILLINOIS FED. AID PROJECT |              |           |
|  |                             | DATE - 01/11/12 | REVISED - |   |  |  |  |                    |         |                           |              |           |



# SCHEDULE OF QUANTITIES

|                 | LOCATION OF WORK:                               | LOCATION #1                             | LOCATION #2                              | LOCATION #2                              | LOCATION #2   | LOCATION #3                              | LOCATION #4                             |
|-----------------|---|---|--|--|---|--|---|
|                 |   | FAI 57<br>(I-57)                        | FAI 72<br>(I-72)                         | FAI 72<br>(I-72)                         | FAI 72<br>(I-72)  | FAP 323<br>(US36)                        | FAP 323<br>(US36)                       |
|                 |   | STA. 1386+91.00<br>TO<br>STA. 547+00.00 | STA. 1376+84.00<br>TO<br>STA. 1518+02.71 | STA. 1518+02.71<br>TO<br>STA. 1764+26.00 | STA. 1764+26.00<br>TO<br>STA. 2041+32.00 EB<br>STA. 2038+78.00 WB | STA. 1681+95.00<br>TO<br>STA. 2081+75.87 | STA. 932+29.05<br>TO<br>STA. 1681+95.00 |
|                 | COUNTY:   | DOUGLAS<br>RURAL                        | PIATT<br>RURAL                           | CHAMPAIGN<br>RURAL                       | CHAMPAIGN<br>URBAN  | EDGAR<br>RURAL                           | EDGAR<br>RURAL                          |
| <u>CODE NO.</u> | <u>ITEM</u>                                     | <u>UNIT</u>                             | <u>QUANTITY</u>                          | <u>QUANTITY</u>                          | <u>QUANTITY</u>   | <u>QUANTITY</u>                          | <u>QUANTITY</u>                         |
| 45100100        | CRACK ROUTING (PAVEMENT)                        | FOOT                                    | 115464.0                                 | 30805.0                                  | 55848.0   | 60400.0                                  | 44150.0                                 |
| 45100200        | CRACK FILLING                                   | POUND                                   | 46186.0                                  | 12322.0                                  | 22339.0   | 24160.0                                  | 17660.0                                 |
| 67100100        | MOBILIZATION                                    | L SUM                                   | 0.2                                      | 0.2                                      | 0.2   | 0.2                                      | 0.1                                     |
| 70100420        | TRAFFIC CONTROL AND PROTECTION, STANDARD 701411 | EACH                                    | 8.0                                      | 0.0                                      | 8.0   | 8.0                                      | 0.0                                     |
| 70100460        | TRAFFIC CONTROL AND PROTECTION, STANDARD 701306 | L SUM                                   | 0.0                                      | 0.0                                      | 0.0   | 0.0                                      | 0.5                                     |
| 70100700        | TRAFFIC CONTROL AND PROTECTION, STANDARD 701406 | L SUM                                   | 0.4                                      | 0.2                                      | 0.2   | 0.2                                      | 0.0                                     |
| 70102630        | TRAFFIC CONTROL AND PROTECTION, STANDARD 701601 | L SUM                                   | 0.0                                      | 0.0                                      | 0.0   | 1.0                                      | 0.0                                     |
| 78001110        | PAINT PAVEMENT MARKING - LINE 4"                | FOOT                                    | 0.0                                      | 0.0                                      | 0.0   | 0.0                                      | 10000.0                                 |
| X7015005        | CHANGEABLE MESSAGE SIGN                         | CAL DA                                  | 6.0                                      | 3.0                                      | 0.0   | 3.0                                      | 0.0                                     |

• D5 CRACK & JOINT SEAL 2012-2

|   |                        |               |           |   |                               |                    |                     |        |              |                           |  |
|---|------------------------|---------------|-----------|---|-------------------------------|--------------------|---------------------|--------|--------------|---------------------------|--|
| FILE NAME =   | USER NAME = ceerlockjd | DESIGNED - BS | REVISED - | <b>STATE OF ILLINOIS<br/>DEPARTMENT OF TRANSPORTATION</b> | <b>SCHEDULE OF QUANTITIES</b> | F.A. RTE.          | SECTION             | COUNTY | TOTAL SHEETS | SHEET NO.                 |  |
| et:\pwork\pwork\ceerlockjd\0287987\0570933-sht-schedule.dgn | DRAWN - BBP            | REVISIED -    |           |   |                               | VAR.               | •                   | VAR.   | 24           | 17                        |  |
| PLOT SCALE = 40.0000' / in.                                 | CHECKED -              | REVISIED -    |           |   |                               | CONTRACT NO. 70933 |                     |        |              |                           |  |
| PLOT DATE = 1/30/2012                                       | DATE - 01/14/12        | REVISIED -    |           |   |                               | SCALE: NONE        | SHEET 1 OF 1 SHEETS | STA.   | TO STA.      | ILLINOIS FED. AID PROJECT |  |

### HMA PAVEMENT

(USE PAY ITEMS : 45100100 CRACK ROUTING (PAVEMENT)  
AND 45100200 CRACK FILLING)

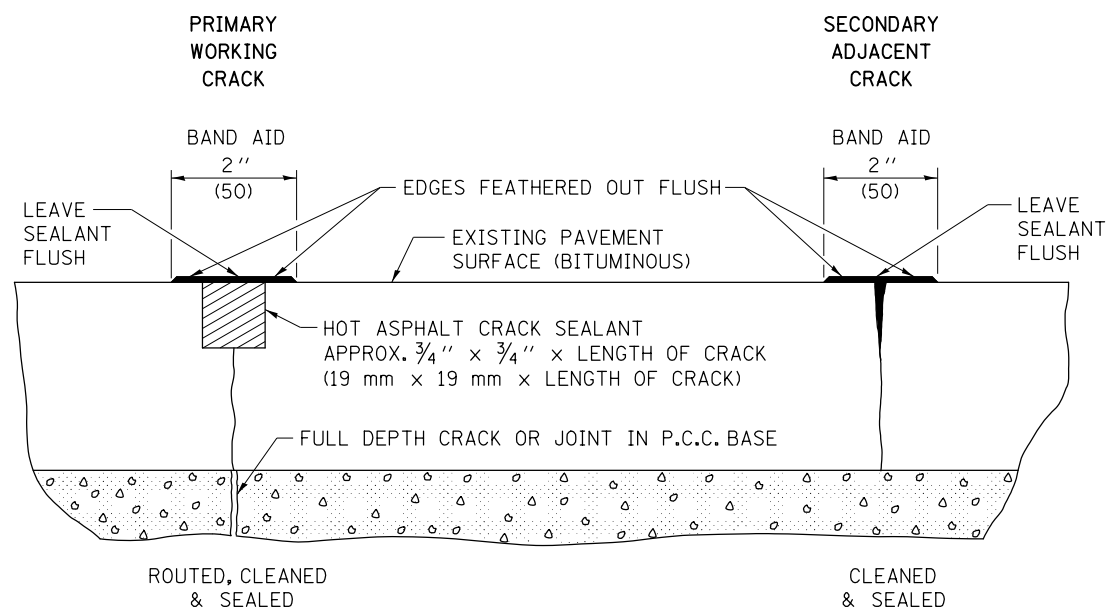

### PCC PAVEMENT

(USE PAY ITEMS : 45200100 JOINT OR CRACK ROUTING (P.C.C. PAVEMENT & SHOULDER)  
AND 45200300 JOINT OR CRACK FILLING)

#### TRANSVERSE CRACKS AND JOINTS AND CENTERLINE JOINT

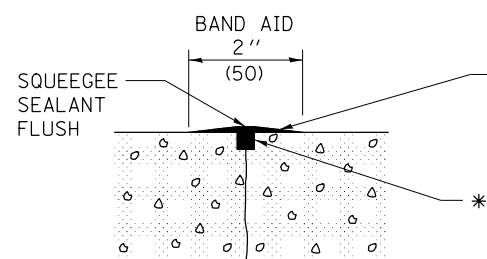

#### LONGITUDINAL SHOULDER JOINT

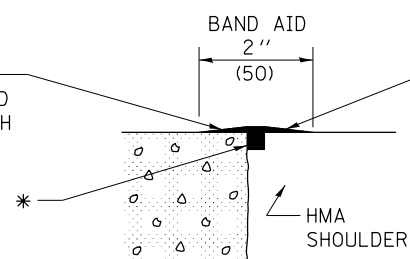

#### ANY WIDE LONGITUDINAL JOINT OR CRACK

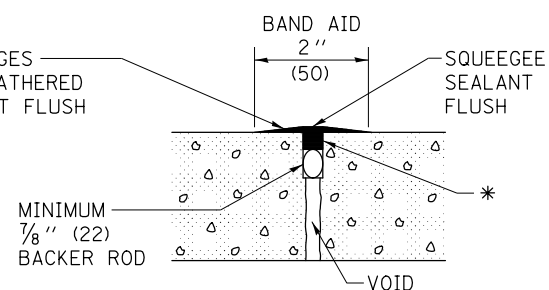

\* HOT ASPHALT CRACK SEALANT APPROX. 3/4" x 3/4" x LENGTH OF CRACK. ACTUAL QUANTITY WILL VARY AS NEEDED FOR PRIMARY OR SECONDARY WORKING CRACK.

#### LONGITUDINAL RANDOM CRACK

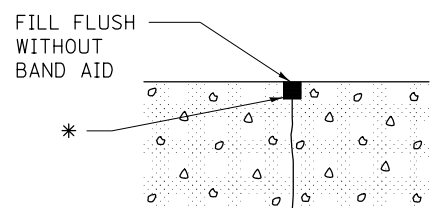

#### TRANSVERSE EXPANSION JOINT

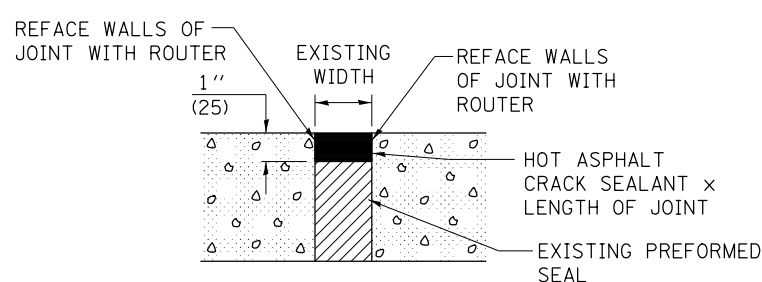

• D5 CRACK & JOINT SEAL 2012-2

Note: All dimensions are in INCHES (millimeters) unless otherwise shown.

### DISTRICT 5 DETAIL NO. 45AAAAAA

|   |                             |            |                 |
|---|-----------------------------|------------|-----------------|
| FILE NAME =   | USER NAME = ppersonbr       | DESIGNED - | REVISED - 12/06 |
| ct:\pw\work\p\dot\personbr\d0287987\0570933-sh1-details.dgn |                             | DRAWN -    | REVISED - 08/07 |
|   | PLOT SCALE = 40.0000' / in. | CHECKED -  | REVISED - 12/08 |
|   | PLOT DATE = 1/27/2012       | DATE -     | REVISED -       |

STATE OF ILLINOIS  
DEPARTMENT OF TRANSPORTATION

CRACK AND JOINT SEALING

SCALE: SHEET NO. OF SHEETS STA. TO STA.

| F.A. RTE.                                     | SECTION | COUNTY | TOTAL SHEETS | SHEET NO. |
|---|---------|--------|--------------|-----------|
| VAR.  | •       | VAR.   | 24           | 18        |
| CONTRACT NO. 70933                            |         |        |              |           |
| FED. ROAD DIST. NO. ILLINOIS FED. AID PROJECT |         |        |              |           |

**APPLICATION NO. 1  
DAY OPERATION ONLY  
PARTIAL RAMP CLOSURE**

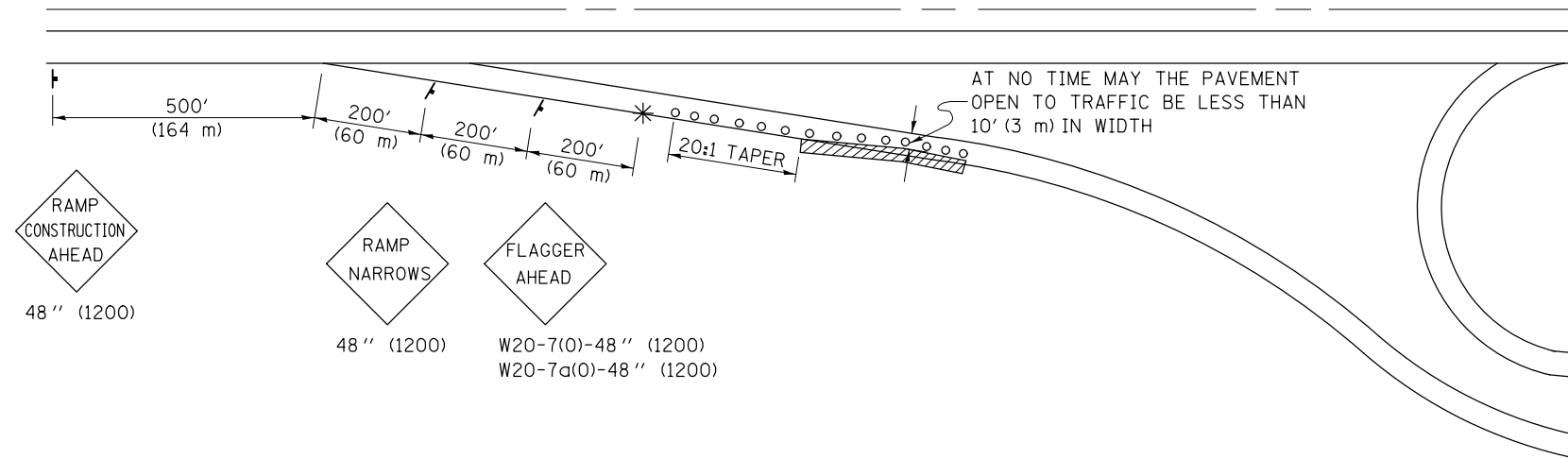

**GENERAL NOTES**

CONSTRUCTION OPERATIONS SHALL BE CONFINED TO AN AREA NARROW ENOUGH THAT A MINIMUM OF 10' (3 m) OF PAVEMENT SHALL BE OPEN TO TRAFFIC AT ALL TIMES.

FULL WIDTH PAVEMENT ON THE RAMPS SHALL BE OPEN TO TRAFFIC AT NIGHT.

WHEN NO WORK IS BEING PERFORMED, THE FLAGGER WILL NOT BE REQUIRED. IF THE FLAGGER IS NOT PRESENT, THE FLAGGER SIGNS SHALL BE REMOVED OR COVERED.

ALL SIGNS SHALL BE POST MOUNTED IF WORK IN THE AREA EXCEEDS FOUR DAYS OF DAYTIME OPERATIONS.

LONGITUDINAL DIMENSIONS MAY BE ADJUSTED SLIGHTLY TO FIT FIELD CONDITIONS.

ALL VEHICLES, EQUIPMENT, WORKERS (EXCEPT FLAGGER) AND THEIR ACTIVITIES ARE RESTRICTED AT ALL TIMES TO ONE SIDE OF THE PAVEMENT UNLESS OTHERWISE AUTHORIZED BY THE DISTRICT ENGINEER.

**SYMBOLS**

- (APPLICATION NO. 1) TYPE I OR II BARRICADES OR DRUMS @ 50' (15 m) CTS.
- ⊗ (APPLICATION NO. 2) TYPE I OR II BARRICADES OR DRUMS @ 25' (7.5 m) CTS. W/STEADY BURNING LIGHTS
- \* (APPLICATION NO. 1) FLAGGER PLACED AS DIRECTED BY THE ENGINEER
- † SIGN ON PORTABLE OR PERMANENT SUPPORT
- ▨ WORK AREA

**TYPICAL APPLICATIONS**

- PAVEMENT PATCHING
- PIPE UNDERDRAINS
- HMA RESURFACING

Traffic Control for all ramps shall be in accordance with the appropriate application of plan detail **TRAFFIC CONTROL FOR RAMPS** and will not be paid for separately, but shall be included in the contract lump sum prices for Traffic Control and Protection, Standard 701401 and Traffic Control and Protection, Standard 701406.

**APPLICATION NO. 2  
RAMP CLOSURE**

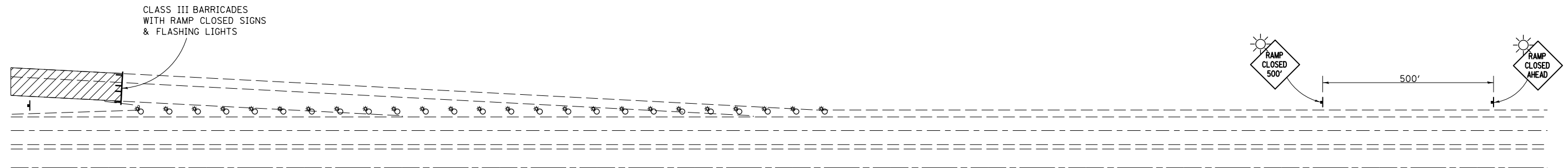

**GENERAL NOTES**

STEADY BURN LIGHTS ARE NOT REQUIRED FOR DAYTIME OPERATIONS.

CONTACT THE DISTRICT TRAFFIC OPERATIONS ENGINEER AT 217-465-4181, ONE WEEK PRIOR TO CLOSING THE RAMP.

• D5 CRACK & JOINT SEAL 2012-2

Note: All dimensions are in INCHES (millimeters) unless otherwise shown.

**DISTRICT 5 DETAIL NO. 70103710**

|   |                             |            |                 |
|---|-----------------------------|------------|-----------------|
| FILE NAME =   | USER NAME = ppersonbr       | DESIGNED - | REVISED - 11/06 |
| et:\pw\work\p\idot\ppersonbr\d0287987\0570933-sh1-details.dgn |                             | DRAWN -    | REVISED -       |
|   | PLOT SCALE = 48.0000' / in. | CHECKED -  | REVISED -       |
|   | PLOT DATE = 1/27/2012       | DATE -     | REVISED -       |

**STATE OF ILLINOIS  
DEPARTMENT OF TRANSPORTATION**

**TRAFFIC CONTROL FOR RAMPS**

SCALE: SHEET NO. OF SHEETS STA. TO STA.

|                     |          |                  |              |           |
|---------------------|----------|------------------|--------------|-----------|
| F.A. RTE.           | SECTION  | COUNTY           | TOTAL SHEETS | SHEET NO. |
| VAR                 | •        | VAR.             | 24           | 19        |
| CONTRACT NO. 70933  |          |                  |              |           |
| FED. ROAD DIST. NO. | ILLINOIS | FED. AID PROJECT |              |           |

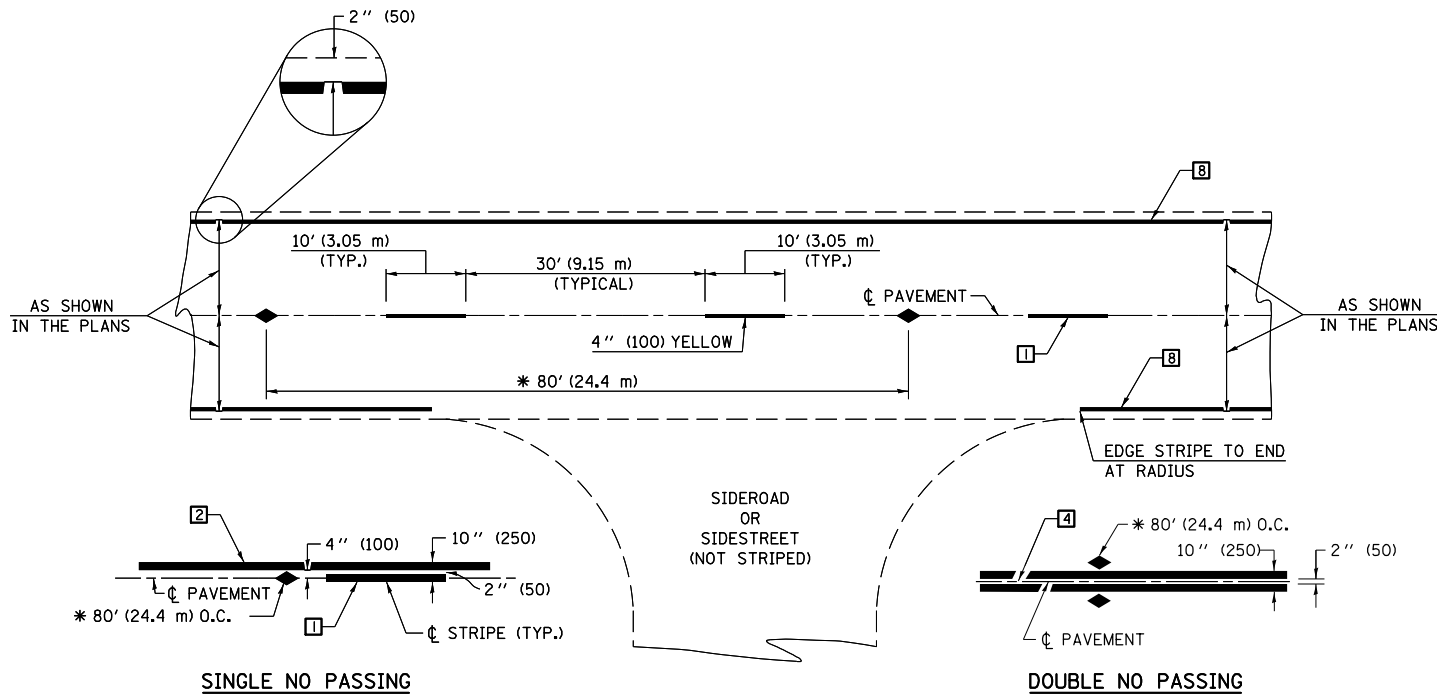

\* REDUCE TO 40' (12.2 m) O.C. ON CURVES WITH POSTED OR ADVISORY SPEEDS OF 45 mph (70 km/h) OR LESS.

**TWO LANE/TWO WAY**

**TYPICAL PAVEMENT MARKING LEGEND**

- 1 4" (100) SKIP-DASH (YELLOW)
- 2 4" (100) SOLID (YELLOW)
- 3 12" (300) DIAGONAL (YELLOW)
- 4 4" (100) DOUBLE YELLOW (NARROW)
- 5 RESERVED
- 6 RESERVED
- 7 4" (100) SKIP-DASH (WHITE)
- 8 4" (100) SOLID (WHITE)
- 9 12" (300) DIAGONAL (WHITE)
- 10 6" (150) SOLID (WHITE)
- 11 24" (600) STOP BAR (WHITE)
- 12 8" (200) SOLID (WHITE)
- 13 4" (100) LANE LINE EXTENSIONS (WHITE)
- 14 4" (100) PARKING WHITE

**TYPICAL PAVEMENT MARKERS LEGEND**

- ◆ TWO-WAY AMBER MARKER
- ▶ ONE-WAY AMBER MARKER
- ▷ ONE-WAY CRYSTAL MARKER

**RURAL LEFT TURN**

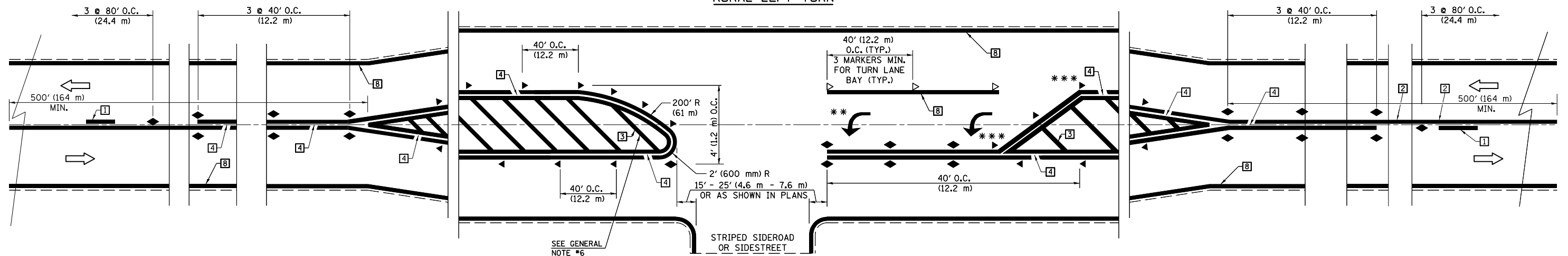

\*\*\* REDUCE SPACING IF NECESSARY TO ASSURE MARKERS AT CORNER POINTS.

\*\* TURN ARROWS SHALL BE PLACED AS SHOWN ON SHEET #2.

• D5 CRACK & JOINT SEAL 2012-2

Note: All dimensions are in INCHES (millimeters) unless otherwise shown.

**DISTRICT 5 DETAIL NO. 7800AAA**

|  |                             |            |                         |
|--|-----------------------------|------------|-------------------------|
| FILE NAME =  | USER NAME = ppersonbr       | DESIGNED - | REVISED - 11/06         |
| et:\pwork\pwork\personbr\d0287987\050933-sh1-details.dgn |                             | DRAWN -    | REVISED - 09/2009 - KJT |
|  | PLOT SCALE = 48.0000' / in. | CHECKED -  | REVISED -               |
|  | PLOT DATE = 1/27/2012       | DATE -     | REVISED -               |

**STATE OF ILLINOIS  
DEPARTMENT OF TRANSPORTATION**

**PAVEMENT MARKING AND MARKERS  
(RURAL & URBAN APPLICATIONS)**

SCALE: SHEET NO. 1 OF 4 SHEETS STA. TO STA.

| F.A. RTE.                                     | SECTION | COUNTY | TOTAL SHEETS | SHEET NO. |
|---|---------|--------|--------------|-----------|
| VAR.  | •       | VAR.   | 24           | 20        |
| CONTRACT NO. 70933                            |         |        |              |           |
| FED. ROAD DIST. NO. ILLINOIS FED. AID PROJECT |         |        |              |           |

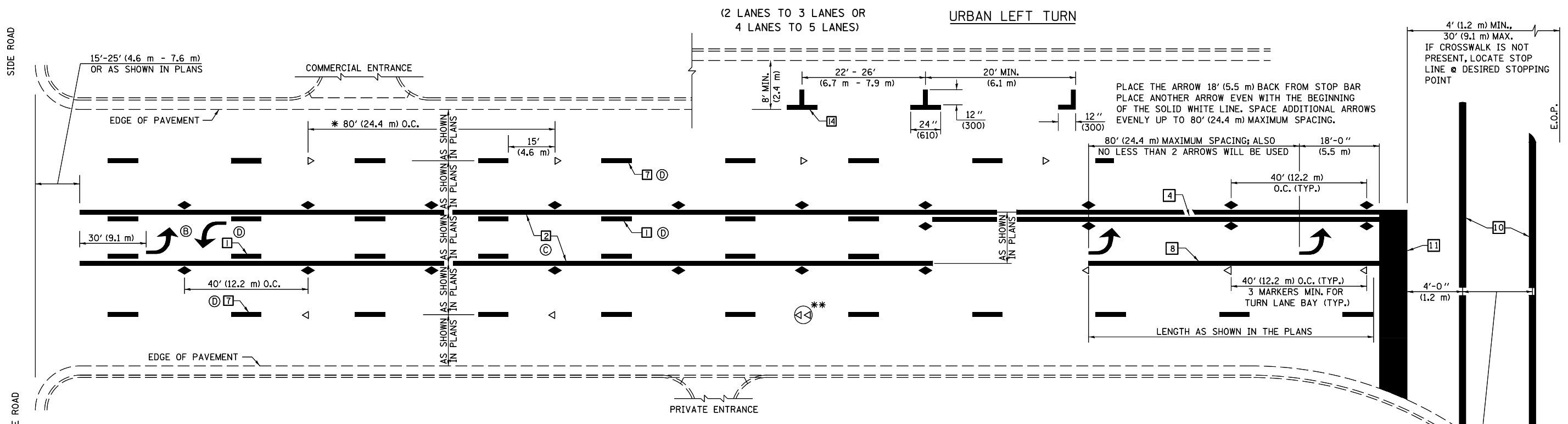

\* REDUCE TO 40 FEET (12.2 METERS) ON CENTER ON CURVES WHERE ADVISORY SPEEDS ARE 10 MPH (15 km/h) LOWER THAN POSTED SPEEDS.

\*\* DOUBLE LANE LINE MARKERS SHALL BE SPECIFIED AND SPACED AS SHOWN IN HIGHWAY STANDARD 781001 FOR MULTI-LANE DIVIDED AND UNDIVIDED HIGHWAYS.

- GENERAL NOTES:**
- ⓑ TURN ARROW PAIRS SHALL BE PLACED AT 250' (75 m) INTERVALS AND SHALL BE EVENLY SPACED BETWEEN BOTH ENDS OF THE BIDIRECTIONAL LEFT TURN LANE.
  - ⓒ THE SOLID YELLOW PAVEMENT MARKINGS [2] SHOULD GENERALLY START OR END NEAR THE RADIUS POINT OF EACH STREET RETURN EXCEPT WHERE ONE OR BOTH ENDS WOULD INCLUDE STOP BARS.
  - ⓓ THE SKIP-DASH PAVEMENT MARKINGS [1] OR [7] SHOULD BE CENTERED BETWEEN BOTH ENDS OF EACH CITY BLOCK AND SHALL BE PLACED SO THEY LINE UP ACROSS FROM EACH OTHER. SEE EXAMPLE ON SHEET 2 OF 3.
  - ⓔ USE LARGE ARROW SIZE FOR BOTH RURAL AND URBAN LOCATIONS. (SEE LAST PAGE OF SECTION 780x FOR SYMBOLS TABLE)

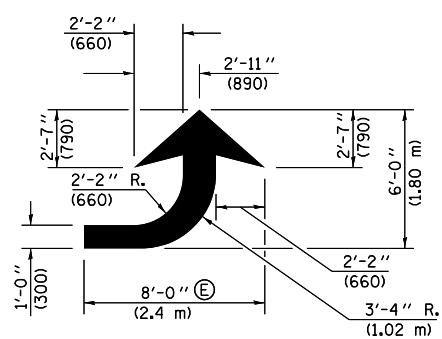

**LEFT ARROW**

REVERSE FOR RIGHT ARROW  
 AREA = 15.6 SQ. FT. (1.47 m<sup>2</sup>)  
 (WHITE)

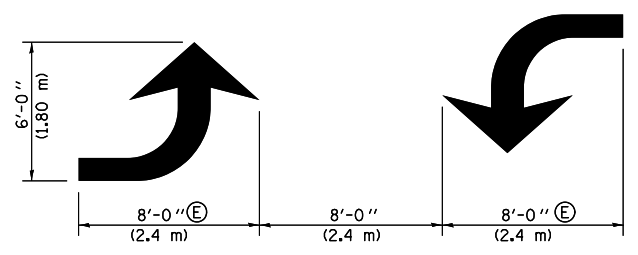

**TYPICAL DOUBLE TURN ARROWS (WHITE)**

**BLOOMINGTON-NORMAL CITY LIMITS ONLY**

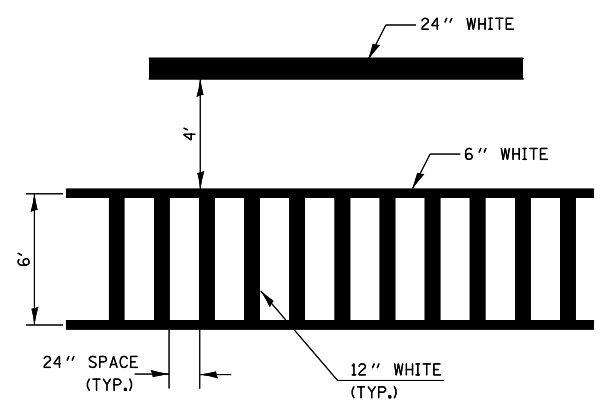

**TYPICAL SPACING FOR CROSSWALKS & STOP BARS**

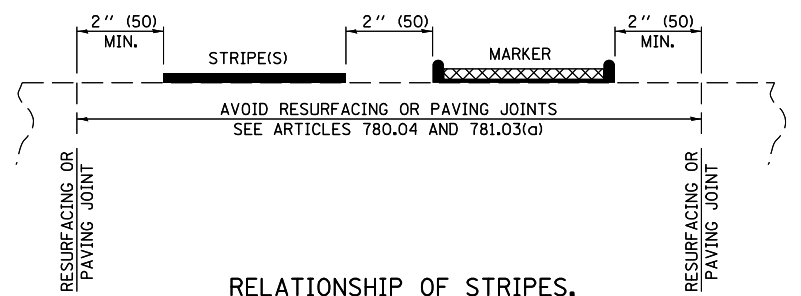

**RELATIONSHIP OF STRIPES, MARKERS AND JOINTS**

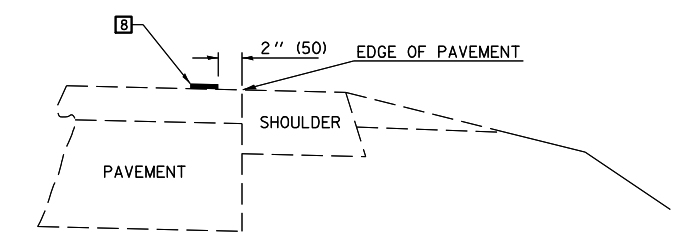

**RELATIONSHIP OF EDGE LINE TO EDGE OF PAVEMENT (SAFETY SHOULDER OR PAVED SURFACE) SEE ARTICLE 780.04**

• D5 CRACK & JOINT SEAL 2012-2

Note: All dimensions are in INCHES (millimeters) unless otherwise shown.

**DISTRICT 5 DETAIL NO. 7800AAA**

|  |                             |            |                         |   |  |              |  |                     |          |                  |              |           |
|--|-----------------------------|------------|-------------------------|---|--|--------------|--|---------------------|----------|------------------|--------------|-----------|
| FILE NAME =  | USER NAME = ppersonbr       | DESIGNED - | REVISED - 11/06         | <b>STATE OF ILLINOIS<br/>DEPARTMENT OF TRANSPORTATION</b> | <b>PAVEMENT MARKING AND MARKERS<br/>(RURAL &amp; URBAN APPLICATIONS)</b> |              |  | F.A. RTE.           | SECTION  | COUNTY           | TOTAL SHEETS | SHEET NO. |
| ci:\pw\work\p\pidot\ppersonbr\d0287987\0578933-sh1-details.dgn |                             | DRAWN -    | REVISED - 09/2009 - KJT |   |  |              |  | VAR.                | •        | VAR.             | 24           | 21        |
|  |                             | CHECKED -  | REVISED -               |   |  |              |  | CONTRACT NO. 70933  |          |                  |              |           |
|  |                             | DATE -     | REVISED -               |   |  |              |  | FED. ROAD DIST. NO. | ILLINOIS | FED. AID PROJECT |              |           |
|  | PLOT SCALE = 48.0000' / in. |            |                         | SCALE:  | SHEET NO. 2 OF 4 SHEETS  | STA. TO STA. |  |                     |          |                  |              |           |

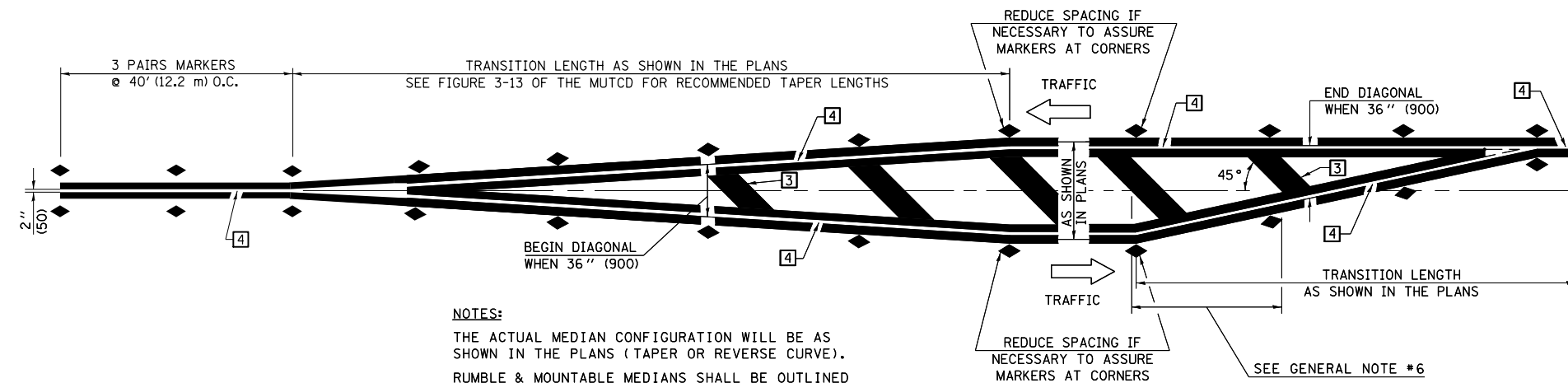

**NOTES:**  
 THE ACTUAL MEDIAN CONFIGURATION WILL BE AS SHOWN IN THE PLANS (TAPER OR REVERSE CURVE).  
 RUMBLE & MOUNTABLE MEDIANS SHALL BE OUTLINED WITH [2].

**TYPICAL MEDIAN TRANSITIONS**

**GENERAL NOTES**

1. WHEN MEDIANS ARE PRESENT, PAVEMENT MARKINGS ARE TO BE PLACED ADJACENT TO MEDIANS.
2. SOME OF THE INFORMATION INCLUDED WITH THIS DETAIL MAY NOT BE APPLICABLE TO THIS IMPROVEMENT.
3. PAVEMENT MARKINGS ARE TO BE EXTENDED THROUGH OMISSIONS WHEN APPLICABLE.
4. A STRIPING KEY IS AVAILABLE ELSEWHERE AND SHALL BE SHOWN WHERE THE QUANTITIES ARE LISTED.
5. FINAL PAVEMENT MARKINGS SHALL BE IN PLACE PRIOR TO PLACING ANY RAISED REFLECTIVE PAVEMENT MARKERS.
6. THE FOLLOWING CRITERIA SHALL BE USED FOR SELECTING THE DIAGONAL PAVEMENT MARKING SPACING,  
 < 30 MPH USE 15' (< 50 km/h USE 4.5 m)  
 30-45 MPH USE 20' (50-75 km/h USE 6.0 m)  
 > 45 MPH USE 30' (> 75 km/h USE 9.0 m)

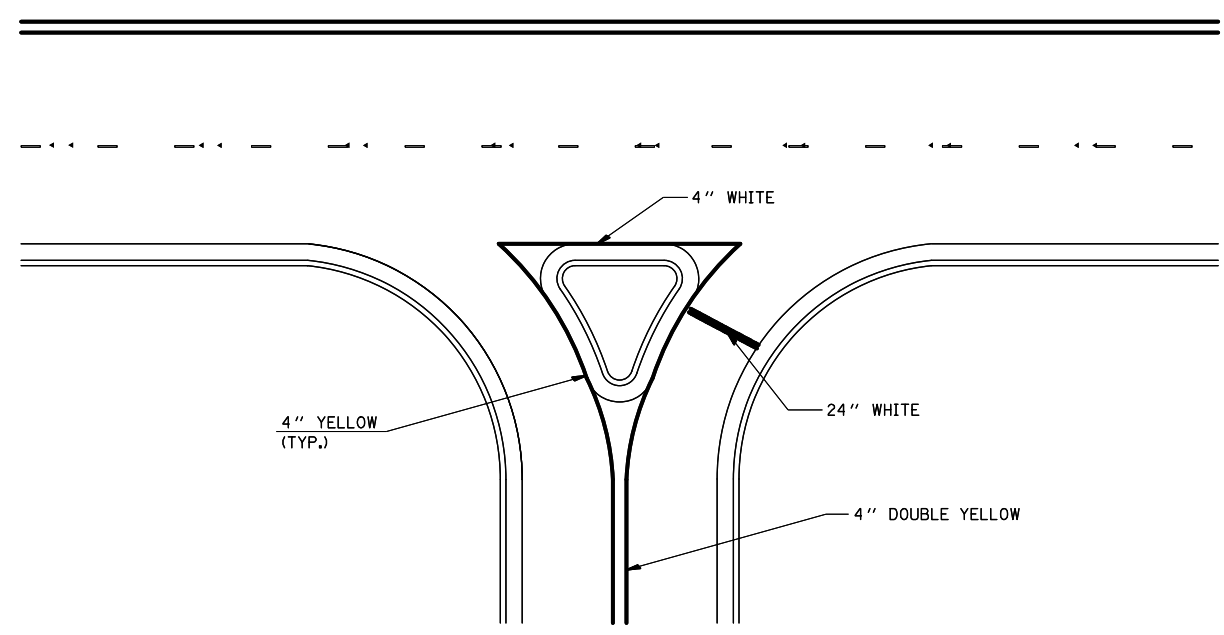

**RIGHT IN - RIGHT OUT ACCESS**

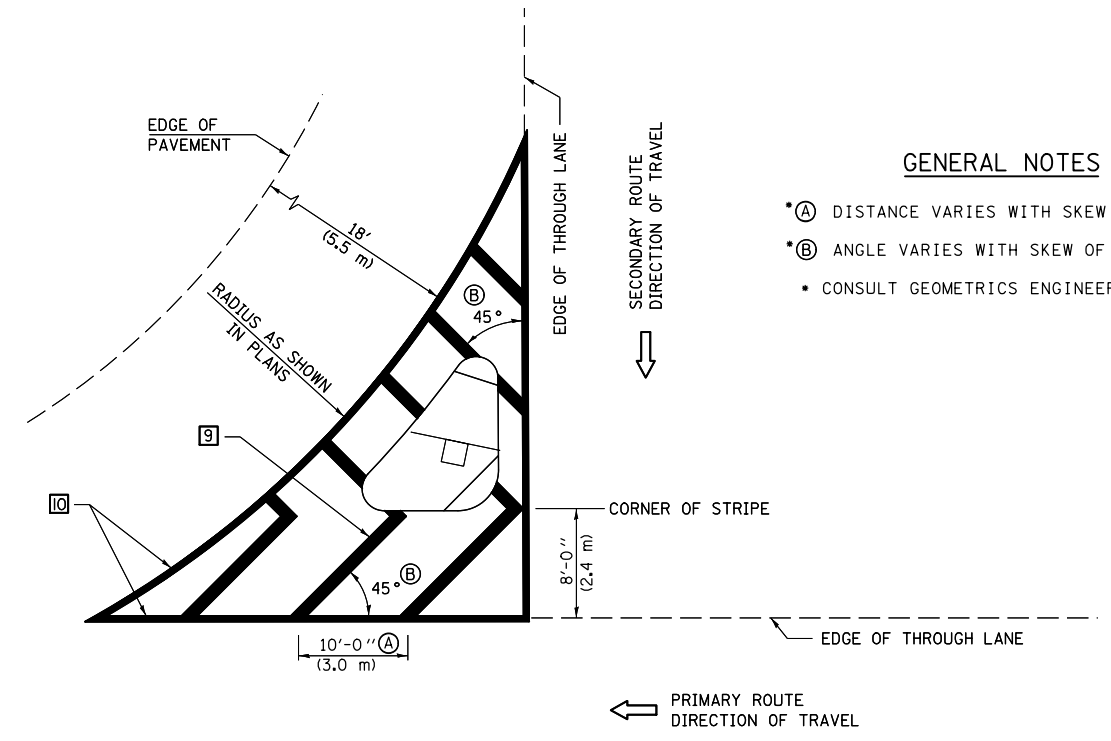

**GENERAL NOTES**

- (A) DISTANCE VARIES WITH SKEW OF INTERSECTION.
- (B) ANGLE VARIES WITH SKEW OF INTERSECTION.
- CONSULT GEOMETRICS ENGINEER

**ISLAND**

• D5 CRACK & JOINT SEAL 2012-2

Note: All dimensions are in INCHES (millimeters) unless otherwise shown.

**DISTRICT 5 DETAIL NO. 7800AAA**

|  |                             |            |                         |
|--|-----------------------------|------------|-------------------------|
| FILE NAME =  | USER NAME = ppersonbr       | DESIGNED - | REVISED - 11/06         |
| et:\pw\work\p\pidot\ppersonbr\d0287987\0570933-sh1-details.dgn |                             | DRAWN -    | REVISED - 09/2009 - KJT |
|  | PLOT SCALE = 40.0000' / in. | CHECKED -  | REVISED -               |
|  | PLOT DATE = 1/27/2012       | DATE -     | REVISED -               |

**STATE OF ILLINOIS  
 DEPARTMENT OF TRANSPORTATION**

**PAVEMENT MARKING AND MARKERS  
 (RURAL & URBAN APPLICATIONS)**

SCALE: SHEET NO. 3 OF 4 SHEETS STA. TO STA.

| F.A. RTE.           | SECTION | COUNTY                    | TOTAL SHEETS | SHEET NO. |
|---------------------|---------|---------------------------|--------------|-----------|
| VAR.                | •       | VAR.                      | 24           | 22        |
| CONTRACT NO. 70933  |         |                           |              |           |
| FED. ROAD DIST. NO. |         | ILLINOIS FED. AID PROJECT |              |           |

RAILROAD CROSSING WITH INTERCONNECT ONLY

RAILROAD CROSSING WITH INTERCONNECT AND PRE-SIGNALS

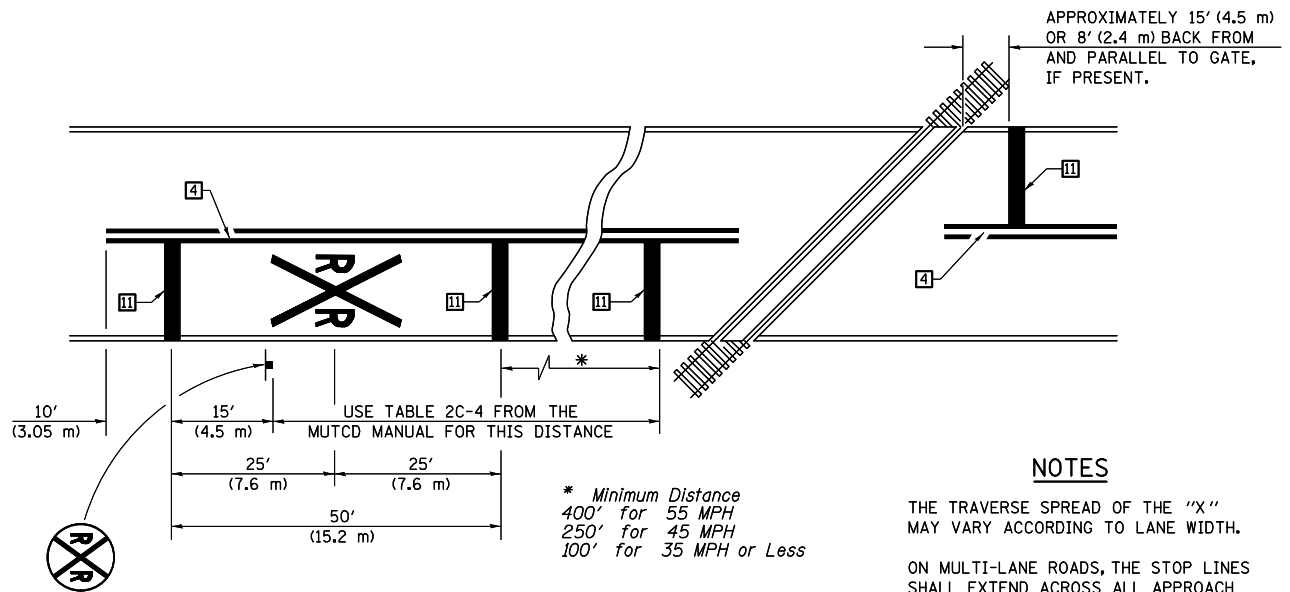

PAVEMENT MARKINGS AT RAILROAD-HIGHWAY GRADE CROSSING

NOTES

APPROXIMATELY 15' (4.5 m) OR 8' (2.4 m) BACK FROM AND PARALLEL TO GATE, IF PRESENT.

THE TRAVERSE SPREAD OF THE "X" MAY VARY ACCORDING TO LANE WIDTH.

ON MULTI-LANE ROADS, THE STOP LINES SHALL EXTEND ACROSS ALL APPROACH LANES AND SEPARATE RXR SYMBOLS SHALL BE PLACED ADJACENT TO EACH OTHER IN EACH LANE.

WHEN THE PAVEMENT MARKING SYMBOL IS USED, A PORTION OF THE SYMBOL SHOULD BE LOCATED DIRECTLY ADJACENT TO THE ADVANCE WARNING SIGN (W10-1) AS PLACED BY TABLE II-1, CONDITION B OF THE MUTCD.

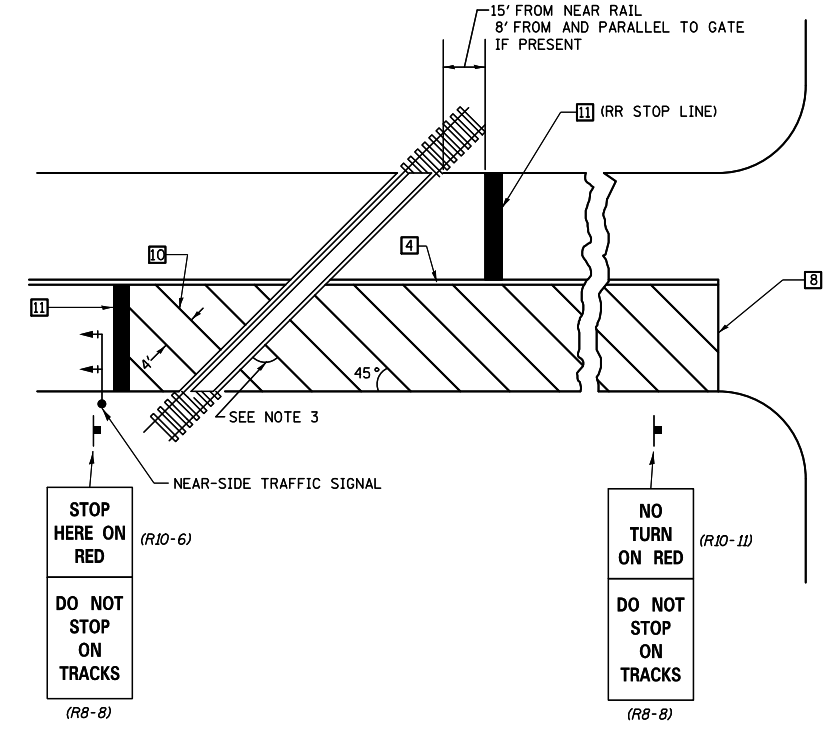
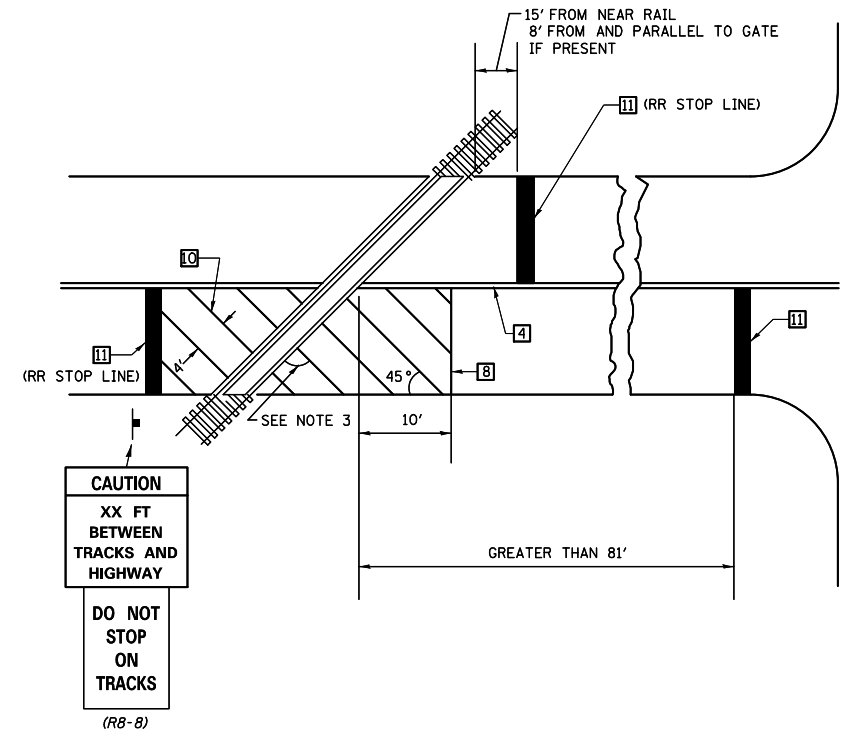

SUPPLEMENTAL PAVEMENT MARKING TREATMENT FOR RAILROAD-HIGHWAY GRADE CROSSING

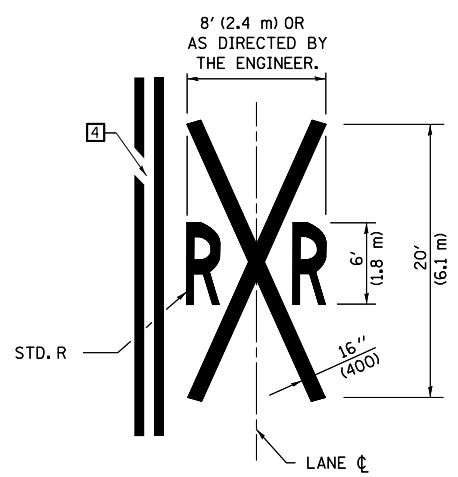

GENERAL NOTES

- SUPPLEMENTAL PAVEMENT MARKINGS TO BE INSTALLED ONLY ON APPROACHES TO INTERSECTIONS CONTROLLED BY TRAFFIC SIGNALS WHICH ARE INTERCONNECTED WITH THE RAILROAD WARNING SIGNALS.
- EXTEND PAVEMENT MARKINGS TO THE INTERSECTION ONLY WHERE NEAR-SIDE TRAFFIC SIGNALS ARE USED.
- WHERE THE ANGLE BETWEEN THE DIAGONAL PAVEMENT MARKINGS AND THE TRACK WOULD BE LESS THAN 20°, THE PAVEMENT MARKINGS SHOULD BE PLACED IN THE OPPOSITE DIRECTION FROM THAT SHOWN.

• D5 CRACK & JOINT SEAL 2012-2

Note: All dimensions are in INCHES (millimeters) unless otherwise shown.

DISTRICT 5 DETAIL NO. 7800AAA

|   |                             |            |                         |
|---|-----------------------------|------------|-------------------------|
| FILE NAME =   | USER NAME = ppersonbr       | DESIGNED - | REVISED - 11/06         |
| et:\pw\work\p\idot\ppersonbr\d0287987\0570933-sh1-details.dgn |                             | DRAWN -    | REVISED - 09/2009 - KJT |
|   | PLOT SCALE = 40.0000' / in. | CHECKED -  | REVISED -               |
|   | PLOT DATE = 1/27/2012       | DATE -     | REVISED -               |

STATE OF ILLINOIS  
DEPARTMENT OF TRANSPORTATION

PAVEMENT MARKING AND MARKERS  
(RURAL & URBAN APPLICATIONS)

SCALE: SHEET NO. 4 OF 4 SHEETS STA. TO STA.

| F.A. RTE.           | SECTION | COUNTY | TOTAL SHEETS              | SHEET NO. |
|---------------------|---------|--------|---------------------------|-----------|
| VAR.                | •       | VAR.   | 24                        | 23        |
| FED. ROAD DIST. NO. |         |        | ILLINOIS FED. AID PROJECT |           |

CENTERLINE INTERSTATE OR MULTI-LANE TWO WAY DIVIDED HIGHWAY

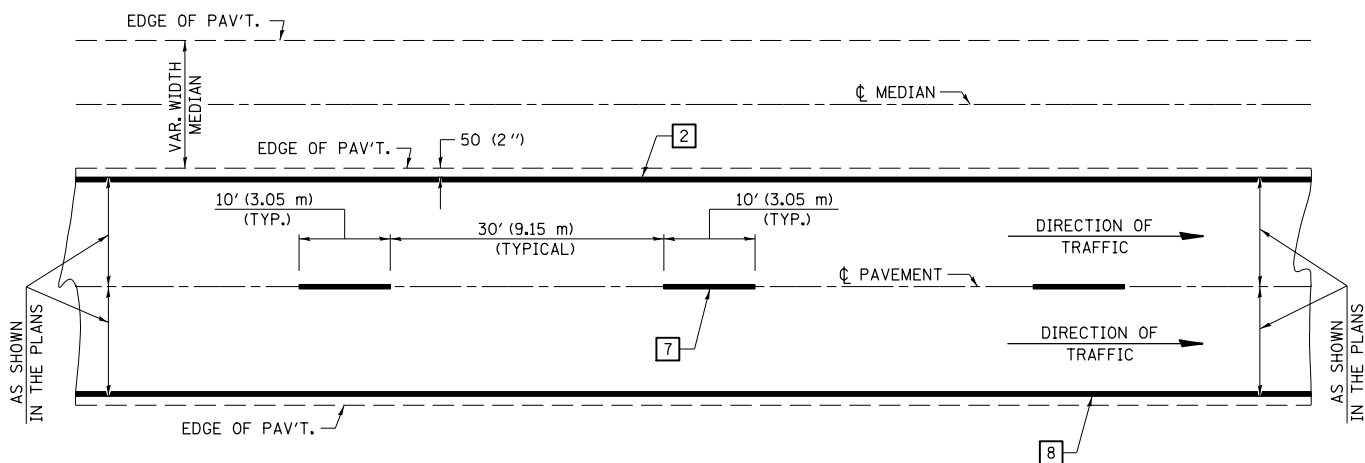

NOTE: PAVEMENT MARKINGS ARE TO BE EXTENDED THROUGH OMISSIONS WHEN APPLICABLE.

NOTE: SEE ARTICLES 780.04 & 781.03 FOR LOCATION OF STRIPES AND MARKERS RELATIVE TO EDGES OR JOINTS.

FOR RAISED REFLECTIVE PAVEMENT MARKERS, REFER TO STANDARD 781001.

TYPICAL EXIT RAMP TERMINAL

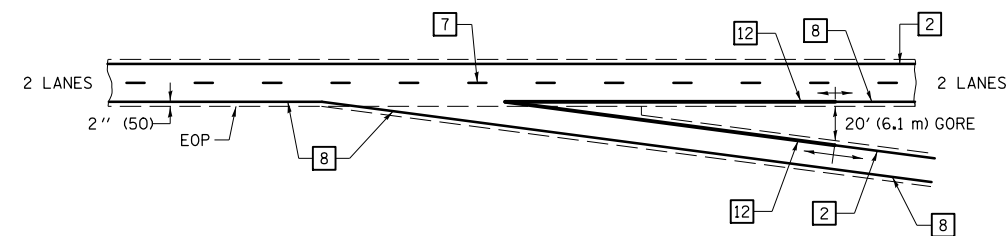

EXIT RAMP TERMINAL with EXCLUSIVE (auxiliary) LANE

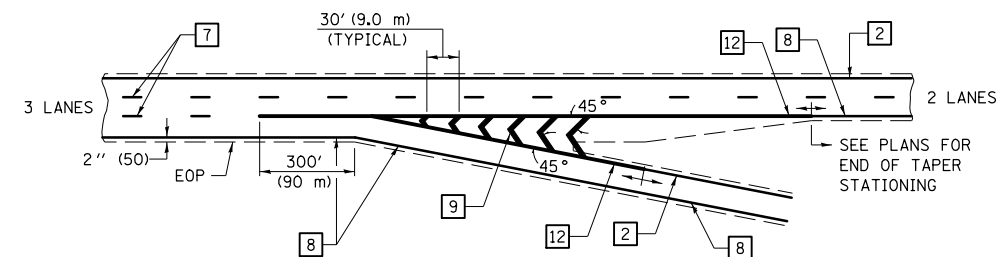

TYPICAL PAVEMENT MARKING LEGEND

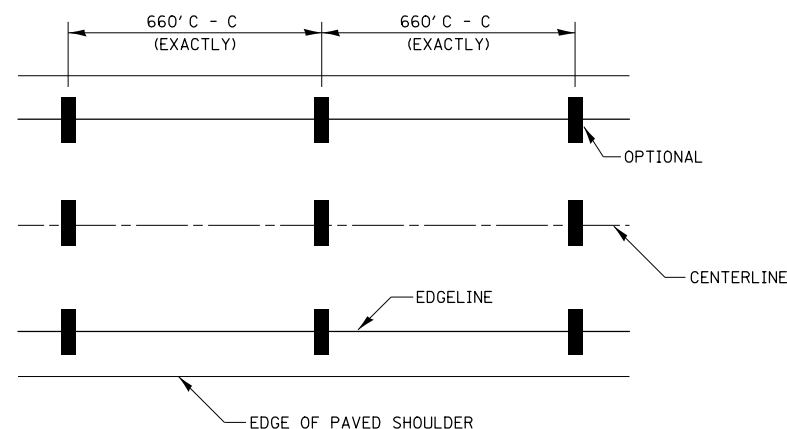

- 1 4" (100) SKIP-DASH (YELLOW)
- 2 4" (100) SOLID (YELLOW)
- 3 12" (300) DIAGONAL (YELLOW)
- 4 4" (100) DOUBLE YELLOW (NARROW)
- 5 RESERVED
- 6 RESERVED
- 7 4" (100) SKIP-DASH (WHITE)
- 8 4" (100) SOLID (WHITE)
- 9 12" (300) DIAGONAL (WHITE)
- 10 6" (150) SOLID (WHITE)
- 11 24" (600) STOP BAR (WHITE)
- 12 8" (200) SOLID (WHITE)
- 13 4" (100) LANE LINE EXTENSIONS (WHITE)

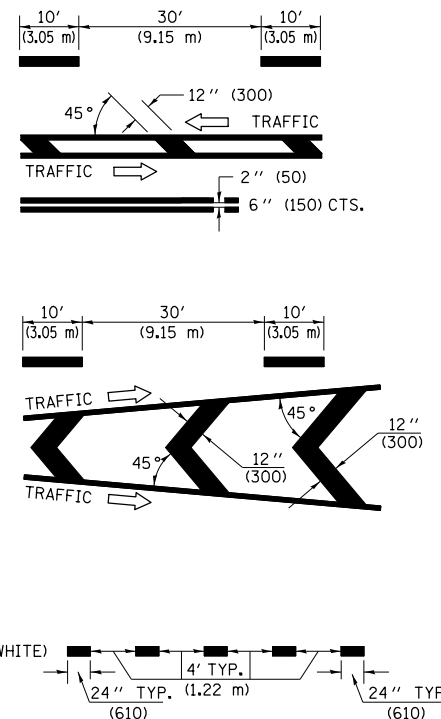

IT WILL BE NECESSARY TO HAVE A REPRESENTATIVE OF THE STATE POLICE PRESENT SO THAT THE ACCURACY OF MEASUREMENT CAN BE ATTESTED TO IN COURT.

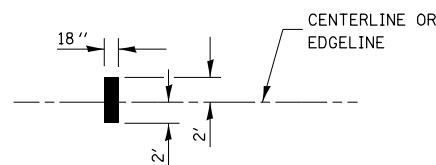

AERIAL SPEED CHECK ZONES

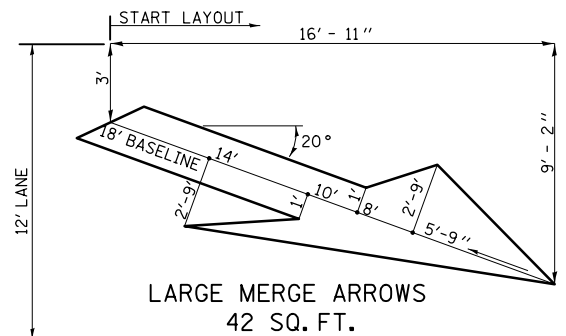

TYPICAL ENTRANCE RAMP TERMINAL

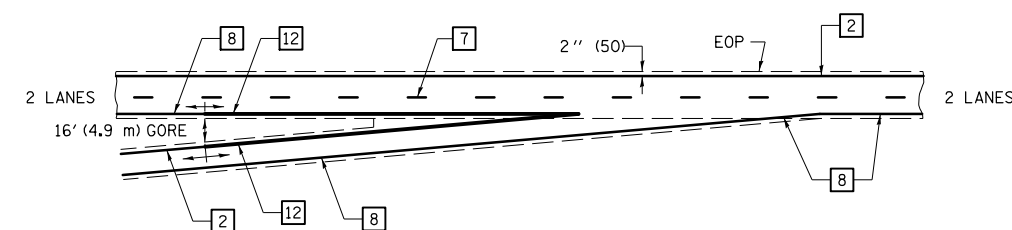

ENTRANCE RAMP TERMINAL with EXCLUSIVE LANE

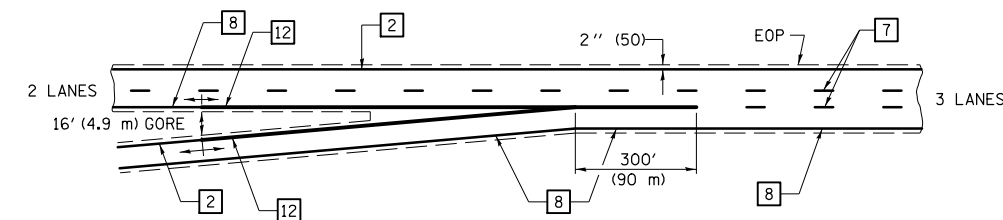

• D5 CRACK & JOINT SEAL 2012-2

Note: All dimensions are in INCHES (millimeters) unless otherwise shown.

DISTRICT 5 DETAIL NO. 7800BBBB

|   |                             |            |                 |
|---|-----------------------------|------------|-----------------|
| FILE NAME =   | USER NAME = ppersonbr       | DESIGNED - | REVISED - 11/06 |
| ei:\pw\work\p\idot\ppersonbr\d0287987\0570933-sh1-details.dgn |                             | DRAWN -    | REVISED -       |
|   | PLOT SCALE = 48.0000' / in. | CHECKED -  | REVISED -       |
|   | PLOT DATE = 1/27/2012       | DATE -     | REVISED -       |

STATE OF ILLINOIS  
DEPARTMENT OF TRANSPORTATION

PAVEMENT MARKING (INTERSTATE & MULTI-LANE APPLICATIONS)

SCALE: SHEET NO. OF SHEETS STA. TO STA.

|   |         |        |              |           |
|---|---------|--------|--------------|-----------|
| F.A. RTE.                                     | SECTION | COUNTY | TOTAL SHEETS | SHEET NO. |
| VAR.  |         | VAR.   | 24           | 24        |
| CONTRACT NO. 70933                            |         |        |              |           |
| FED. ROAD DIST. NO. ILLINOIS FED. AID PROJECT |         |        |              |           |