

EXIST. CURVE 96-1
 PI STA. = 1273+11.52
 $\Delta = 16^\circ 01' 39''$ (LT)
 $D = 1^\circ 36' 00''$
 $R = 3,580.99'$
 $T = 504.15'$
 $L = 1,001.72'$
 $E = 35.31'$
 $e = 4.70\%$
 $T.R. = 38.4'$
 S.E. RUN = 120.2'
 P.C. STA. = 1268+07.37
 P.T. STA. = 1278+09.09

S.E. TRANSITIONS
 STA. 1266+88.84 TO STA. 1268+47.44
 STA. 1277+69.02 TO STA. 1279+27.62

STA. 272+18.50 (IL 96)
 STA. 30+00.00 (TR 238)

IL 96 IMPROVEMENT BEGINS
 STA. 1273+10.50

PROPOSED BUTT-JOINT 35'-0"
 FOR DETAILS SEE BUTT-JOINT &
 MILLING TRANSITION DETAIL SHEET

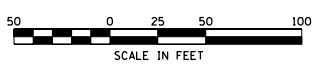
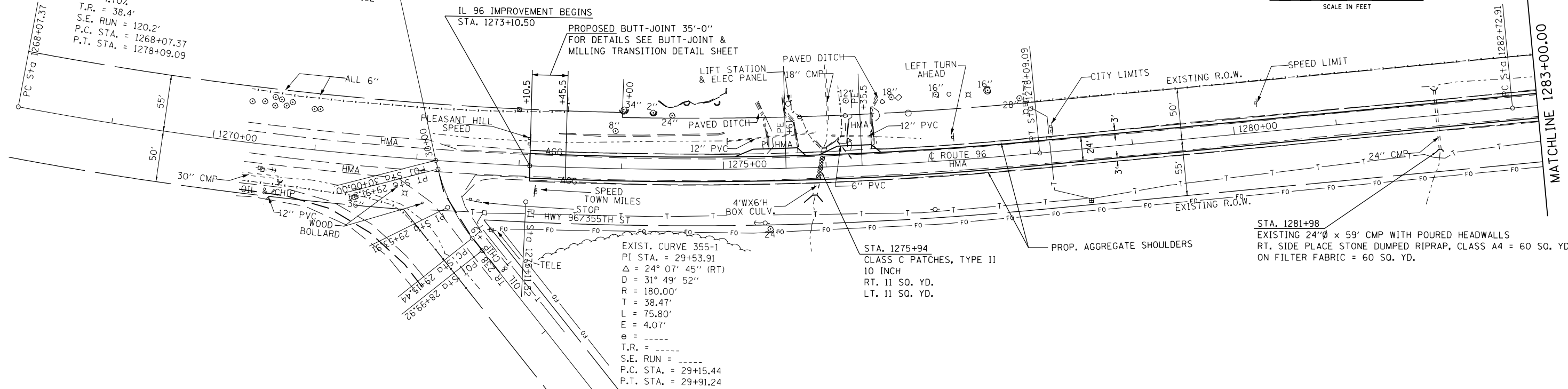

EXIST. CURVE 355-1
 PI STA. = 29+53.91
 $\Delta = 24^\circ 07' 45''$ (RT)
 $D = 31^\circ 49' 52''$
 $R = 180.00'$
 $T = 38.47'$
 $L = 75.80'$
 $E = 4.07'$
 $e =$
 $T.R. =$
 S.E. RUN =
 P.C. STA. = 29+15.44
 P.T. STA. = 29+91.24

STA. 1275+94
 CLASS C PATCHES, TYPE II
 10 INCH
 RT. 11 SQ. YD.
 LT. 11 SQ. YD.

STA. 1281+98
 EXISTING 24"Ø x 59' CMP WITH POURED HEADWALLS
 RT. SIDE PLACE STONE DUMPED RIPRAP, CLASS A4 = 60 SQ. YD.
 ON FILTER FABRIC = 60 SQ. YD.

EXIST. CURVE 96-2
 PI STA. = 1287+40.52
 $\Delta = 4^\circ 21' 44''$ (RT)
 $D = 0^\circ 28' 00''$
 $R = 12,277.71'$
 $T = 467.61'$
 $L = 934.77'$
 $E = 8.90'$
 $e = N/A$
 $T.R. =$
 S.E. RUN =
 P.C. STA. = 1282+72.91
 P.T. STA. = 1292+07.67

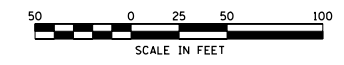
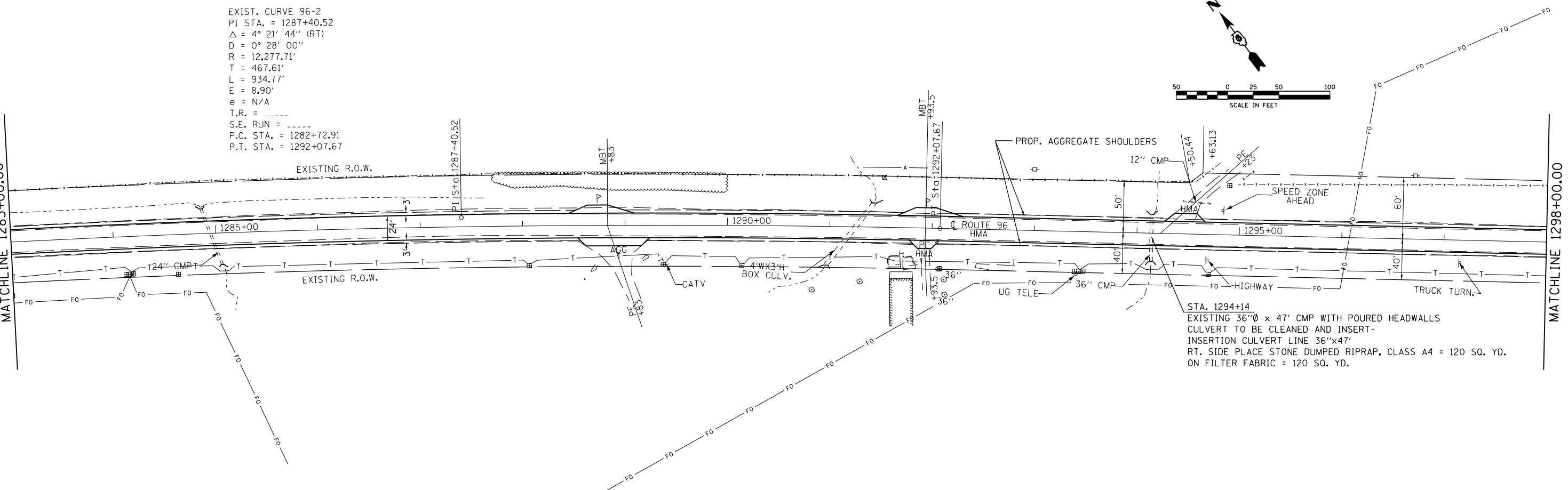

STA. 1294+14
 EXISTING 36"Ø x 47' CMP WITH POURED HEADWALLS
 CULVERT TO BE CLEANED AND INSERT-
 INSERTION CULVERT LINE 36"x47'
 RT. SIDE PLACE STONE DUMPED RIPRAP, CLASS A4 = 120 SQ. YD.
 ON FILTER FABRIC = 120 SQ. YD.

FILE NAME =	USER NAME = sparksgw	DESIGNED -	REVISED -	STATE OF ILLINOIS DEPARTMENT OF TRANSPORTATION	PLAN SHEET	F.A.P. RTE.	SECTION	COUNTY	TOTAL SHEETS	SHEET NO.	
c:\pw\work\p\id\dot\sparksgw\10216263\067243-sht.pln.dgn		DRAWN -	REVISED -			304	4RS-3, BR-1	PIKE	41	17	
PLOT SCALE = 100.0000' / in.		CHECKED -	REVISED -			CONTRACT NO. 72243					
PLOT DATE = Feb-07-2012 02:52:48PM		DATE -	REVISED -			SCALE:	SHEET NO. 1 OF 7 SHEETS	STA. 1273+10.50 TO STA. 1298+00.00	ILLINOIS FED. AID PROJECT		