

STA. 1424+78
 CLASS C PATCHES, TYPE III
 10 INCH
 RT. 16 SQ. YD.
 LT. 16 SQ. YD.

STA. 1424+78
 EXISTING 10'x9'x53' BOX CULVERT
 RT. SIDE PLACE STONE DUMPED RIPRAP = 45 SQ. YD.
 ON FILTER FABRIC = 45 SQ. YD.

STA. 1432+97
 EXISTING 30"Ø x 51' CMP WITH POURED HEADWALLS
 CULVERT TO BE CLEANED AND INSERT-INSERTION
 CULVERT LINE 30"x51'

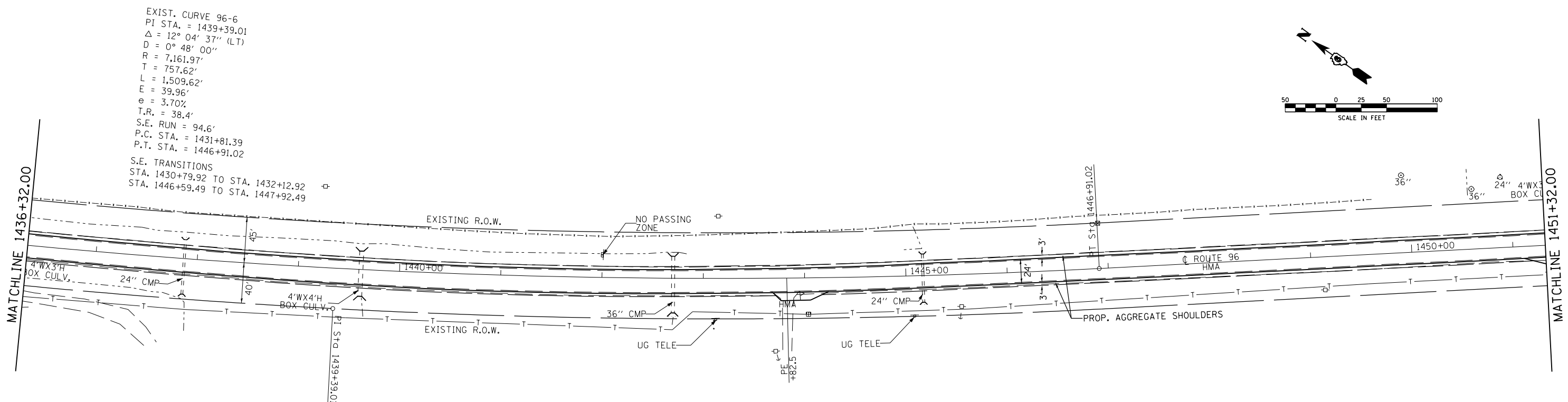
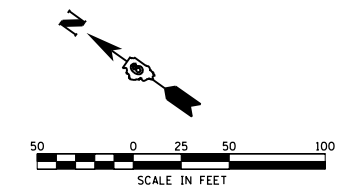

EXIST. CURVE 96-6
 PI STA. = 1439+39.01
 $\Delta = 12^\circ 04' 37''$ (LT)
 $D = 0^\circ 48' 00''$
 $R = 7,161.97'$
 $T = 757.62'$
 $L = 1,509.62'$
 $E = 39.96'$
 $e = 3.70\%$
 $T.R. = 38.4'$
 $S.E. RUN = 94.6'$
 $P.C. STA. = 1431+81.39$
 $P.T. STA. = 1446+91.02$

S.E. TRANSITIONS
 STA. 1430+79.92 TO STA. 1432+12.92
 STA. 1446+59.49 TO STA. 1447+92.49

FILE NAME =	USER NAME = sparksgw	DESIGNED -	REVISED -	STATE OF ILLINOIS DEPARTMENT OF TRANSPORTATION	PLAN SHEET		F.A.P. RTE.	SECTION	COUNTY	TOTAL SHEETS	SHEET NO.	
ei:\pwwork\pwwork\sparksgw\10216263\067243-shr-pln.dgn		DRAWN -	REVISED -		SCALE:	SHEET NO. 6 OF 7 SHEETS	STA. 1421+32.00 TO STA. 1451+32.00	304	4RS-3, BR-1	PIKE	41	23
		CHECKED -	REVISED -		CONTRACT NO. 72243							
		DATE -	REVISED -		ILLINOIS FED. AID PROJECT							