

CAMP BUTLER ROAD & COLT ROAD - TRAFFIC SIGNAL QUANTITIES		
QUANTITY	UNIT	ITEM
12	SQ FT	SIGN PANEL, TYPE 1
30	SQ FT	SIGN PANEL, TYPE 2
1	EACH	SERVICE INSTALLATION, TYPE A
414	FOOT	UNDERGROUND CONDUIT, PVC, 1 1/2" DIA.
163	FOOT	UNDERGROUND CONDUIT, PVC, 2" DIA.
105	FOOT	UNDERGROUND CONDUIT, PVC, 2 1/2" DIA.
244	FOOT	UNDERGROUND CONDUIT, PVC, 3" DIA.
112	FOOT	UNDERGROUND CONDUIT, PVC, 3 1/2" DIA.
5	EACH	HANDHOLE
1	EACH	DOUBLE HANDHOLE
1	EACH	FULL-ACTUATED CONTROLLER AND TYPE V CABINET
1	EACH	MASTER CONTROLLER
1	EACH	UNINTERRUPTIBLE POWER SUPPLY, STANDARD
2	EACH	TRANSCIEVER - FIBER OPTIC
884	FOOT	FIBER OPTIC CABLE IN CONDUIT, NO. 62.5/125, MM12F SM12F
1291	FOOT	ELECTRIC CABLE IN CONDUIT, SIGNAL, NO. 14, 5C
321	FOOT	ELECTRIC CABLE IN CONDUIT, SIGNAL, NO. 14, 7C
777	FOOT	ELECTRIC CABLE IN CONDUIT, SIGNAL, NO. 14, 9C
338	FOOT	ELECTRIC CABLE IN CONDUIT, SIGNAL, NO. 14, 12C
887	FOOT	ELECTRIC CABLE IN CONDUIT, SIGNAL, NO. 18 3C
17	FOOT	ELECTRIC CABLE IN CONDUIT, SERVICE, NO. 6, 3C
886	FOOT	ELECTRIC CABLE IN CONDUIT, EQUIPMENT GROUNDING CONDUCTOR, NO. 6, 1C
5	EACH	TRAFFIC SIGNAL POST, ALUMINUM, 14 FT.
2	EACH	TRAFFIC SIGNAL POST, ALUMINUM, 15 FT.
1	EACH	TRAFFIC SIGNAL POST, ALUMINUM, 16 FT.
1	EACH	STEEL MAST ARM ASSEMBLY AND POLE, 26 FT.

MATCH LINE STA. 69 + 00.00

1	EACH	STEEL MAST ARM ASSEMBLY AND POLE, 32 FT.
1	EACH	STEEL MAST ARM ASSEMBLY AND POLE, 34 FT.
1	EACH	STEEL MAST ARM ASSEMBLY AND POLE, 48 FT.
24	FOOT	CONCRETE FOUNDATION, TYPE A
3	FOOT	CONCRETE FOUNDATION, TYPE C
37	FOOT	CONCRETE FOUNDATION, TYPE E, 30-INCH DIAMETER
13	FOOT	CONCRETE FOUNDATION, TYPE E, 36-INCH DIAMETER
1	EACH	DRILL EXISTING HANDHOLE
3	EACH	SIGNAL HEAD, POLYCARBONATE, LED, 1-FACE, 3-SECTION, BRACKET MOUNTED
3	EACH	SIGNAL HEAD, POLYCARBONATE, LED, 1-FACE, 3-SECTION, MAST ARM MOUNTED
2	EACH	SIGNAL HEAD, POLYCARBONATE, LED, 1-FACE, 4-SECTION, MAST ARM MOUNTED
1	EACH	SIGNAL HEAD, POLYCARBONATE, LED, 1-FACE, 5-SECTION, BRACKET MOUNTED
1	EACH	SIGNAL HEAD, POLYCARBONATE, LED, 1-FACE, 5-SECTION, MAST ARM MOUNTED
3	EACH	SIGNAL HEAD, POLYCARBONATE, LED, 2-FACE, 3-SECTION, BRACKET MOUNTED
2	EACH	SIGNAL HEAD, POLYCARBONATE, LED, 2-FACE, 1-3 SECTION, 1-4 SECTION, BRACKET MOUNTED
1	EACH	SIGNAL HEAD, POLYCARBONATE, LED, 2-FACE, 1-3 SECTION, 1-5 SECTION, BRACKET MOUNTED
21	EACH	TRAFFIC SIGNAL BACKPLATE
4	EACH	CAMERA MOUNTING ASSEMBLY
1	EACH	OPTIMIZE TRAFFIC SIGNAL SYSTEM
1	EACH	VIDEO VEHICLE DETECTION SYSTEM

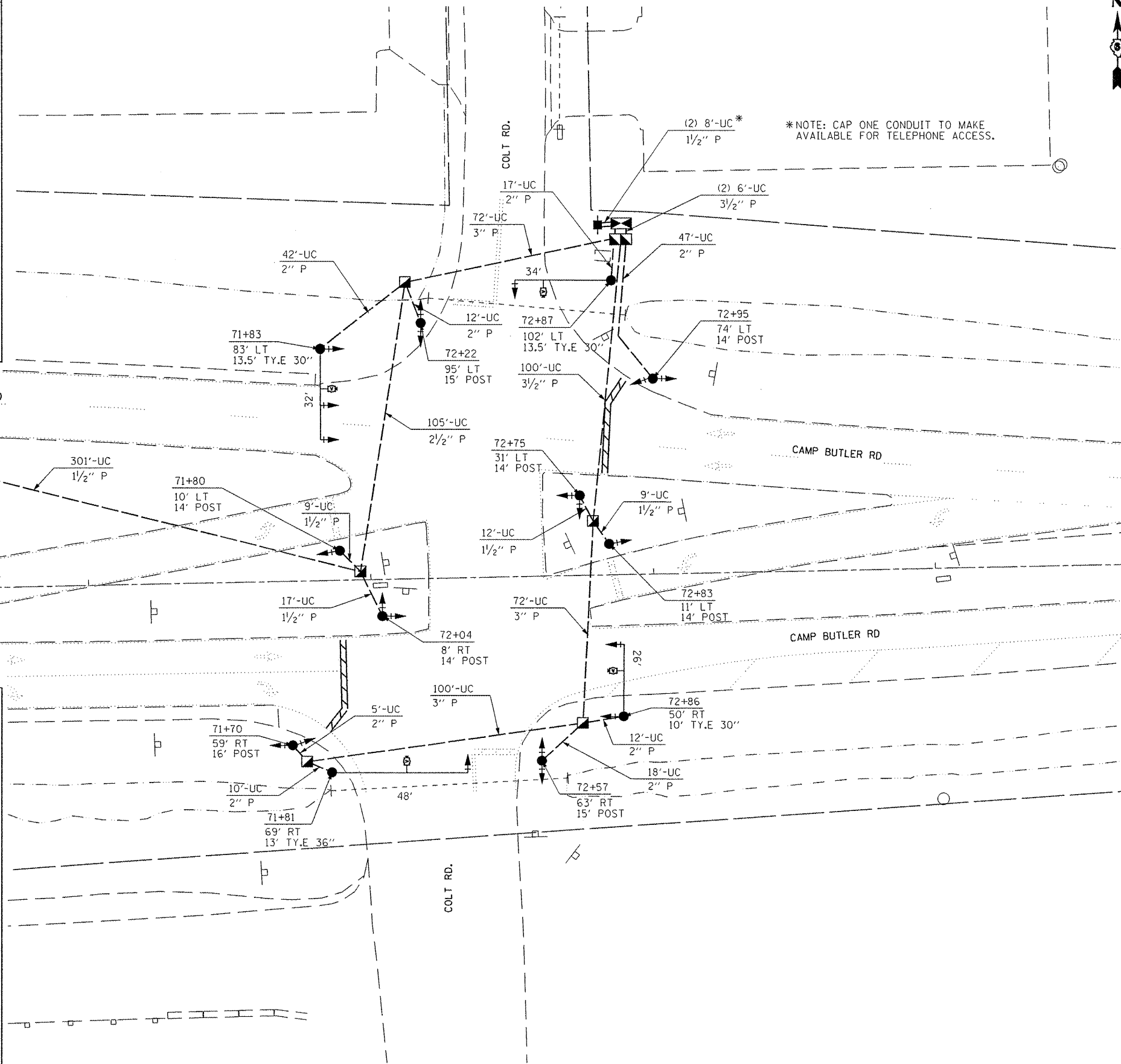

FILE NAME =	USER NAME = sparksgv	DESIGNED -	REVISED -
et:\pwork\puidot\sparksgv\d0280577\06724-shr-plan2.dgn		DRAWN -	REVISED -
PLOT SCALE = 40,0000 ' / in.		CHECKED -	REVISED -
PLOT DATE = Feb-06-2012 09:14:46AM		DATE -	REVISED -

**STATE OF ILLINOIS  
DEPARTMENT OF TRANSPORTATION**

<b>PROPOSED TRAFFIC SIGNAL PLAN</b>	
SCALE:	SHEET OF SHEETS STA. TO STA.

F.A.U. RTE.	SECTION	COUNTY	TOTAL SHEETS	SHEET NO.
7968		SANGAMON	11	9
CONTRACT NO. 72F24			ILLINOIS FED. AID PROJECT	