

STATE OF ILLINOIS  
DEPARTMENT OF TRANSPORTATION  
DIVISION OF HIGHWAYS

**PROPOSED  
HIGHWAY PLANS**  
FAU ROUTE: 7968 (CAMP BUTLER RD.)  
SECTION: D6 TRAFFIC SIGNAL MOD 2012  
PROJECT: HSIP-7968(001)  
TRAFFIC SIGNAL MODERNIZATION  
SANGAMON COUNTY

F.A.U. RTE.	SECTION	COUNTY	TOTAL SHEETS	SHEET NO.
7968	D6 TRAF SIGNAL MOD 2012	SANGAMON	11	1
CONTRACT NO. 72F24				

D-96-036-12

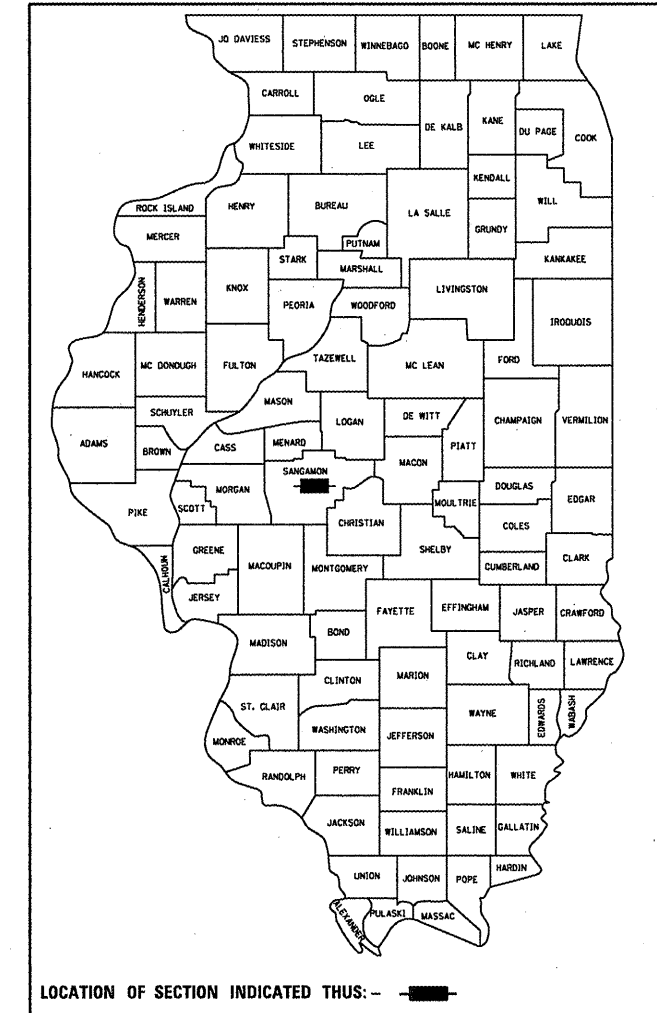

**INDEX OF SHEETS**

- 1 COVER SHEET
- 2 GENERAL NOTES
- 3-6 SUMMARY OF QUANTITIES
- 7 TRAFFIC SIGNAL LEGEND
- 8-9 TRAFFIC SIGNAL PLANS
- 10 CABLE PLAN
- 11 VDS SYSTEM DETAILS

**STANDARDS**

701101-02	814006-02
701501-06	857001-01
701701-08	862001-01
701901-02	873001-02
720016-03	877001-05
805001-01	878001-09
814001-02	880006-01

C-96-036-12

BEGIN SECTION DIST. 6  
TRAFFIC SIGNAL MOD 2012  
STA. 65+50  
CAMP BUTLER RD.

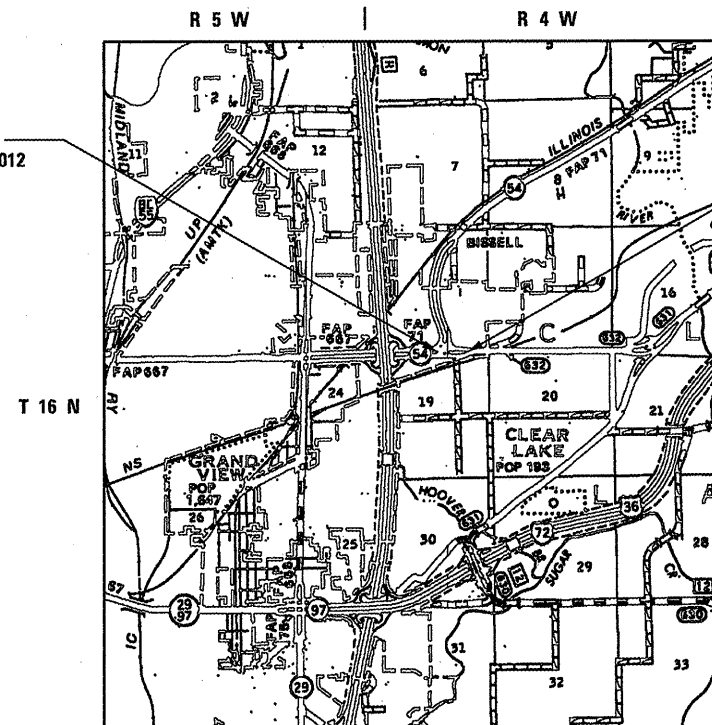

END SECTION DIST. 6  
TRAFFIC SIGNAL MOD 2012  
STA. 73+00  
CAMP BUTLER RD.

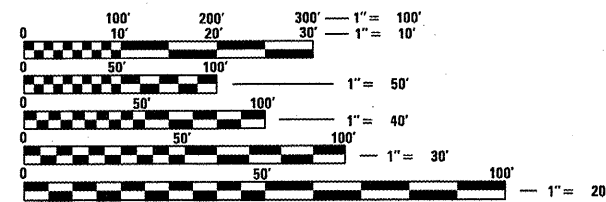

FULL SIZE PLANS HAVE BEEN PREPARED USING STANDARD ENGINEERING SCALES. REDUCED SIZED PLANS WILL NOT CONFORM TO STANDARD SCALES. IN MAKING MEASUREMENTS ON REDUCED PLANS, THE ABOVE SCALES MAY BE USED.

J.U.L.I.E.  
JOINT UTILITY LOCATION INFORMATION FOR EXCAVATION  
1-800-892-0123  
OR 811

SENIOR TEAM LEADER: VINCE MADONIA (217) 785-9046  
TEAM ENGINEER: VICTOR YOUNG (217) 524-0472

CONTRACT NO. 72F24



FAU 7968 (CAMP BUTLER RD.) - OTHER PRINCIPAL ARTERIAL  
ADT - 7,400 (2009), 9,137 (2030)  
DESIGN/POSTED SPEED - 55 MPH /45 MPH  
NET LENGTH = 750.00 FT. = 0.142 MI.  
GROSS LENGTH = 750.00 FT. = 0.142 MI.



11 Executive Drive Suite 12  
Fairview Heights, Illinois 62208  
(618) 624-8610  
(618) 624-8611 (fax)  
2501 Chatham Road, Suite 120  
Springfield, Illinois 62704  
(217) 698-8610  
(217) 698-8608 (fax)  
115 North Neil Street, Suite 105  
Champaign, Illinois 61820  
(217) 351-8610  
(217) 351-8611 (fax)

STATE OF ILLINOIS  
DEPARTMENT OF TRANSPORTATION  
DIVISION OF HIGHWAYS  
SUBMITTED February 3 20 12  
*Rege Z. D. ...*  
DEPUTY DIRECTOR OF HIGHWAYS, REGION ENGINEER  
March 23 20 12  
*John D. Baranzelli, P.E.*  
ENGINEER OF DESIGN AND ENVIRONMENT  
March 23 20 12  
*William R. Frey Jr.*  
DIRECTOR OF HIGHWAYS, CHIEF ENGINEER

**PRINTED BY THE AUTHORITY  
OF THE STATE OF ILLINOIS**

DATE: \_\_\_\_\_  
LICENSE EXP. 11/30/2013

**GENERAL NOTES**

1. THESE PLANS HAVE BEEN PREPARED USING STANDARD SYMBOLS AS INDICATED IN THESE PLANS, AND THEY SHALL TAKE PRECEDENCE OVER THOSE SHOWN ON STANDARD 000001 IF THERE IS A CONFLICT.
2. THE CONTRACTOR SHALL VERIFY ALL DIMENSIONS AND CONDITIONS IN THE FIELD PRIOR TO CONSTRUCTION AND ORDERING OF MATERIALS.
3. THE CONTRACTOR SHALL PROTECT UTILITY PROPERTY FROM CONSTRUCTION OPERATIONS AS OUTLINED IN ARTICLE 107.31 OF THE STANDARD SPECIFICATIONS. AGENCIES KNOWN TO HAVE FACILITIES WITHIN THE PROJECT AREA ARE AS FOLLOWS:

J.U.L.I.E. 1-800-892-0123  
ILLINOIS DEPARTMENT OF TRANSPORTATION 217-524-9161

ILLINOIS STATE LAW REQUIRES A 48-HOUR NOTICE BE GIVEN TO ALL UTILITIES BEFORE DIGGING. FIELD MARKING OF FACILITIES MAY BE OBTAINED BY CONTACTING J.U.L.I.E. OR FOR NON-MEMBERS, BY CONTACTING THE UTILITY COMPANY DIRECTLY.

IT IS UNDERSTOOD AND AGREED THAT THE CONTRACTOR HAS TAKEN THE FOREGOING INTO CONSIDERATION IN SUBMITTING HIS BID, AND NO ADDITIONAL COMPENSATION WILL BE ALLOWED FOR ANY DELAYS OF INCONVENIENCES CAUSED BY THE SAME.

THE INFORMATION AND DATA SHOWN OR INDICATED ON THESE IMPROVEMENT PLANS WITH RESPECT TO EXISTING UNDERGROUND FACILITIES AND UTILITIES AT OR CONTIGUOUS TO THE SITE IS BASED ON INFORMATION AND DATA FURNISHED BY THE OWNERS OF SUCH UNDERGROUND FACILITIES AND UTILITIES OR BY OTHERS. FIELD MARKINGS OF FACILITIES IN CRITICAL AREAS MAY BE OBTAINED BY PROVIDING A MINIMUM OF 96 HOURS IN ADVANCE NOTICE TO THE RESIDENT ENGINEER SO THAT UTILITIES CAN BE GIVEN NOTICE. NO GUARANTEE IS IMPLIED AS TO THE ACCURACY OR COMPLETENESS OF ANY SUCH INFORMATION OR DATA; AND THE CONTRACTOR SHALL HAVE FULL RESPONSIBILITY FOR (i) REVIEW AND CHECKING ALL SUCH INFORMATION AND DATA, (ii) VERIFYING IF ANY CONFLICTS EXIST WITH THE PROPOSED WORK AND UNDERGROUND FACILITIES AND UTILITIES SHOWN OR INDICATED ON THE IMPROVEMENT, (iii) COORDINATION OF THE WORK WITH THE OWNERS OF SUCH UNDERGROUND FACILITIES AND UTILITIES DURING CONSTRUCTION, AND (iv) THE SAFETY AND PROTECTION OF ALL SUCH UNDERGROUND FACILITIES AND UTILITIES AND REPAIR ANY DAMAGE THERETO RESULTING FROM THE WORK AT HIS EXPENSE.

4. ALL UTILITIES TO BE RELOCATED BY OTHERS.
5. THE CONTRACTOR SHALL REMOVE EXISTING SIGN PANELS (STOP, STOP AHEAD, YIELD, ETC.) AND POSTS AND TRANSPORT THEM TO A LOCATION TO BE DETERMINED BY THE ENGINEER. THIS WORK WILL NOT BE PAID FOR SEPARATELY, BUT WILL BE CONSIDER PART OF THE CONTRACT. THE DISTRICT 6 TRAFFIC OPERATION ENGINEER, MARSHALL METCALF, SHALL BE CONTACTED AT (217)785-5312 BEFORE THE SIGNS ARE REMOVED.
6. THE CONTRACTOR SHALL CONTACT THE DISTRICT 6 BUREAU OF OPERATIONS BEFORE ACTIVATING THE TRAFFIC SIGNALS.

**COMMITMENTS**

1. THE FIELD/RESIDENT ENGINEER SHALL CONTACT STUDIES AND PLANS COVERING ANY MAJOR PLAN CHANGES TO MAKE SURE NO PREVIOUS COMMITMENTS (NOT LISTED) WERE MADE AFFECTING THE DESIGN, AND TO ALLOW IMPROVED DESIGN FOR THE FUTURE.

<b>DISTRICT SIX</b>	
EXAMINED <u>1/17</u> 20 <u>12</u> <i>William M. Ryan</i>	OPERATIONS ENGINEER
EXAMINED <u>JAN 21</u> 20 <u>12</u> <i>Tommy Ford</i>	PROJECT IMPLEMENTATION ENGINEER
EXAMINED <u>January 10</u> 20 <u>12</u> <i>ARMLI</i>	PROGRAM DEVELOPMENT ENGINEER

FILE NAME =	USER NAME = ba1j	DESIGNED -	REVISED -	<b>STATE OF ILLINOIS DEPARTMENT OF TRANSPORTATION</b>	<b>GENERAL NOTES</b>	F.A.U. RTE.	SECTION	COUNTY	TOTAL SHEETS	SHEET NO.	
c:\pwwork\pwwork\ba1j\02280577\0672F24	shir-gennote.dgn	DRAWN -	REVISED -			7968	*	SANGAMON	11	2	
PLOT SCALE = 40.0000' / 1" =	CHECKED -	REVISED -	REVISED -			CONTRACT NO. 72F24					
PLOT DATE = Feb-01-2012 02:10:33PM	DATE -	REVISED -	REVISED -			ILLINOIS FED. AID PROJECT					
					SCALE:	SHEET OF SHEETS		STA.	TO STA.		

CODE NO.	ITEM	UNIT	CONSTRUCTION CODE	URBAN
			SFTY	90% Fed
			0021	5% State
			TOTAL	5% City
				QUANTITY
67100100	MOBILIZATION	L SUM	1	1
70102620	TRAFFIC CONTROL AND PROTECTION, STANDARD 701501	L SUM	1	1
70102635	TRAFFIC CONTROL AND PROTECTION, STANDARD 701701	L SUM	1	1
72000100	SIGN PANEL, TYPE 1	SQ FT	12	12
72000200	SIGN PANEL, TYPE 2	SQ FT	30	30
* 78003180	PREFORMED PLASTIC PAVEMENT MARKING, TYPE B - LINE 24"	FOOT	71	71
80500100	SERVICE INSTALLATION, TYPE A	EACH	1	1
81028340	UNDERGROUND CONDUIT, PVC, 1 1/2" DIA.	FOOT	406	406
81028350	UNDERGROUND CONDUIT, PVC, 2" DIA.	FOOT	163	163
81028360	UNDERGROUND CONDUIT, PVC, 2 1/2" DIA.	FOOT	105	105
81028370	UNDERGROUND CONDUIT, PVC, 3" DIA.	FOOT	244	244
81028380	UNDERGROUND CONDUIT, PVC, 3 1/2" DIA.	FOOT	112	112
81400100	HANDHOLE	EACH	5	5
81400300	DOUBLE HANDHOLE	EACH	1	1

\*SPECIALTY  
ITEM

FILE NAME *	USER NAME - sparksg*	DESIGNED -	REVISED -	<b>STATE OF ILLINOIS DEPARTMENT OF TRANSPORTATION</b>	<b>SUMMARY OF QUANTITIES</b>				F.A.I.L. RTE.	SECTION	COUNTY	TOTAL SHEETS	SHEET NO.	
et\pwwork\pwwork\sparksg\0280577\06724-sht-500.dgn		DRAWN -	REVISED -		SCALE:	SHEET	OF	SHEETS	STA.	TO STA.	7968	SANGAMON	11	3
		CHECKED -	REVISED -											
		DATE -	REVISED -											
											CONTRACT NO. 72F24			
											ILLINOIS FED. AID PROJECT			

CODE NO.	ITEM	UNIT	CONSTRUCTION CODE	URBAN
			SFTY	90% Fed
			0021	5% State
			TOTAL	5% City
				QUANTITY
85700300	FULL-ACTUATED CONTROLLER AND TYPE V CABINET	EACH	1	1
86000100	MASTER CONTROLLER	EACH	1	1
86200200	UNINTERRUPTIBLE POWER SUPPLY, STANDARD	EACH	1	1
86400100	TRANSCEIVER - FIBER OPTIC	EACH	2	2
87100020	FIBER OPTIC CABLE IN CONDUIT, NO. 62.5/125, MM12F SM12F	FOOT	884	884
87301245	ELECTRIC CABLE IN CONDUIT, SIGNAL, NO. 14, 5C	FOOT	1,291	1,291
87301255	ELECTRIC CABLE IN CONDUIT, SIGNAL, NO. 14, 7C	FOOT	321	321
87301265	ELECTRIC CABLE IN CONDUIT, SIGNAL, NO. 14, 9C	FOOT	777	777
87301275	ELECTRIC CABLE IN CONDUIT, SIGNAL, NO. 14, 12C	FOOT	338	338
87301290	ELECTRIC CABLE IN CONDUIT, SIGNAL, NO. 18, 3C	FOOT	887	887
87301805	ELECTRIC CABLE IN CONDUIT, SERVICE, NO. 6 2C	FOOT	17	17
87301900	ELECTRIC CABLE IN CONDUIT, EQUIPMENT GROUNDING CONDUCTOR, NO. 6, 1C	FOOT	886	886
87502680	TRAFFIC SIGNAL POST, ALUMINUM, 14 FT.	EACH	5	5
87502690	TRAFFIC SIGNAL POST, ALUMINUM, 15 FT.	EACH	2	2

FILE NAME =	USER NAME = sparksgu	DESIGNED -	REVISED -	<b>STATE OF ILLINOIS DEPARTMENT OF TRANSPORTATION</b>	<b>SUMMARY OF QUANTITIES</b>				F.A.J. RTE.	SECTION	COUNTY	TOTAL SHEETS	SHEET NO.	
c:\pwork\pwork\sparksgu\d0280577\0672F24-shc-500.dgn		DRAWN -	REVISED -		SCALE:	SHEET	OF	SHEETS	STA.	TO STA.	7968	SANGAMON	11	4
		CHECKED -	REVISED -											
		DATE	REVISED -											

CODE NO.	ITEM	UNIT	CONSTRUCTION CODE	URBAN
			SFTY	90% Fed
			0021	5% State
			TOTAL	5% City
				QUANTITY
87502700	TRAFFIC SIGNAL POST, ALUMINUM, 16 FT.	EACH	1	1
87700170	STEEL MAST ARM ASSEMBLY AND POLE, 26 FT.	EACH	1	1
87700200	STEEL MAST ARM ASSEMBLY AND POLE, 32 FT.	EACH	1	1
87700210	STEEL MAST ARM ASSEMBLY AND POLE, 34 FT.	EACH	1	1
87700280	STEEL MAST ARM ASSEMBLY AND POLE, 48 FT.	EACH	1	1
87800100	CONCRETE FOUNDATION, TYPE A	FOOT	24	24
87800150	CONCRETE FOUNDATION, TYPE C	FOOT	3	3
87800400	CONCRETE FOUNDATION, TYPE E, 30-INCH DIAMETER	FOOT	37	37
87800415	CONCRETE FOUNDATION, TYPE E, 36-INCH DIAMETER	FOOT	13	13
87900200	DRILL EXISTING HANDHOLE	EACH	1	1
88040070	SIGNAL HEAD, POLYCARBONATE, LED, 1-FACE, 3-SECTION, BRACKET MOUNTED	EACH	3	3
88040090	SIGNAL HEAD, POLYCARBONATE, LED, 1-FACE, 3-SECTION, MAST ARM MOUNTED	EACH	3	3
88040120	SIGNAL HEAD, POLYCARBONATE, LED, 1-FACE, 4-SECTION, MAST ARM MOUNTED	EACH	2	2
88040150	SIGNAL HEAD, POLYCARBONATE, LED, 1-FACE, 5-SECTION, BRACKET MOUNTED	EACH	1	1

FILE NAME =	USER NAME = sparkgw	DESIGNED -	REVISED -	<b>STATE OF ILLINOIS DEPARTMENT OF TRANSPORTATION</b>	<b>SUMMARY OF QUANTITIES</b>				F.A.I. RTE.	SECTION	COUNTY	TOTAL SHEETS	SHEET NO.
et\pvc\work\pvidot\sparkgw\d0280577\0672f24-shc-500.dgn		DRAWN -	REVISED -		7968	*	SANGAMON	11	5				
PLOT SCALE = 100.0000' / 1"		CHECKED -	REVISED -		SCALE: SHEET OF SHEETS STA. TO STA.				CONTRACT NO. 72F24				
PLOT DATE = Feb-08-2012 09:24:36AM		DATE -	REVISED -		ILLINOIS FED. AID PROJECT								



**PLAN SHEET SYMBOLS**

EXISTING	PROPOSED	
		SIGNAL HEAD
		SIGNAL HEAD WITH BACKPLATE
		TEMPORARY SIGNAL HEAD
		VIDEO VEHICLE DETECTOR CAMERA
		PEDESTRIAN SIGNAL HEAD
		PEDESTRIAN PUSHBUTTON DETECTOR
		DETECTOR LOOP
		QUADRAPOLE DETECTOR LOOP
		SIGNAL POST
		ALUMINUM MAST ARM ASSEMBLY AND POLE
		STEEL MAST ARM ASSEMBLY AND POLE
		COMBINATION SIGNAL AND LIGHT POLE
		WOOD POLE
		WOOD POLE WITH GUY
		SERVICE INSTALLATION
		CONTROLLER
		HANDHOLE
		HEAVY DUTY HANDHOLE
		DOUBLE HANDHOLE
		JUNCTION BOX
		GULFBOX JUNCTION
		AERIAL CABLE
		CONDUIT
		LENGTH - CONSTRUCTION (T=TRENCH P=PUSHED A=AUGERED E=EXISTING)
		SIZE - TYPE (S=STEEL P=PVC)
		CONDUIT SPLICE
		SPAN WIRE/TETHER WIRE
		56 ——— SIDEWALK REMOVAL IN SQ. FT.
		40 ——— PCC SIDEWALK, 4 INCH IN SQ. FT.
		32 ——— PCC SIDEWALK, 4 INCH (SPECIAL) IN SQ. FT.

**CABLE PLAN SYMBOLS**

EXISTING	PROPOSED	
		8" SIGNAL SECTION
		12" SIGNAL SECTION
		DIRECTIONAL SIGNAL SECTION
		9" PEDESTRIAN SIGNAL FACE
		12" PEDESTRIAN SIGNAL FACE
		SIGNAL FACE WITH BACKPLATE
		PROGRAMMED SIGNAL SECTION
		SIGNAL SECTION WITH LOUVRE
		DUAL-INDICATION SIGNAL SECTION
		INDUCTION DETECTOR LOOP
		QUADRAPOLE DETECTOR LOOP
		DIRECT-CONNECTED LOOP LEAD-IN (TWISTED)
		ELECTRIC CABLE DENOTING NUMBER OF CONDUCTORS
		ELECTRIC CABLE TO BE REMOVED
		ELECTRIC CABLE IDENTIFIER TAPE CODES (R=RED W=WHITE Y=YELLOW G=GREEN B=BLUE O=ORANGE)
		PEDESTRIAN PUSHBUTTON DETECTOR
		VIDEO CAMERA
		STEEL TWIN TENON
		EMERGENCY VEHICLE PREEMPTOR
		PEDESTRIAN SIGNAL HEAD

FILE NAME =	USER NAME = sparksgv	DESIGNED -	REVISED -
c:\pwwork\pwwork\sparksgv\d0280577\06724-sht-legend.dgn		DRAWN -	REVISED -
PLOT SCALE = 40.0000' / in.		CHECKED -	REVISED -
PLOT DATE = Feb-06-2012 09:14:39AM		DATE -	REVISED -

**STATE OF ILLINOIS  
DEPARTMENT OF TRANSPORTATION**

**TRAFFIC SIGNAL LEGEND**

SCALE: SHEET OF SHEETS STA. TO STA.

F.A.U. RTE.	SECTION	COUNTY	TOTAL SHEETS	SHEET NO.
7968		SANGAMON	11	7
CONTRACT NO. 72F24			ILLINOIS FED. AID PROJECT	

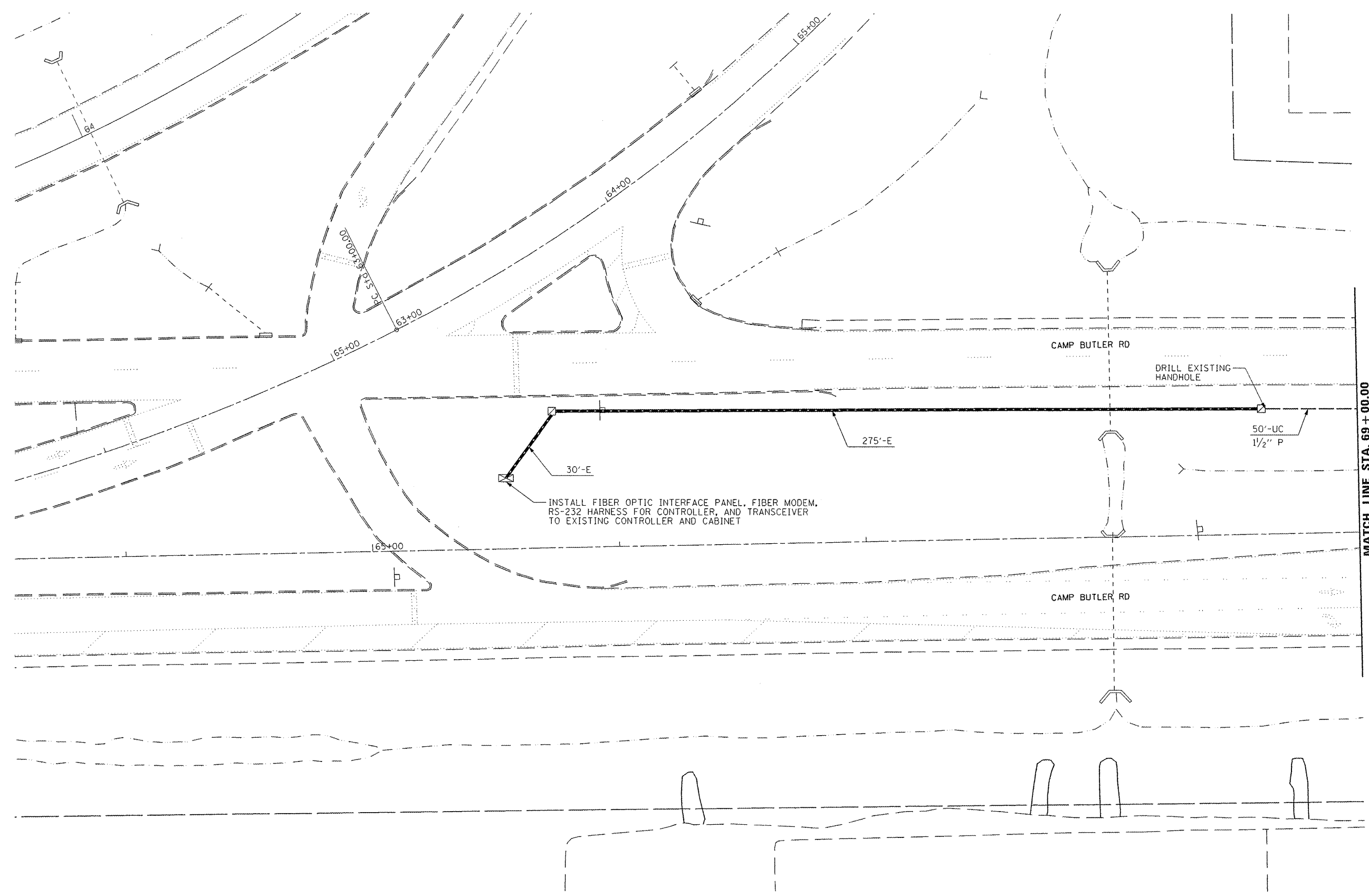

FILE NAME =	USER NAME = sparksgw	DESIGNED -	REVISED -
e:\pwork\puidot\sparksgw\d0280577\0672f24-sht-plan.dgn		DRAWN -	REVISED -
PLOT SCALE = 40.0000' / in.		CHECKED -	REVISED -
PLOT DATE = Feb-06-2012 09:14:43AM		DATE -	REVISED -

**STATE OF ILLINOIS  
DEPARTMENT OF TRANSPORTATION**

<b>PROPOSED TRAFFIC SIGNAL PLAN</b>			
SCALE:	SHEET	OF	SHEETS
			STA. TO STA.

F.A.D. RTE.	SECTION	COUNTY	TOTAL SHEETS	SHEET NO.
7968	.	SANGAMON	11	8
CONTRACT NO. 72F24			ILLINOIS FED. AID PROJECT	





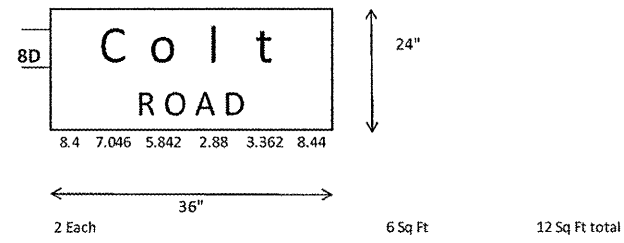
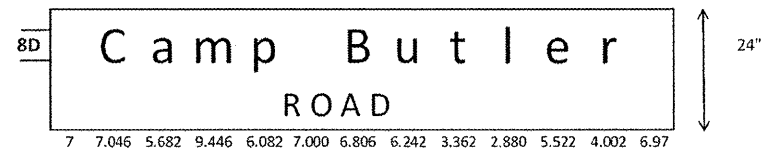

SIGN LAYOUT

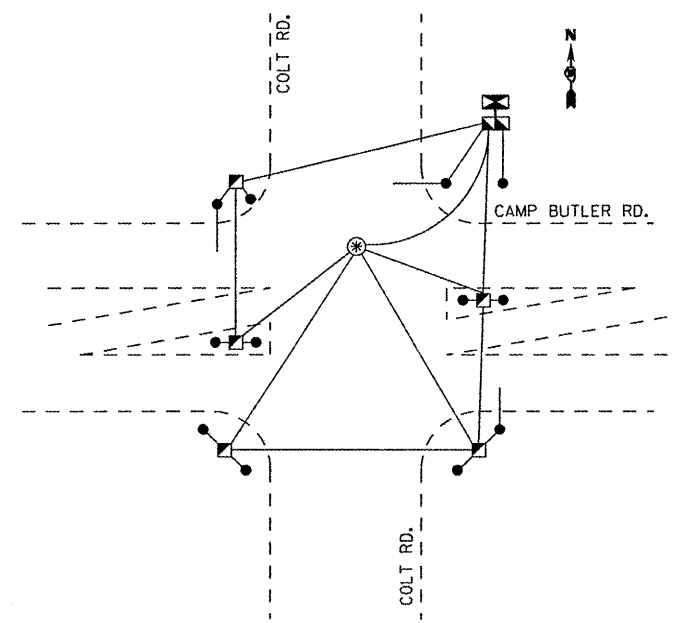
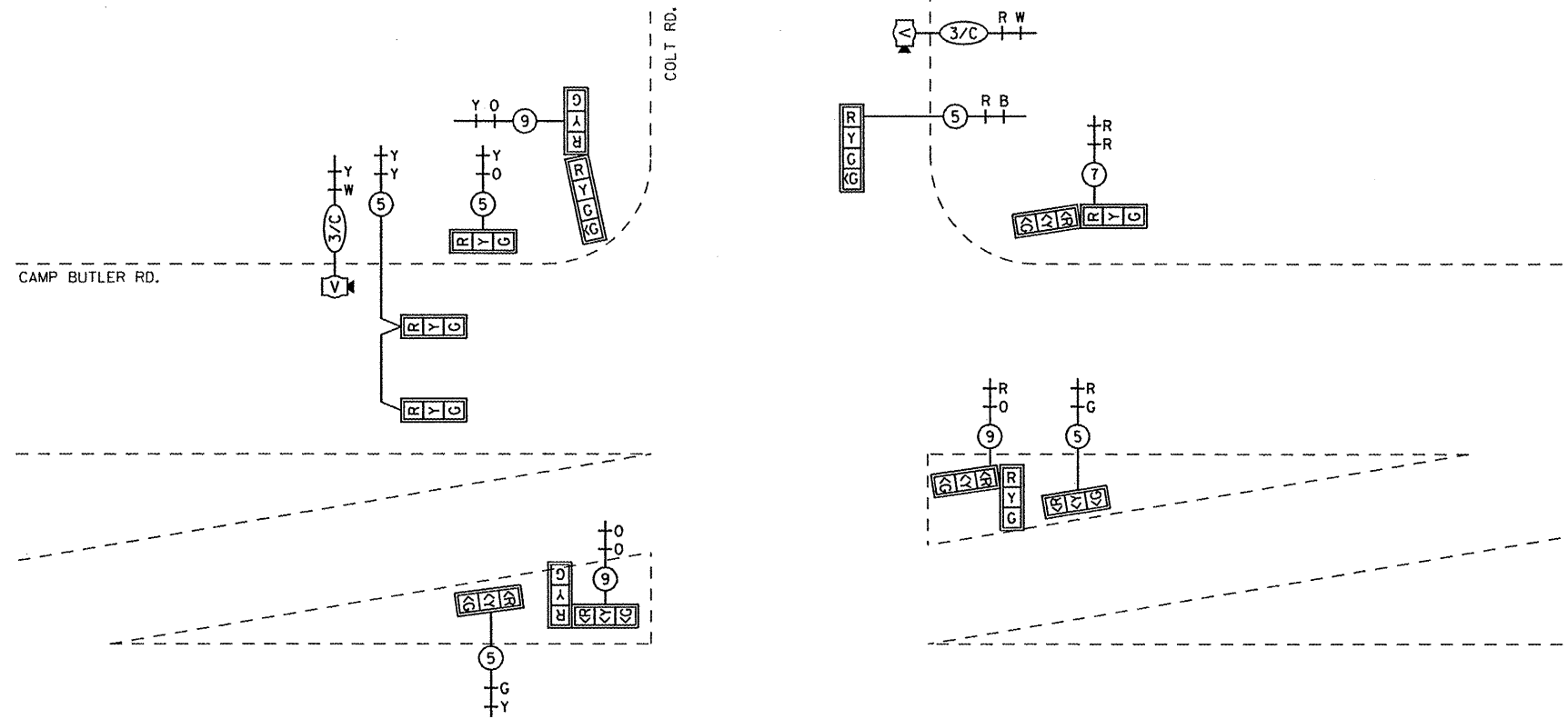

GROUNDING SCHEMATIC

\* GROUNDING WIRE SPLICED BUT NOT BONDED TO COMPOSITE CONCRETE HANDHOLE

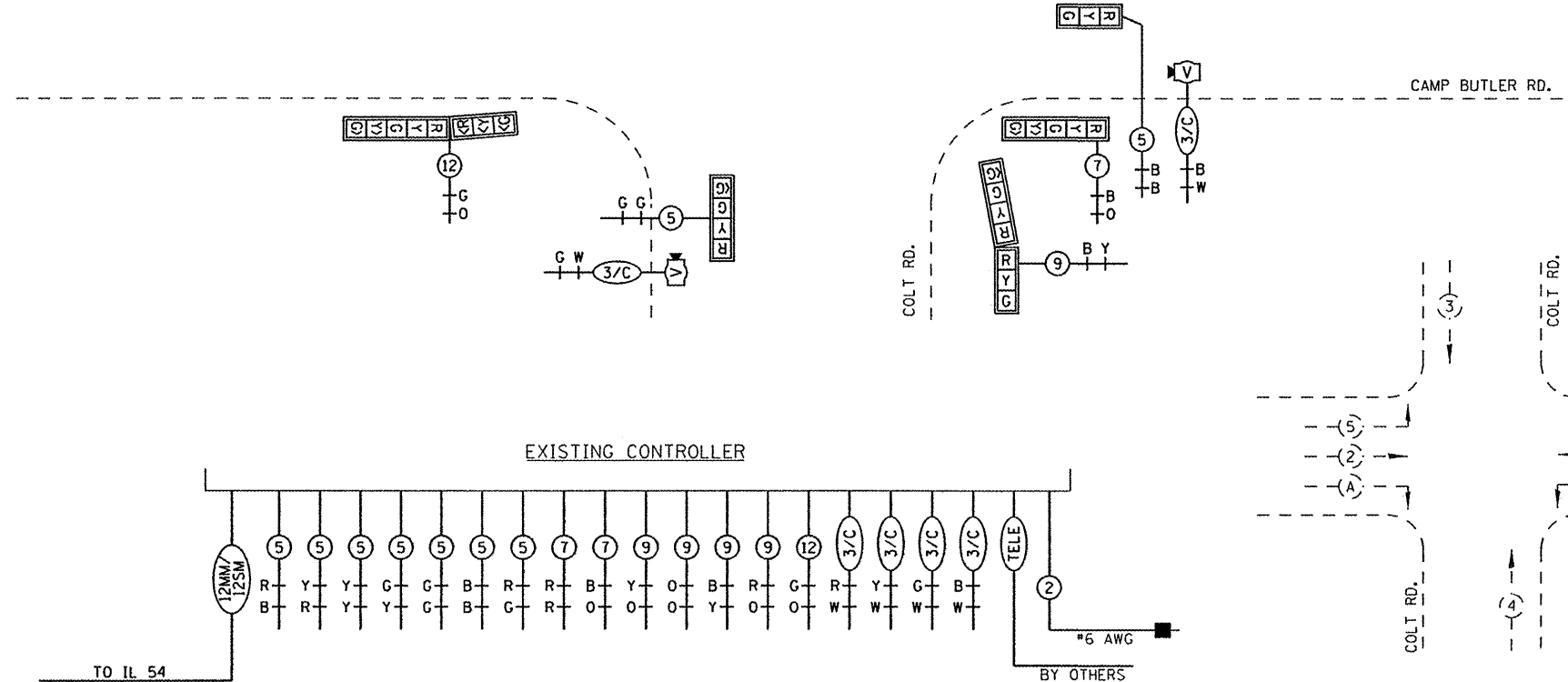

PHASE DESIGNATION DIAGRAM

NOT TO SCALE

FILE NAME :	USER NAME : sparksgv	DESIGNED -	REVISED -
c:\pwork\pwork\sparksgv\d0280577\06724-shr-cableplan.dgn		DRAWN -	REVISED -
		CHECKED -	REVISED -
		DATE -	REVISED -

STATE OF ILLINOIS  
DEPARTMENT OF TRANSPORTATION

CABLE PLAN	
SCALE:	SHEET OF SHEETS STA. TO STA.

F.A.J. RTE.	SECTION	COUNTY	TOTAL SHEETS	SHEET NO.
7968		SANGAMON	11	10
ILLINOIS FED. AID PROJECT			CONTRACT NO. 72F24	

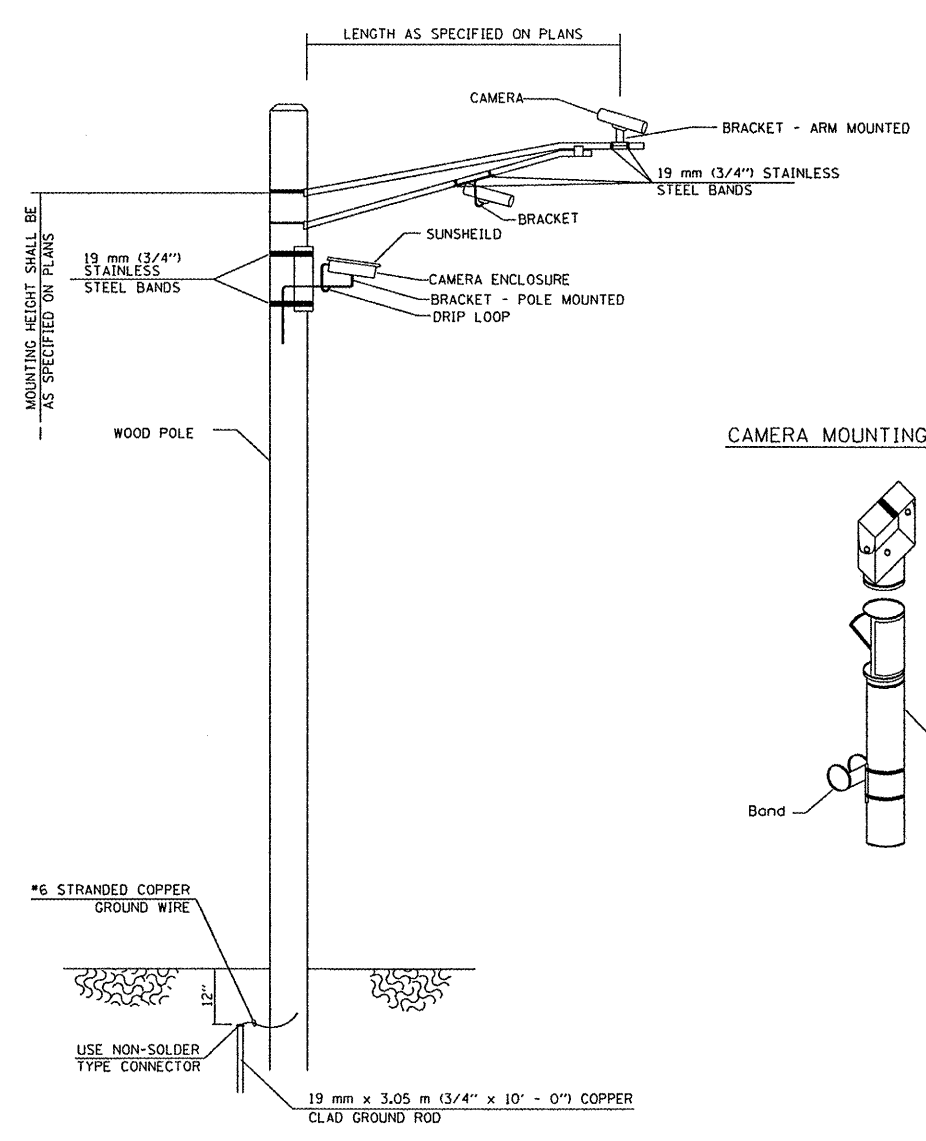

CAMERA MOUNTING ASSEMBLY

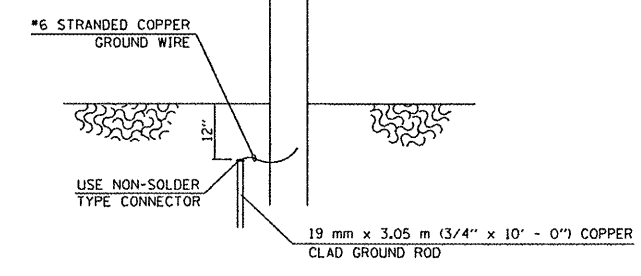
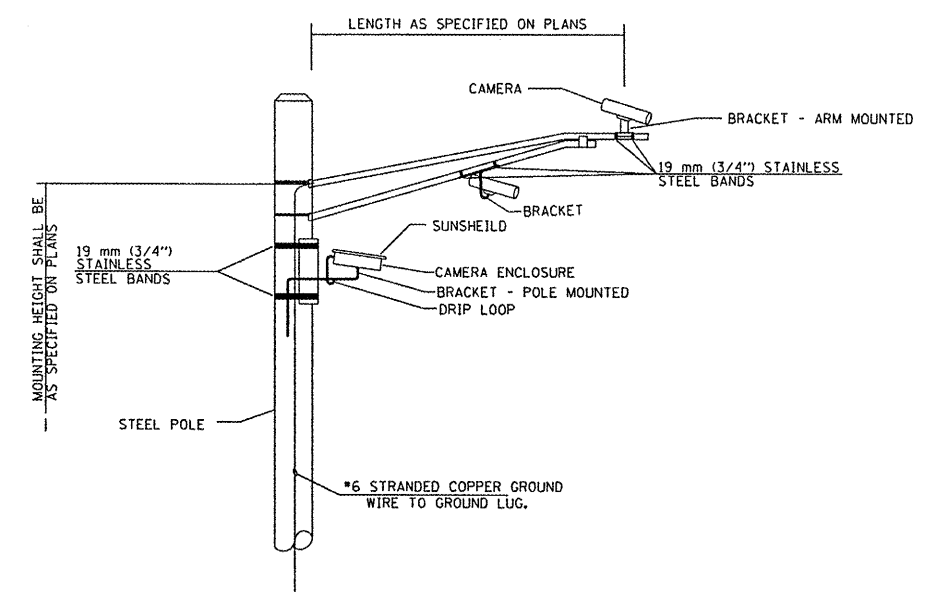
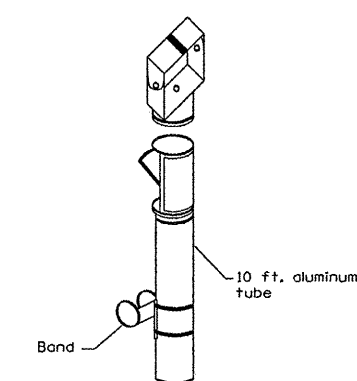

VIDEO DETECTION SYSTEM INSTALLATION  
ARM MOUNTED OR POLE MOUNTED CAMERA

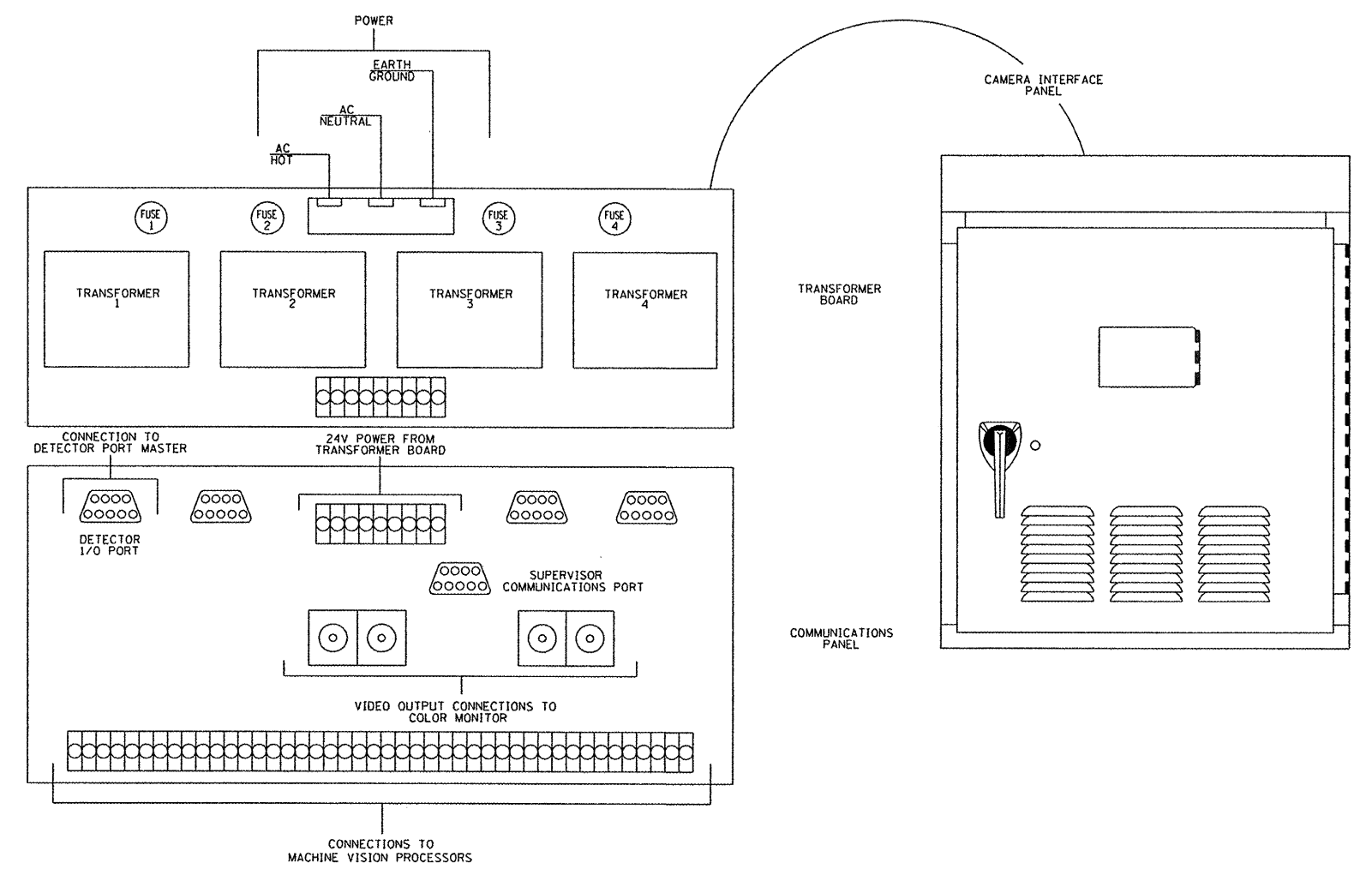

FILE NAME =	USER NAME = sparksgu	DESIGNED -	REVISED -
c:\piv\work\pvidot\sparksgu\d0280577\0624-sh1-VDS.dgn		DRAWN -	REVISED -
	PLOT SCALE = 40.0000 "/> <td>CHECKED -</td> <td>REVISED -</td>	CHECKED -	REVISED -
	PLOT DATE = Feb-06-2012 09:44:58AM	DATE -	REVISED -

**STATE OF ILLINOIS  
DEPARTMENT OF TRANSPORTATION**

**VEHICLE DETECTION SYSTEM**

SCALE: SHEET OF SHEETS STA. TO STA.

F.A.U. RTE. 7968	SECTION *	COUNTY SANGAMON	TOTAL SHEETS 11	SHEET NO. 11
CONTRACT NO. 72F24			ILLINOIS FED. AID PROJECT	