

FINAL SURVEY NO.	SURVEYED	BY	DATE
NOTE BOOK	PLOTTED		
	TEMPLATE		
	AREAS CHECKED		

ORIGINAL SURVEY NO.	SURVEYED	BY	DATE
NOTE BOOK	PLOTTED		
	TEMPLATE		
	AREAS CHECKED		

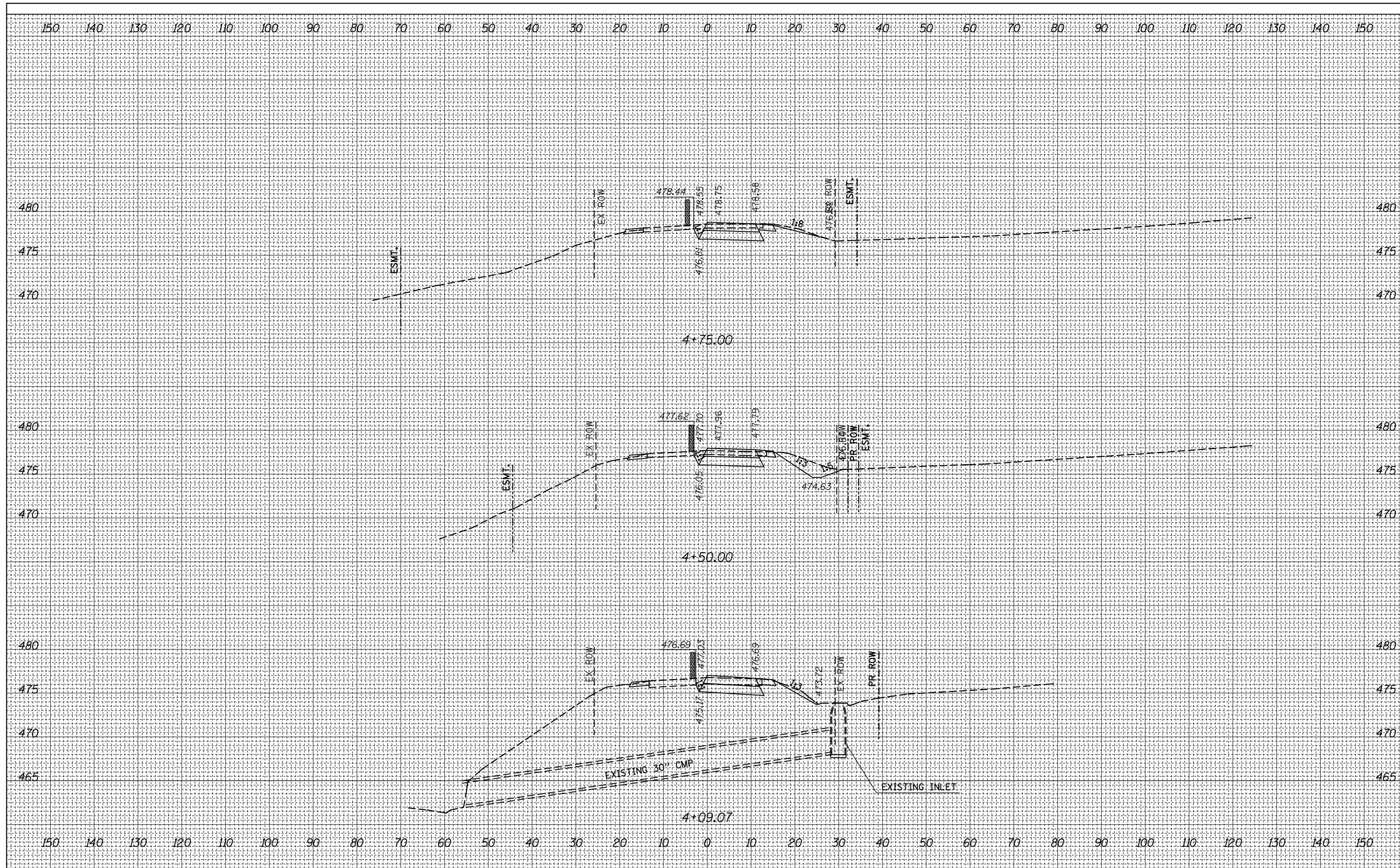

FILE NAME = c:\pwork\pwork\harbaugh\rd\0139799\0876401-ht-xssh-sr-1B.dgn	DESIGNED -	REVISED -	<b>STATE OF ILLINOIS</b> <b>DEPARTMENT OF TRANSPORTATION</b>	<b>SCALE: 1" = 10'</b>	<b>STAGE 1B CONSTRUCTION CROSS SECTIONS</b> <b>OLD CARPENTER ROAD</b>	F.A.S. RTE. = 770	SECTION = 64-1BR	COUNTY = MADISON	TOTAL SHEETS = 137	SHEET NO. = 42
PLOT SCALE = 20.0000 ' / in.	DRAWN -	REVISED -				CONTRACT NO. = 76401				
PLOT DATE = 2/3/2012	CHECKED -	REVISED -				ILLINOIS FED. AID PROJECT				
	DATE -	REVISED -				SCALE: 1" = 10'    SHEET 3 OF 4 SHEETS    STA. 4+09.07 TO STA. 4+75.00				