

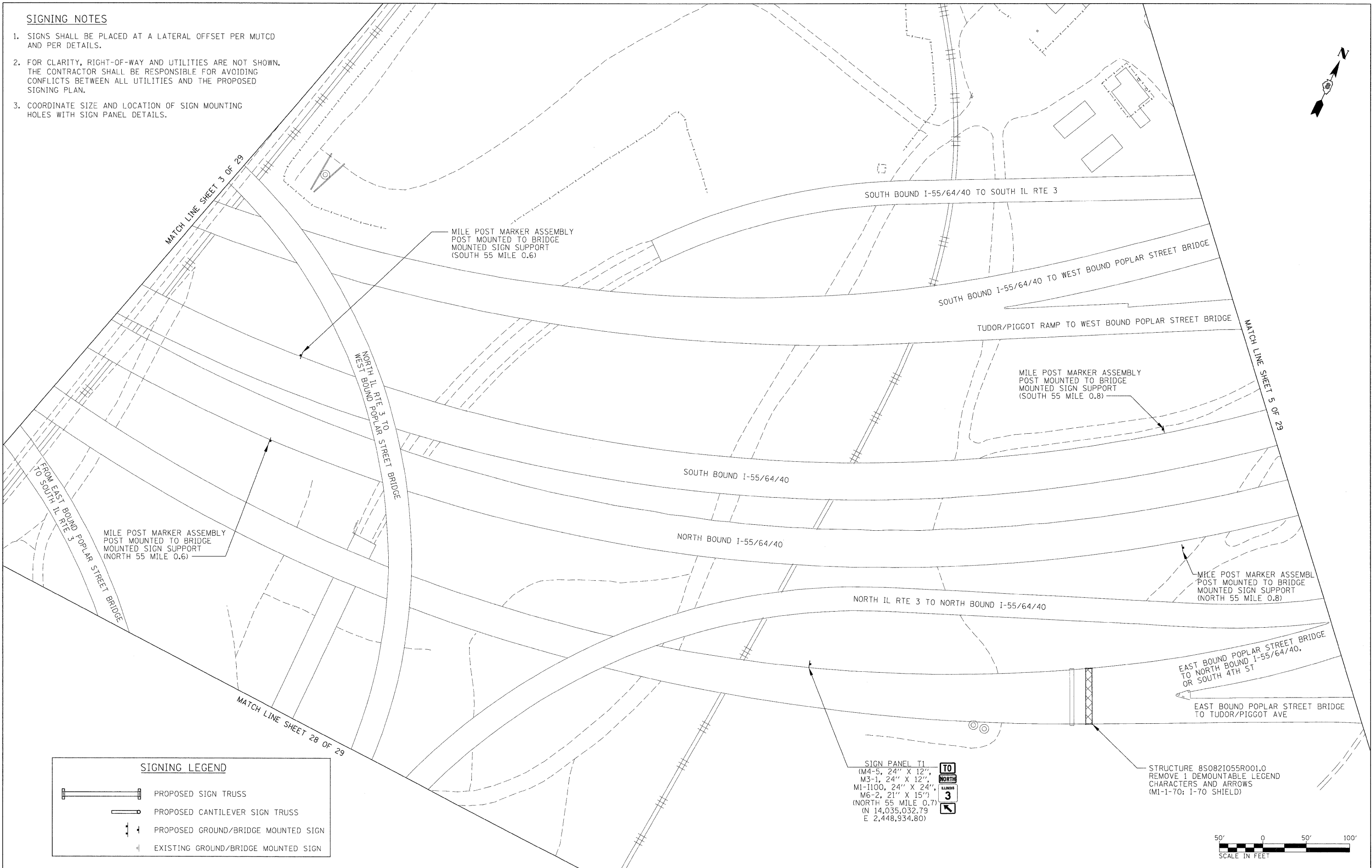

SIGNING NOTES

1. SIGNS SHALL BE PLACED AT A LATERAL OFFSET PER MUTCD AND PER DETAILS.
2. FOR CLARITY, RIGHT-OF-WAY AND UTILITIES ARE NOT SHOWN. THE CONTRACTOR SHALL BE RESPONSIBLE FOR AVOIDING CONFLICTS BETWEEN ALL UTILITIES AND THE PROPOSED SIGNING PLAN.
3. COORDINATE SIZE AND LOCATION OF SIGN MOUNTING HOLES WITH SIGN PANEL DETAILS.

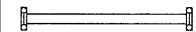

SIGNING LEGEND

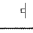
-  PROPOSED SIGN TRUSS
-  PROPOSED CANTILEVER SIGN TRUSS
-  PROPOSED GROUND/BRIDGE MOUNTED SIGN
-  EXISTING GROUND/BRIDGE MOUNTED SIGN

SIGN PANEL T1
 (M4-5, 24" X 12",
 M3-1, 24" X 12",
 M1-I100, 24" X 24",
 M6-2, 21" X 15")
 (NORTH 55 MILE 0.7)
 (N 14,035,032.79
 E 2,448,934.80)



STRUCTURE 850821055R001.0
 REMOVE 1 DEMOUNTABLE LEGEND
 CHARACTERS AND ARROWS
 (M1-1-70: 1-70 SHIELD)



FILE NAME = DBTR1-76C45-sht-sign4.dgn	USER NAME = mmccorach20	DESIGNED - PMK	REVISED -
		DRAWN - PMK	REVISED -
	PLOT SCALE = 50.0000' / 1"	CHECKED - MPW	REVISED -
	PLOT DATE = 2/2/2012	DATE - 2/2/2012	REVISED -

**STATE OF ILLINOIS
 DEPARTMENT OF TRANSPORTATION**

SIGNING PLAN

SCALE: 1" = 50' SHEET NO. 4 OF 29 SHEETS STA. N/A TO STA. N/A

F.A.I. RTE.	SECTION	COUNTY	TOTAL SHEETS	SHEET NO.
•	82-15G	ST. CLAIR	145	26
•998/70/64			CONTRACT NO. 76C45	
FED. ROAD DIST. NO. [ILLINOIS] FED. AID PROJECT				