

PROP. CURVE 13EPP1  
 PI STA. = 339+89.14  
 $\Delta = 12^\circ 30' 25''$  (LT)  
 $D = 1^\circ 30' 55''$   
 $R = 3,781.36'$   
 $T = 414.36'$   
 $L = 825.42'$   
 $e = 2.5\%$   
 $e = 22.63'$   
 P.C. STA. = 335+74.79  
 P.T. STA. = 344+00.21  
 SUPERELEVATION TRANSITION  
 STA. 335+46.80 TO STA. 336+30.80

PROP. CURVE 13EPP2  
 PI STA. = 345+50.86  
 $\Delta = 7^\circ 51' 36''$  (LT)  
 $D = 2^\circ 36' 46''$   
 $R = 2,192.89'$   
 $T = 150.65'$   
 $L = 300.82'$   
 $e = 5.17'$   
 $e = 2.5\%$   
 P.C. STA. = 344+00.21  
 P.T. STA. = 347+01.03

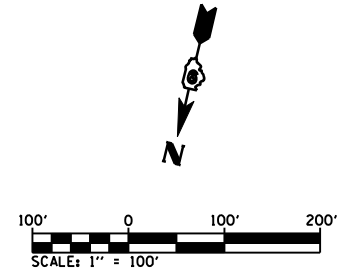
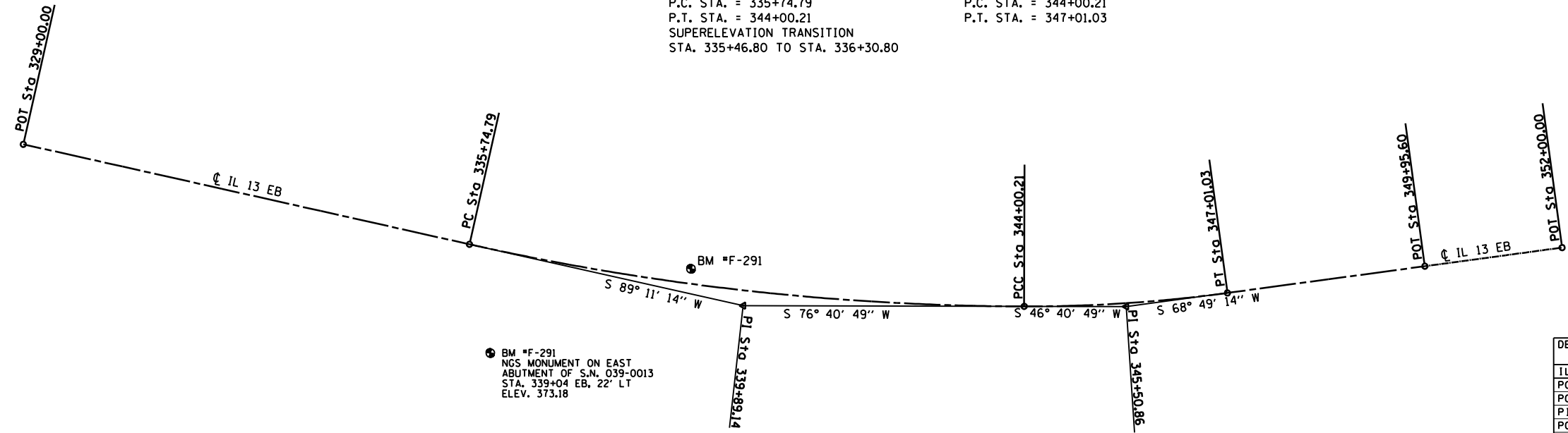

GROUND COORDINATES

DESCRIPTION	NORTHING	EASTING
IL RTE 13 (EB)		
POT STA. 329+00.00	401,159.054	2,541,681.422
PC STA. 335+74.79	401,149.484	2,541,006.705
PI STA. 339+89.14	401,143.607	2,540,592.387
PCC STA. 344+00.21	401,048.145	2,540,042.579
PI STA. 345+50.86	401,013.439	2,540,042.579
PT STA. 347+01.03	400,959.010	2,539,902.106
POT STA. 349+95.60	400,852.809	2,539,628.012
POT STA. 352+00.00	400,778.962	2,539,437.422

PROP. CURVE 13WPP1  
 PI STA. = 341+93.56  
 $\Delta = 20^\circ 22' 01''$  (LT)  
 $D = 2^\circ 00' 28''$   
 $R = 2,853.59'$   
 $T = 512.59'$   
 $L = 1,014.37'$   
 $E = 45.67'$   
 $e = 2.5\%$   
 P.C. STA. = 336+80.97  
 P.T. STA. = 346+95.33  
 SUPERELEVATION TRANSITION  
 STA. 335+46.00 TO STA. 336+30.00  
 STA. 346+53.30 TO STA. 347+90.60

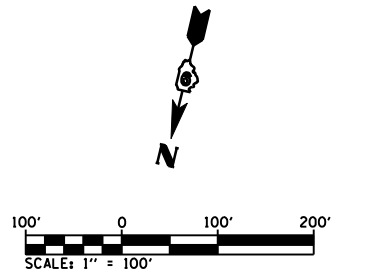
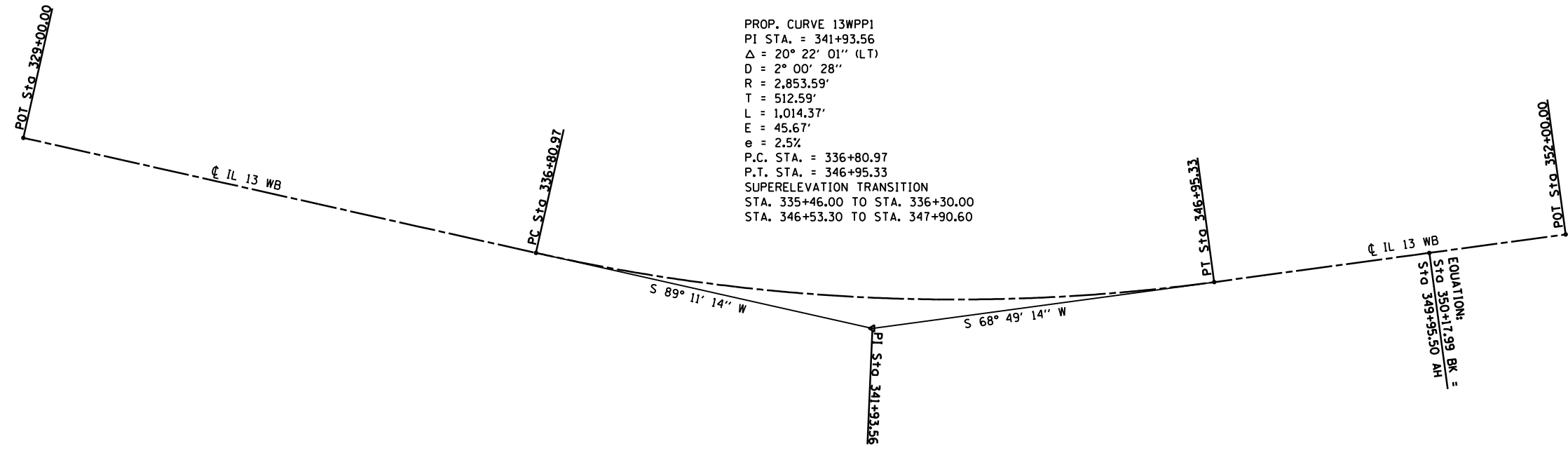

GROUND COORDINATES

DESCRIPTION	NORTHING	EASTING
IL RTE 13 (WB)		
POT STA. 329+00.00	401,224.247	2,541,680.497
PC STA. 336+80.97	401,213.171	2,540,899.610
PI STA. 341+93.56	401,205.901	2,540,387.071
PT STA. 346+95.33	401,020.706	2,539,909.103
POT STA. 350+17.99BK = STA. 349+95.50 AH	400,904.131	2,539,608.238
POT STA. 352+00.00	400,830.247	2,539,417.551

FILE NAME = M:\28018\Microstation\0Phase1\1\0978056-sh1-ATB.dgn	USER NAME = default	DESIGNED -	REVISED -
PLOT SCALE = 200.0000' / IN.	CHECKED -	REVISED -	REVISED -
PLOT DATE = 1/25/2012	DATE -	REVISED -	REVISED -

**STATE OF ILLINOIS  
 DEPARTMENT OF TRANSPORTATION**

**ALIGNMENT AND TIE SHEETS  
 IL RTE 13 OVER BIG MUDDY RIVER**

SCALE: SHEET NO. 1 OF 2 SHEETS STA. TO STA.

F.A.P. RTE. 331	SECTION (12-1)-B-1	COUNTY JACKSON	TOTAL SHEETS 200	SHEET NO. 21
CONTRACT NO. 78056				
ILLINOIS FED. AID PROJECT				