

- Notes:
- ① For Sections A-A, B-B, D-D and View C-C, see sheet 23 of 53.
 - ② a16(E), a17(E), a18(E) and a19(E) bar spacings measured along \perp Roadway.
 - ③ Tilt #9 b7(E) bars as required to maintain clearance.
 - ④ Flexible foam expansion joint filler according to Article 1051.09 of the Std. Specifications; full depth of slab, full length of parapet. Cost included with Concrete Superstructure.

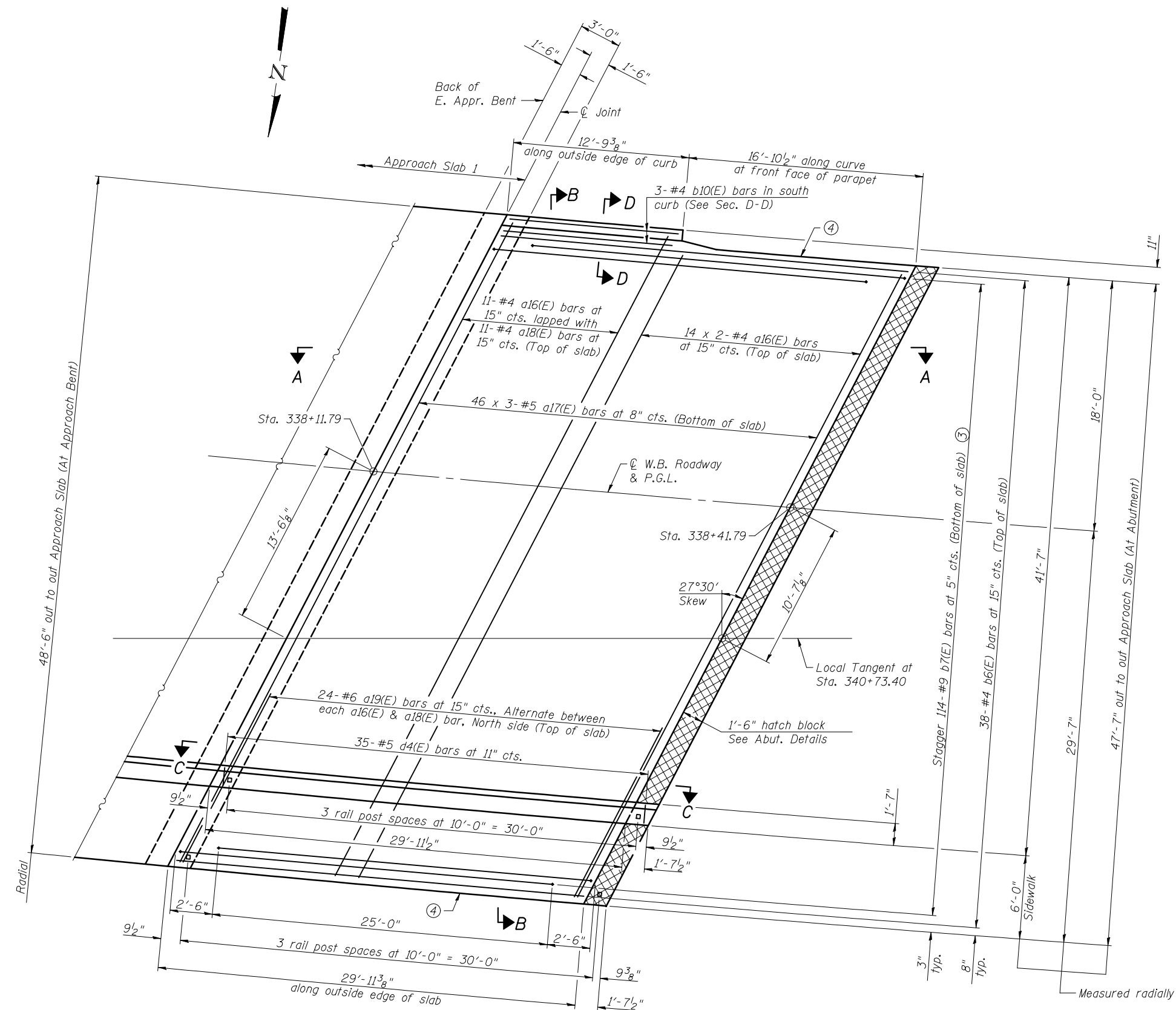

MIN. BAR LAP
 #4 bar = 2'-4"
 #5 bar = 2'-11"

PLAN



USER NAME =	DESIGNED - MAG	REVISED -
CHECKED - JAD	REVISIONS -	
PLOT SCALE =	DRAWN - MAG	REVISED -
PLOT DATE =	CHECKED - JAD	REVISED -

**STATE OF ILLINOIS
 DEPARTMENT OF TRANSPORTATION**

**BRIDGE APPROACH SLAB 2 DETAILS
 STRUCTURE NO. 039-0076 (W.B.)**

SHEET NO. 21 OF 53 SHEETS

F.A.P. RTE.	SECTION	COUNTY	TOTAL SHEETS	SHEET NO.
331	(12-1)B-1	JACKSON	200	133
CONTRACT NO. 78056				

ILLINOIS FED. AID PROJECT