

Notes: See sheet 14 of 25 for Sections C-C & D-D and View E-E.  
 $a_{100}$  (E),  $a_{101}$  (E),  $a_{102}$  (E),  $a_{103}$  (E),  $w_{100}$  (E) and  $w_{101}$  (E) bar spacings measured along  $\varnothing$  Rdwy.

\*\*\*Cost included with Concrete Superstructure.

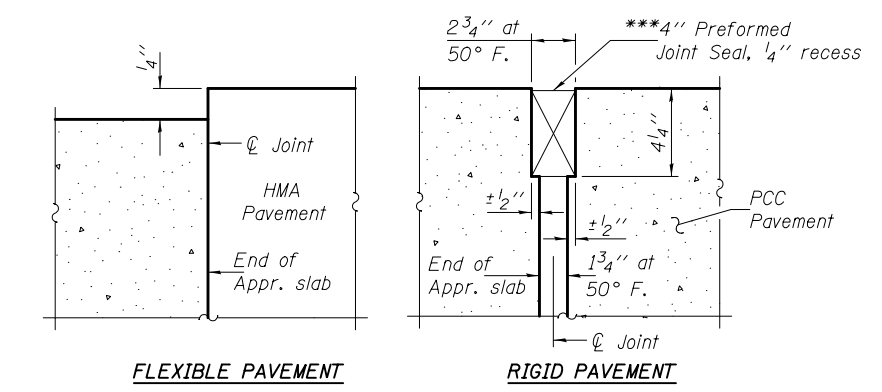

DETAIL A

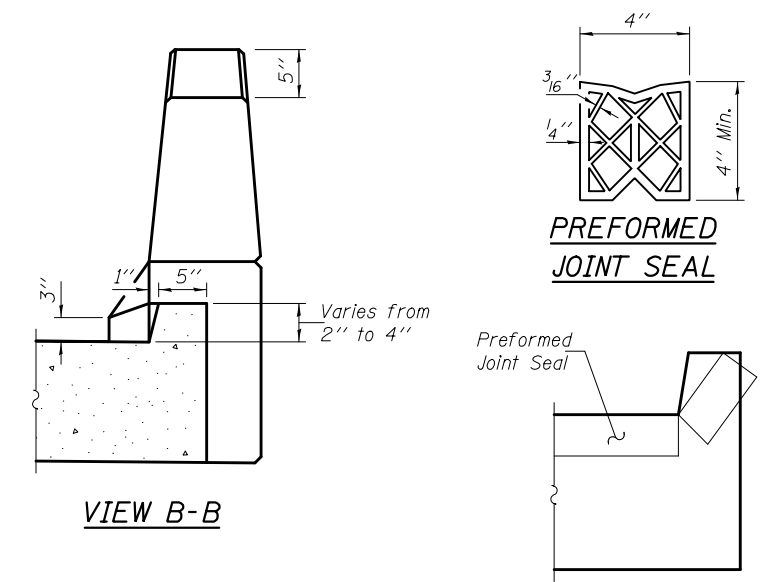

VIEW B-B

VIEW F-F

Angle Preformed Joint Seal at 45° at curbs when req'd for drainage.

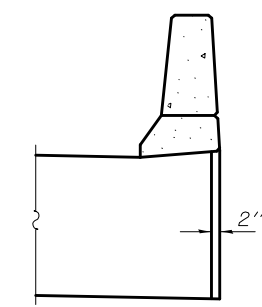

VIEW G-G

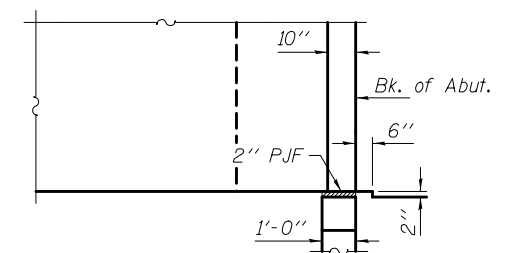

PLAN

(Parapet and approach not included)

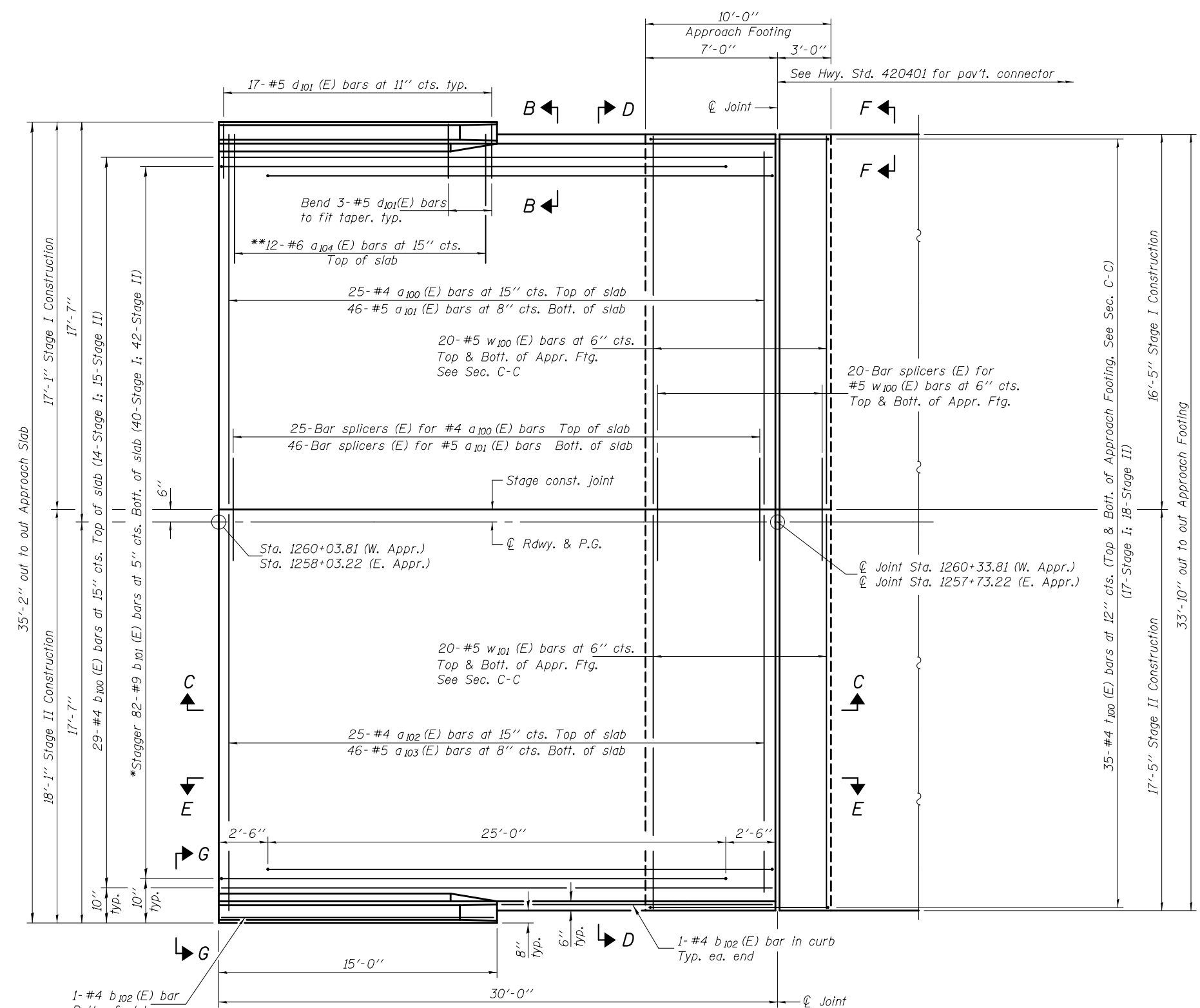

PLAN

(West Approach shown - East Approach similar by mirror image)

\*Tilt #9  $b_{101}$  (E) bars as required to maintain clearance.  
 \*\*Spaced between  $a_{100}$  (E) &  $a_{102}$  (E) bars, typ. ea. parapet.

DESIGNED - Nicholas R. Barnett	EXAMINED - <i>Thomas Domagalick</i>	DATE - MARCH 20, 2012
CHECKED - Michael D. Rolape	PASSED - <i>Michael D. Rolape</i>	REVISOR
DRAWN - h.t. duong	ENGINEER OF BRIDGES AND STRUCTURES	REVISOR
CHECKED - NRB/MDR		

STATE OF ILLINOIS  
 DEPARTMENT OF TRANSPORTATION

BRIDGE APPROACH SLAB DETAILS  
 STRUCTURE NO. 076-0031

SHEET NO. 13 OF 25 SHEETS

F.A.P. R.T.E.	SECTION	COUNTY	TOTAL SHEETS	SHEET NO.
885	6B-2	POPE	51	30
CONTRACT NO. 78168				
ILLINOIS FED. AID PROJECT				