

Stage 1 Removal

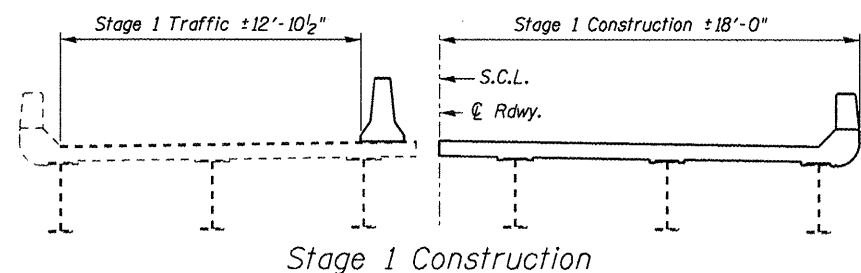

Stage 1 Construction

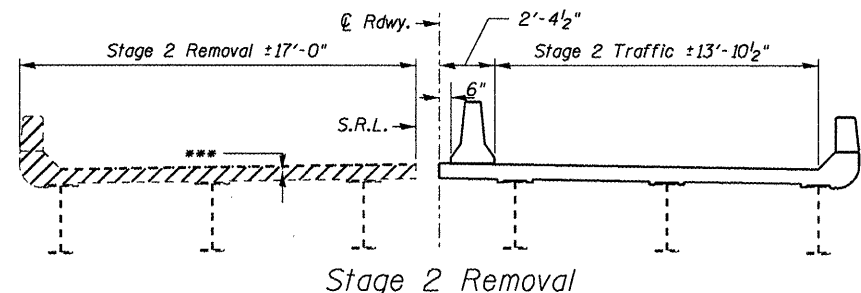

Stage 2 Removal

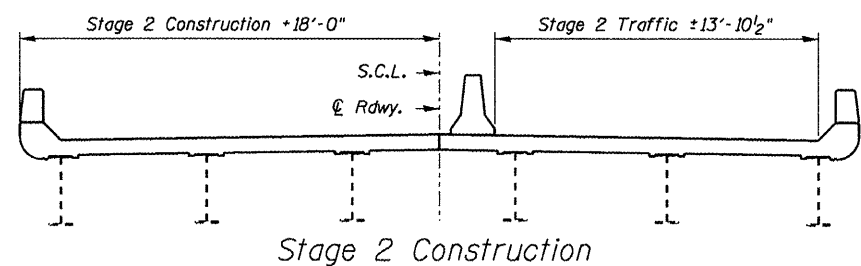

Stage 2 Construction

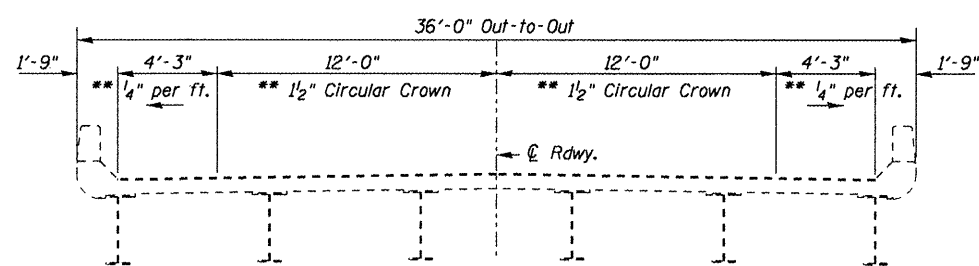

Section Through Structure  
SN 097-0002

### SUGGESTED SEQUENCE OF CONSTRUCTION

SN 097-0001

1. Set up TC&P 701402 for work on inside passing lane and TC&P 701411 for keeping entrance ramp open to I-64 EB.
2. Perform concrete removal as shown on the joint detail sheets.
3. Attach stud shear connectors.
4. Construct new strip seal joints as shown on the joint detail sheets.
5. Plug existing deck drains during cure.
6. Adjust TC&P 701402 for work on outside driving lane. Close the entrance ramp to I-64 EB by replacing TC&P 701411 with TC&P 701451.
7. Perform concrete removal as shown on joint detail sheets.
8. Attach stud shear connectors.
9. Construct new strip seal joints as shown on the joint detail sheets.
10. Plug existing deck drains during concrete cure.
11. Remove TC&P 701402 and TC&P 701451.

SN 097-0002

1. Set up TC&P 701402 for work on inside passing lane and TC&P 701411 for keeping exit ramp open to IL 1.
2. Perform concrete removal as shown on the joint details sheets.
3. Attach stud shear connectors.
4. Construct new strip seal joints as shown on the joint details sheet.
5. Plug existing deck drains during cure.
6. Adjust TC&P 701402 for work on outside driving lane and adjust TC&P 701411 for keeping exit ramp open to IL 1.
7. Perform concrete removal as shown on joint detail sheets.
8. Attach stud shear connectors.
9. Construct new strip seal joints as shown on the joint details sheet.
10. Plug existing deck drains during concrete cure.
11. Remove TC&P 701402 and TC&P 701411.

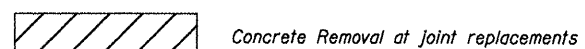

NOTES:

If the contractor chooses to modify the Suggested Sequence of Construction, the contractor shall submit a revised sequence of construction and traffic control layout details for review and acceptance by the Engineer.

All Sections looking East.

- \* 2 Spaces @ 6'-11 5/8" @ West Abutment = 13'-11 1/4"
- 2 Spaces @ 4'-0 3/4" @ East Abutment = 8'-1 1/2"

\*\* These match the existing cross slopes.

\*\*\* Existing 1/4" HMA Surface Course with 1/2" Waterproof Membrane System per existing plans.

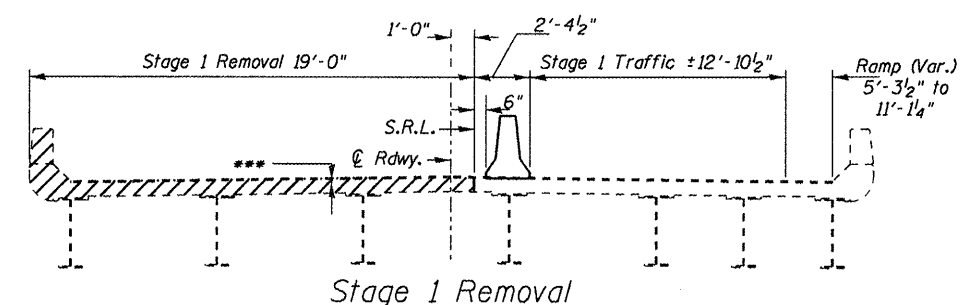

Stage 1 Removal

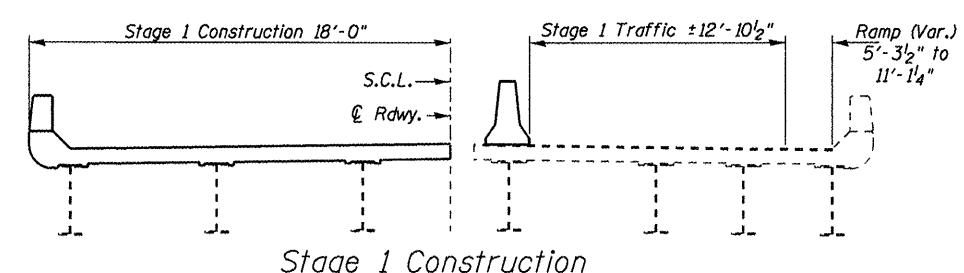

Stage 1 Construction

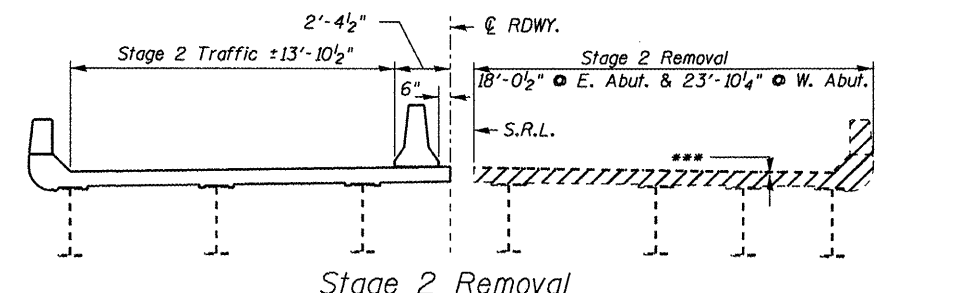

Stage 2 Removal

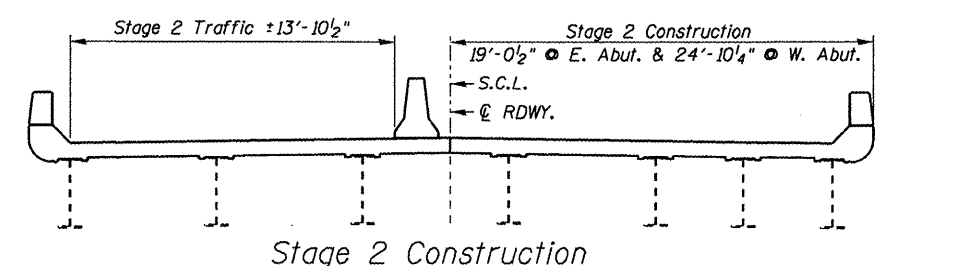

Stage 2 Construction

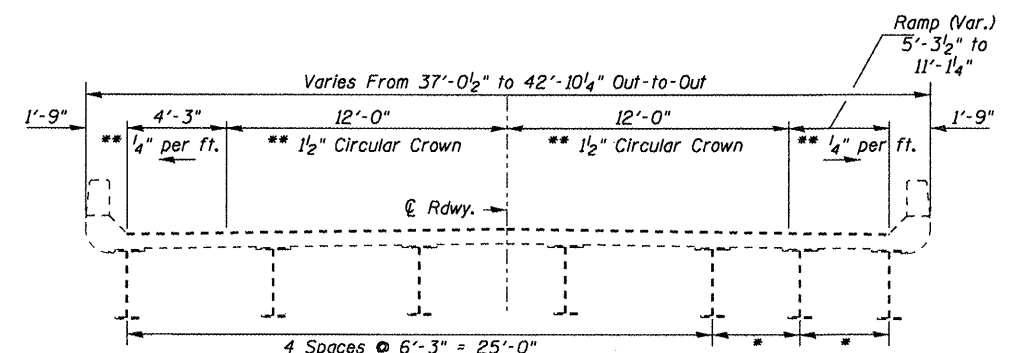

Section Through Structure  
SN 097-0001

FILE NAME: c:\pwwork\pindot\vidaman\08253211\78254 joint.rep.plt.dgn

USER NAME = odamsan	DESIGNED -	REVISED -
PLOT SCALE = 8.0000' / 1"	DRAWN -	REVISED -
PLOT DATE = 2/21/2012	CHECKED -	REVISED -
	DATE -	REVISED -

STATE OF ILLINOIS  
DEPARTMENT OF TRANSPORTATION

STAGING DETAILS

SCALE: \_\_\_\_\_ SHEET NO. \_\_\_\_\_ OF \_\_\_\_\_ SHEETS STA. \_\_\_\_\_ TO STA. \_\_\_\_\_

F.A.I. RTE.	SECTION	COUNTY	TOTAL SHEETS	SHEET NO.
64	D9 CM BRIDGE REP 2012-4	WHITE	13	6
CONTRACT NO. 78254			ILLINOIS FED. AID PROJECT	