

15+1 = 16

04-27-12 LETTING ITEM 123

INDEX OF SHEETS

Sheet #1	Cover Sheet/ Title Sheet
Sheet #2	Legend, Quantities, Typical Sections & Utility Contacts
Sheet #3-4	South Street Existing Conditions & Removal Plans
Sheet #5-8	Plan & Profiles
Sheet #9	Intersection Grading
Sheet #10-11	Grading & Storm Water Pollution Prevention Plan
Sheet #12-15	Cross-Sections

STATE OF ILLINOIS
DEPARTMENT OF TRANSPORTATION
DIVISION OF HIGHWAYS

PLANS FOR PROPOSED
SAFE ROUTES TO SCHOOL PROJECT
MS 1060 (SOUTH STREET)
SIDEWALK IMPROVEMENTS
RIDGE ST. TO GROVE ST.
VILLAGE OF CRESTON
OGLE COUNTY

SECTION: 10-00007-00-SW
PROJECT NO: SRTS-4009 (054)
JOB NO. C-40-045-09
CONTRACT NO. 85541

P.A. RTE.	SECTION	COUNTY	TOTAL SHEETS	SHEET NO.
	10-00007-00-SW	OGLE	15	1
SRTS-4009(054)		ILLINOIS	CONTRACT NO. 85541	

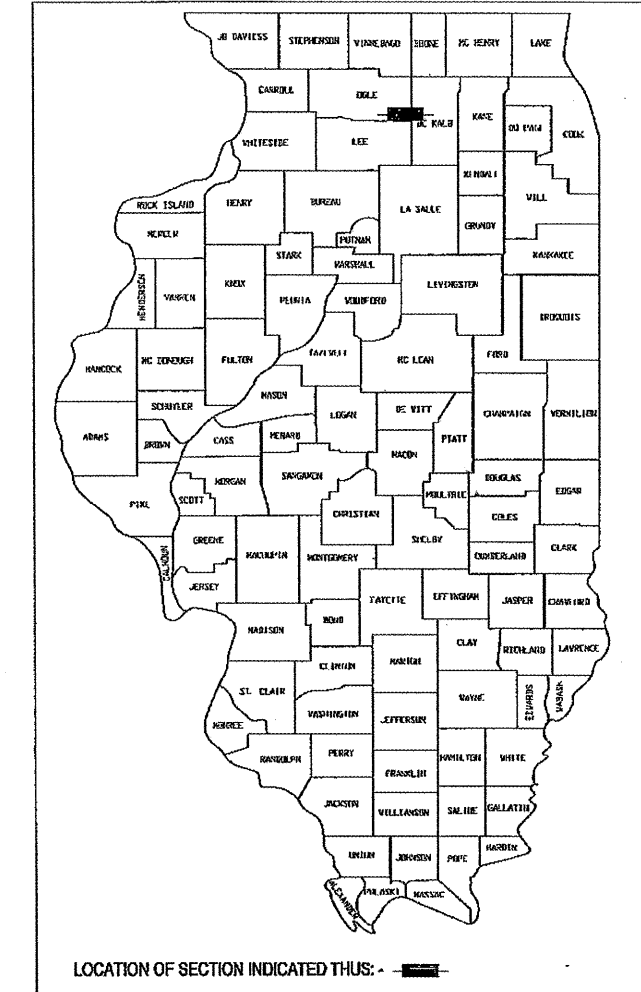

HIGHWAY STANDARDS

280001-06	TEMPORARY EROSION CONTROL SYSTEMS
424001-06	CURB RAMPS FOR SIDEWALKS
701001-02	OFF-ROAD OPERATIONS, 2L, 2W, MORE THAN 15' AWAY
701006-03	OFF-ROAD OPERATIONS, 2L, 2W, 15' TO 24" FROM PAVEMENT EDGE
701301-04	LANE CLOSURE, 2L, 2W, SHORT TIME OPERATIONS
701501-06	URBAN LANE CLOSURE, 2L, 2W, UNDIVIDED
701801-05	LANE CLOSURE MULTILANE 1W OR 2W CROSSWALK OR SIDEWALK CLOSURE
701901-02	TRAFFIC CONTROL DEVICES
720001-01	SIGN PANEL MOUNTING DETAILS
720006-03	SIGN PANEL ERECTION DETAILS
728001-01	TELESCOPING STEEL SIGN SUPPORT
729001-01	APPLICATIONS OF TYPES A & B METAL POSTS (FOR SIGNS & MARKERS)

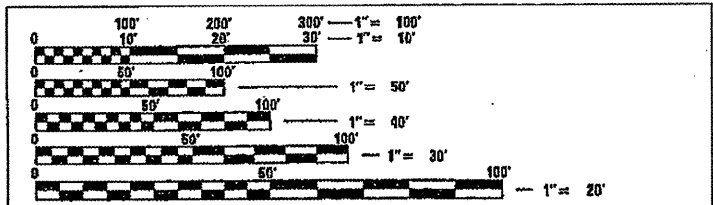
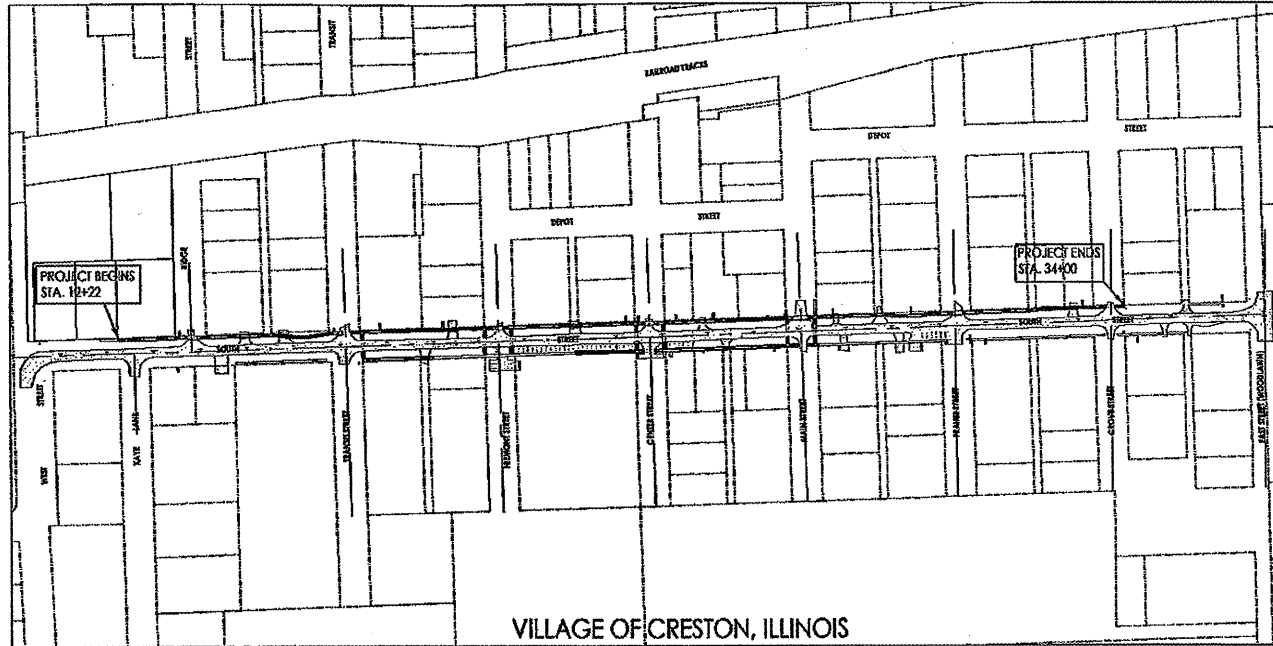

SCALES FOR PLAN & PROFILES 11x17 SHEET	SCALES FOR PLAN & PROFILES 22x34 SHEET
1" = 40' HORIZ.	1" = 40' HORIZ.
1" = 8' VERT.	1" = 8' VERT.

FULL SIZE PLANS HAVE BEEN PREPARED USING STANDARD ENGINEERING SCALES. REDUCED SIZE PLANS WILL NOT CONFORM TO STANDARD SCALES. IN MAKING MEASUREMENTS ON REDUCED PLANS, THE ABOVE SCALES MAY BE USED.

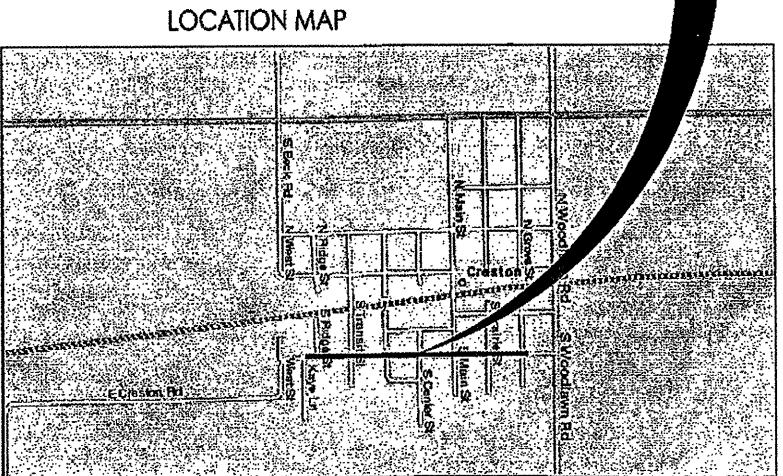

GROSS LENGTH.....2830' OR 0.536 MILES
NET LENGTH.....2175' OR 0.412 MILES

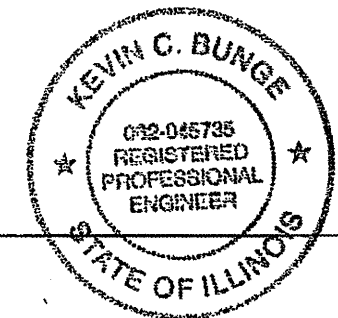
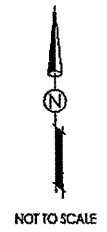

STATE OF ILLINOIS
DEPARTMENT OF TRANSPORTATION
DIVISION OF HIGHWAYS

APPROVED 3/2 2012
Thomas D. Bago
VILLAGE PRESIDENT VILLAGE OF CRESTON

PASSED March 3 2012
Paul J. [Signature]
DISTRICT ENGINEER OF LOCAL ROADS

RELEASED FOR BID
BASED ON LIMITED
REVIEW March 3 2012
E. J. [Signature]
DEPUTY DIRECTOR OF HIGHWAYS REGIONAL ENGINEER

CONTACT:
J.U.L.I.E.
DIAL: 811
PRIOR TO ANY CONSTRUCTION



UTILITY CONTACTS:
FRONTIER COMMUNICATIONS
DEB PETERSON
(815) 895-1524
ROCHELLE MUNICIPAL UTILITIES
CATHY COOPER
333 LINCOLN HIGHWAY
ROCHELLE, IL 61068
(815) 562-4155

PLANS PREPARED BY:
C.E.S. INC.
700 W. LOCUST ST.
BELVIDERE, IL 61008
PHONE: (815) 547-8435
FAX: (815) 544-0421
ILLINOIS DESIGN FIRM NO. 184-001220

C.E.S. JOB #3000

[Signature] 3/2/12
KEVIN C. BUNGE, PE
EXPIRES: 11/30/13

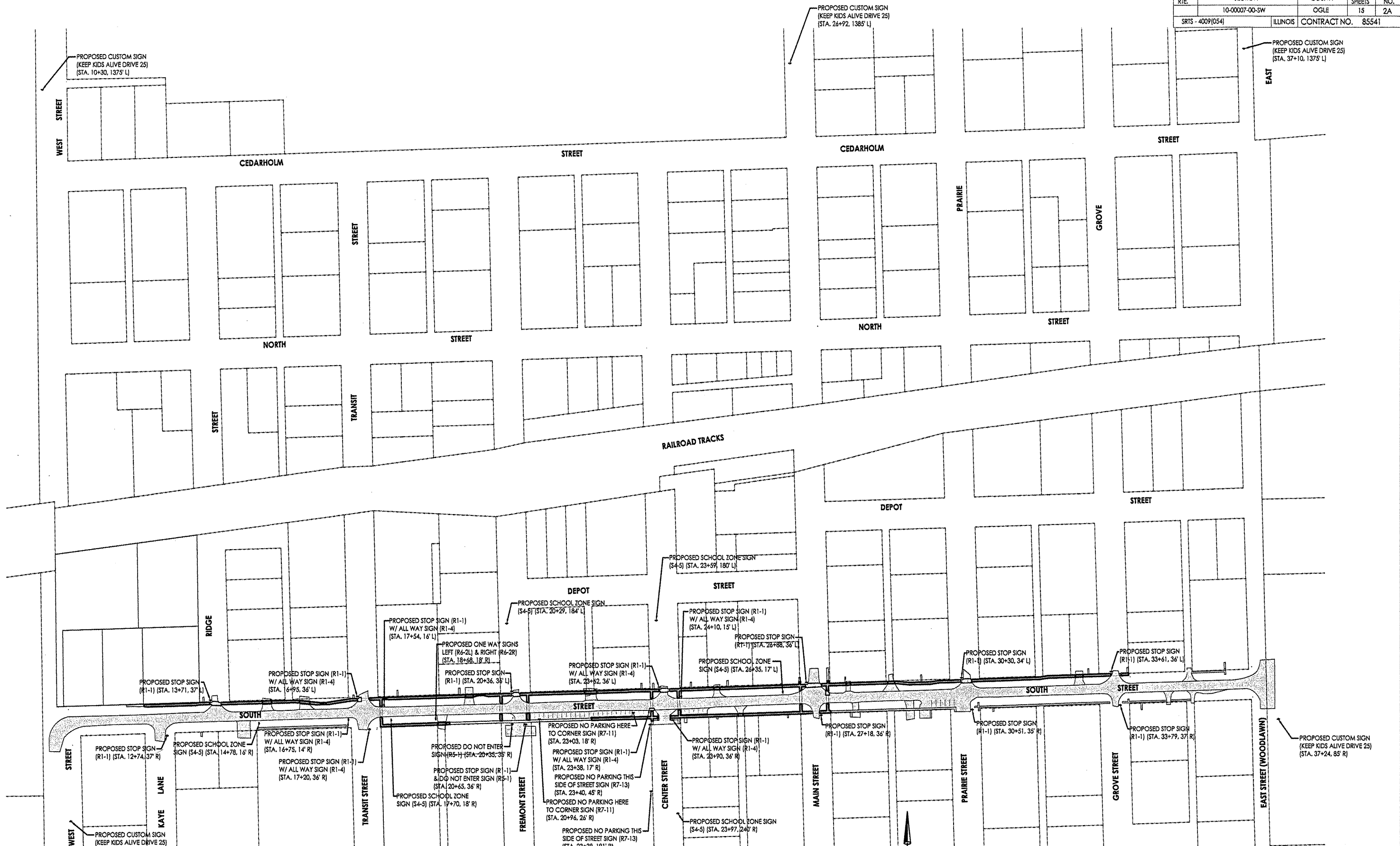

Date	Revision	By
6/12/11	REVISED PER IDOT REVIEW LETTER (DATED APRIL 27)	JAB
11/11/11	REVISED PER IDOT/RWA MEETING (JULY 20, 2011)	JAB
2/28/12	REVISED PER IDOT REVIEW LETTER (DATED JANUARY 19, 2012)	JAB
2/24/12	REVISED PER IDOT E-MAILS (FEBRUARY 15 & 18, 2012)	JAB

**Safe Routes to School
Supplemental Sign Plan**

CHECKED BY: HCB DATE: 02/18/11	DRAWN BY: JAB DATE: 02/18/11	Sheet 2A of 15
-----------------------------------	---------------------------------	-------------------

700 WEST LOCUST ST., BELVIDERE, IL 61008
(815)-547-8435 FAX: (815)-544-0421
ILLINOIS DESIGN FIRM NO. 184-001260

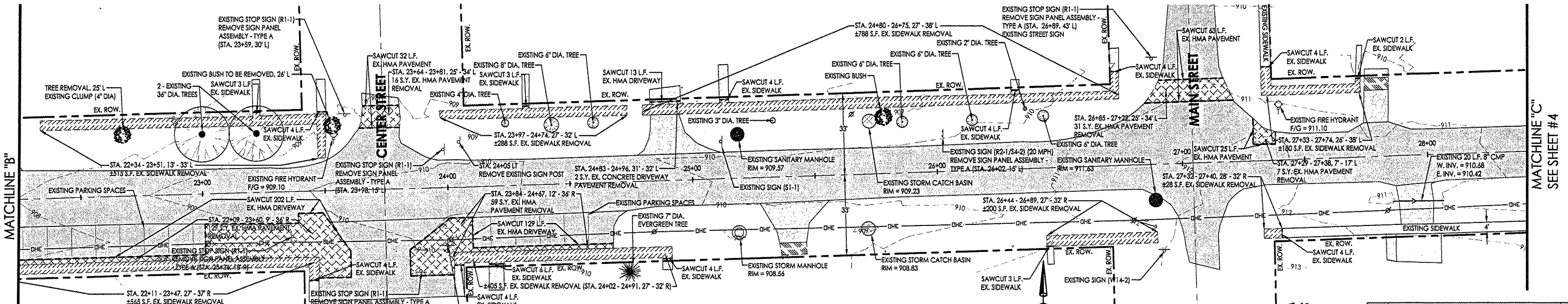
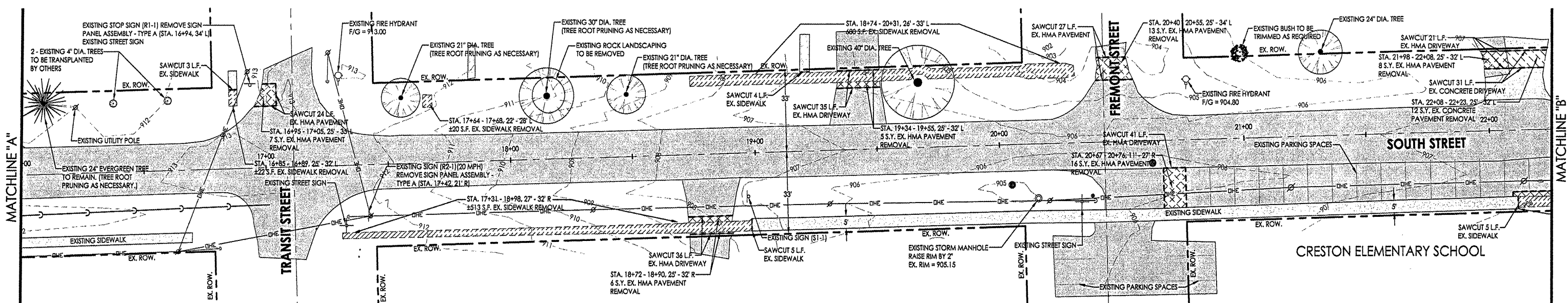
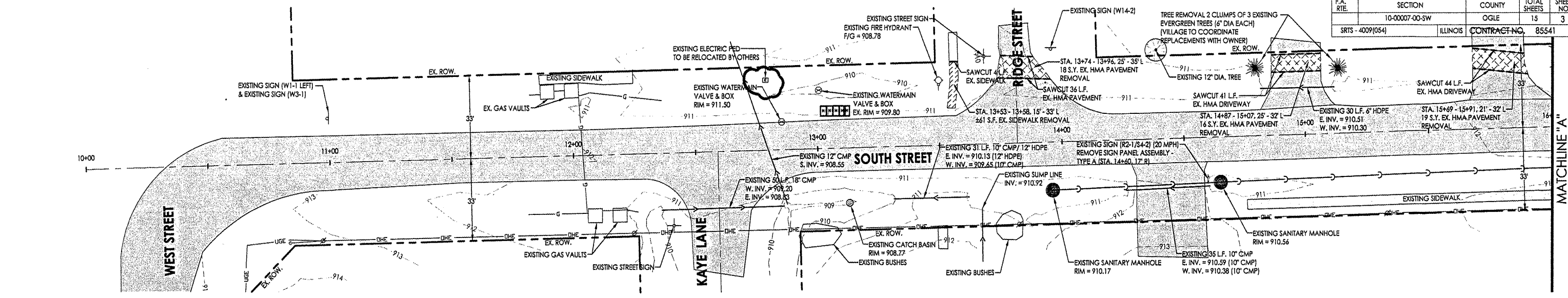

	REMOVE SIDEWALK (PAID UNDER SIDEWALK REMOVAL)		REMOVE CONCRETE DRIVEWAY (PAID UNDER PAVEMENT REMOVAL)		REMOVE HMA PAVEMENT (PAID UNDER PAVEMENT REMOVAL)		REMOVE AGGREGATE DRIVEWAY (INCIDENTAL TO CONCRETE SIDEWALK)
	EXISTING CONCRETE SIDEWALK		EXISTING CONCRETE DRIVEWAY		EXISTING HMA PAVEMENT		EXISTING AGGREGATE DRIVEWAY

VILLAGE TO NOTIFY OWNERS OF TREES TO BE REMOVED OR TRIMMED. ALL TREES DESIGNATED TO BE REMOVED ARE WITHIN THE VILLAGE ROW.

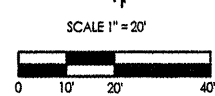

Date	Revision	By
5/1/21	REVISED PER IDOT REVIEW LETTER (DATED APRIL 27)	JAS
1/17/11	REVISED PER IDOT/HMA MEETING (JULY 20, 2011)	JAS
2/08/12	REVISED PER IDOT REVIEW LETTER (DATED JANUARY 19, 2012)	JAS
2/24/12	REVISED PER IDOT E-MAILS (FEBRUARY 15 & 16, 2012)	JAS

Safe Routes to School
South Street Existing Conditions & Removal Plan

CHECKED BY: MCB	DRAWN BY: JAB	Sheet
DATE: 02/18/11	DATE: 02/18/11	3 of 15

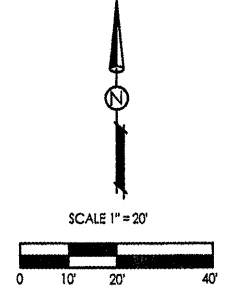
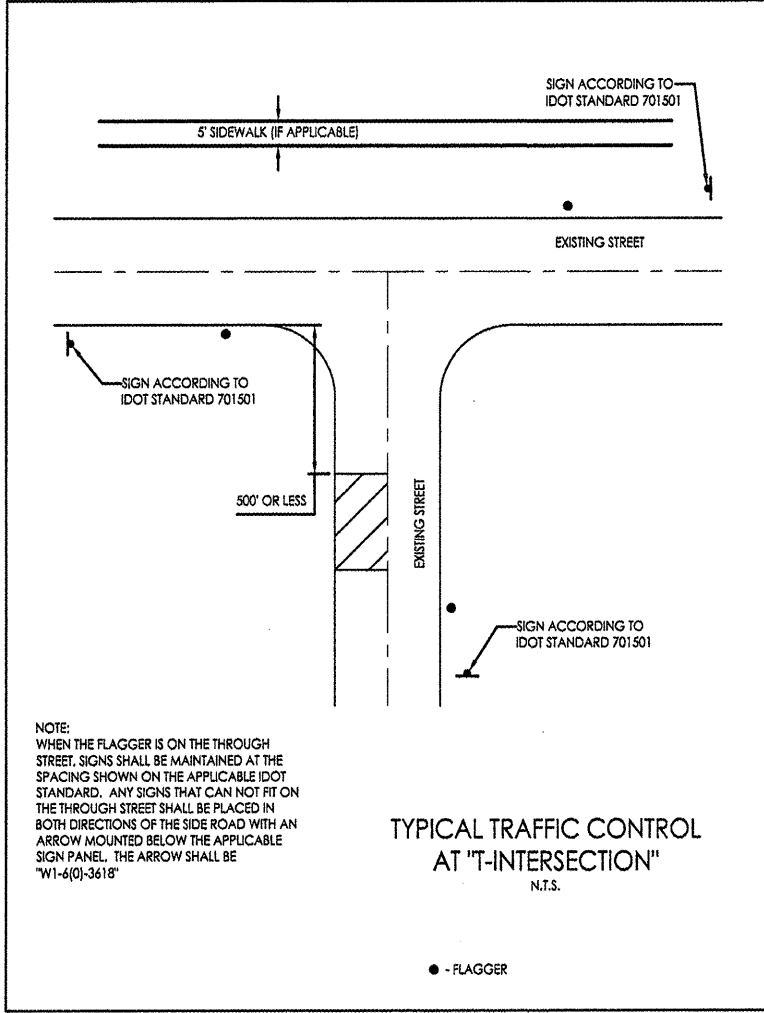
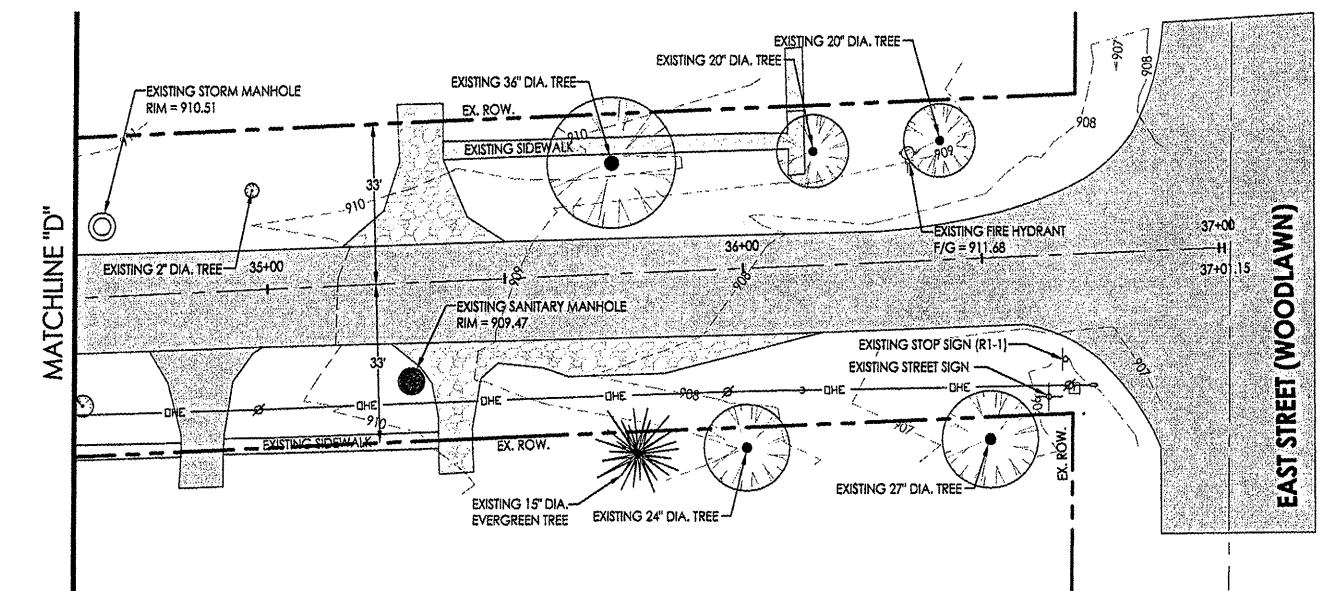
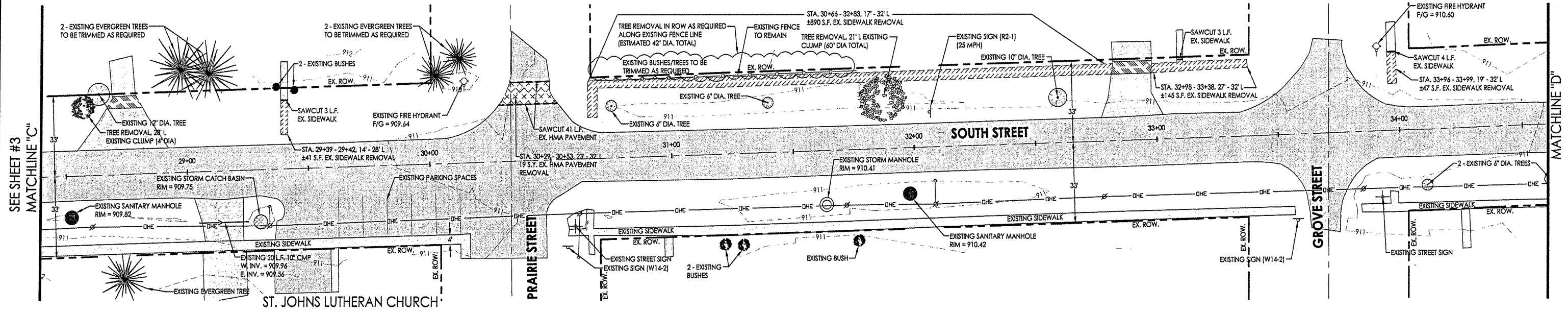

VILLAGE TO NOTIFY OWNERS OF TREES TO BE REMOVED OR TRIMMED.
ALL TREES DESIGNATED TO BE REMOVED ARE WITHIN THE VILLAGE ROW.

	REMOVE SIDEWALK (PAID UNDER SIDEWALK REMOVAL)		REMOVE CONCRETE DRIVEWAY (PAID UNDER PAVEMENT REMOVAL)		REMOVE HMA PAVEMENT (PAID UNDER PAVEMENT REMOVAL)		REMOVE AGGREGATE DRIVEWAY (INCIDENTAL TO CONCRETE SIDEWALK)
	EXISTING CONCRETE SIDEWALK		EXISTING CONCRETE DRIVEWAY		EXISTING HMA PAVEMENT		EXISTING AGGREGATE DRIVEWAY



700 WEST LOCUST ST., BELVIDERE, IL 61008
(815)-347-8435 FAX: (815)-344-0421
ILLINOIS DESIGN FIRM NO. 154-001250

Date	Revision	By
5/12/11	REVISED PER IDOT REVIEW LETTER (DATED APRIL 27)	JAB
1/11/11	REVISED PER IDOT/PRWA MEETING (JULY 20, 2011)	JAB
2/08/12	REVISED PER IDOT REVIEW LETTER (DATED JANUARY 19, 2012)	JAB
2/24/12	REVISED PER IDOT E-MAILS (FEBRUARY 15 & 18, 2012)	JAB

Safe Routes to School
South Street Existing Conditions & Removal Plan

CHECKED BY: KCB DATE: 02/18/11
DRAWN BY: JAB DATE: 02/18/11
3000_BASE.dwg

Sheet
4 of 15

PROFILE FOR SIDEWALK ON LEFT SIDE OF ROAD

FA. RTE.	SECTION	COUNTY	TOTAL SHEETS	SHEET NO.
10-00007-00-SW	10-00007-00-SW	OGLE	15	5
SRTS-4009(054)	ILLINOIS	CONTRACT NO. 85541		

SCALE:
1" = 20'-0" Horizontal
1" = 5'-0" Vertical

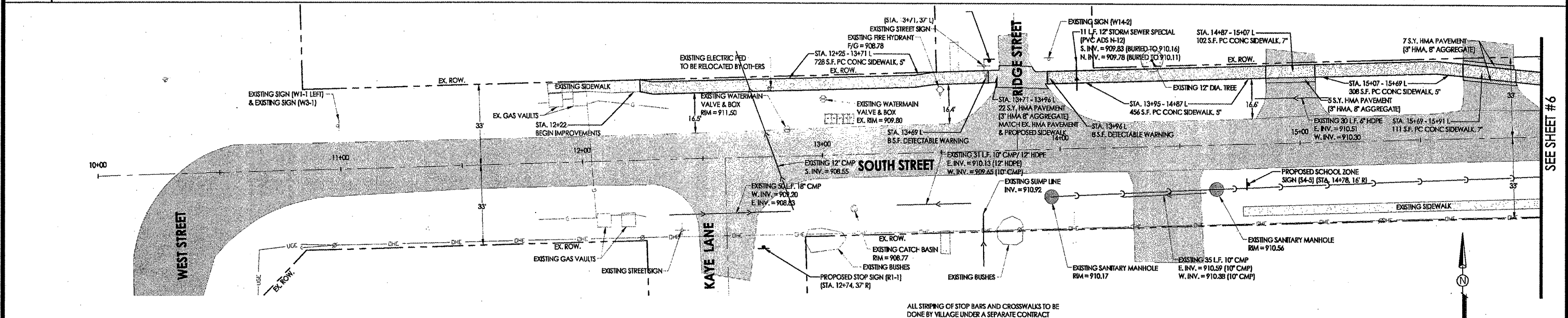
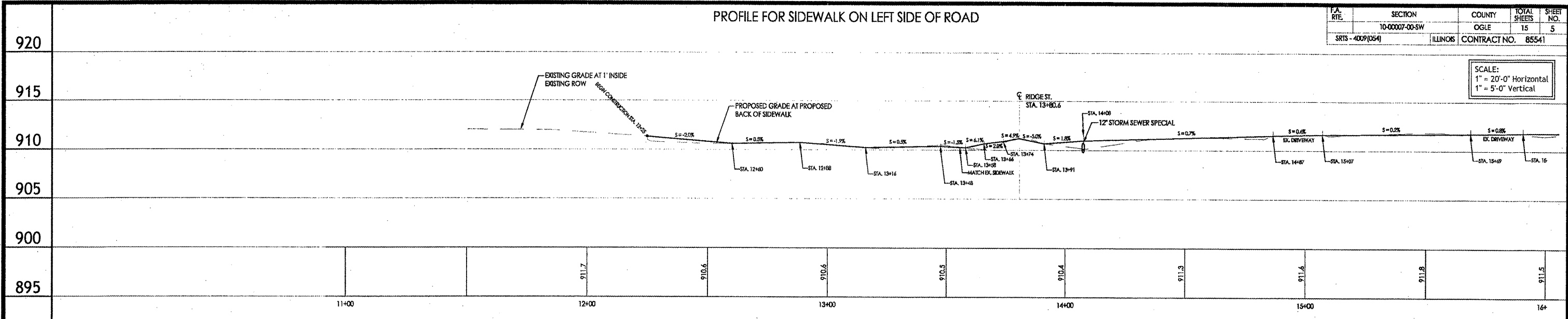

	EXISTING CONCRETE SIDEWALK		EXISTING CONCRETE DRIVEWAY		EXISTING ASPHALT PAVEMENT		EXISTING AGGREGATE DRIVEWAY
	PROPOSED CONCRETE SIDEWALK		PROPOSED CONCRETE DRIVEWAY		PROPOSED HMA PAVEMENT		PROPOSED AGGREGATE DRIVEWAY

ALL STRIPING OF STOP BARS AND CROSSWALKS TO BE DONE BY VILLAGE UNDER A SEPARATE CONTRACT
 VILLAGE TO NOTIFY OWNERS OF TREES TO BE REMOVED OR TRIMMED.
 ALL TREES DESIGNATED TO BE REMOVED ARE WITHIN THE VILLAGE ROW.
 USE STAINLESS STEEL DETECTABLE WARNING (2' X 4' PANEL TO ALLOW FOR A 6" FINISHED EDGE AROUND THE PLATE TO LOCK THE PLATE IN PLACE)
 ALL SIGNS TO BE "SIGN PANEL - TYPE 1" ON TELESCOPING STEEL SIGN SUPPORT.

PROFILE FOR SIDEWALK ON RIGHT SIDE OF ROAD

SCALE:
1" = 20'-0" Horizontal
1" = 5'-0" Vertical

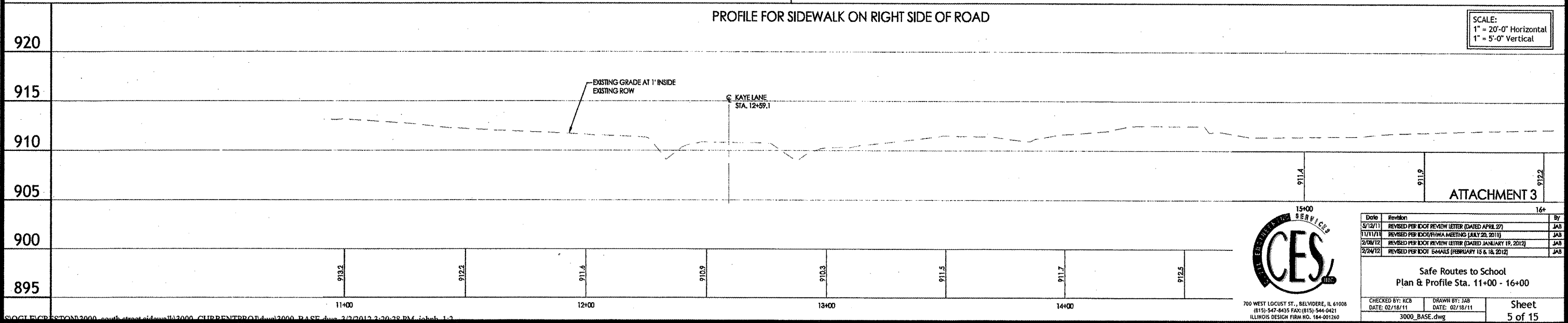

700 WEST LOCUST ST., BELVIDERE, IL 61008
 (815) 547-9435 FAX: (815) 544-0421
 ILLINOIS DESIGN FIRM NO. 164-001260

Date	Revision	By
5/12/11	REVISED PER IDOT REVIEW LETTER (DATED APRIL 27)	JAB
11/11/11	REVISED PER IDOT/IRMA MEETING (JULY 20, 2011)	JAB
2/08/12	REVISED PER IDOT REVIEW LETTER (DATED JANUARY 19, 2012)	JAB
2/24/12	REVISED PER IDOT E-MAILS (FEBRUARY 15 & 16, 2012)	JAB

Safe Routes to School
 Plan & Profile Sta. 11+00 - 16+00

CHECKED BY: KCB DATE: 02/18/11
 DRAWN BY: JAB DATE: 02/18/11

3000_BASE.dwg Sheet 5 of 15

PROFILE FOR SIDEWALK ON LEFT SIDE OF ROAD

F.A. RTE.	SECTION	COUNTY	TOTAL SHEETS	SHEET NO.
SRTS - 4009(054)	10-00007-00-SW	OGLE	15	6
		ILLINOIS	CONTRACT NO. 85541	

SCALE:
1" = 20'-0" Horizontal
1" = 5'-0" Vertical

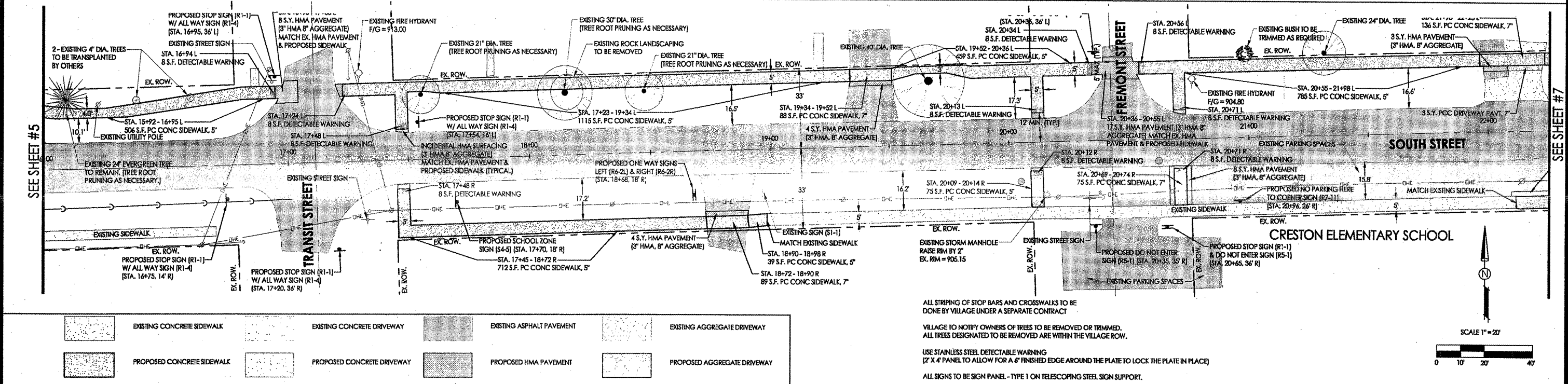
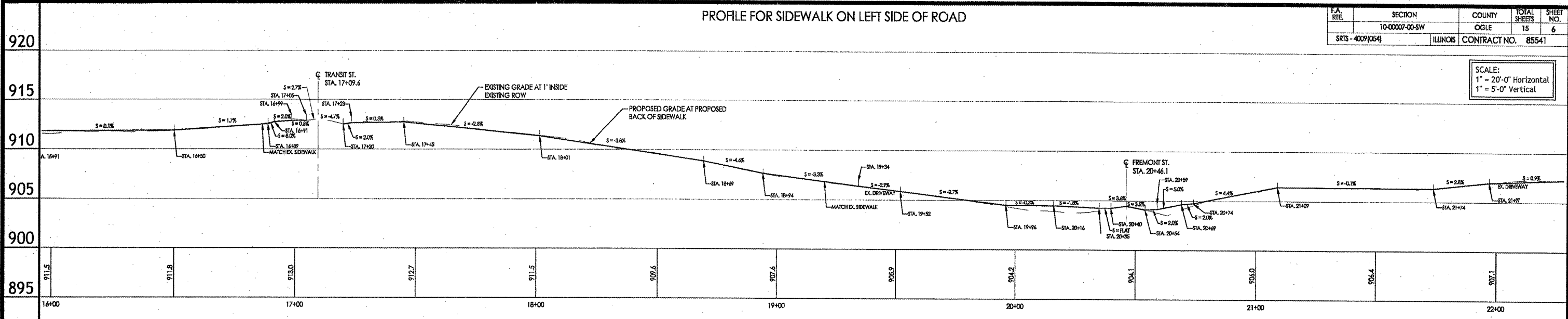

	EXISTING CONCRETE SIDEWALK		EXISTING CONCRETE DRIVEWAY		EXISTING ASPHALT PAVEMENT		EXISTING AGGREGATE DRIVEWAY
	PROPOSED CONCRETE SIDEWALK		PROPOSED CONCRETE DRIVEWAY		PROPOSED HMA PAVEMENT		PROPOSED AGGREGATE DRIVEWAY

ALL STRIPING OF STOP BARS AND CROSSWALKS TO BE DONE BY VILLAGE UNDER A SEPARATE CONTRACT
 VILLAGE TO NOTIFY OWNERS OF TREES TO BE REMOVED OR TRIMMED. ALL TREES DESIGNATED TO BE REMOVED ARE WITHIN THE VILLAGE ROW.
 USE STAINLESS STEEL DETECTABLE WARNING (2' X 4' PANEL TO ALLOW FOR A 6" FINISHED EDGE AROUND THE PLATE TO LOCK THE PLATE IN PLACE)
 ALL SIGNS TO BE SIGN PANEL - TYPE 1 ON TELESCOPING STEEL SIGN SUPPORT.

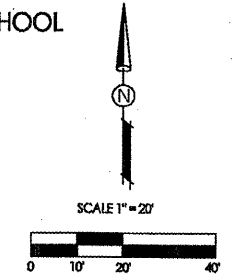

PROFILE FOR SIDEWALK ON RIGHT SIDE OF ROAD

SCALE:
1" = 20'-0" Horizontal
1" = 5'-0" Vertical

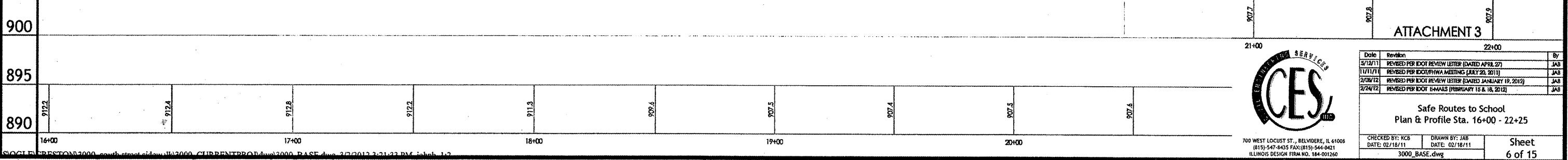
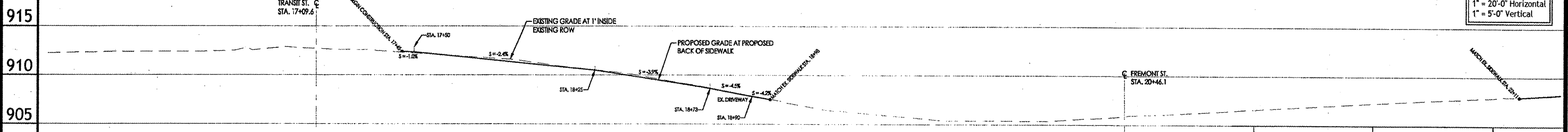

Date	Revision	By
5/12/11	REVISED PER IDOT REVIEW LETTER (DATED APRIL 22)	JAS
11/11/11	REVISED PER IDOT/PHVA MEETING (JULY 20, 2011)	JAS
2/26/12	REVISED PER IDOT REVIEW LETTER (DATED JANUARY 19, 2012)	JAS
2/24/12	REVISED PER IDOT E-MAILS (FEBRUARY 15 & 16, 2012)	JAS

Safe Routes to School
 Plan & Profile Sta. 16+00 - 22+25
 Checked by: KCB DATE: 02/18/11
 Drawn by: JAS DATE: 02/18/11
 3000_BASE.dwg
 Sheet 6 of 15

PROFILE FOR SIDEWALK ON LEFT SIDE OF ROAD

P.A. RTE.	SECTION	COUNTY	TOTAL SHEETS	SHEET NO.
SRTS - 4009(054)	10-00007-00-SW	OGLE	15	7
		ILLINOIS CONTRACT NO.	85541	

SCALE:
1" = 20'-0" Horizontal
1" = 5'-0" Vertical

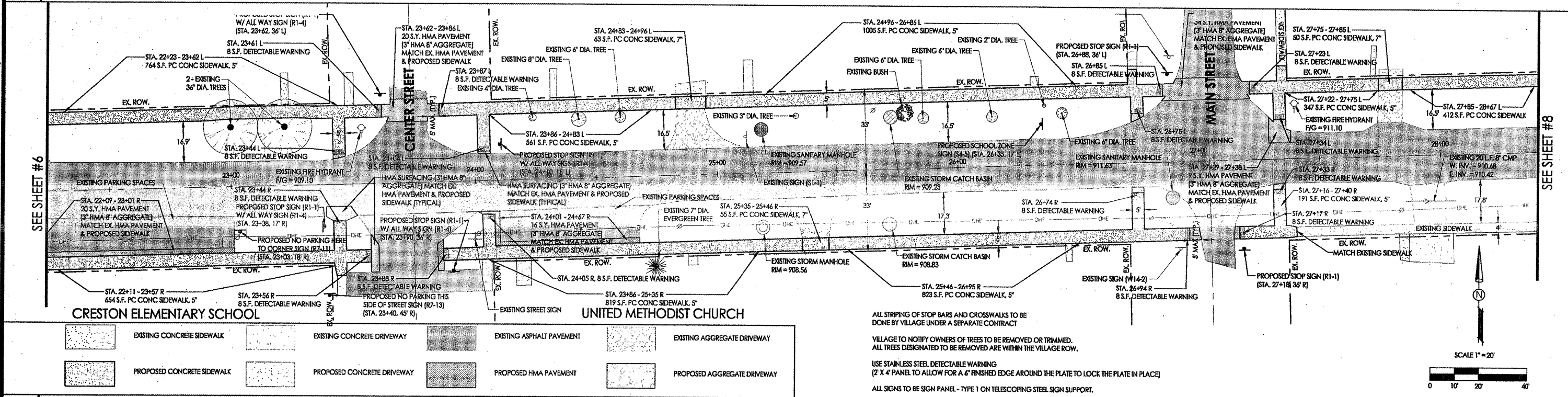
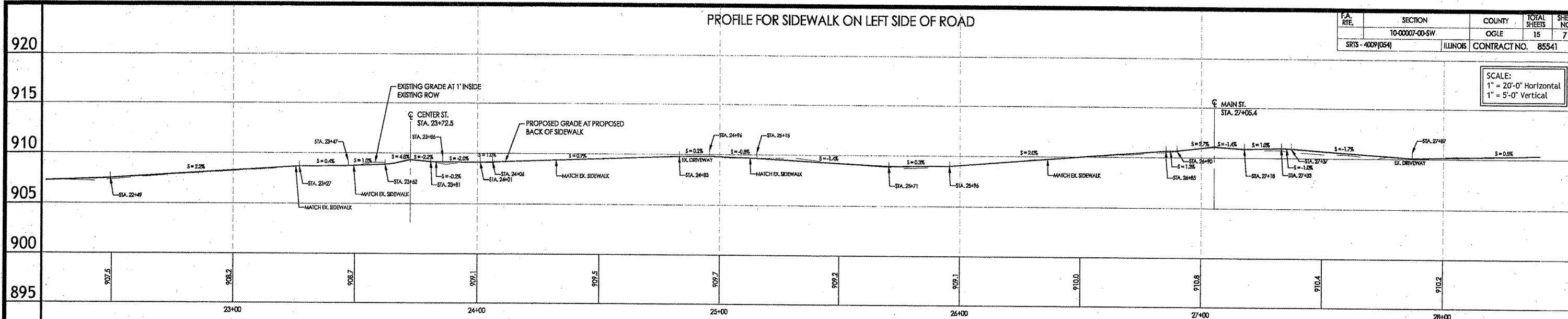

PROFILE FOR SIDEWALK ON RIGHT SIDE OF ROAD

SCALE:
1" = 20'-0" Horizontal
1" = 5'-0" Vertical

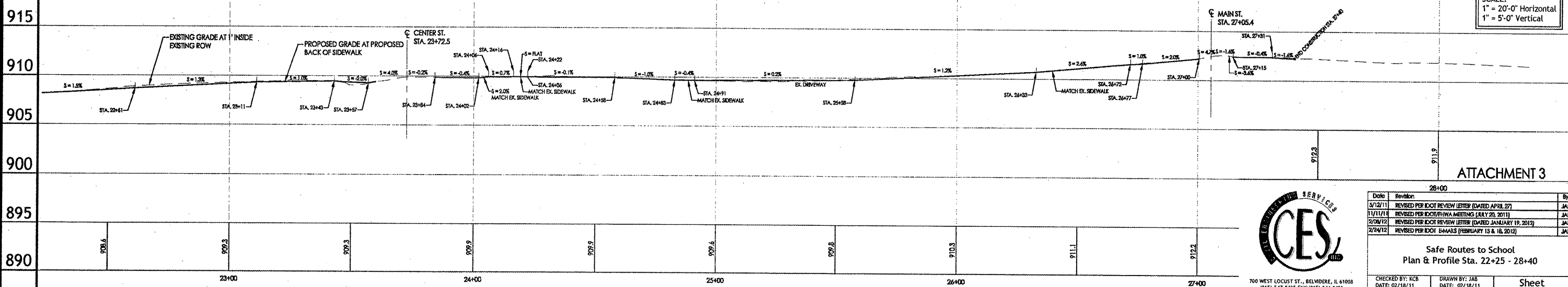

Date	Revision	By
5/12/11	REVISED PER DOT REVIEW LETTER (DATED APRIL 27)	JAB
1/11/11	REVISED PER DOT/CHA MEETING (JULY 28, 2011)	JAB
2/26/12	REVISED PER DOT REVIEW LETTER (DATED JANUARY 19, 2012)	JAB
2/24/12	REVISED PER DOT EMAILS (FEBRUARY 15 & 16, 2012)	JAB

Safe Routes to School
Plan & Profile Sta. 22+25 - 28+40

CHECKED BY: KCB DATE: 02/18/11
DRAWN BY: JAB DATE: 02/18/11

3000_BASE.dwg

PROFILE FOR SIDEWALK ON LEFT SIDE OF ROAD

F.A. RTE.	SECTION	COUNTY	TOTAL SHEETS	SHEET NO.
SR15 - 4009(054)	10-00007-00-SW	OGLE	15	8
		ILLINOIS	CONTRACT NO. 85541	

SCALE:
1" = 20'-0" Horizontal
1" = 5'-0" Vertical

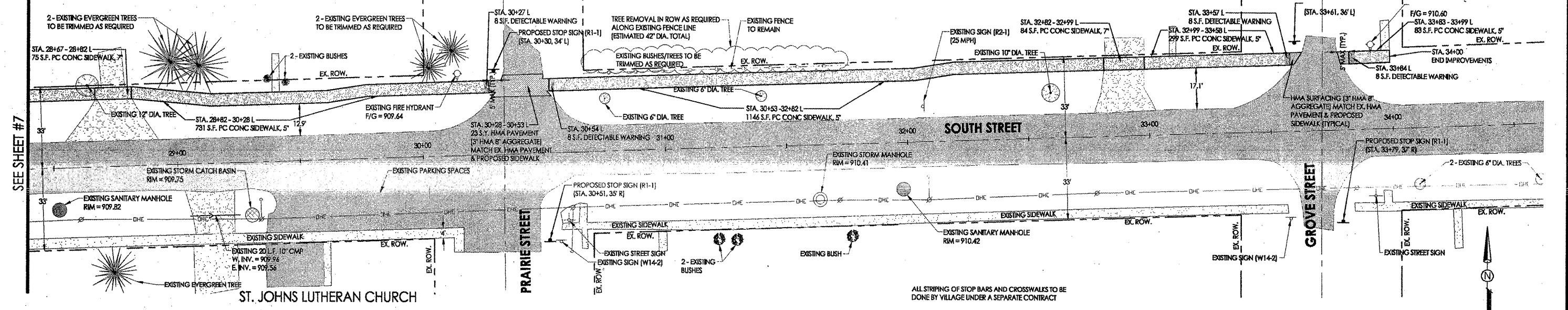
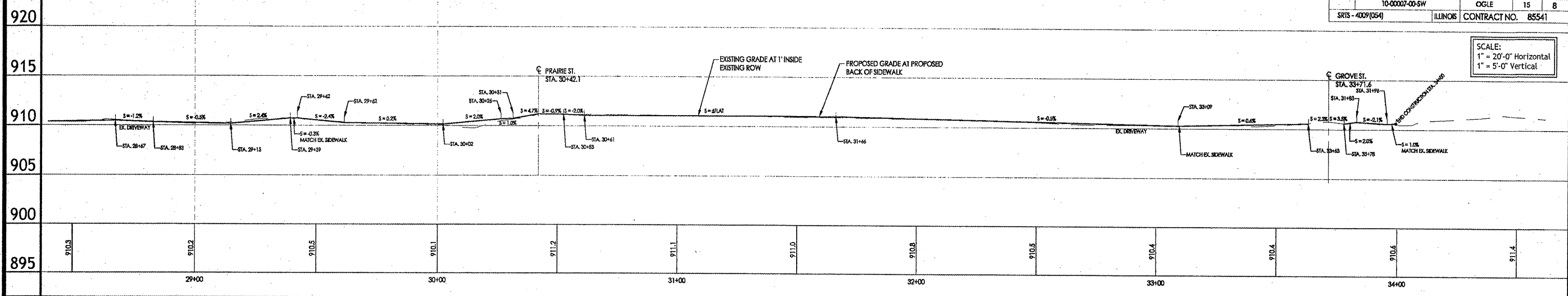

SEE SHEET #7

ALL STRIPING OF STOP BARS AND CROSSWALKS TO BE DONE BY VILLAGE UNDER A SEPARATE CONTRACT
VILLAGE TO NOTIFY OWNERS OF TREES TO BE REMOVED OR TRIMMED. ALL TREES DESIGNATED TO BE REMOVED ARE WITHIN THE VILLAGE ROW.
USE STAINLESS STEEL DETECTABLE WARNING (2' X 4' PANEL TO ALLOW FOR A 6\"/>

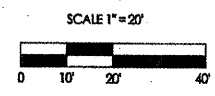

PROFILE FOR SIDEWALK ON RIGHT SIDE OF ROAD

SCALE:
1" = 20'-0" Horizontal
1" = 5'-0" Vertical

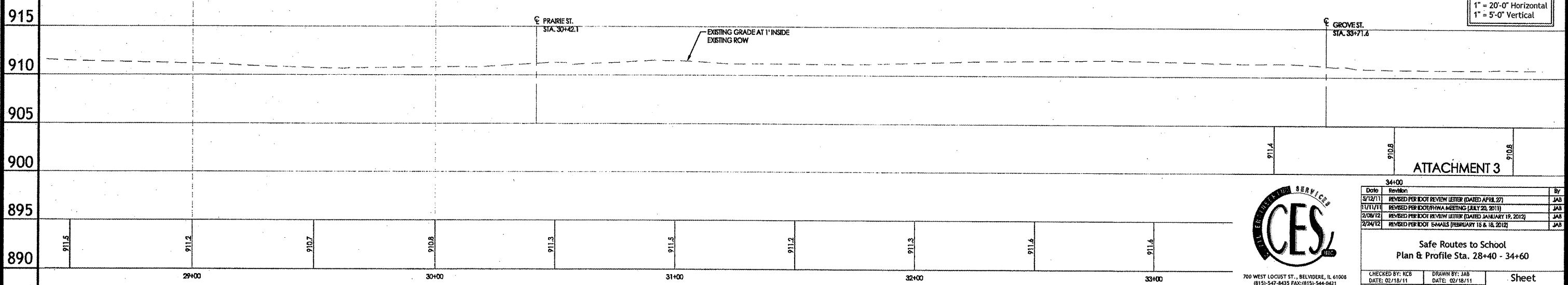

ATTACHMENT 3

Date	Revision	By
3/12/11	REVISED PER IDOT REVIEW LETTER (DATED APRIL 27)	JAB
11/11/11	REVISED PER IDOT/HHMA MEETING (JULY 20, 2011)	JAB
2/28/12	REVISED PER IDOT REVIEW LETTER (DATED JANUARY 19, 2012)	JAB
2/24/12	REVISED PER IDOT E-MAILS (FEBRUARY 15 & 18, 2012)	JAB



700 WEST LOCUST ST., BELLEVILLE, IL 61008
(815) 547-8435 FAX: (815) 544-0421
ILLINOIS DESIGN FIRM NO. 164-001260

Safe Routes to School
Plan & Profile Sta. 28+40 - 34+60

CHECKED BY: KCB DATE: 02/18/11
DRAWN BY: JAB DATE: 02/18/11

3000_BASE.dwg

Sheet
8 of 15

F.A. RTE.	SECTION	COUNTY	TOTAL SHEETS	SHEET NO.
SR15 - 4009(054)	10-00007-00-SW	OGLE	15	49
		ILLINOIS	CONTRACT NO. 85541	

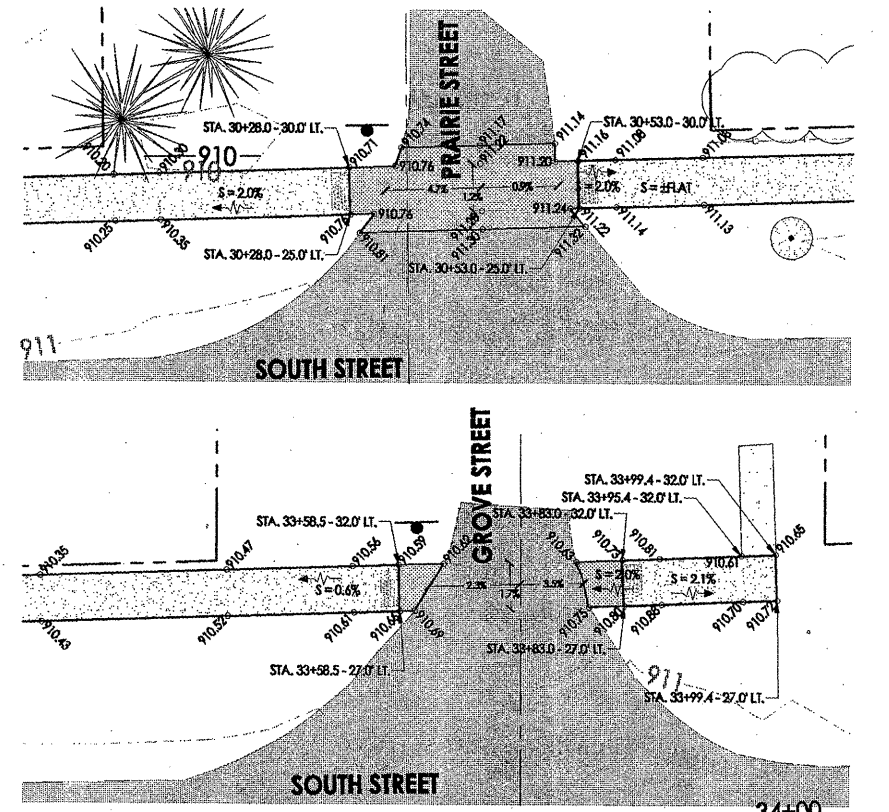
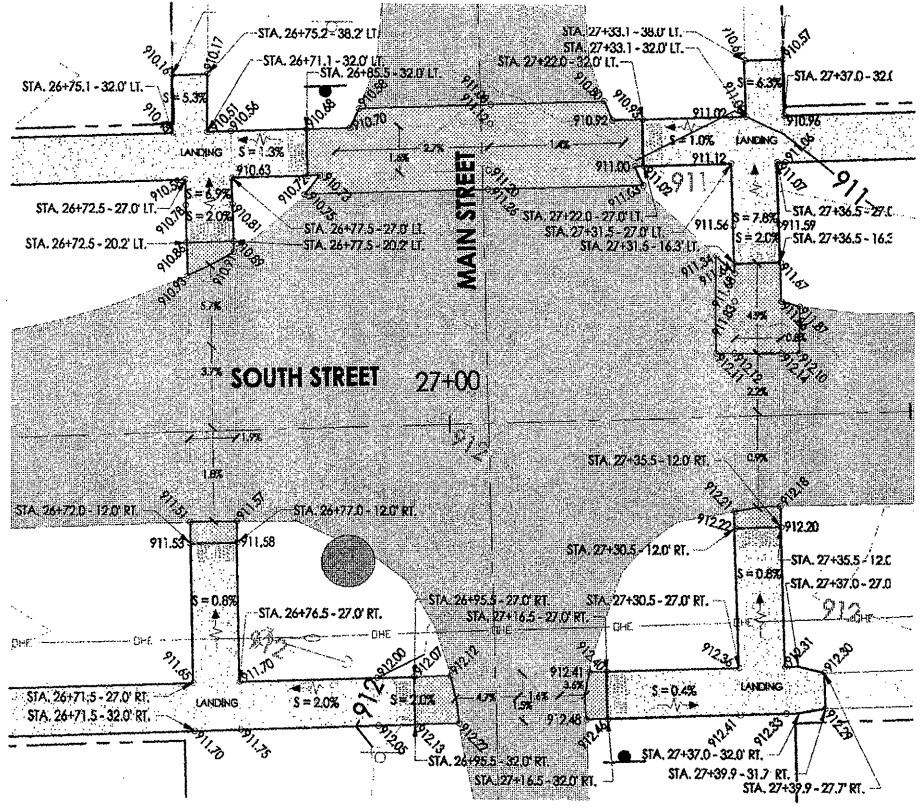
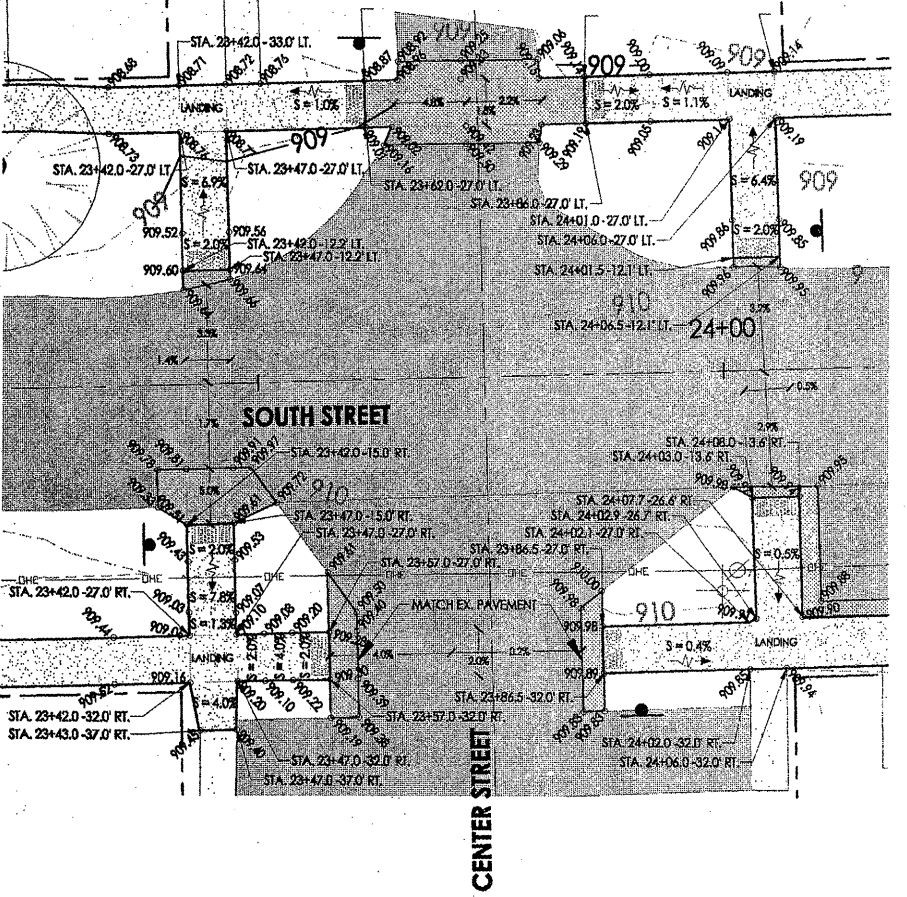
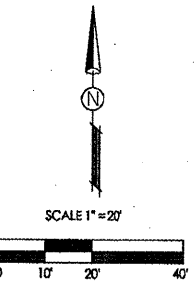
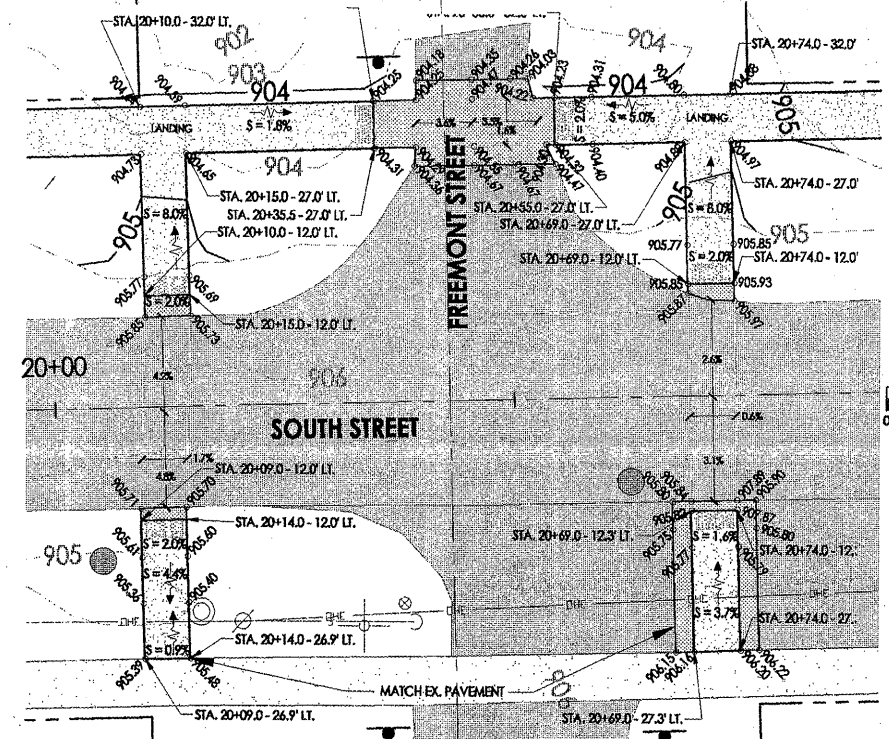
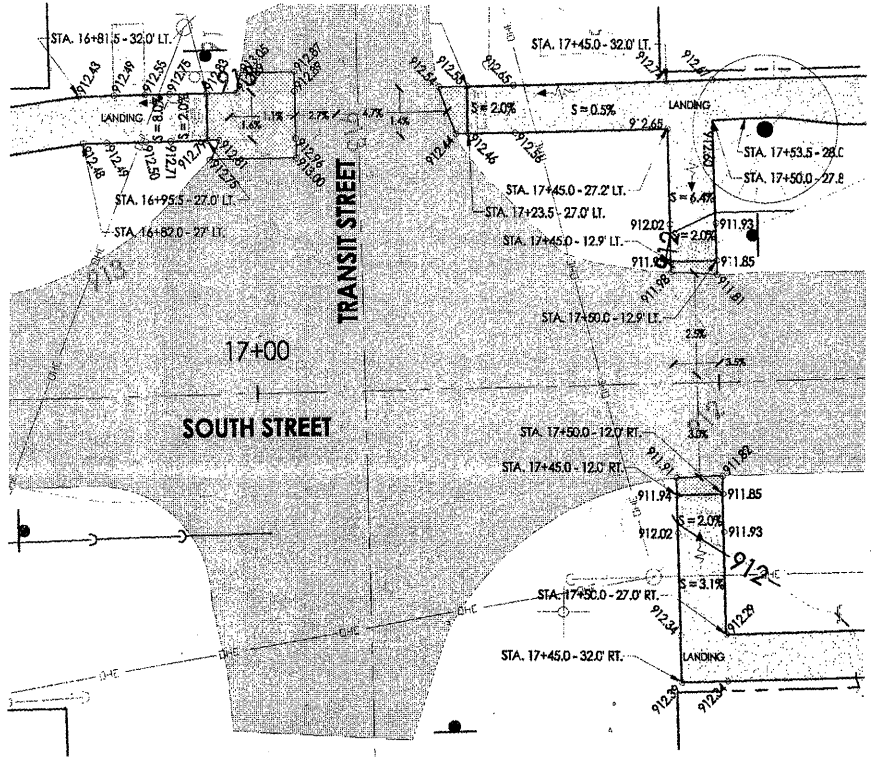
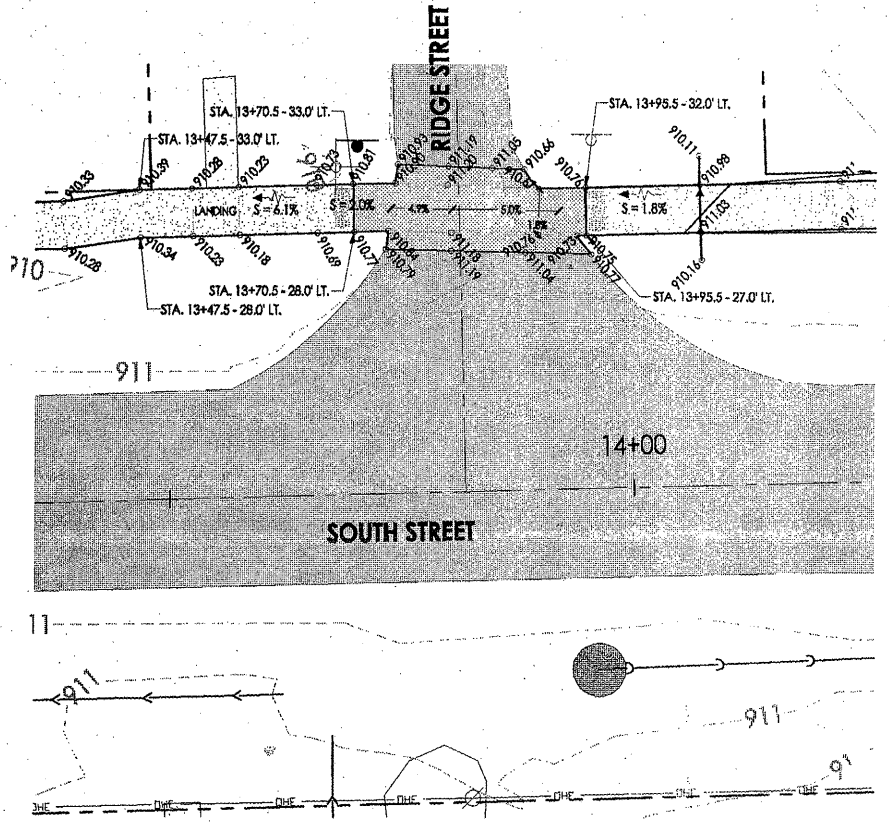

Date	Revision	By
5/12/11	REVISED PER DOT REVIEW LETTER (DATED APRIL 27)	JAB
11/11/11	REVISED PER DOT/PRIMA MEETING (JULY 20, 2011)	JAB
2/26/12	REVISED PER DOT REVIEW LETTER (DATED JANUARY 19, 2012)	JAB
2/24/12	REVISED PER DOT E-MAILS (FEBRUARY 15 & 18, 2012)	JAB

Safe Routes to School
Intersection Grading

CHECKED BY: KCB	DRAWN BY: JAB	Sheet 9 of 15
DATE: 02/18/11	DATE: 02/18/11	

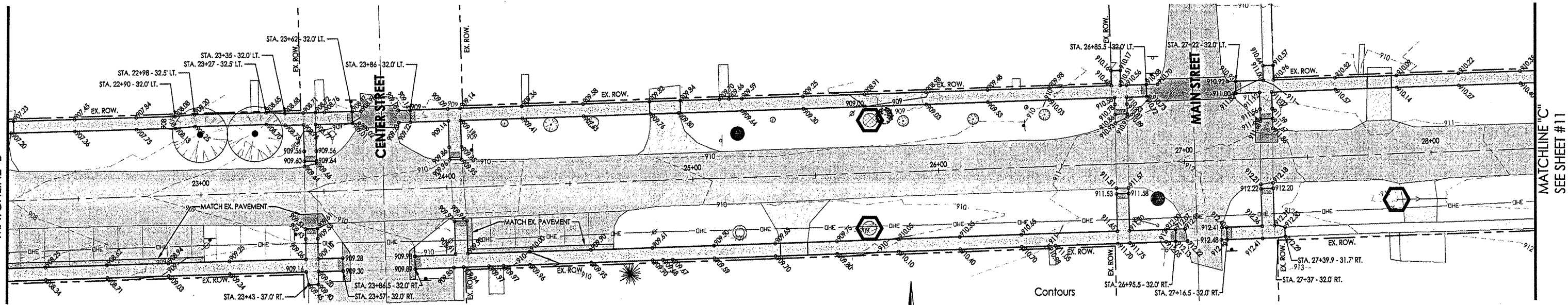
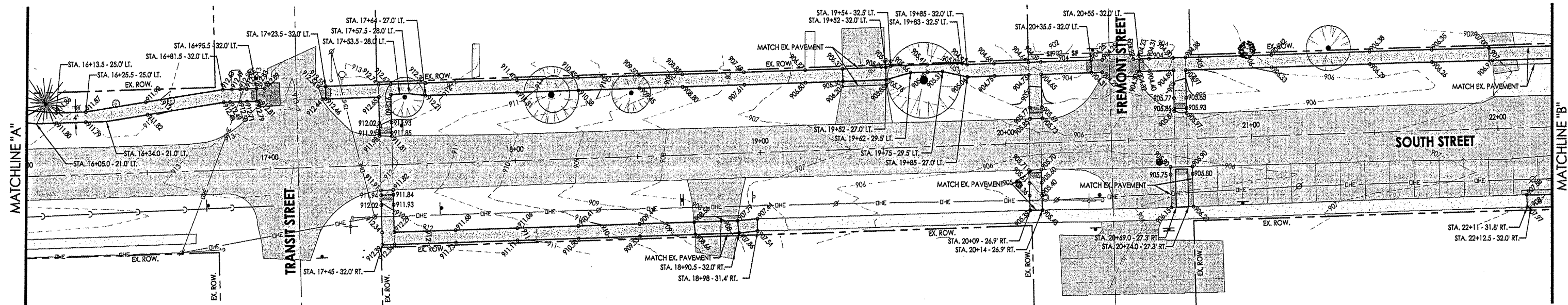
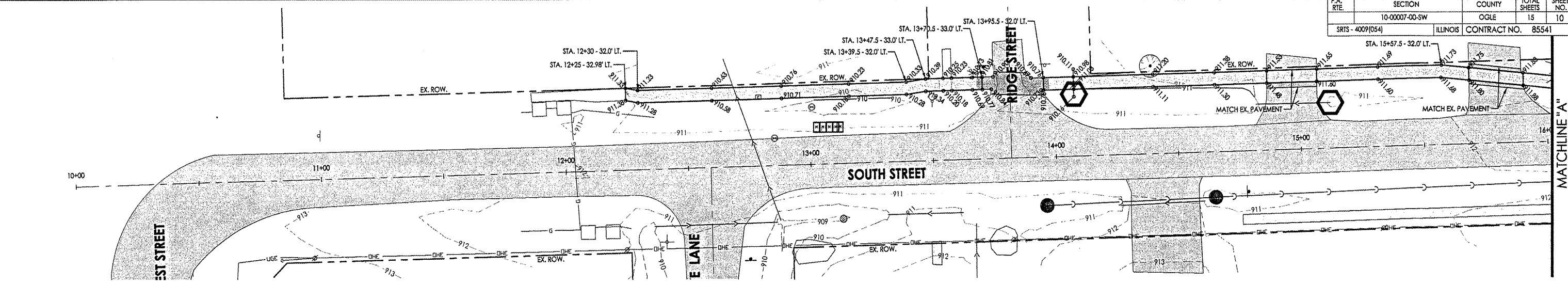

EROSION AND SEDIMENT CONTROL NOTES:

UNLESS OTHERWISE INDICATED, ALL VEGETATIVE AND STRUCTURAL EROSION AND SEDIMENT CONTROL PRACTICES WILL BE CONSTRUCTED ACCORDING TO MINIMUM STANDARDS AND SPECIFICATIONS IN THE IDOT STANDARD SPECIFICATIONS FOR ROAD & BRIDGE CONSTRUCTION, LATEST REVISION.

A COPY OF THE APPROVED EROSION AND SEDIMENT CONTROL PLAN SHALL BE MAINTAINED ON THE SITE AT ALL TIMES.

THE CONTRACTOR IS RESPONSIBLE FOR INSTALLATION OF ANY ADDITIONAL EROSION CONTROL MEASURES NECESSARY TO PREVENT EROSION AND SEDIMENTATION AS DETERMINED BY THE ENGINEER.

THE CONTRACTOR SHALL BE RESPONSIBLE FOR SWEEPING PUBLIC & DEVELOPMENT STREETS WHEN DEBRIS HAS BEEN TRACKED AND OR WASHED ON THEM. THE CONTRACTOR SHALL BE RESPONSIBLE TO SWEEP THE STREETS IF DIRECTED TO DO SO BY THE ENGINEER. THE CONTRACTOR IS ALSO RESPONSIBLE TO CONTROL DUST ON THE SITE IN ACCORDANCE WITH PRACTICES IN THE IDOT STANDARD SPECIFICATIONS FOR ROAD & BRIDGE CONSTRUCTION, LATEST REVISION.

EROSION FABRIC IS NECESSARY FOR SILT TRAPS INSTALLED AT ALL STORM STRUCTURES WITH OPEN LIDS. ALL STORMWATER INLETS SHALL BE PROTECTED PER THE DETAILS. AFTER EACH RAINFALL EACH INLET SHALL BE INSPECTED. ANY INLET PROTECTION THAT HAS FAILED OR IS DAMAGED SHALL BE REPAIRED AS SOON AS POSSIBLE. SEDIMENT SHALL BE REMOVED AS NECESSARY TO PROVIDE FOR THE CONTINUED EFFECTIVENESS OF THE INLET PROTECTION TECHNIQUE IN USE.

ALL EROSION AND SEDIMENT CONTROL DEVICES SHALL BE INSTALLED AND STABILIZED PRIOR TO SITE CLEARING AND GRADING. ALL EROSION AND SEDIMENT CONTROL PRACTICES WILL BE MAINTAINED THROUGHOUT THE DURATION OF THE PROJECT. ALL EROSION AND SEDIMENT CONTROL STRUCTURES SHALL BE INSPECTED WEEKLY AND AFTER EACH 1/2" RAINFALL EVENT AND 6" SNOWFALL EVENT AND AN INSPECTION RECORD SHALL BE MAINTAINED BY THE CONTRACTOR AT THE JOB SITE FOR THE DURATION OF THE PROJECT. THE CONTRACTOR SHALL BE RESPONSIBLE TO PERFORM THESE INSPECTIONS AND TO MAINTAIN ALL EROSION AND SEDIMENT CONTROL DEVICES IN SUCH A MANNER THAT THEY CONTINUE TO FUNCTION FOR THE DURATION OF THEIR INTENDED USE. THE CONTRACTOR SHALL BE RESPONSIBLE TO PERFORM ALL TEMPORARY SEEDING.

ALL DISTURBED AREAS SHALL BE STABILIZED WITH TEMPORARY SEEDING WITHIN 14 DAYS FOLLOWING THE END OF ACTIVE CONSTRUCTION.

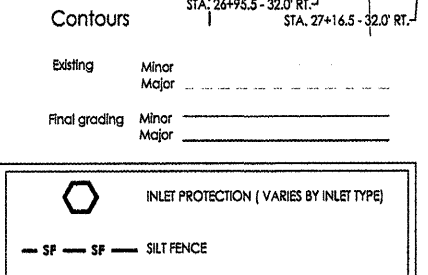
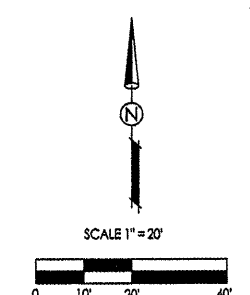

700 WEST LOCUST ST., BELVIDERE, IL 61008
(815)-347-8435 FAX: (815)-344-0421
ILLINOIS DESIGN FIRM NO. 194-001260

Date	Revision	By
5/12/11	REVISED PER IDOT REVIEW LETTER (DATED APRIL 27)	JAB
11/11/11	REVISED PER IDOT/FHWA MEETING (JULY 20, 2011)	JAB
2/08/12	REVISED PER IDOT REVIEW LETTER (DATED JANUARY 19, 2012)	JAB
2/24/12	REVISED PER IDOT E-MAILS (FEBRUARY 15 & 18, 2012)	JAB

**Safe Routes to School
Grading & Storm Water Pollution Prevention Plan**

CHECKED BY: KCB DATE: 02/18/11	DRAWN BY: JAB DATE: 02/18/11	Sheet 10 of 15
-----------------------------------	---------------------------------	-------------------

3000_BASE.dwg

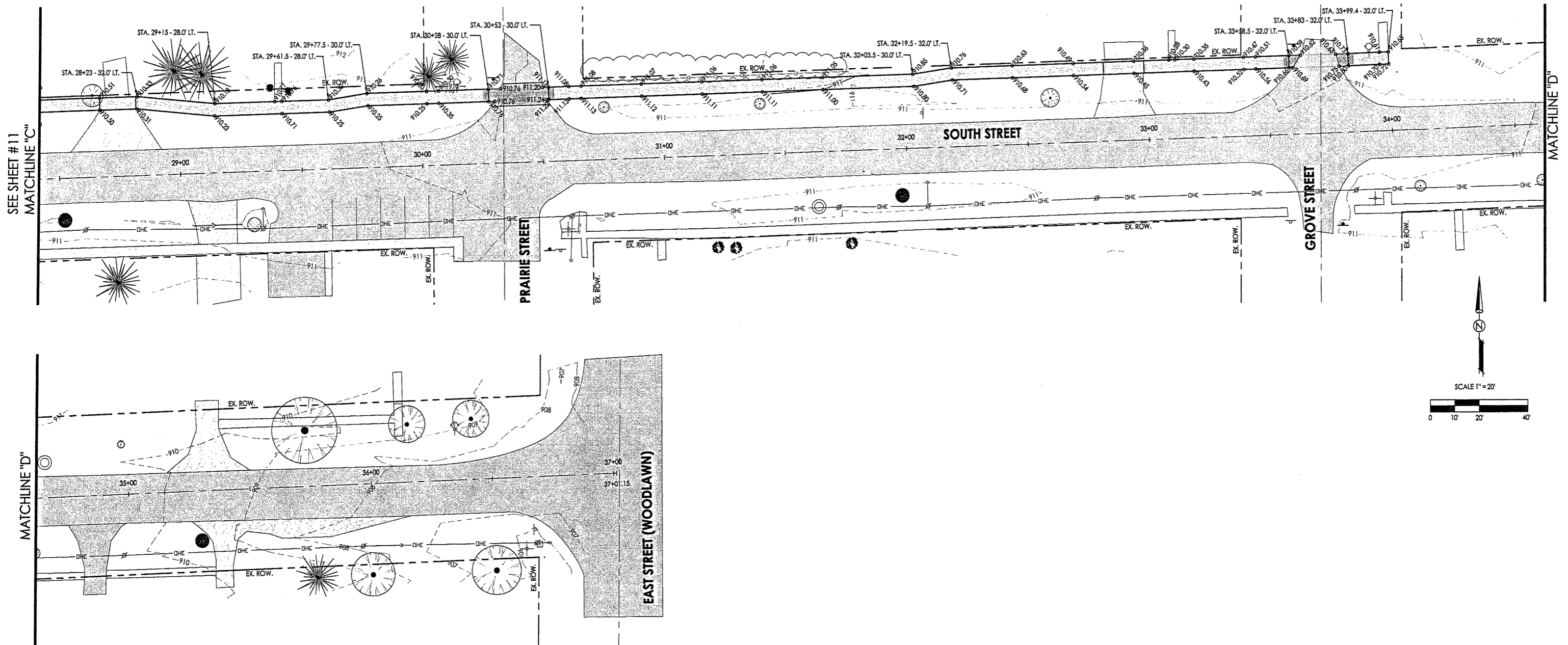

EROSION AND SEDIMENT CONTROL NOTES:

UNLESS OTHERWISE INDICATED, ALL VEGETATIVE AND STRUCTURAL EROSION AND SEDIMENT CONTROL PRACTICES WILL BE CONSTRUCTED ACCORDING TO MINIMUM STANDARDS AND SPECIFICATIONS IN THE IDOT STANDARD SPECIFICATIONS FOR ROAD & BRIDGE CONSTRUCTION, LATEST REVISION.

A COPY OF THE APPROVED EROSION AND SEDIMENT CONTROL PLAN SHALL BE MAINTAINED ON THE SITE AT ALL TIMES.

THE CONTRACTOR IS RESPONSIBLE FOR INSTALLATION OF ANY ADDITIONAL EROSION CONTROL MEASURES NECESSARY TO PREVENT EROSION AND SEDIMENTATION AS DETERMINED BY THE ENGINEER.

THE CONTRACTOR SHALL BE RESPONSIBLE FOR SWEEPING PUBLIC & DEVELOPMENT STREETS WHEN DEBRIS HAS BEEN TRACKED AND OR WASHED ON THEM. THE CONTRACTOR SHALL BE RESPONSIBLE TO SWEEP THE STREETS IF DIRECTED TO DO SO BY THE ENGINEER. THE CONTRACTOR IS ALSO RESPONSIBLE TO CONTROL DUST ON THE SITE IN ACCORDANCE WITH PRACTICES IN THE IDOT STANDARD SPECIFICATIONS FOR ROAD & BRIDGE CONSTRUCTION, LATEST REVISION.

EROSION FABRIC IS NECESSARY FOR SILT TRAPS INSTALLED AT ALL STORM STRUCTURES WITH OPEN LIDS. ALL STORMWATER INLETS SHALL BE PROTECTED PER THE DETAILS. AFTER EACH RAINFALL EACH INLET SHALL BE INSPECTED. ANY INLET PROTECTION THAT HAS FAILED OR IS DAMAGED SHALL BE REPAIRED AS SOON AS POSSIBLE. SEDIMENT SHALL BE REMOVED AS NECESSARY TO PROVIDE FOR THE CONTINUED EFFECTIVENESS OF THE INLET PROTECTION TECHNIQUE IN USE.

ALL EROSION AND SEDIMENT CONTROL DEVICES SHALL BE INSTALLED AND STABILIZED PRIOR TO SITE CLEARING AND GRADING. ALL EROSION AND SEDIMENT CONTROL PRACTICES WILL BE MAINTAINED THROUGH THE DURATION OF THE PROJECT. ALL EROSION AND SEDIMENT CONTROL STRUCTURES SHALL BE INSPECTED WEEKLY AND AFTER EACH 1/2" RAINFALL EVENT AND 6" SNOWFALL EVENT AND AN INSPECTION RECORD SHALL BE MAINTAINED BY THE CONTRACTOR AT THE JOB SITE FOR THE DURATION OF THE PROJECT. THE CONTRACTOR SHALL BE RESPONSIBLE TO PERFORM THESE INSPECTIONS AND TO MAINTAIN ALL EROSION AND SEDIMENT CONTROL DEVICES IN SUCH A MANNER THAT THEY CONTINUE TO FUNCTION FOR THE DURATION OF THERE INTENDED USE. THE CONTRACTOR SHALL BE RESPONSIBLE TO PERFORM ALL TEMPORARY SEEDING.

ALL DISTURBED AREAS SHALL BE STABILIZED WITH TEMPORARY SEEDING WITHIN 14 DAYS FOLLOWING THE END OF ACTIVE DISTURBANCE.

Contours

- Existing Minor _____
- Major _____
- Final grading Minor _____
- Major _____

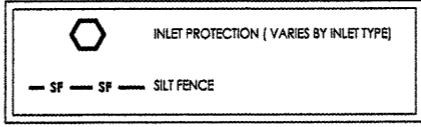

Date	Revision	By
5/12/11	REVISED PER IDOT REVIEW LETTER (DATED APRIL 27)	JAS
1/11/11	REVISED PER IDOT/FHWA MEETING (JULY 20, 2011)	JAS
2/08/12	REVISED PER IDOT REVIEW LETTER (DATED JANUARY 19, 2012)	JAS
2/24/12	REVISED PER IDOT E-MAILS (FEBRUARY 15 & 18, 2012)	JAS

Safe Routes to School
Grading & Storm Water Pollution Prevention Plan

CHECKED BY: KCB DRAWN BY: JAB
DATE: 02/18/11 DATE: 02/18/11

SCALE:
1" = 20'-0" Horizontal
1" = 5'-0" Vertical

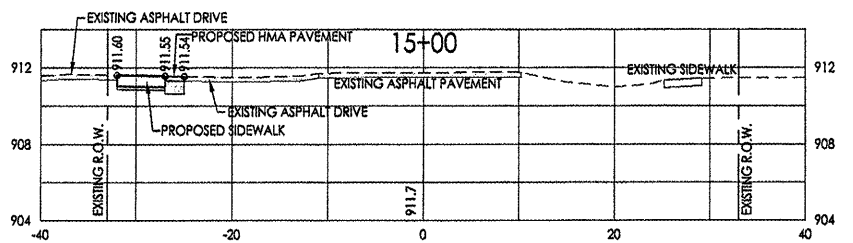
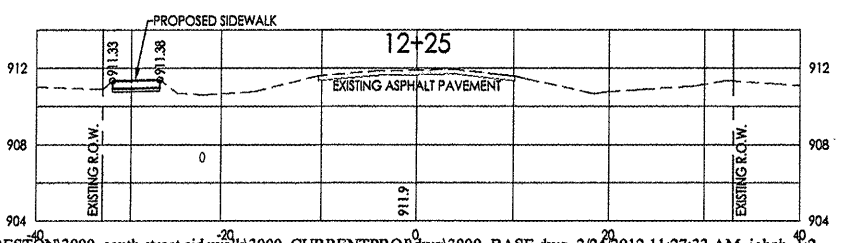
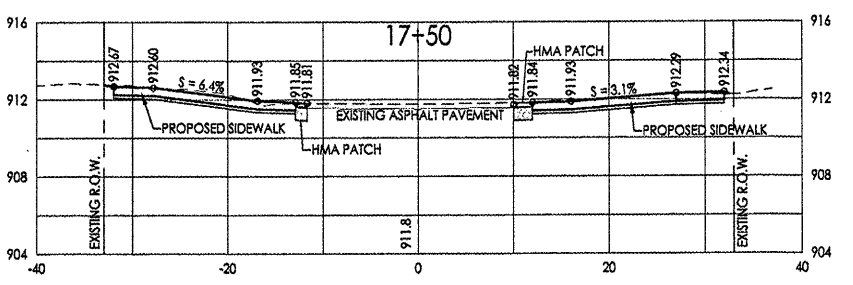
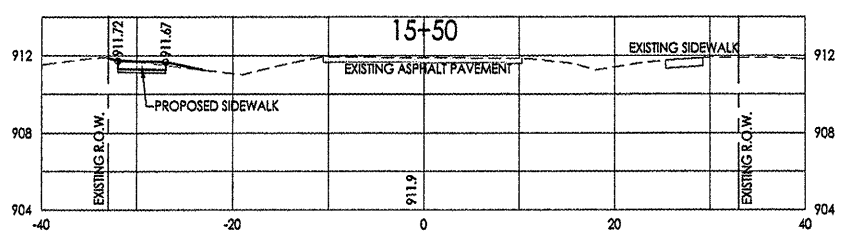
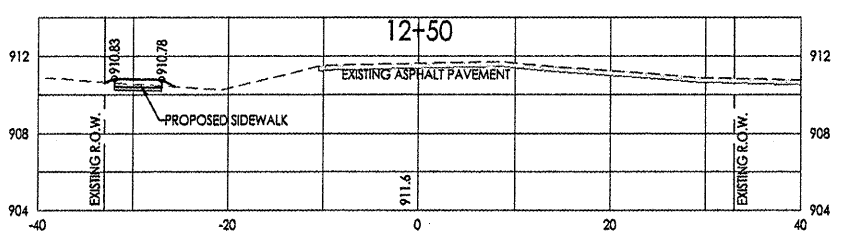
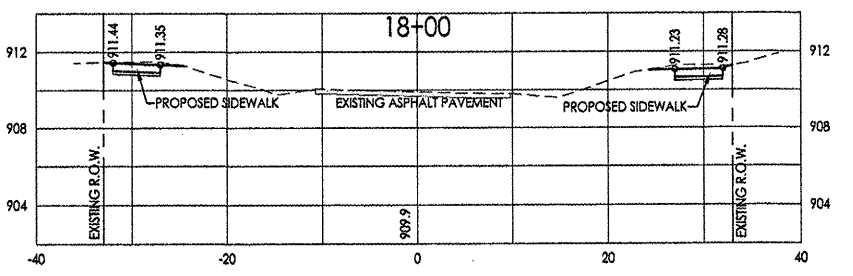
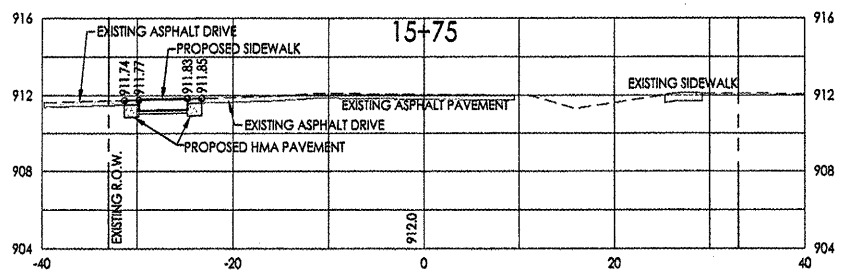
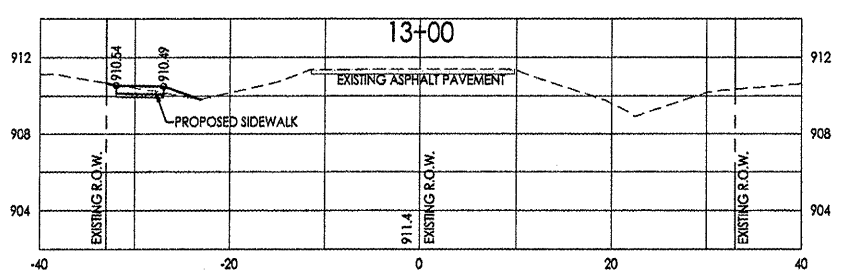
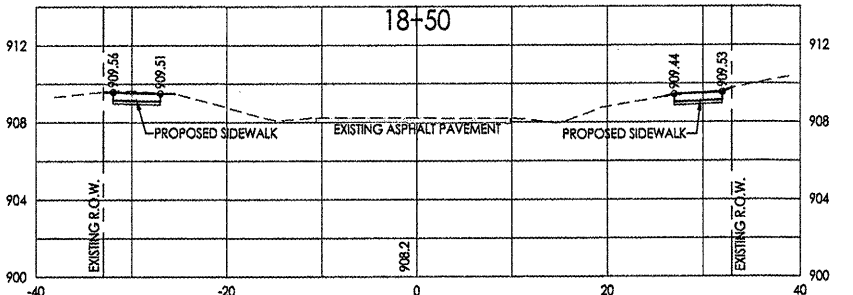
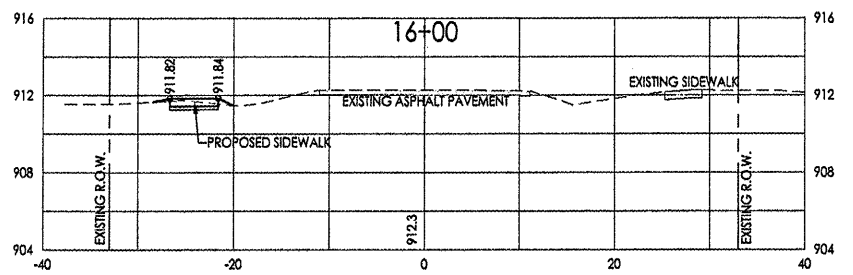
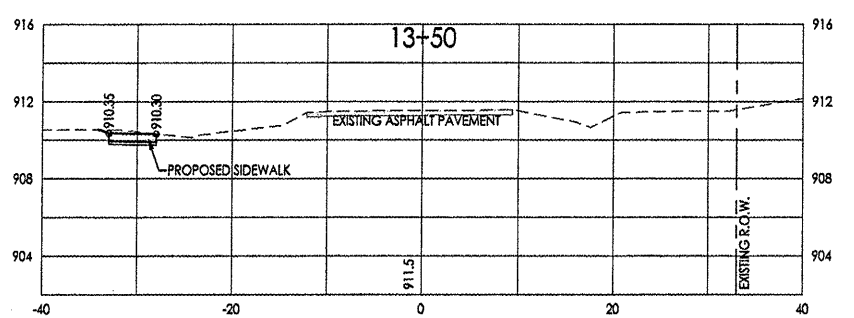
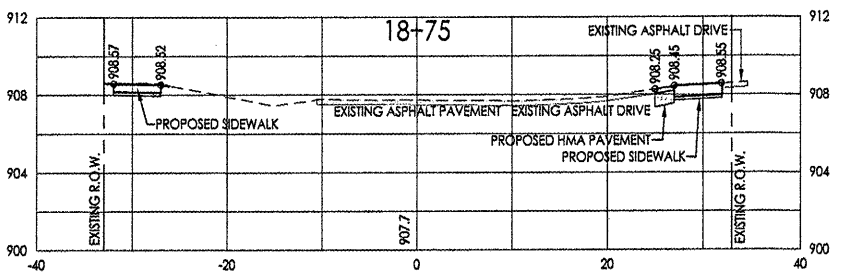
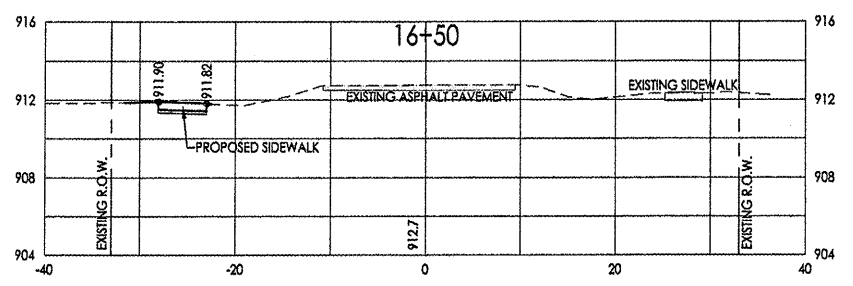
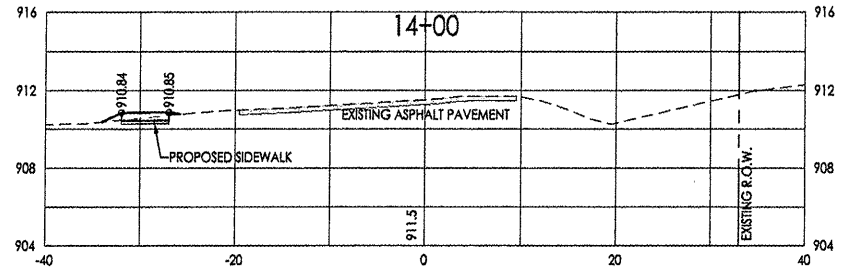
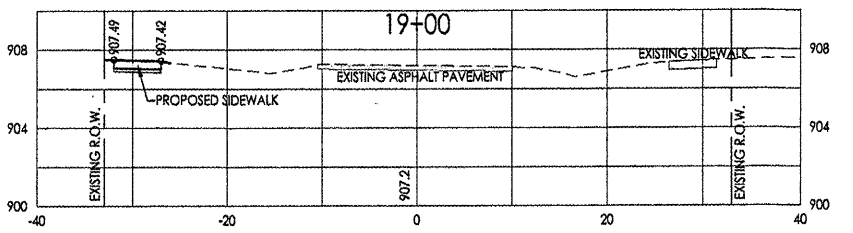
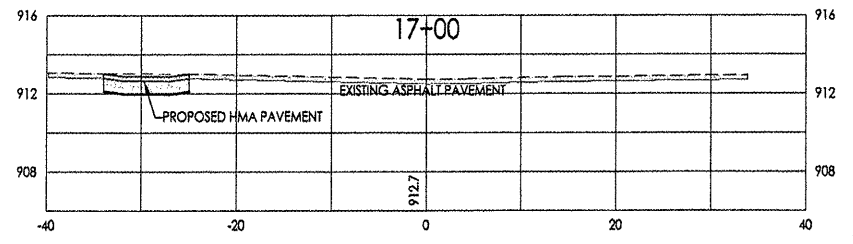
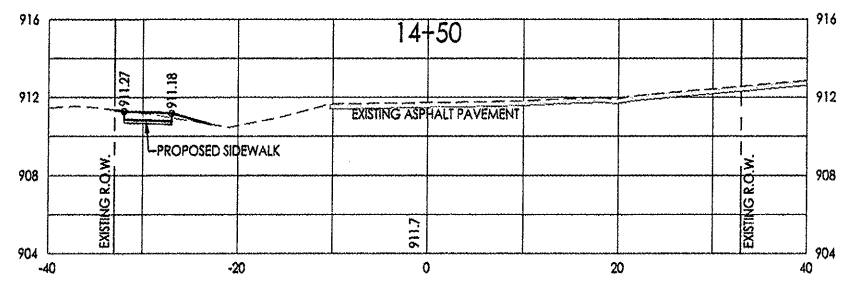

700 WEST LOCUST ST., BELVIDERE, IL 61008
(815)-547-8435 FAX: (815)-544-0421
ILLINOIS DESIGN FIRM NO. 184-007260

Date	Revision	By
5/12/11	REVISED PER DOT REVIEW LETTER (DATED APRIL 27)	JAB
11/11/11	REVISED PER DOT/HMA MEETING (JULY 20, 2011)	JAB
2/28/12	REVISED PER DOT REVIEW LETTER (DATED JANUARY 19, 2012)	JAB
2/24/12	REVISED PER DOT E-MAILS (FEBRUARY 15 & 18, 2012)	JAB

**Safe Routes to School
Cross-Sections**

CHECKED BY: HCB DRAWN BY: JAB
DATE: 02/18/11 DATE: 02/18/11

3000_BASE.dwg Sheet
12 of 15

SCALE:
1" = 20'-0" Horizontal
1" = 5'-0" Vertical

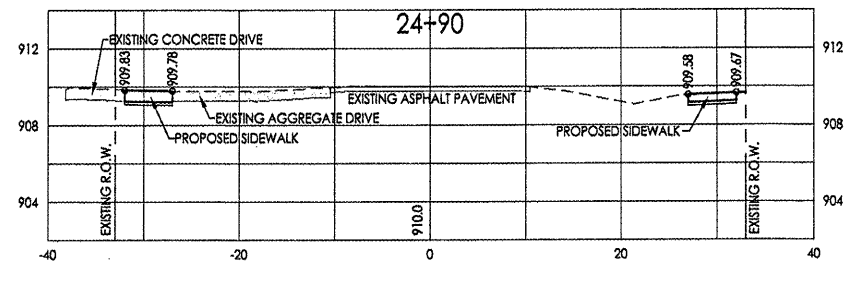
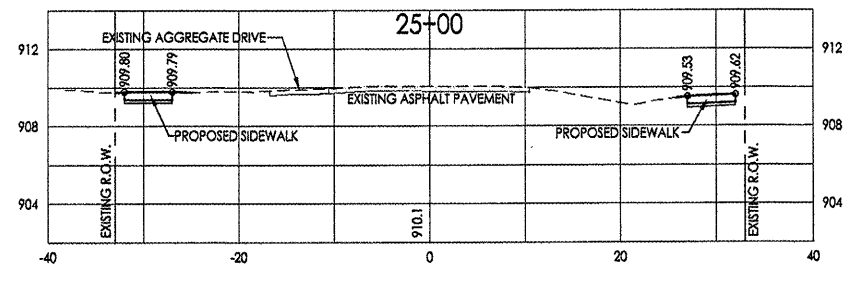
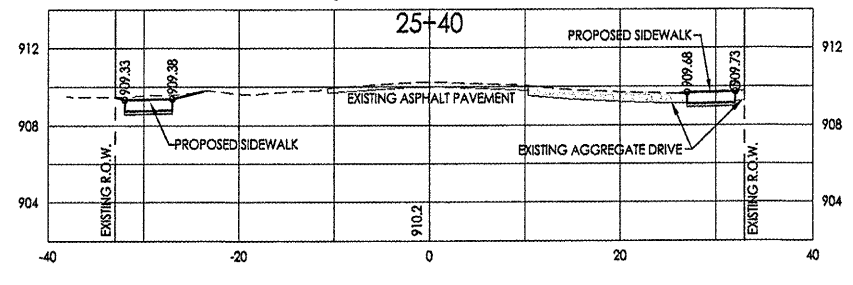
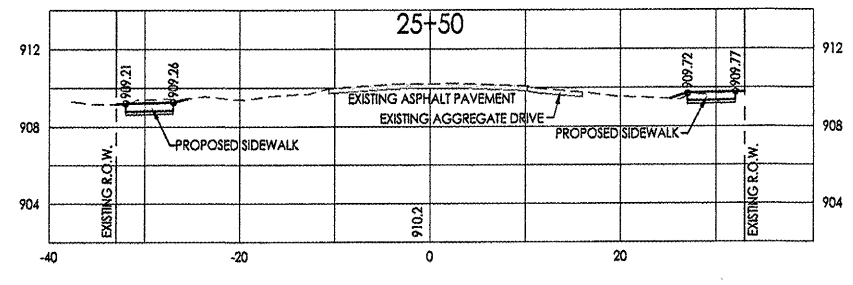
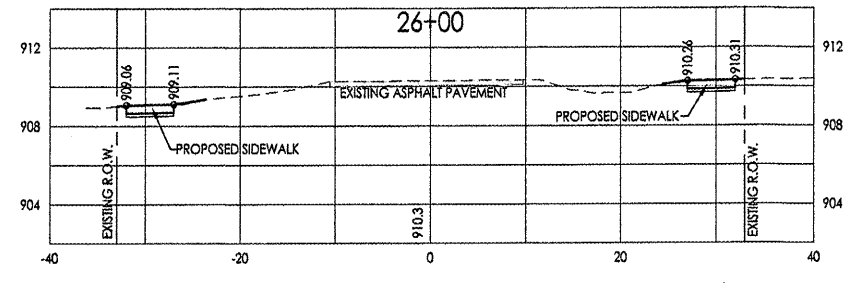
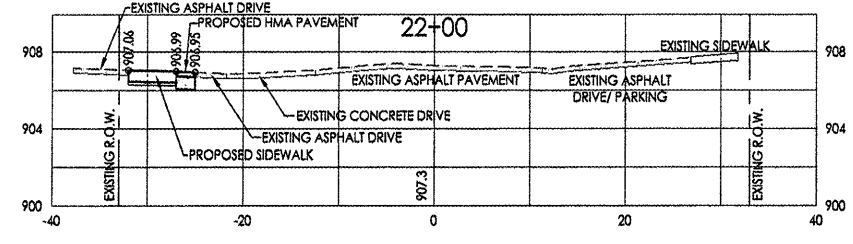
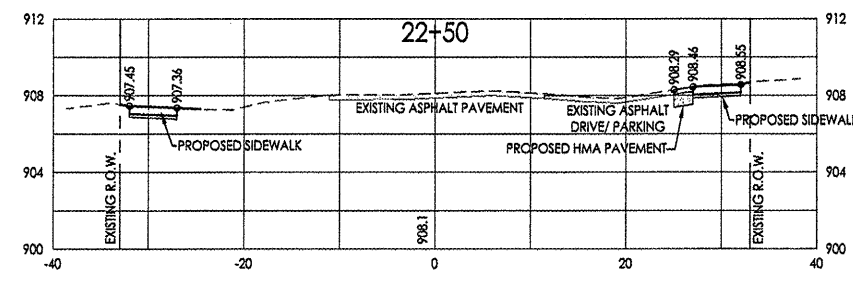
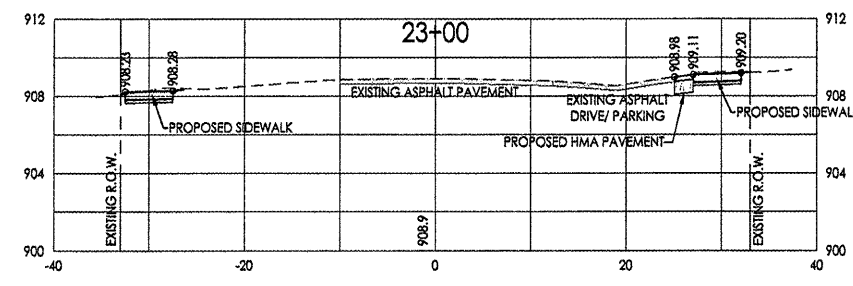
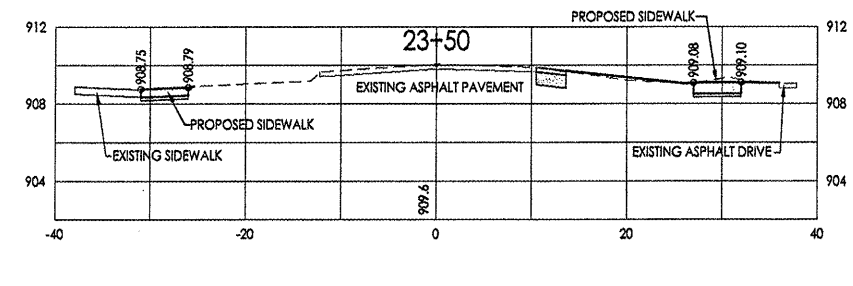
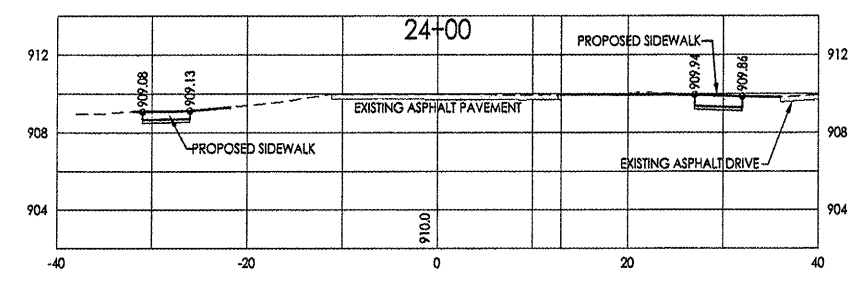
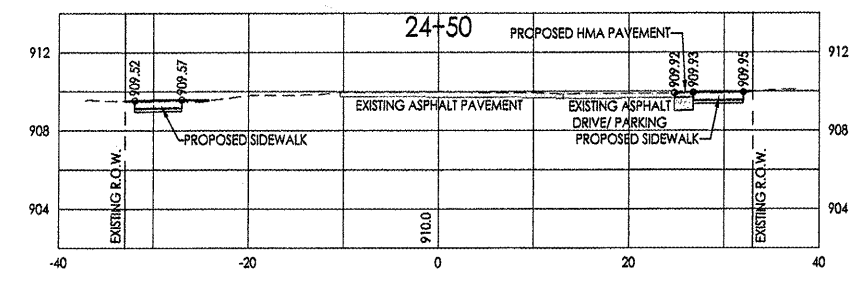
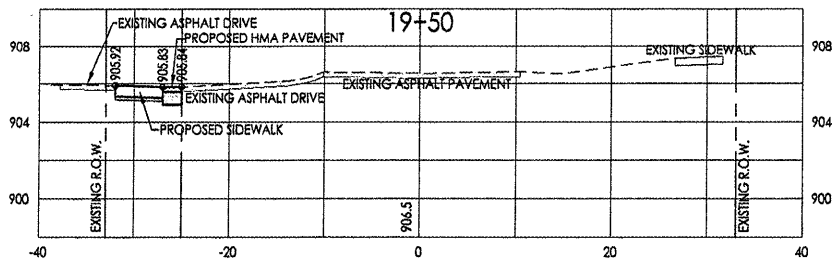
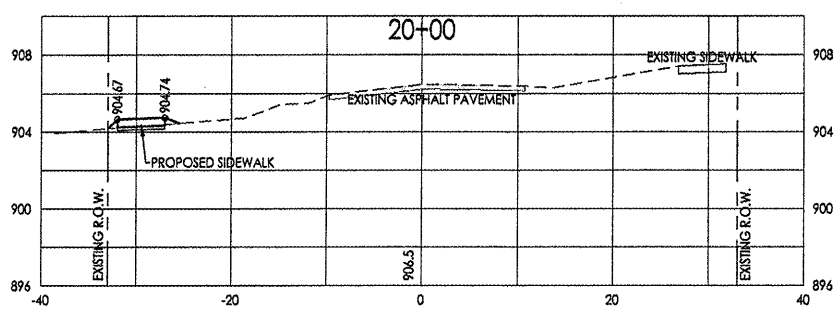
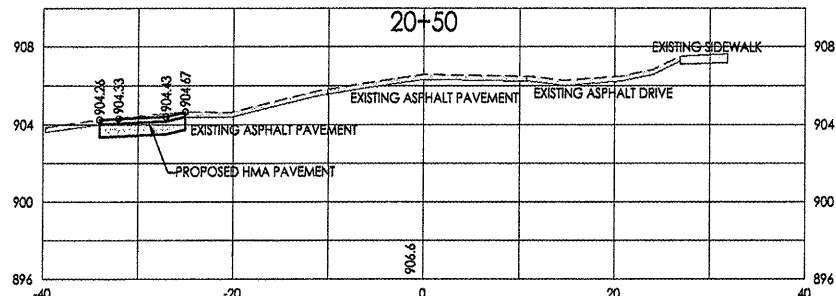
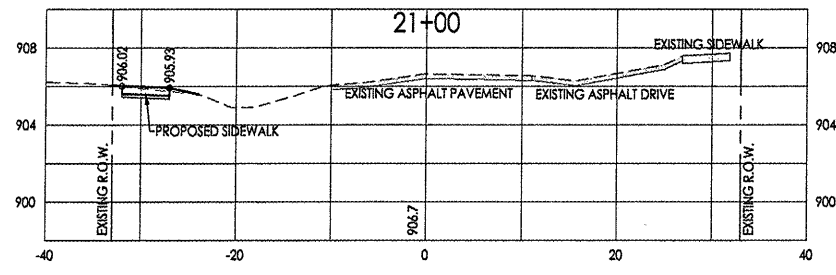
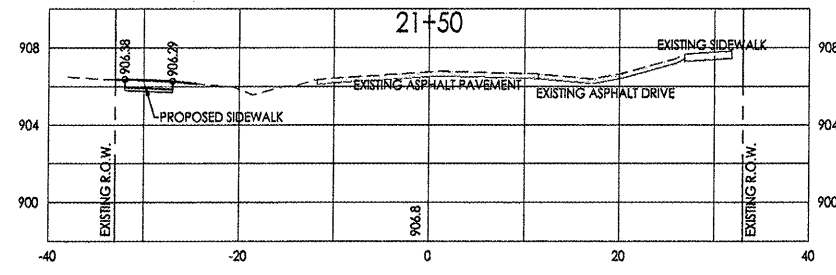

700 WEST LOCUST ST., BELVIDERE, IL 61008
(815)-547-8433 FAX: (815)-544-0421
ILLINOIS DESIGN FIRM NO. 184-001260

Date	Revision	By
5/12/11	REVISED PER IDOT REVIEW LETTER (DATED APRIL 27)	JAB
11/17/11	REVISED PER IDOT/FHWA MEETING (JULY 20, 2011)	JAB
2/08/12	REVISED PER IDOT REVIEW LETTER (DATED JANUARY 19, 2012)	JAB
2/24/12	REVISED PER IDOT E-MAILS (FEBRUARY 15 & 18, 2012)	JAB

**Safe Routes to School
Cross-Sections**

CHECKED BY: KCB DRAWN BY: JAB
DATE: 02/18/11 DATE: 02/18/11

3000_BASE.dwg Sheet 13 of 15

SCALE:
1" = 20'-0" Horizontal
1" = 5'-0" Vertical

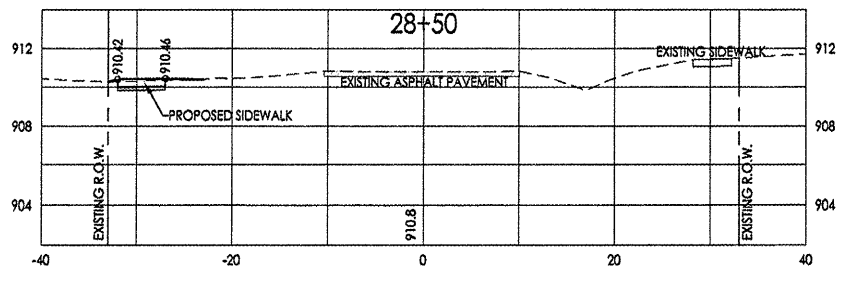
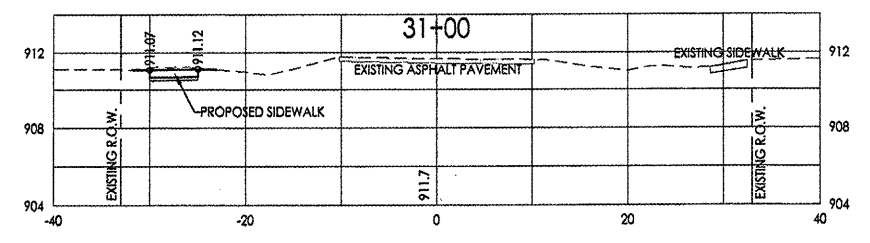
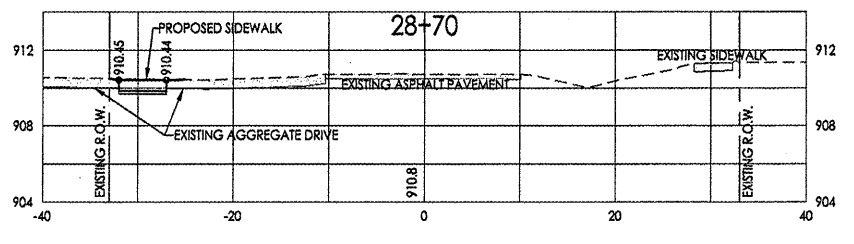
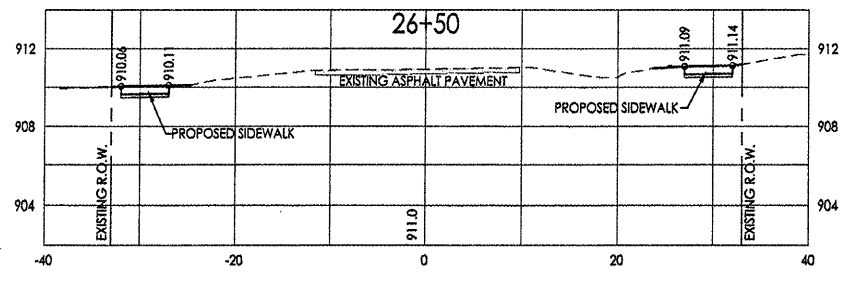
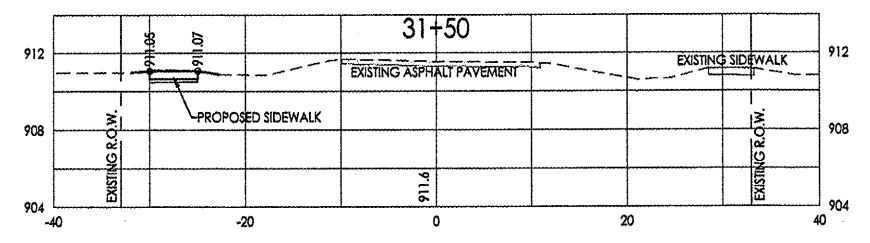
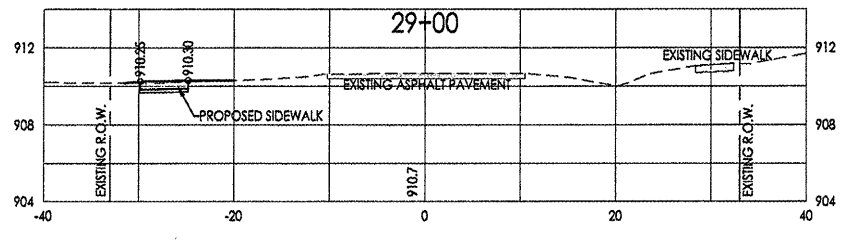
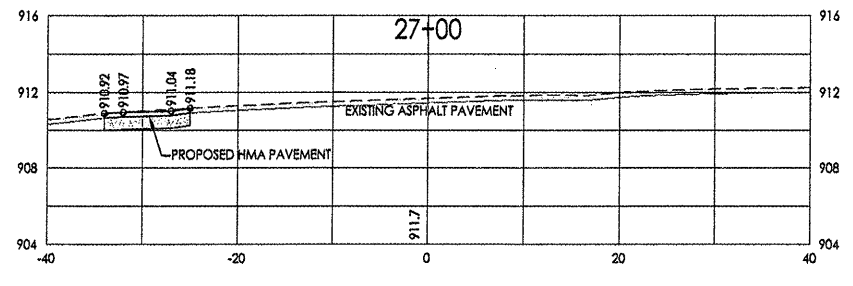
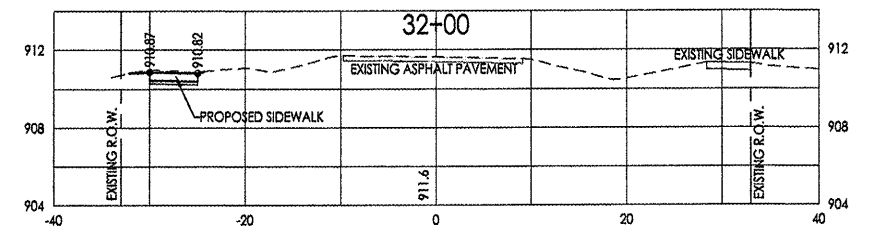
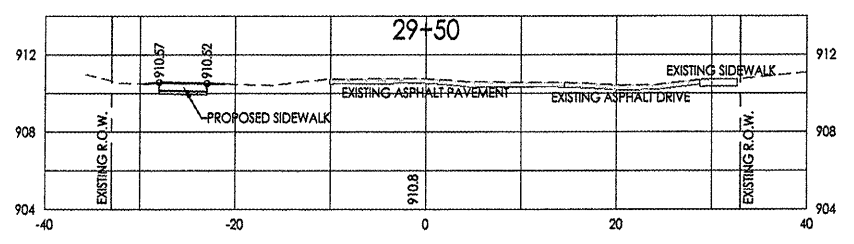
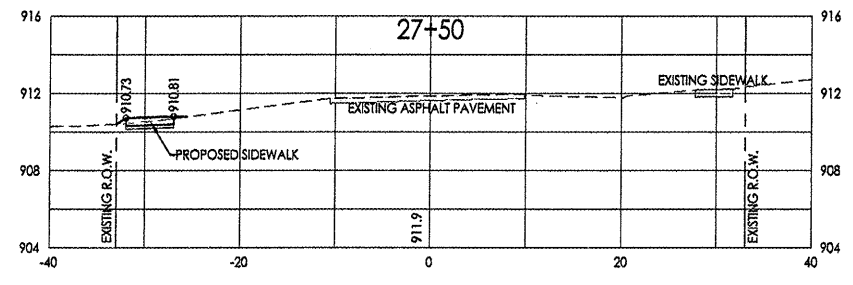
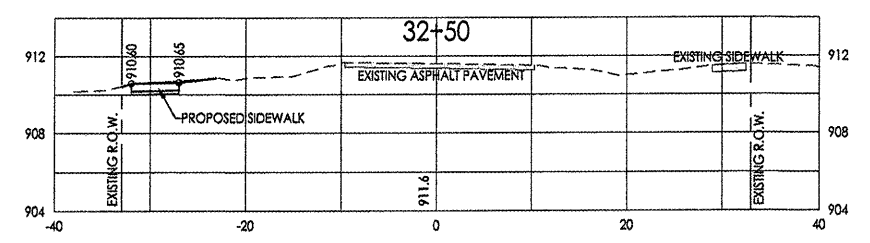
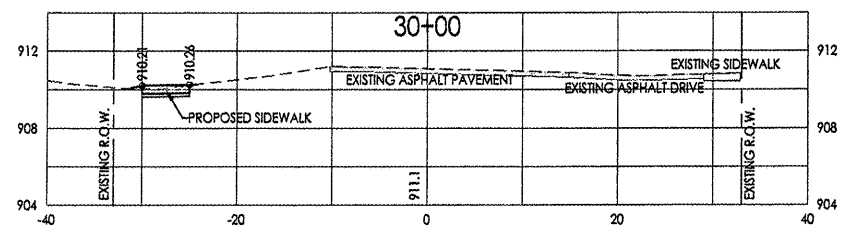
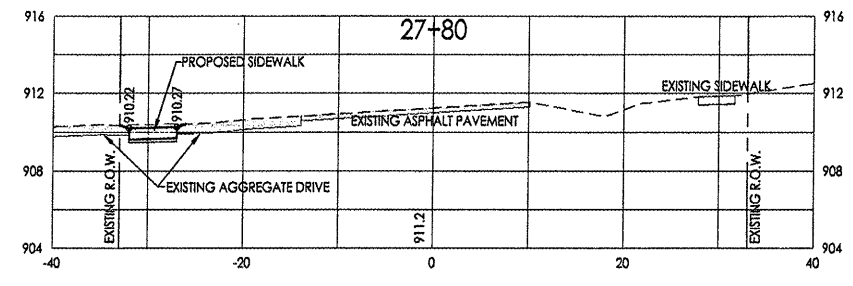
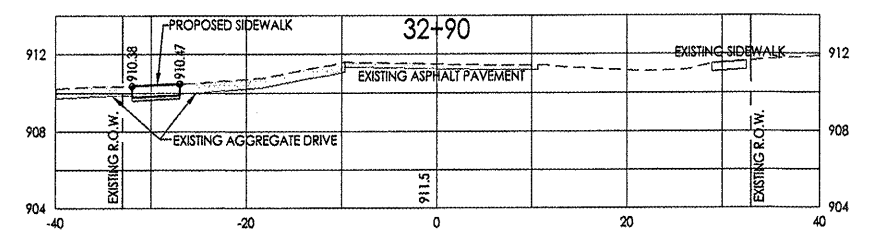
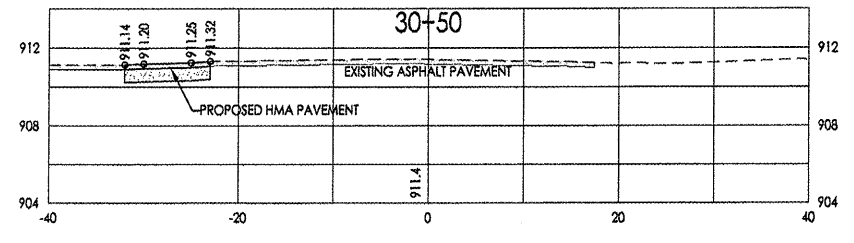
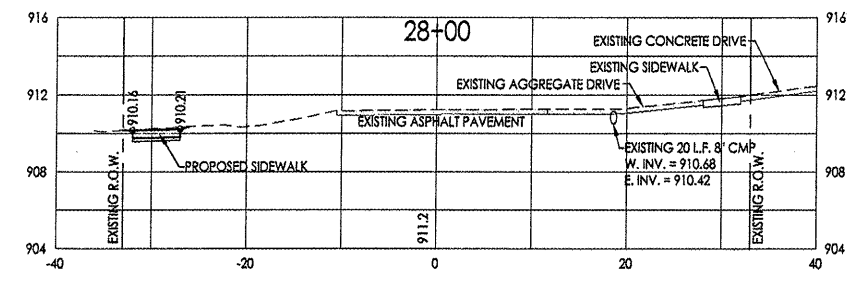

700 WEST LOCUST ST., BELVIDERE, IL 61008
(815)-547-8435 FAX: (815)-544-0421
ILLINOIS DESIGN FIRM NO. 164-001260

Date	Revision	By
5/12/11	REVISED PER DOT REVIEW LETTER (DATED APRIL 27)	JAS
11/17/11	REVISED PER DOT/RHWA MEETING (JULY 20, 2011)	JAS
2/08/12	REVISED PER DOT REVIEW LETTER (DATED JANUARY 19, 2012)	JAS
2/24/12	REVISED PER DOT E-MAILS (FEBRUARY 15 & 18, 2012)	JAS

**Safe Routes to School
Cross-Sections**

CHECKED BY: WCB DATE: 02/18/11	DRAWN BY: JAB DATE: 02/18/11	Sheet 14 of 15
-----------------------------------	---------------------------------	-------------------

3000_BASE.dwg

SCALE:
 1" = 20'-0" Horizontal
 1" = 5'-0" Vertical

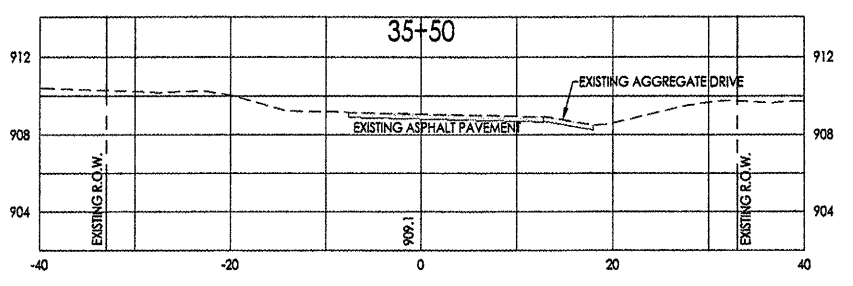
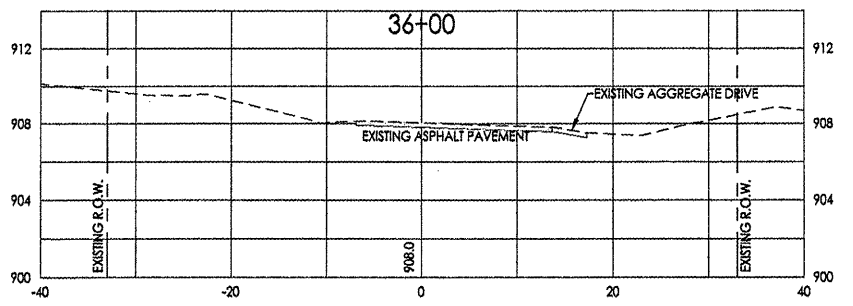
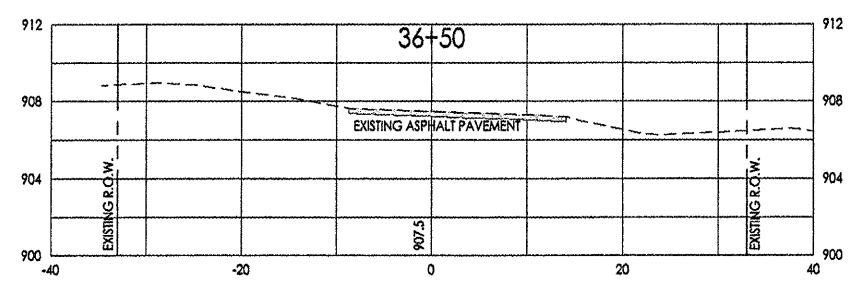
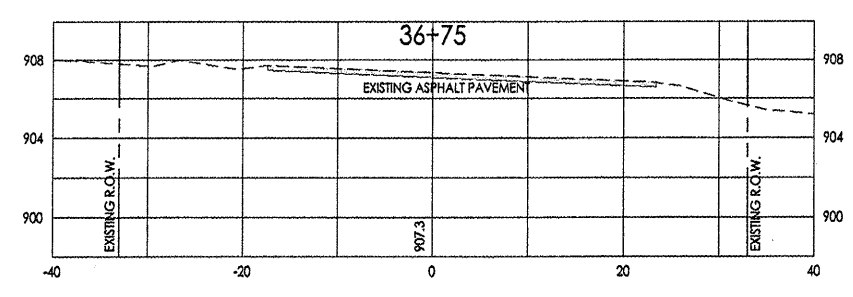
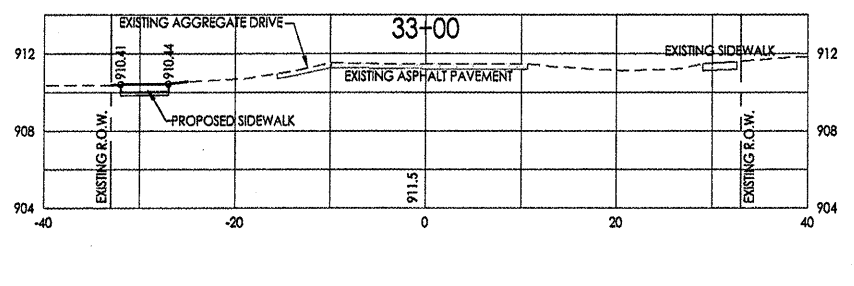
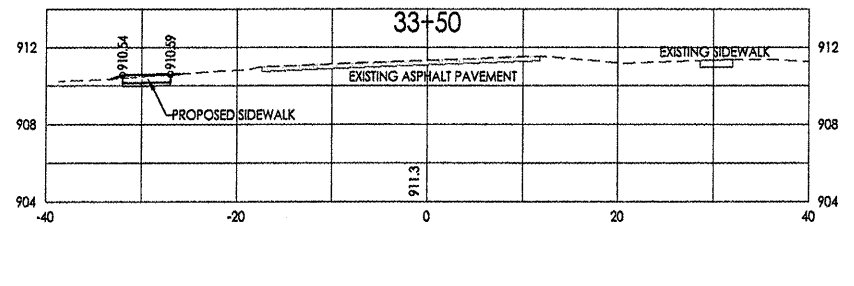
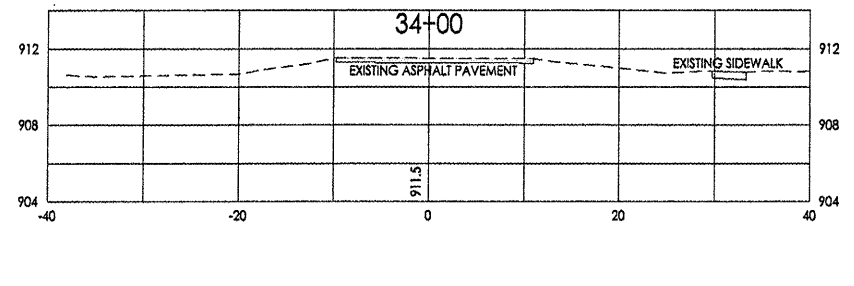
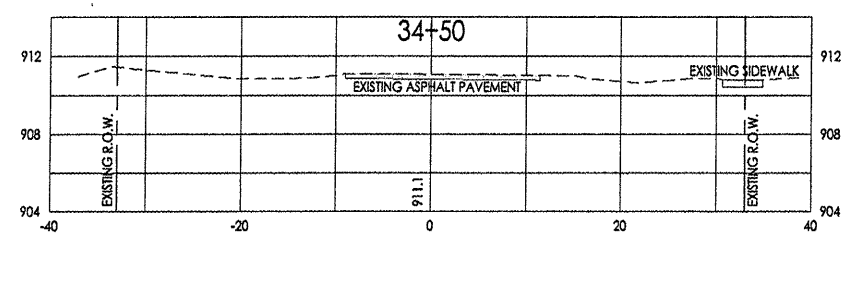
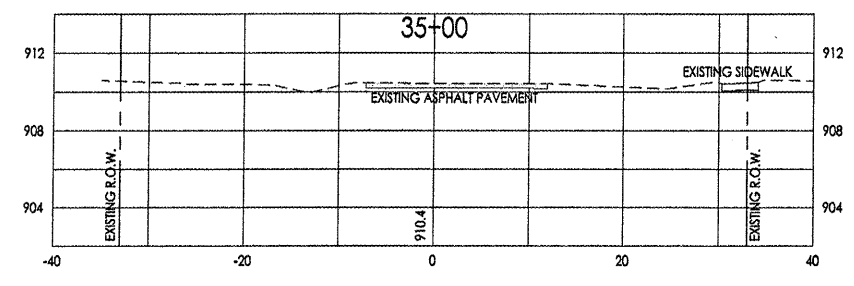
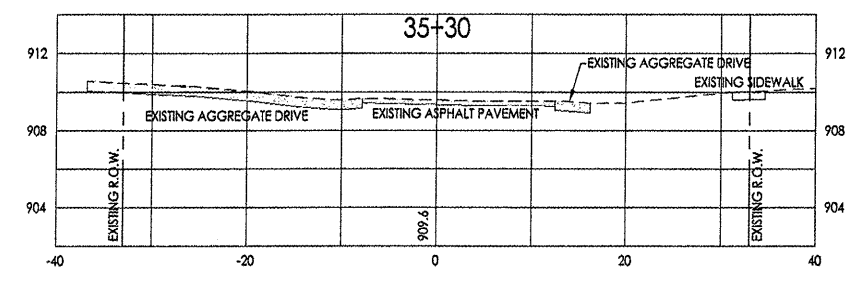

700 WEST LOCUST ST., BELVIDERE, IL 61008
 (815)-547-8435 FAX: (815)-544-0421
 ILLINOIS DESIGN FIRM NO. 184-001260

Date	Revision	By
5/12/11	REVISED PER IDOT REVIEW LETTER (DATED APRIL 27)	JAB
1/17/11	REVISED PER IDOT/HHWA MEETING (JULY 20, 2011)	JAB
2/08/12	REVISED PER IDOT REVIEW LETTER (DATED JANUARY 19, 2012)	JAB
2/24/12	REVISED PER IDOT E-MAILS (FEBRUARY 15 & 16, 2012)	JAB

**Safe Routes to School
Cross-Sections**

CHECKED BY: KCB DATE: 02/18/11	DRAWN BY: JAB DATE: 02/18/11	Sheet 15 of 15
-----------------------------------	---------------------------------	-------------------

3000_BASE.dwg