

F.A.U. RTE.	SECTION	COUNTY	TOTAL SHEETS	SHEET NO.
6160	10-00090-00-WR	LASALLE	61	1
STA. 0+11.71		TO STA. 52+77.14		
FED. ROAD DIST. NO. 3		ILLINOIS FED. AID PROJECT		

INDEX OF SHEETS

- 1 COVER SHEET & INDEX OF SHEETS
- 2 GENERAL INFORMATION, NOTES
- 3-4 DETAILS
- 5-6 TYPICAL SECTIONS
- 7-8 SCHEDULE OF QUANTITIES
- 9 TRAFFIC CONTROL PLAN
- 10 ROW PLAT
- 11-14 REMOVAL PLAN
- 15-23 PLAN AND PROFILE
- 24 PAVEMENT MARKING PLAN
- 25-27 STRUCTURE REPLACEMENT PLANS
- 28 ADVANCED WARNING SIGNING PLAN
- 29 RADAR SPEED LIMIT SIGN ASSEMBLY DETAIL
- 30 EROSION CONTROL PLAN
- 31-61 CROSS SECTIONS

HIGHWAY STANDARDS

ABBREVIATIONS, SYMBOLS AND PATTERNS	000001-06
TEMPORARY EROSION CONTROL SYSTEMS	280001-06
MAILBOX TURNOUT	406201-01
PERPENDICULAR CURB RAMPS FOR SIDEWALKS	424001-06
DIAGONAL CURB RAMPS FOR SIDEWALKS	424006
CORNER PARALLEL CURB RAMPS FOR SIDEWALKS	424011
DEPRESSED CORNER FOR SIDEWALKS	424021
PRECAST REINFORCED CONC. FLARED END SECTION	542301-03
METAL END SECTIONS FOR PIPE ARCHES	542406-01
CATCH BASIN, TY-A	602001-02
CATCH BASIN TY-C	602011-02
INLET, TY-A	602301-03
INLET, TY-B	602306-03
MANHOLE, TY-A	602401-03
PRECAST REINF. CONC. FLAT TOP SLAB	602601-02
MANHOLE STEPS	602701-02
FRAME AND LIDS, TYPE 1	604001-03
FRAME & GRATE, TY-3	604006-04
GRATE, TY-B	604036-02
CONCRETE CURB TY-B & COMBINATION CONCRETE CURB & GUTTER	606001-04
STEEL PLATE BEAM GUARDRAIL	630001-10
GUARDRAIL MOUNTED ON EXISTING CULVERT	630101-09
TRAFFIC BARRIER, TERMINAL TYPE 2	631011-08
CHAIN LINK FENCE	664001-02
URBAN LANE CLOSURE 2L, 2W UNDIVIDED	701501-06
SIDEWALK, CORNER OR CROSSWALK CLOSURE	701801-05
TRAFFIC CONTROL DEVICES	701901-02
SIGN PANEL MOUNTING DETAILS	720001-01
SIGN PANEL ERECTION DETAILS	720006-03
APPLICATIONS OF TYPES A & B METAL POSTS (FOR SIGNS AND MARKERS)	729001-01
TYPICAL PAVEMENT MARKINGS	780001-03
LIGHT POLE FOUNDATION	836001-01
TYPICAL APPLICATION OF TRAFFIC CONTROL DEVICES FOR CONSTRUCTION ON RURAL LOCAL HIGHWAYS	BLR 22-7

BENCHMARKS:

- BM # 12 - SPIKE IN P.P., W. SIDE OF OTTERCREEK RD. @ N.W. COR 12TH ST. - STA. 0+26 LT. (ELEV=619.50)
- BM # 30 - SPIKE IN P.P., W. SIDE OF OTTERCREEK RD. @ N.W. COR JAMES ST. - STA. 13+57 LT. (ELEV=617.70)
- BM # 66 - SPIKE IN P.P., W. SIDE OF OTTERCREEK RD. @ N.W. COR LUNDY ST. - STA. 33+26 LT. (ELEV=618.15)

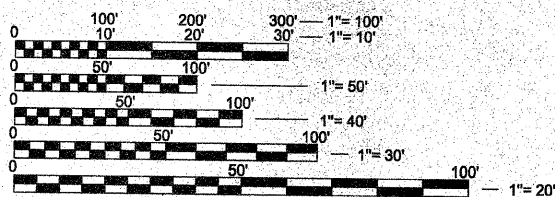

FULL SIZE PLANS HAVE BEEN PREPARED USING STANDARD ENGINEERING SCALES. REDUCED SIZED PLANS WILL NOT CONFORM TO STANDARD SCALES. IN MAKING MEASUREMENTS ON REDUCED PLANS, THE ABOVE SCALES MAY BE USED.

J.U.L.I.E.
JOINT UTILITY LOCATION INFORMATION FOR EXCAVATION
1-800-892-0123
OR 811

CONTRACT NO. 87388

STATE OF ILLINOIS

DEPARTMENT OF TRANSPORTATION

DIVISION OF HIGHWAYS

PLANS FOR PROPOSED LOCAL AGENCY IMPROVEMENT

S. OTTERCREEK RD. (FAU 6160) (FROM 12TH ST. TO IL ROUTE 18 MAIN ST.)

CITY OF STREATOR

SECTION 10-00090-00-WR

PROJECT NO. M-5066(013)

LaSALLE COUNTY

JOB C-93-078-09

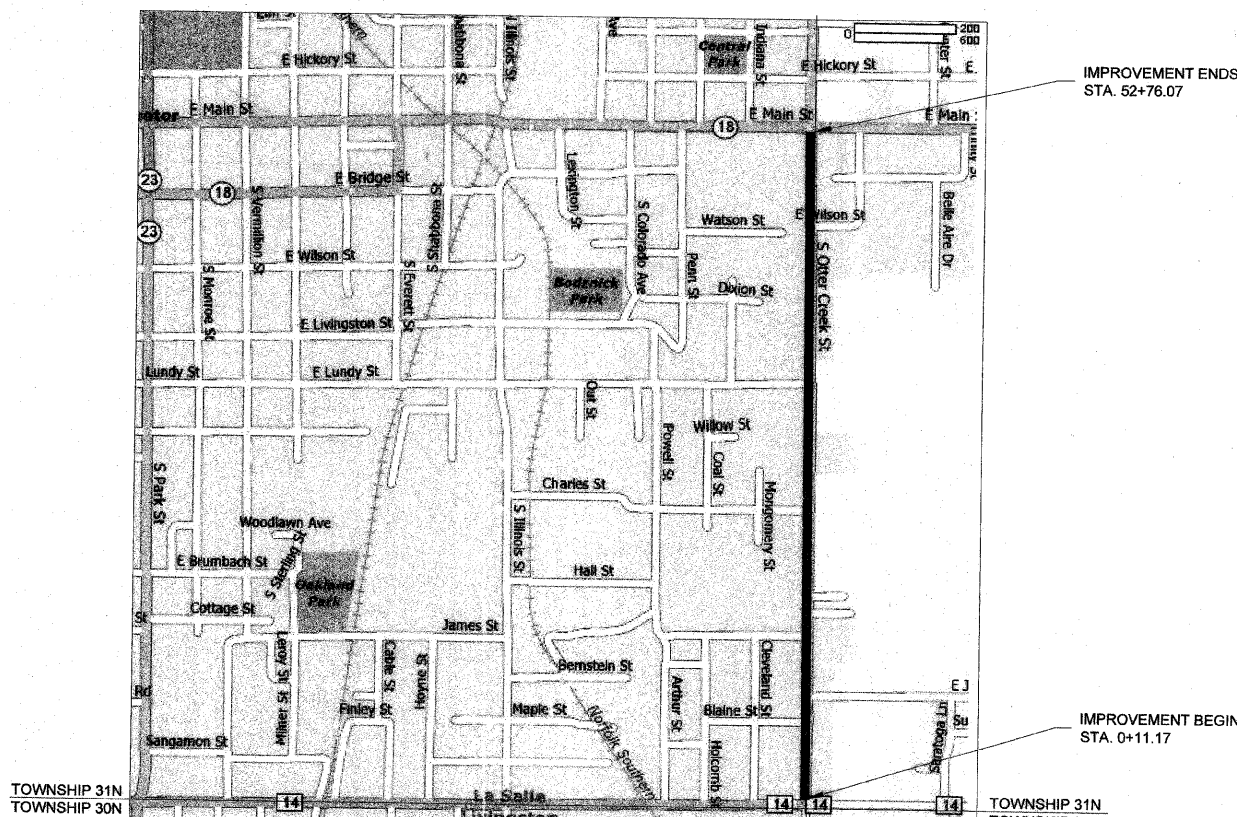
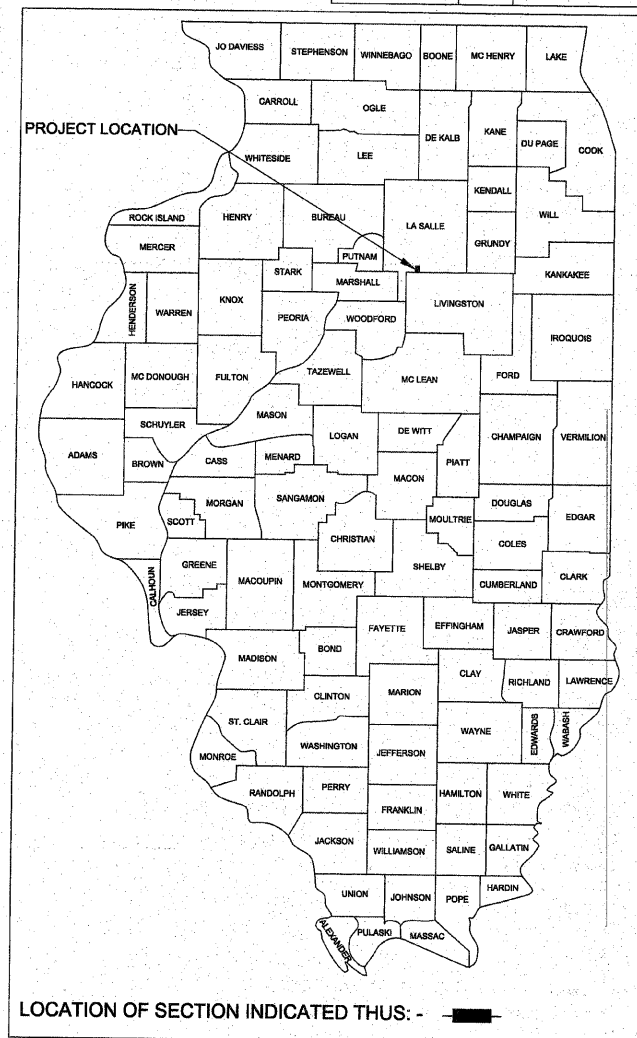

LOCATION MAP - CITY OF STREATOR
TOTAL LENGTH OF PROJECT = 5,266 FEET = 0.997 MILES
NET LENGTH OF PROJECT = 5,266 FEET = 0.997 MILES

ROADWAY DATA

ROUTE CLASSIFICATION:	COLLECTOR
FACILITY CLASS:	II (2-LANE)
CURRENT YEAR ADT:	2723 (YEAR 2009)
DESIGN YEAR ADT:	3000 (YEAR 2029)
DESIGN GUIDELINES:	URBAN
DESIGN SPEED:	25 MPH

FINAL

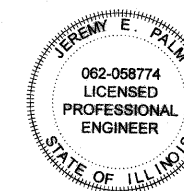

SIGNATURE: *Jeremy E. Palm* DATE: 11/29/11
EXPIRATION 11/30/2013

STATE OF ILLINOIS
DEPARTMENT OF TRANSPORTATION
DIVISION OF HIGHWAYS

APPROVED 12-6-2011
James D. Conzel
LOCAL AGENCY REPRESENTATIVE

PASSED 1-4-2012
John M. ...
DISTRICT 3 IMPLEMENTATION ENGINEER

RELEASING FOR BID BASED ON LIMITED REVIEW 1-4-2012
Eric J. ...
DEPUTY DIRECTOR OF HIGHWAYS
REGION TWO ENGINEER

PRINTED BY THE AUTHORITY OF THE STATE OF ILLINOIS