

F.A.U. RTE.	SECTION	COUNTY	TOTAL SHEETS	SHEET NO.
6160	10-00090-00-WR	LASALLE	61	19
STA. 0+11.71		TO STA. 52+77.14		
FED. ROAD DIST. NO. 3		ILLINOIS	FED. AID PROJECT	

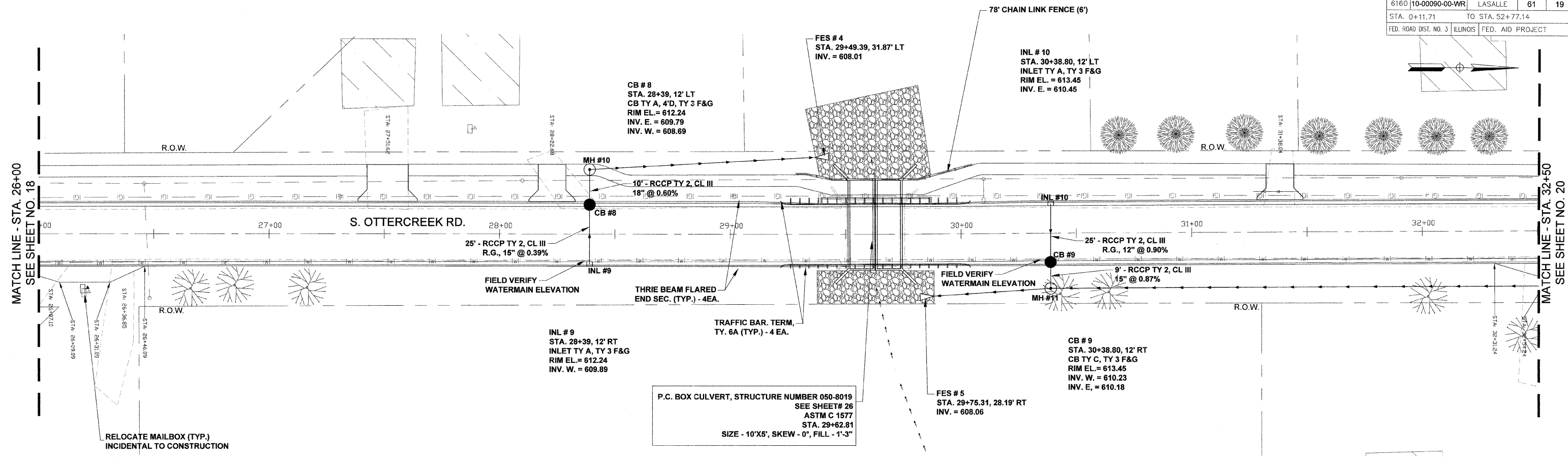

GH POINT ELEV = 614.05  
 GH POINT STA = 25+95.36  
 PVI STA = 25+90  
 PVI ELEV = 614.27  
 A.D. = -1.7605  
 K = 56.8006

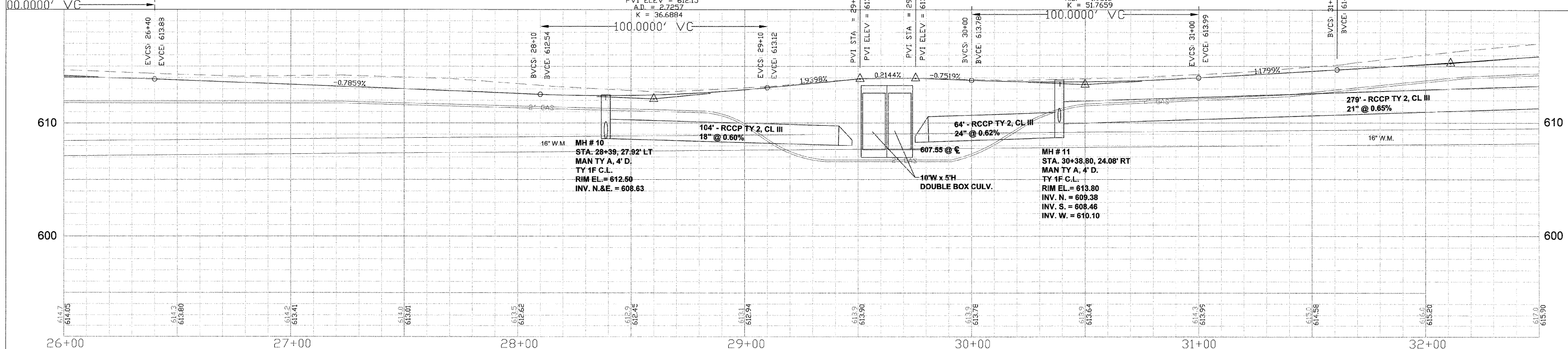

FINAL

SCALE: 1" = 20'

DESIGNED - JEP	REVISED - 11/29/2011
DRAWN - JCL	REVISED -
CHECKED - JEP	REVISED -
DATE - 12/01/2008	REVISED -

STATE OF ILLINOIS  
 DEPARTMENT OF TRANSPORTATION

Plan and Profile (Sta. 26+00 to 32+50)