

NOTE:  
ALONG EDGE OF REPLACEMENT DRIVEWAY, FURNISH AND PLACE, 4" TOPSOIL W/ SEEDING, CLASS 1

**HMA DRIVEWAY REPLACEMENT DETAIL**  
NOT TO SCALE

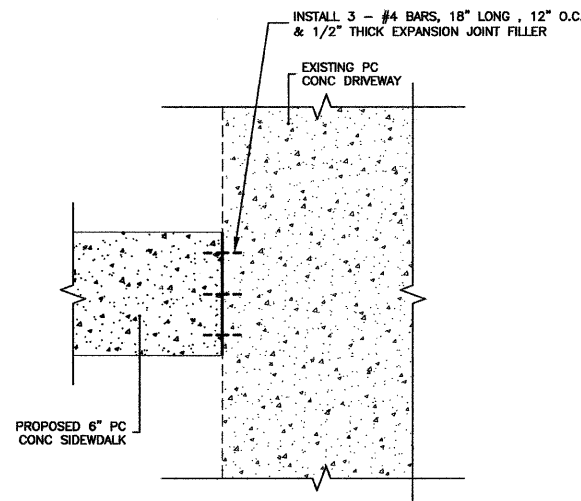

**PLAN**

**MIXTURE TABLE**

	HMA DRIVEWAY PAVEMENT
PG GRADE	PG 64-22
MAX % RAP ALLOWABLE	10
DESIGN AIR Voids	4.0% @ N50
MIXTURE COMPOSITION	IL 9.5
FRICTION AGGREGATE	MIXTURE C
DENSITY TEST METHOD	SATISFACTION OF ENGINEER

\* MATERIAL SHALL BE COMPACTED TO 93.0-97.4 PERCENT OF THE MAXIMUM THEORETICAL DENSITY, EXCEPT THAT WHEN PLACED AS FIRST LIFT ON AN UNIMPROVED SUBGRADE, THE MINIMUM PERCENT COMPACTION SHALL BE 92.0 PERCENT. THE MAXIMUM THEORETICAL DENSITY SHALL BE DETERMINED FROM THE MOVING AVERAGE AS SPECIFIED IN THE QC/QA SPECIFICATION.

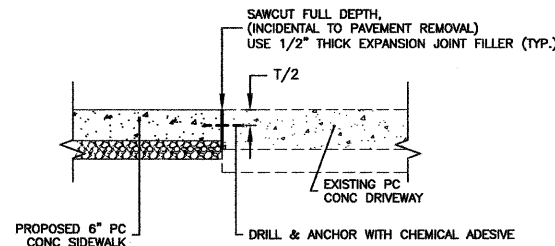

**PROFILE**

NOTE:  
ALONG EDGE OF REPLACEMENT DRIVEWAY, FURNISH AND PLACE 4" TOPSOIL W/ SEEDING, CLASS 1

**PROPOSED PC CONC. SIDEWALK ABUTTING EXISTING P.C.C. DRIVEWAY DETAIL**  
NOT TO SCALE

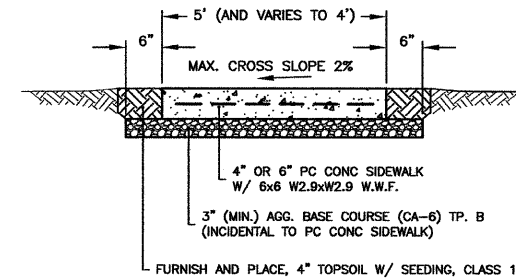

**PC CONCRETE SIDEWALK DETAIL**  
NOT TO SCALE

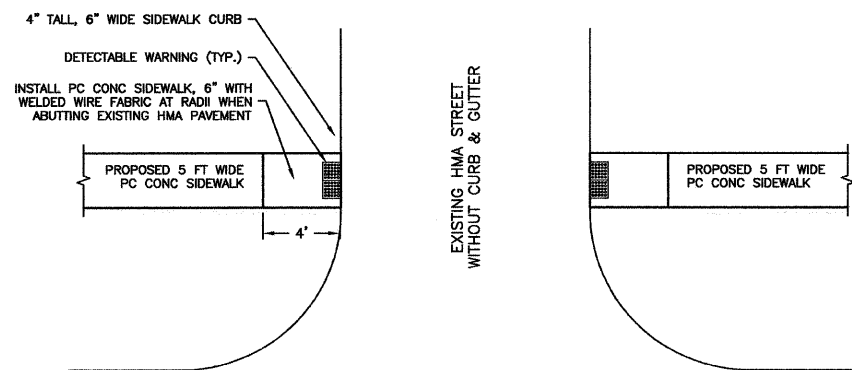

**PC CONC. SIDEWALK DETAIL ABUTTING EXISTING HMA PAVEMENT**  
NOT TO SCALE

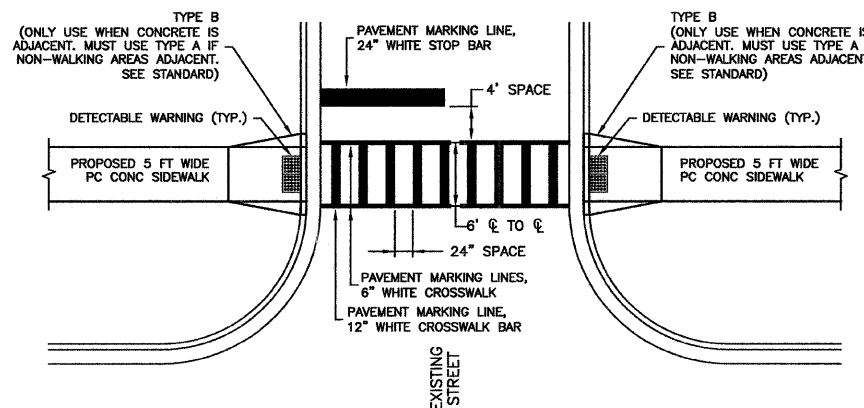

**HIGH VOLUME CROSSWALK DETAIL**  
NOT TO SCALE

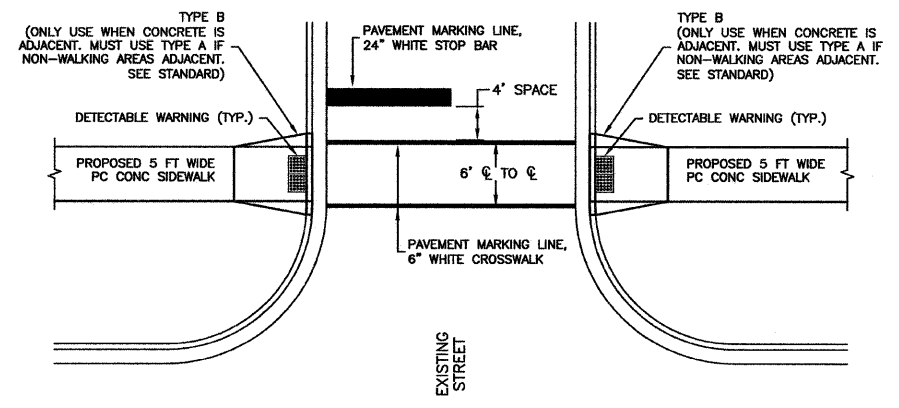

**LOW VOLUME CROSSWALK DETAIL**  
NOT TO SCALE

**GENERAL NOTES:**

- BEFORE STARTING ANY EXCAVATION, THE CONTRACTOR SHALL CALL J.U.L.I.E. AT (800) 892-0123 FOR FIELD LOCATIONS OF BURIED ELECTRIC, TELEPHONE AND GAS UTILITIES. (48 HOUR NOTIFICATION IS REQUIRED).
- BOTH ROBINSON ENGINEERING, LTD. (815-464-2240) AND THE CITY OF PLANO PUBLIC WORKS DEPARTMENT (630-552-7000) SHALL BE NOTIFIED TWO (2) WORKING DAYS BEFORE CONSTRUCTION BEGINS.
- WHEN IN THE CONSTRUCTION OPERATION, IF ANY LOOSE MATERIAL IS DEPOSITED IN THE FLOW LINE OF DITCHES, GUTTERS, OR OTHER DRAINAGE STRUCTURES SO THAT THE NATURAL FLOW OF WATER IS OBSTRUCTED, IT SHALL BE REMOVED AT THE CLOSE OF EACH DAY BY THE CONTRACTOR AT HIS EXPENSE.
- AREAS DISTURBED BY CONSTRUCTION SHALL BE KEPT TO A MINIMUM. ALL AREAS DISTURBED UNNECESSARILY SHALL BE RESTORED AS REQUIRED IN THE SPECIAL PROVISIONS AT THE CONTRACTOR'S EXPENSE.
- ALL PAVEMENT, CURB AND SIDEWALK REMOVALS SHALL BE MADE BY MEANS OF A STRAIGHT SAW CUT JOINT. THIS WORK SHALL NOT BE PAID FOR SEPARATELY, BUT SHALL BE INCLUDED IN THE UNIT PRICE BID FOR THE VARIOUS ITEMS.
- TEMPORARY ACCESS TO PROPERTIES AFFECTED BY THE CONSTRUCTION SHALL BE MAINTAINED AT ALL TIMES BY PLACEMENT OF TEMPORARY AGGREGATE. THE CONTRACTOR SHALL PERIODICALLY MONITOR ALL AFFECTED AREAS DURING THE PROJECT, AND SHALL PLACE ADDITIONAL AGGREGATE WHEN NECESSARY. THIS WORK WILL NOT BE PAID FOR DIRECTLY, BUT WILL BE CONSIDERED INCIDENTAL TO THE CONTRACT.
- IT SHALL BE THE CONTRACTOR'S RESPONSIBILITY TO VERIFY ALL DIMENSIONS AND CONDITIONS EXISTING IN THE FIELD PRIOR TO CONSTRUCTION AND ORDERING OF MATERIALS.
- WHERE CURB IS NOT PRESENT, THE LAST 5' OF NEW WALK SHALL BE THICKENED TO A MINIMUM OF 7". THIS WORK SHALL BE CONSIDERED INCIDENTAL TO PORTLAND CEMENT CONCRETE SIDEWALK, 4 INCH.

FILE NAME = 10228-NOTE-01 - P01

USER NAME =	DESIGNED -- BDB	REVISION --
CHECKED -- JRA	REVISION --	
PLOT SCALE =	DRAWN -- JJB	REVISION --
PLOT DATE = 8/17/2011	CHECKED -- BDB	REVISION --

STATE OF ILLINOIS  
DEPARTMENT OF TRANSPORTATION

SAFE ROUTES TO SCHOOLS  
CITY OF PLANO  
GENERAL NOTES AND DETAILS

SCALE: SHEET NO. 5 OF 12 SHEETS STA. TO STA.

F.A.U. RTE.	SECTION	COUNTY	TOTAL SHEETS	SHEET NO.
VAR	10-00038-00-SW	KENDALL	12	5
CONTRACT NO. 87456				
FED. ROAD DIST. NO. 3 ILLINOIS FED. AID PROJECT SRTS-4009(103)				