

DATE	
BY	
FINAL SURVEY	
SUBMITTED	
PLOTTED	
TEMPLATE	
NOTE BOOK	
AREAS CHECKED	
AREAS CHECKED	

DATE	
BY	
ORIGINAL SURVEY	
SUBMITTED	
PLOTTED	
TEMPLATE	
NOTE BOOK	
AREAS CHECKED	
AREAS CHECKED	

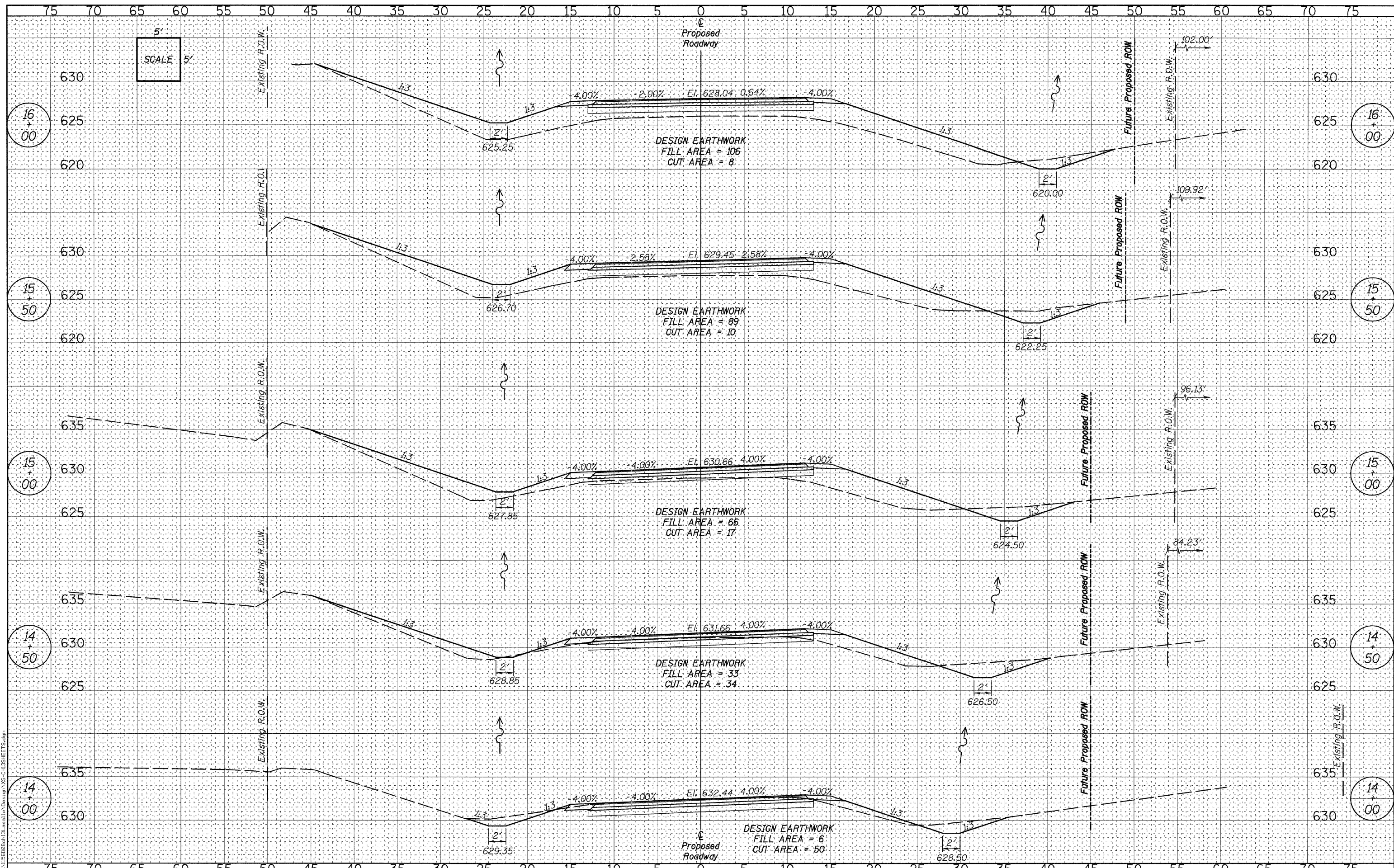

WILLET HOFMANN ASSOCIATES INC.
 ENGINEERING ARCHITECTURE LAND SURVEYING
 809 EAST 2ND STREET, DIXON, IL 61021-0367
 T: 815-284-3381 DESIGN FIRM #184-000938

DESIGNED	- J.M.K.	REVISED	-
CHECKED	- G.F.S.	REVISED	-
DRAWN	- J.M.K.	REVISED	-
CHECKED	- G.F.S.	REVISED	-

LASALLE COUNTY
C.H. 13 OVER TOMAHAWK CREEK
STATION 20+00

CROSS SECTIONS - C.H. 13
STRUCTURE NO. 050-3604

SHEET NO. 4 OF 13 SHEETS STA. 14+00 TO STA. 16+00

F.A.S. RTE.	SECTION	COUNTY	TOTAL SHEETS	SHEET NO.
260	10-00651-00-BR	LASALLE	51	39
WHA# 1156D08		CONTRACT NO. 87466		
ILLINOIS FED. AID PROJECT BRS-0260(105)				