

DATE	
BY	
FINAL SURVEY	
SURVEYED	
PLOTTED	
TEMPLATE	
NOTE BOOK	
AREAS CHECKED	
NO.	

DATE	
BY	
ORIGINAL SURVEY	
SURVEYED	
PLOTTED	
TEMPLATE	
NOTE BOOK	
AREAS CHECKED	
NO.	

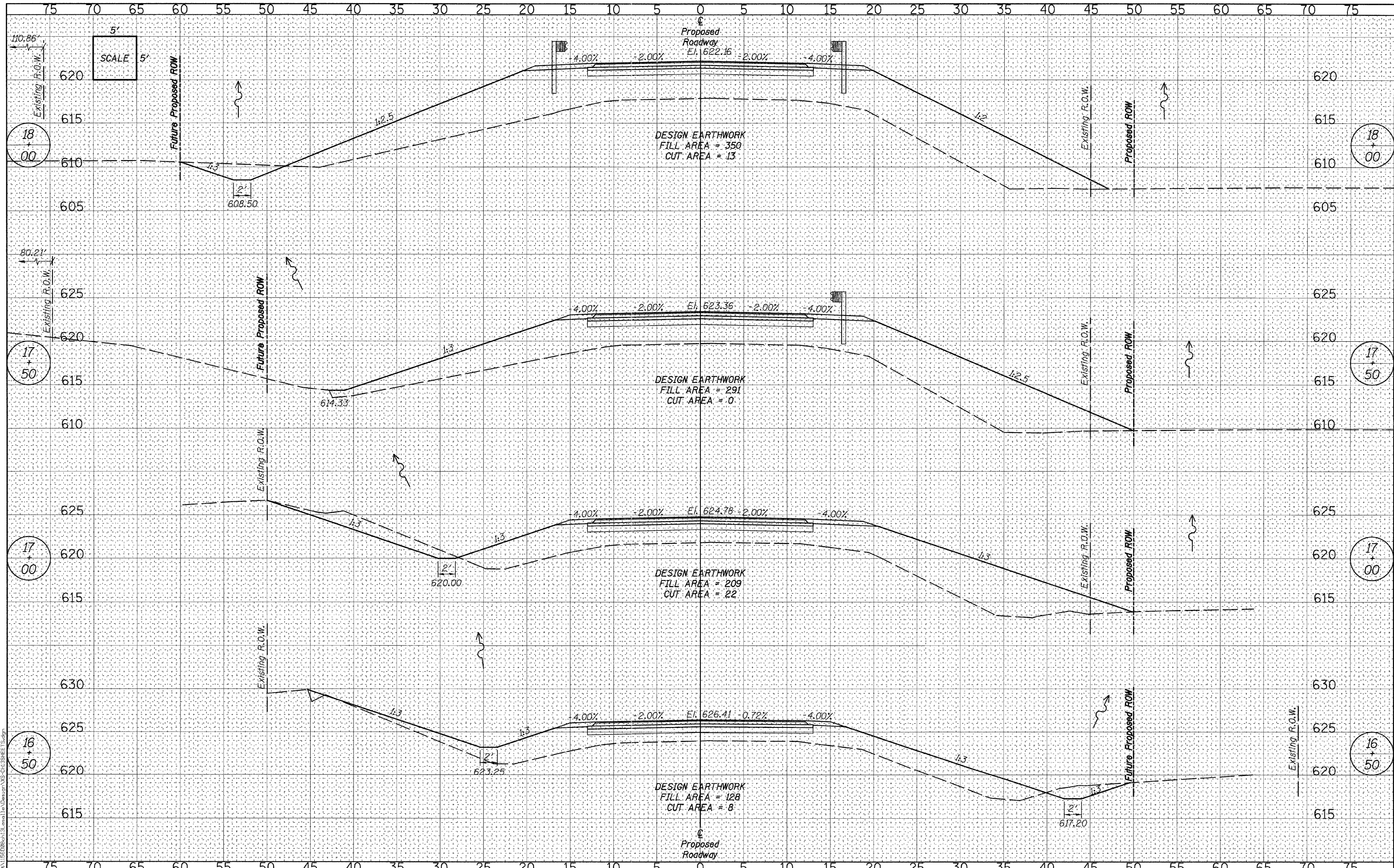

WILLET HOFMANN ASSOCIATES INC.
 809 EAST 2ND STREET, DUKOW, IL 61021-0367
 T: 815-284-3381 DESIGN FIRM: #384-009948

DESIGNED	- J.M.K.	REVISED	-
CHECKED	- G.F.S.	REVISED	-
DRAWN	- J.M.K.	REVISED	-
CHECKED	- G.F.S.	REVISED	-

**LASALLE COUNTY
 C.H. 13 OVER TOMAHAWK CREEK
 STATION 20+00**

**CROSS SECTIONS - C.H. 13
 STRUCTURE NO. 050-3604**

SHEET NO. 5 OF 13 SHEETS STA. 16+50 TO STA. 18+00

F.A.S. RTE.	SECTION	COUNTY	TOTAL SHEETS	SHEET NO.
260	10-00651-00-BR	LASALLE	51	40
WHA# 1156D08		CONTRACT NO. 87466		
ILLINOIS FED. AID PROJECT BRS-0260(105)				