

FINAL SURVEY	BY	DATE
NOTE BOOK NO.		
TEMPLATES AREAS CHECKED		

ORIGINAL SURVEY	BY	DATE
NOTE BOOK NO.		
TEMPLATES AREAS CHECKED		

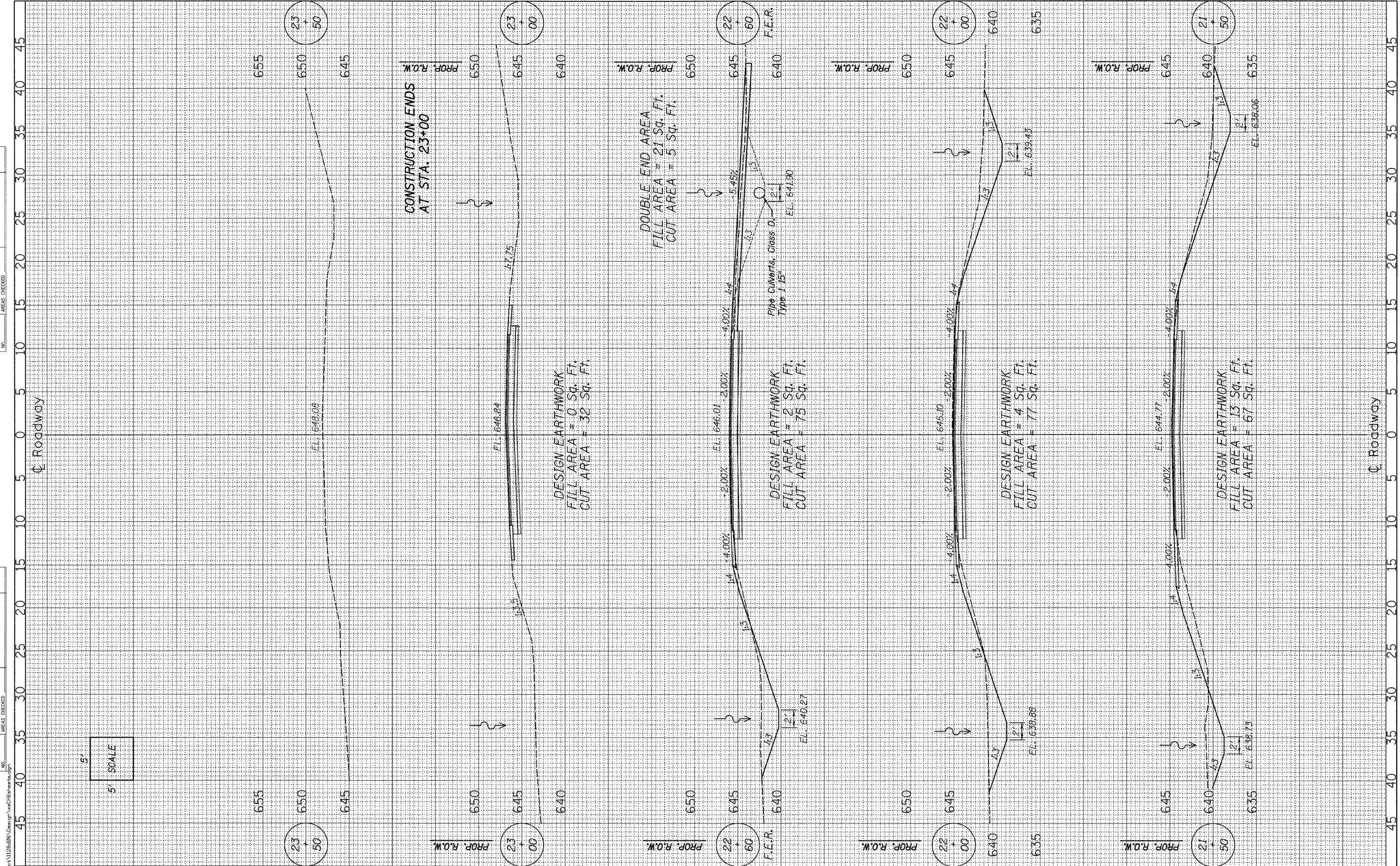

FILE: S:\S\p\112806\Design\112806.dwg

WILLET HOFMANN
 ASSOCIATES INC.
 ENGINEERING ARCHITECTURE LAND SURVEYING
 809 EAST 2ND STREET, DIXON, IL 61021-0357
 T: 815-284-3351 DESIGN FIRM: #184-00918

DESIGNED - MICHAEL WAGNER	REVISED -
DRAWN - RON ALLEN	REVISED -
CHECKED - BRIAN CONVERSE	REVISED -
DATE - AUGUST 2011	REVISED -

MERCER COUNTY
F.A.S. 217 (C.H. 6) OVER MAIDS RUN
STATION 20 + 05

CROSS SECTIONS
STRUCTURE NO. 066-3031
 SCALE: 1" = 5'
 SHEET NO. 3 OF 3 SHEETS
 STA. 21+50.00 TO STA. 23+50.00

F.A.S. RTE. 217	SECTION 05-00096-00-BR	COUNTY MERCER	TOTAL SHEETS 21	SHEET NO. 20
WHA# 1128006		CONTRACT NO. 89432		
ILLINOIS FED. AID PROJECT BRS-021(102)				