

VARIABLE MILLING DEPTH FOR SUPERELEVATION CORRECTION		
STATION	AT $\bar{C}$	AT EDGE PAVEMENT
192+09 LT	1 1/2"	1 1/2"
192+50 LT	1"	1 7/16"
193+00 LT	1"	5/16"
193+50 LT	1"	1 7/16"
194+00 LT	1"	2 1/4"
194+50 LT	1"	2 3/16"
195+00 LT	1"	1 13/16"
195+50 LT	1"	1 1/2"
196+00 LT	1"	13/16"
196+50 LT	1"	3/4"

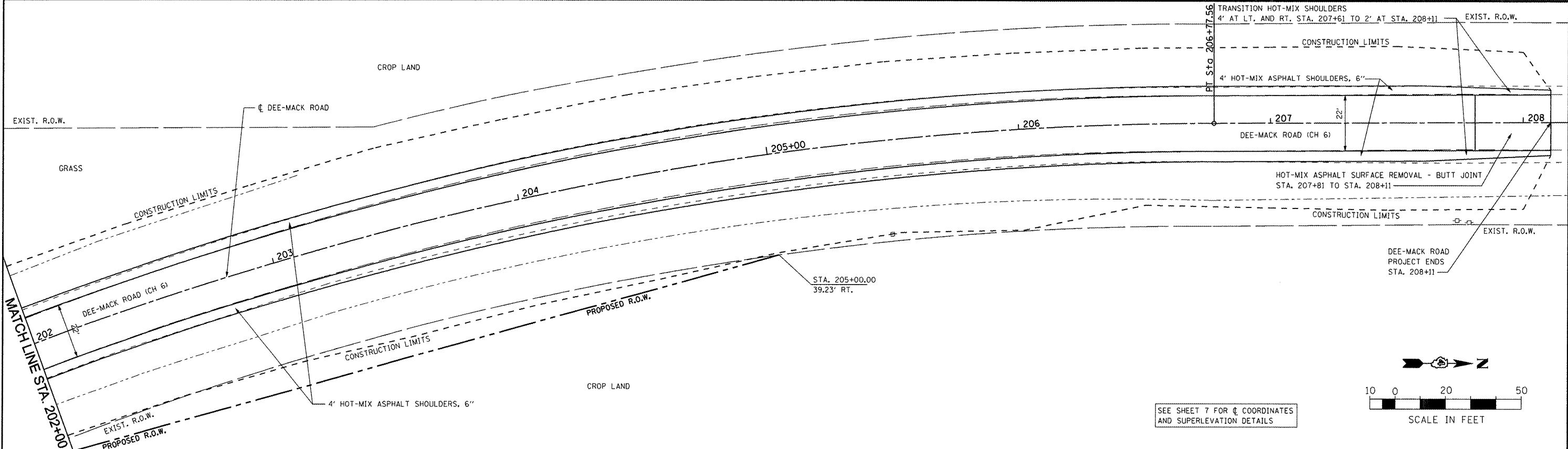
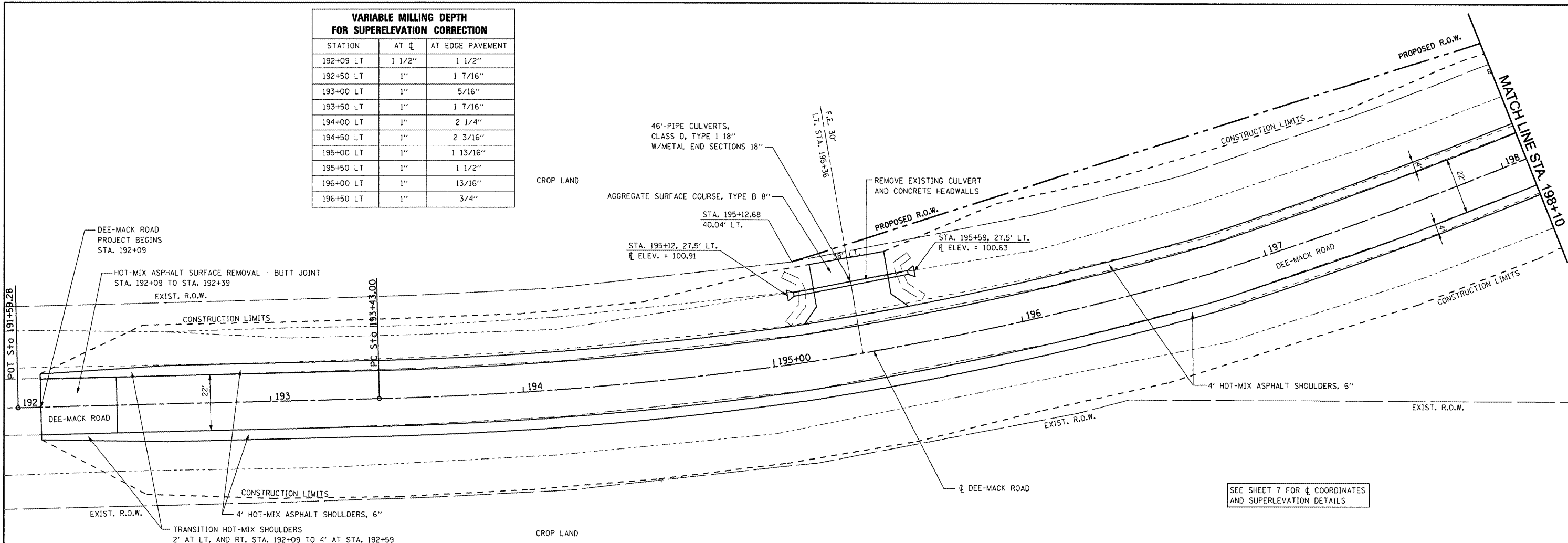

FILE NAME = X:\PROJECTS\2007705506\DCN\DEEMACK-COOPER\PLANS-REFS\RDWY PLAN 02.DGN

USER NAME =  
 PLOT SCALE =  
 PLOT DATE = 2/24/2012

DESIGNED - REW	REVISED -
DRAWN - KRS, DLC	REVISED -
CHECKED - KMC	REVISED -
DATE -	REVISED -

**STATE OF ILLINOIS  
 DEPARTMENT OF TRANSPORTATION**

**TAZEWELL COUNTY - DEE-MACK ROAD AND COOPER ROAD  
 INTERSECTION IMPROVEMENTS  
 ROADWAY PLAN**

SCALE: SHEET NO. OF SHEETS STA. TO STA.

F.A.S. RTE.	SECTION	COUNTY	TOTAL SHEETS	SHEET NO.
470	10-00076-00 RS	TAZEWELL	38	9

ILLINOIS FED. AID PROJECT