

**72000100 SIGN PANEL - TYPE 1**

LOCATION	QUANTITY
EX. MAA&P A - (R10-3E)	0.94 SQ.FT.
EX. TS POST B - (R10-3E)	0.94
PROP. TS POST C - (R10-3E)	0.94
EX. TS POST D - (R10-3E)	0.94
<b>TOTAL THIS SHEET</b>	<b>3.76 SQ.FT.</b>

**87800100 CONCRETE FOUNDATION, TYPE A**

LOCATION	QUANTITY
48.0' RT. STA. 138+16.33 (C)	3 FT.
<b>PROJECT TOTAL</b>	<b>3 FT.</b>

**88102717 PEDESTRIAN SIGNAL HEAD, LED, 1-FACE, BRACKET MOUNTED W/COUNTDOWN TIMER**

LOCATION	QUANTITY
EXISTING MAA&P (A)	1 EA.
EXISTING TS POST (B)	1
PROPOSED TS POST (C)	1
EXISTING TS POST (D)	1
<b>TOTAL THIS SHEET</b>	<b>4 EA.</b>

**88800100 PEDESTRIAN PUSH-BUTTON**

LOCATION	QUANTITY
EXISTING MAA&P (A)	1 EA.
EXISTING TS POST (B)	1
PROPOSED TS POST (C)	1
EXISTING TS POST (D)	1
<b>TOTAL THIS SHEET</b>	<b>4 EA.</b>

ROUTE NO	SECTION	COUNTY	TOTAL SHEETS	THIS SHEET
F.A.U. 6728	*	TAZEWELL	28	14

FED. RD. DIST. NO. 7 ILLINOIS PROJECT TE-004(110)  
 \*10-00109-00-BT  
 CONTRACT NO. 89598

**81028350 UNDERGROUND CONDUIT, PVC, 2" DIA.**

LOCATION	QUANTITY
EX. HH#2 TO PROP. TRAFFIC SIGNAL POST C	32 FT.
<b>PROJECT TOTAL</b>	<b>32 FT.</b>

LOCATION	QUANTITY
16.8' RT. STA. 138+18.6 (EX. HH#2)	1 EA.
<b>PROJECT TOTAL</b>	<b>1 EA.</b>

**89502210 MODIFY EXISTING CONTROLLER CABINET**

LOCATION	QUANTITY
47.9' RT. STA. 136+70.6	1 EA.
<b>PROJECT TOTAL</b>	<b>1 EA.</b>

**87301255 ELECTRIC CABLE IN CONDUIT, SIGNAL, NO. 14 7C**

LOCATION	QUANTITY
CONTROLLER TO EX. MAA&P A	134.0 FT.
CONTROLLER TO EX. TS POST B	217.5
CONTROLLER TO PROP. TS POST C	242.5
CONTROLLER TO EX. TS POST D	307.0
<b>TOTAL THIS SHEET</b>	<b>901.0 FT.</b>

**87500600 TRAFFIC SIGNAL POST, 10 FT.**

LOCATION	QUANTITY
48.0' RT. STA. 138+16.33 (C)	1 EA.
<b>PROJECT TOTAL</b>	<b>1 EA.</b>

- ALL TRAFFIC SIGNAL POSTS ARE TO BE GALVANIZED STEEL.
- THE LOCATION OF ALL UTILITIES SHALL BE FIELD VERIFIED BY THE CONTRACTOR BEFORE THE INSTALLATION OF ANY TRAFFIC SIGNAL COMPONENTS.
- THE EXISTING TRAFFIC SIGNALS SHALL REMAIN OPERATIONAL DURING THE INSTALLATION OF THE PEDESTRIAN HEADS.
- NO ADDITIONAL COMPENSATION SHALL BE ALLOWED FOR PLACING CONDUIT AT GREATER THAN 2 FOOT MINIMUM DEPTH TO AVOID OBSTACLES SUCH AS UNDERGROUND UTILITIES OR EXISTING PAVEMENT.
- THE CONTRACTOR IS RESPONSIBLE FOR THE COST OF UNCOVERING OR HAND DIGGING AROUND UTILITIES AS NECESSARY. THE COST FOR THIS WORK SHALL BE CONSIDERED INCIDENTAL TO THE COST OF CONSTRUCTING THE CONDUIT.
- THE PROPOSED TRAFFIC SIGNAL POST SHALL BE GROUNDED IN ACCORDANCE WITH NEC REGULATIONS.
- THE CONTRACTOR SHALL BE RESPONSIBLE FOR LOCATING ALL EXISTING IDOT LIGHTING AND TRAFFIC SIGNAL FACILITIES. THIS WORK SHALL BE INCLUDED IN THE CONTRACT BID PRICE.
- TIMING OF THE PEDESTRIAN HEADS SHALL BE PERFORMED BY THE ILLINOIS DEPARTMENT OF TRANSPORTATION. CONTACT RANDY LANINGA AT (309) 671-4477 FORTY EIGHT HOURS IN ADVANCE.

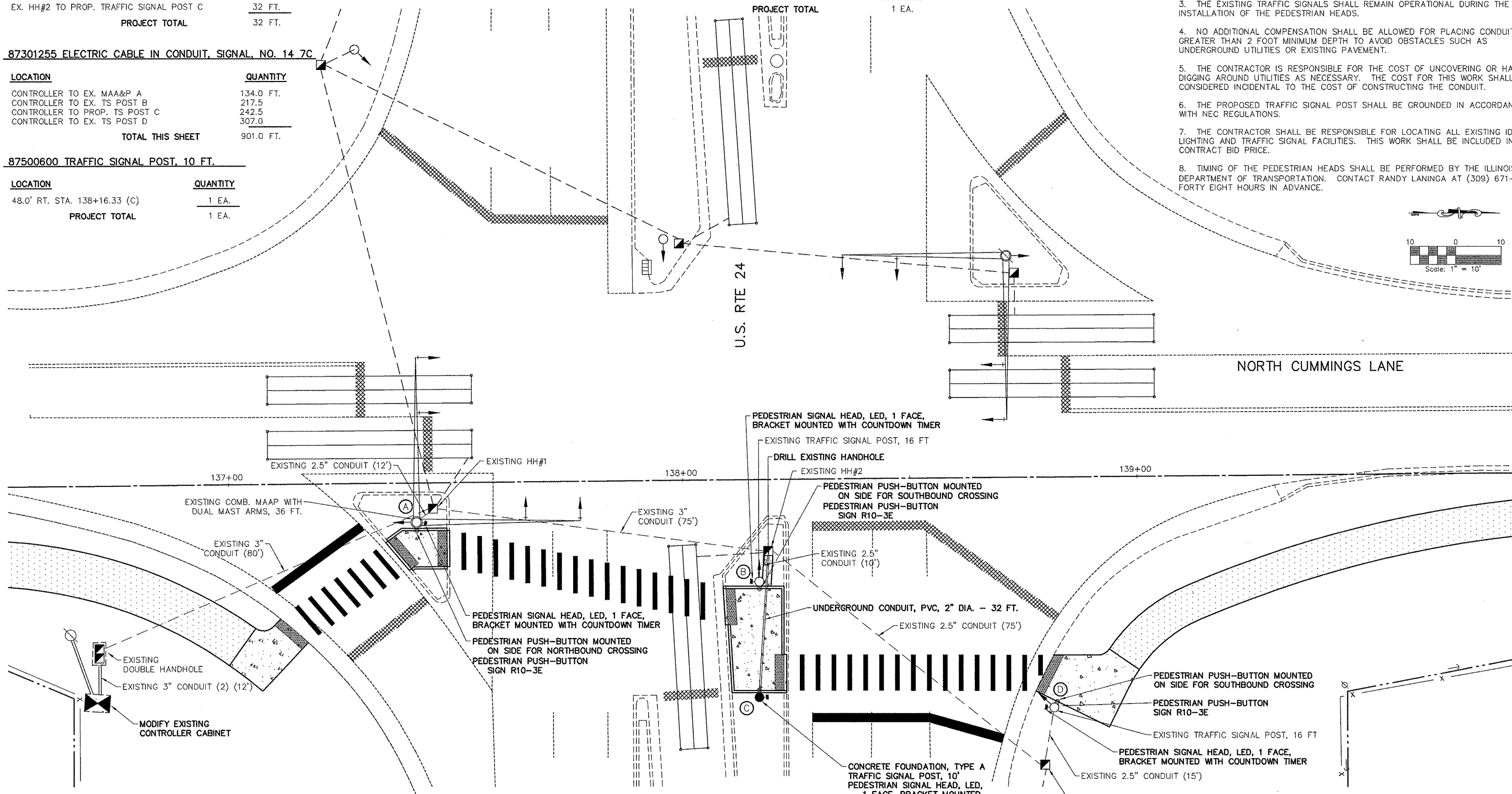
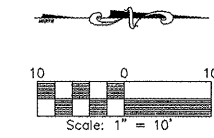

NORTH CUMMINGS LANE / BY-PASS RTE 24

<b>INTERSECTION DETAIL - RTE 24 SIGNALS</b>		<b>AUSTIN ENGINEERING, CO., INC.</b> Consulting Engineers / Surveyors 6100 North University Street Peoria, Illinois 61615-1979 License No. 184-001143	
FOR: CITY OF WASHINGTON		PROJECT: 20-10-008	DATE: 12/01/11
SCALE: 1"=10'	BOOK:	REVISIONS:	SHEET NO. 14 OF 28