

BEGIN IMPROVEMENTS
MULBERRY ST.
STA. 498+36.00
 (MATCH EXISTING)
 N. 1400829.58
 E. 802523.41

KEY NOTES THIS SHEET

- ① PROVIDE CONDUIT UNDER EXISTING PAVEMENT USING DIRECTIONAL BORING. BORE SHALL BE MEASURED TO 2 FEET PAST PAVEMENT ON EACH SIDE. LOCATE ALL EXISTING UTILITIES IN AREA PRIOR TO BEGINNING. FOR PROTECTION OF EXISTING UNDERGROUND UTILITIES ALL EXCAVATION AROUND THEM SHALL BE DONE BY HAND.
- ② CONTRACTOR WILL PROVIDE (2) 4" SCHEDULE 40 PVC CONDUITS 36" TO 42" UNDER EXISTING PAVEMENT USING DIRECTIONAL BORING FROM JUNCTION BOX LABELED 281-10 APPROXIMATELY 80 FEET TO THE NORTHWEST, AS SHOWN. AMEREN WILL PROVIDE ACCESS TO JUNCTION BOX 281-10, HOWEVER, THE CONTRACTOR WILL BE RESPONSIBLE FOR INSTALLING THE SWEEP INTO THE BOX. THE SWEEP AT EACH END SHALL BE SCHED. 80 PVC WITH A MINIMUM BENDING RADIUS OF 36". THE ENDS OF THE CONDUITS SHALL HAVE BUSHINGS INSTALLED. THE PULL STRING IN THE CONDUITS SHALL BE RATED AT 2600# OF TENSION. CONTRACTOR SHALL VERIFY ALL DISTANCES AT SITE PRIOR TO BIDDING.

CONDUCTOR SYMBOL SCHEME

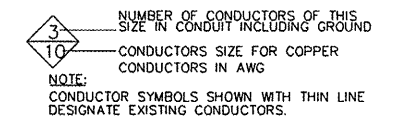

CIRCUIT DESIGNATION SCHEME

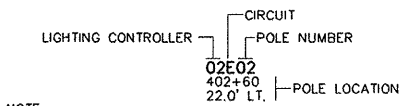

NOTE:
 PROVIDE PERMANENT STICKER ON EACH LIGHT POLE INDICATING THE LIGHTING CONTROLLER, CIRCUIT AND POLE NUMBER.

HANDHOLE NAMING SCHEME

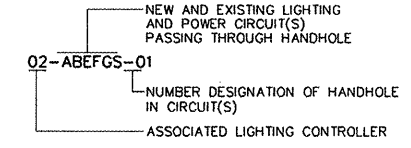

STREET LIGHTING LEGEND

EXISTING	PROPOSED	DESCRIPTION
<input type="checkbox"/>	<input checked="" type="checkbox"/>	PORTLAND CEMENT CONCRETE HANDHOLE.
<input type="checkbox"/>	<input checked="" type="checkbox"/>	DOUBLE PORTLAND CEMENT CONCRETE HANDHOLE.
<input type="checkbox"/>	<input checked="" type="checkbox"/>	GULFBOX JUNCTION, COMPOSITE CONCRETE.
<input type="checkbox"/>	<input checked="" type="checkbox"/>	TRAFFIC SIGNAL CONTROLLER CABINET.
<input type="checkbox"/>	<input checked="" type="checkbox"/>	LIGHTING CONTROLLER (# = CONTROLLER NUMBER)
<input type="checkbox"/>	<input checked="" type="checkbox"/>	LIGHTING ASSEMBLY MOUNTED ON SIGNAL POLE.
<input type="checkbox"/>	<input checked="" type="checkbox"/>	LIGHTING ASSEMBLY, DOUBLE ARMS WITH LUMINAIRES, PER SPECIAL PROVISIONS, MOUNTED ON 26' POLE, WITH CONCRETE FOUNDATION.
<input type="checkbox"/>	<input checked="" type="checkbox"/>	PVC CONDUIT (SCH. 80) IN TRENCH OR BORED AS NOTED (1 2-INCH UNLESS NOTED OTHERWISE) SEE CONDUIT/CABLE SCHEDULE FOR QUANTITIES

CONDUIT ROUTING NOTE

ALL CONDUIT SHOWN ARE DIAGRAMMATIC ONLY. ALL CONDUIT SHALL BE TRENCHED OR BORED THROUGH PATH OF LEAST RESISTANCE. COORDINATE THE INSTALLATION WITH UTILITIES, OTHER TRADES AND THE CITY.

ALL CONDUITS SHALL BE PROVIDED WITH AN INTEGRAL PULL STRING. THE PULL STRING SHALL BE INCLUDED IN THE COST OF THE CONDUITS AND NO ADDITIONAL COMPENSATION WILL BE ALLOWED.

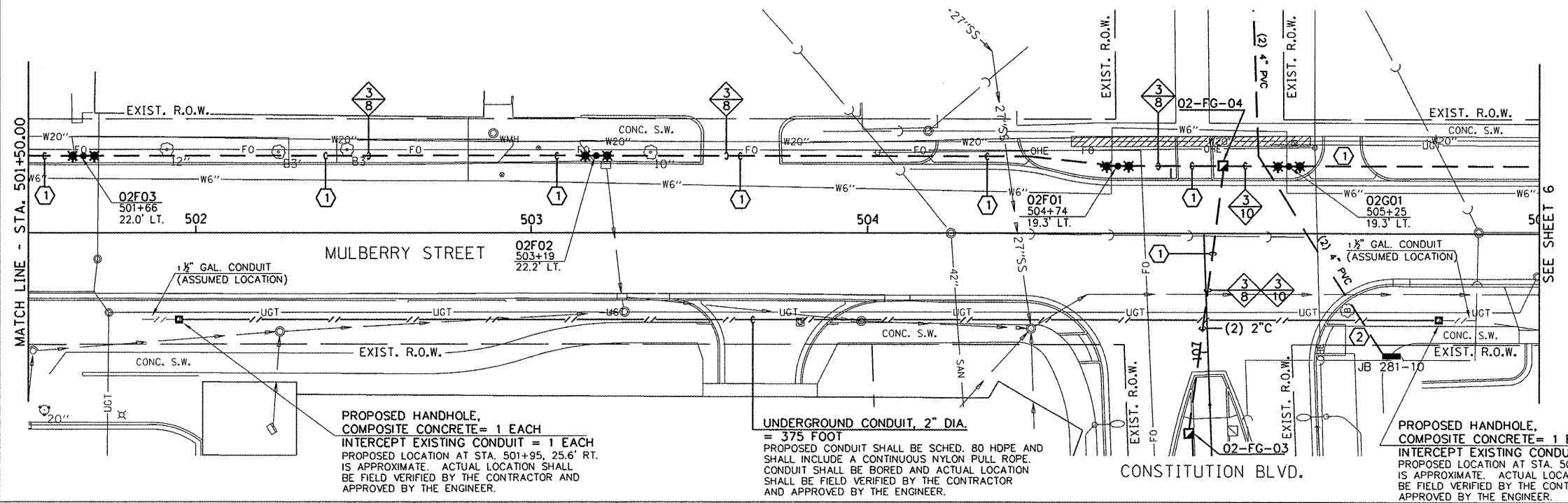

PROPOSED HANDHOLE, COMPOSITE CONCRETE = 1 EACH
 INTERCEPT EXISTING CONDUIT = 1 EACH
 PROPOSED LOCATION AT STA. 501+95, 25.6' RT. IS APPROXIMATE. ACTUAL LOCATION SHALL BE FIELD VERIFIED BY THE CONTRACTOR AND APPROVED BY THE ENGINEER.

UNDERGROUND CONDUIT, 2" DIA. = 375 FOOT
 PROPOSED CONDUIT SHALL BE SCHED. 80 HDPE AND SHALL INCLUDE A CONTINUOUS NYLON PULL ROPE. CONDUIT SHALL BE BORED AND ACTUAL LOCATION SHALL BE FIELD VERIFIED BY THE CONTRACTOR AND APPROVED BY THE ENGINEER.

PROPOSED HANDHOLE, COMPOSITE CONCRETE = 1 EACH
 INTERCEPT EXISTING CONDUIT = 1 EACH
 PROPOSED LOCATION AT STA. 505+70, 25.6' RT. IS APPROXIMATE. ACTUAL LOCATION SHALL BE FIELD VERIFIED BY THE CONTRACTOR AND APPROVED BY THE ENGINEER.

FILE NAME = p:\m0240094\...Plans\sheet\ 5-lighting.dgn
 PLOT DATE = 1/18/2012 7:35:13 PM

DESIGNED - M.P.	REVISED -
DRAWN - M.P.	REVISED -
CHECKED - S.M.W.	REVISED -
DATE - 1-12	REVISED -

STATE OF ILLINOIS
 DEPARTMENT OF TRANSPORTATION

LIGHTING PLANS - MULBERRY STREET

SCALE: 1"=20' SHEET NO. 5 OF 14 SHEETS STA. TO STA.

F.A.U. RTE.	SECTION	COUNTY	TOTAL SHEETS	SHEET NO.
	10-00242-00-LT	MCCLEAN	14	5
CONTRACT NO. 91460				
FED. ROAD DIST. NO. ILLINOIS FED. AID PROJECT				