

SECTION 8, T.12N., R.10W., 2nd P.M.

F.A.S.	SECTION	COUNTY	TOTAL SHEETS	SHEET NO.
680	10-00101-00-SP	EDGAR	132	23
EDGAR COUNTY, ILLINOIS		CONTRACT NO. 91467		

PROPOSED \odot CURVE DATA
 PI STA. = 98+65.14
 Δ = 63° 12' 44" (LT)
 D = 8° 16' 00"
 R = 693.10'
 T = 426.50'
 L = 764.67'
 E = 120.71'
 e = 0.08 FT/FT
 T.R. = 33.33'
 S.E. RUN = 163'
 P.C. STA. = 94+36.48
 P.T. STA. = 101+99.21
 S.E. ATTAINED:
 STATION 92+91.39 TO STATION 94+87.22
 STATION 101+44.17 TO STATION 103+40.50

CONSTRUCT SPECIAL DITCH
 LT. STA. 98+00 ELEV. = 528.00
 TO LT. STA. 100+00 ELEV. = 527.00
 TO LT. STA. 101+00 ELEV. = 526.75
 TO LT. STA. 101+50 ELEV. = 526.00
 TO LT. STA. 102+00 ELEV. = 525.00
 TO LT. STA. 102+85 ELEV. = 524.60

DALE & PAMELA ELLIOTT

PROPOSED \odot CURVE DATA
 PI STA. = 115+84.21
 Δ = 56° 54' 26" (RT)
 D = 6° 49' 09"
 R = 840.23'
 T = 455.33'
 L = 834.53'
 E = 115.44'
 e = 0.08 FT/FT
 T.R. = 36'
 S.E. RUN = 176'
 P.C. STA. = 111+28.89
 P.T. STA. = 119+63.42
 S.E. ATTAINED:
 STATION 109+68.30 TO STATION 111+80.30
 STATION 119+11.17 TO STATION 121+23.17

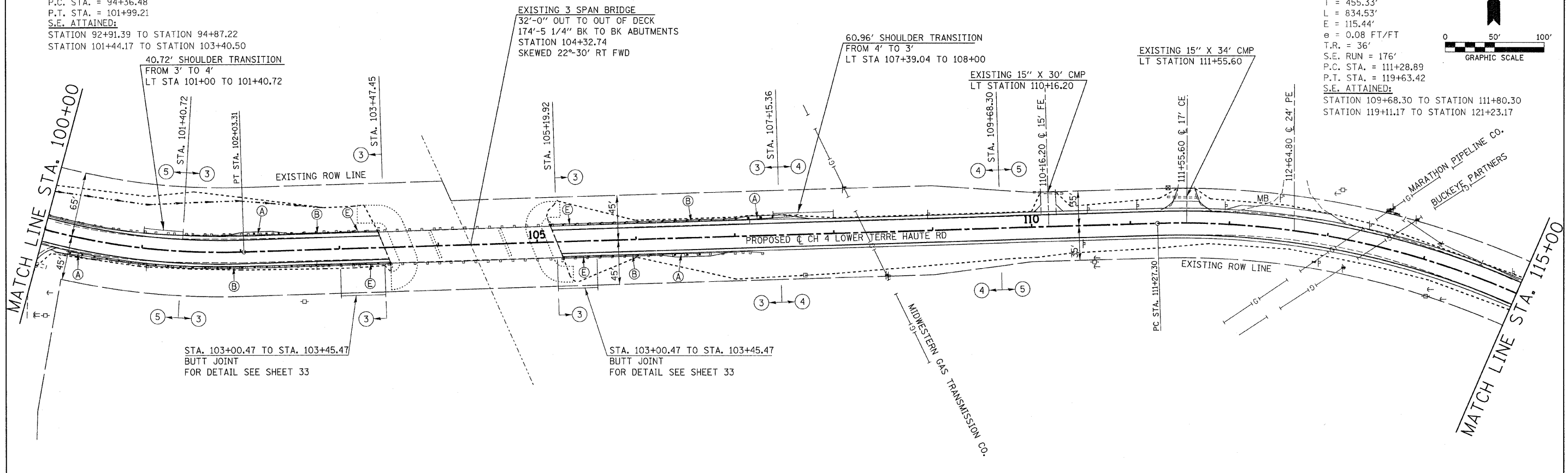
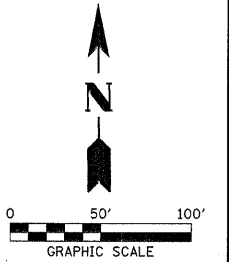

STA. 103+00.47 TO STA. 103+45.47
 BUTT JOINT
 FOR DETAIL SEE SHEET 33

STA. 103+00.47 TO STA. 103+45.47
 BUTT JOINT
 FOR DETAIL SEE SHEET 33

OMMISSION FROM SECTION AND PROJECT
 BRIDGE OMISSION STATION 103+45.47
 TO STATION 105+19.92

WILLIAM C McCLAIN

BM PT1007 TOP OF CONCRETE WALL IN DITCH, CENTER WALL
 28.51' RT. STA. 111+98.52
 N = 1032241.468
 E = 1205166.479
 ELEV. 535.69

- GUARDRAIL LEGEND**
- (A) TBT TYPE 1 (SP) TANGENT
 LT. STA. 102+13.09 TO LT. STA. 102+63.09
 LT. STA. 106+89.04 TO LT. STA. 107+39.04
 RT. STA. 100+26.25 TO RT. STA. 100+76.25
 RT. STA. 106+14.80 TO RT. STA. 106+64.80
 - (B) SPBGR TYPE A
 LT. STA. 102+63.09 TO LT. STA. 103+25.59
 LT. STA. 105+26.54 TO LT. STA. 106+89.04
 RT. STA. 100+76.25 TO RT. STA. 103+38.85
 RT. STA. 105+39.80 TO RT. STA. 106+14.80
 - (E) TBT TYPE 5A
 LT. STA. 103+25.59 TO LT. STA. 103+38.84
 LT. STA. 105+13.29 TO LT. STA. 105+26.54
 RT. STA. 103+38.85 TO RT. STA. 103+52.10
 RT. STA. 105+26.55 TO RT. STA. 105+39.80

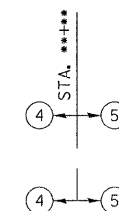

INDICATES PROPOSED TYPICAL SECTION USED

FILE NAME =
 118330-shr-plans.dgn
 PLOT DATE = 1/19/2012
 SCALE: 1" = 50'



EDGAR COUNTY
 HIGHWAY DEPARTMENT

SECTION 8, T.12N., R.10W., 2nd P.M.