

F.A.S.	SECTION	COUNTY	TOTAL SHEETS	SHEET NO.
680	10-00101-00-SP	EDGAR	132	91
EDGAR COUNTY, ILLINOIS		CONTRACT NO. 91467		

FINAL SURVEY	DATE
NO.	
NOTE BOOK	BY
NO.	
TEMP. PLATE	DATE
NO.	
PLOTTED	BY
NO.	
SURVEYED	DATE
NO.	
AREAS CHECKED	

ORIGINAL SURVEY	DATE
NO.	
NOTE BOOK	BY
NO.	
TEMP. PLATE	DATE
NO.	
PLOTTED	BY
NO.	
SURVEYED	DATE
NO.	
AREAS CHECKED	

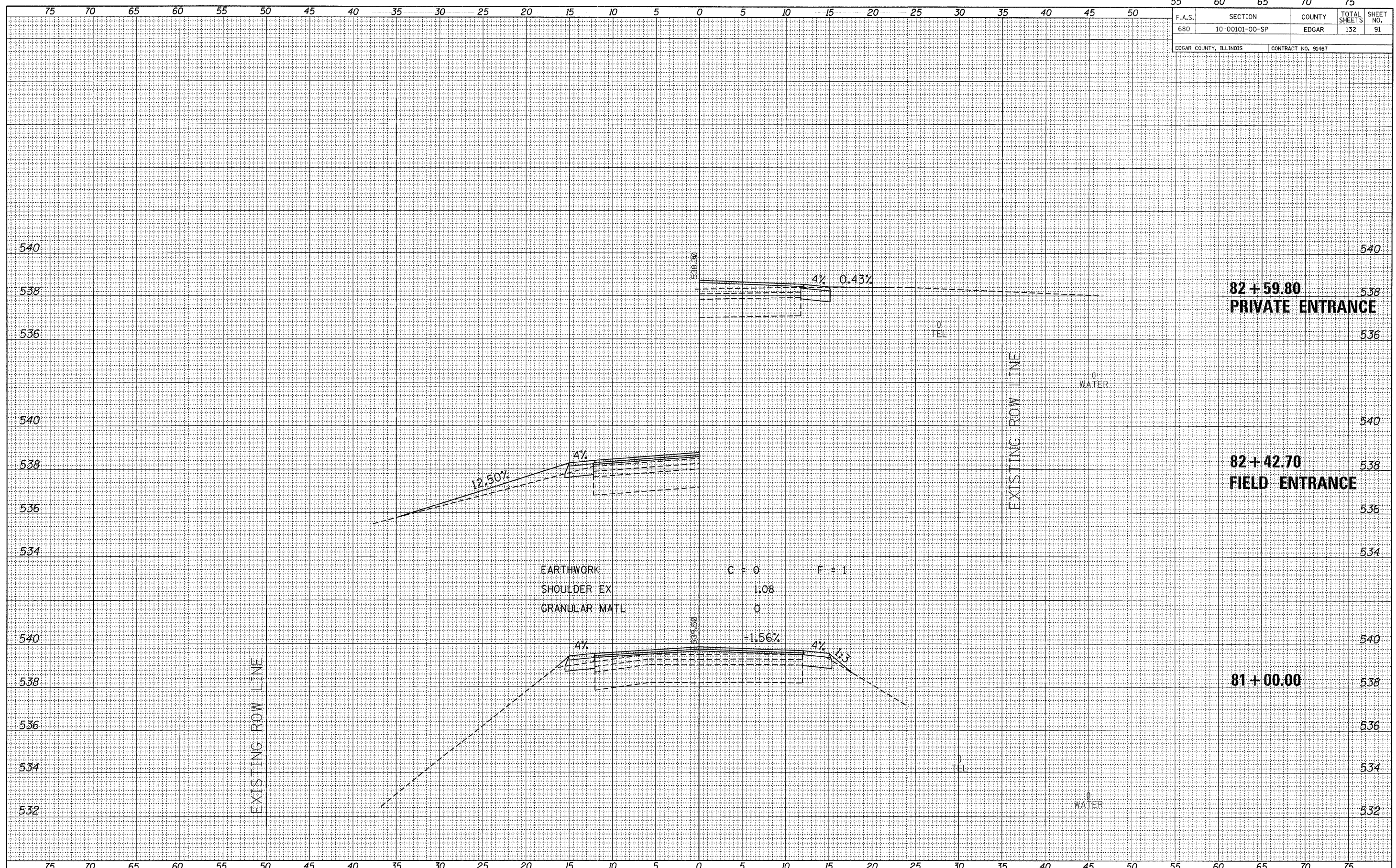

FILE NAME = 118338-ahtr-axs.dgn
 PLOT DATE = 1/19/2012
 SCALE: 1" = 5' HORZ, 1" = 2' VERT

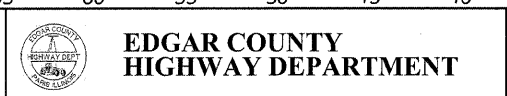

CROSS SECTIONS EAST OF ELBRIDGE
 STATION 81+00 TO STATION 82+59.80