

F.A.S.	SECTION	COUNTY	TOTAL SHEETS	SHEET NO.
680	10-00101-00-SF	EDGAR	132	106
EDGAR COUNTY, ILLINOIS		CONTRACT NO. 91467		

BY	DATE
FINAL SURVEY	SURVEYED
NOTE BOOK	PLOTTED
NO.	TEMPLATE
	AREAS CHECKED

BY	DATE
ORIGINAL SURVEY	SURVEYED
NOTE BOOK	PLOTTED
NO.	TEMPLATE
	AREAS CHECKED

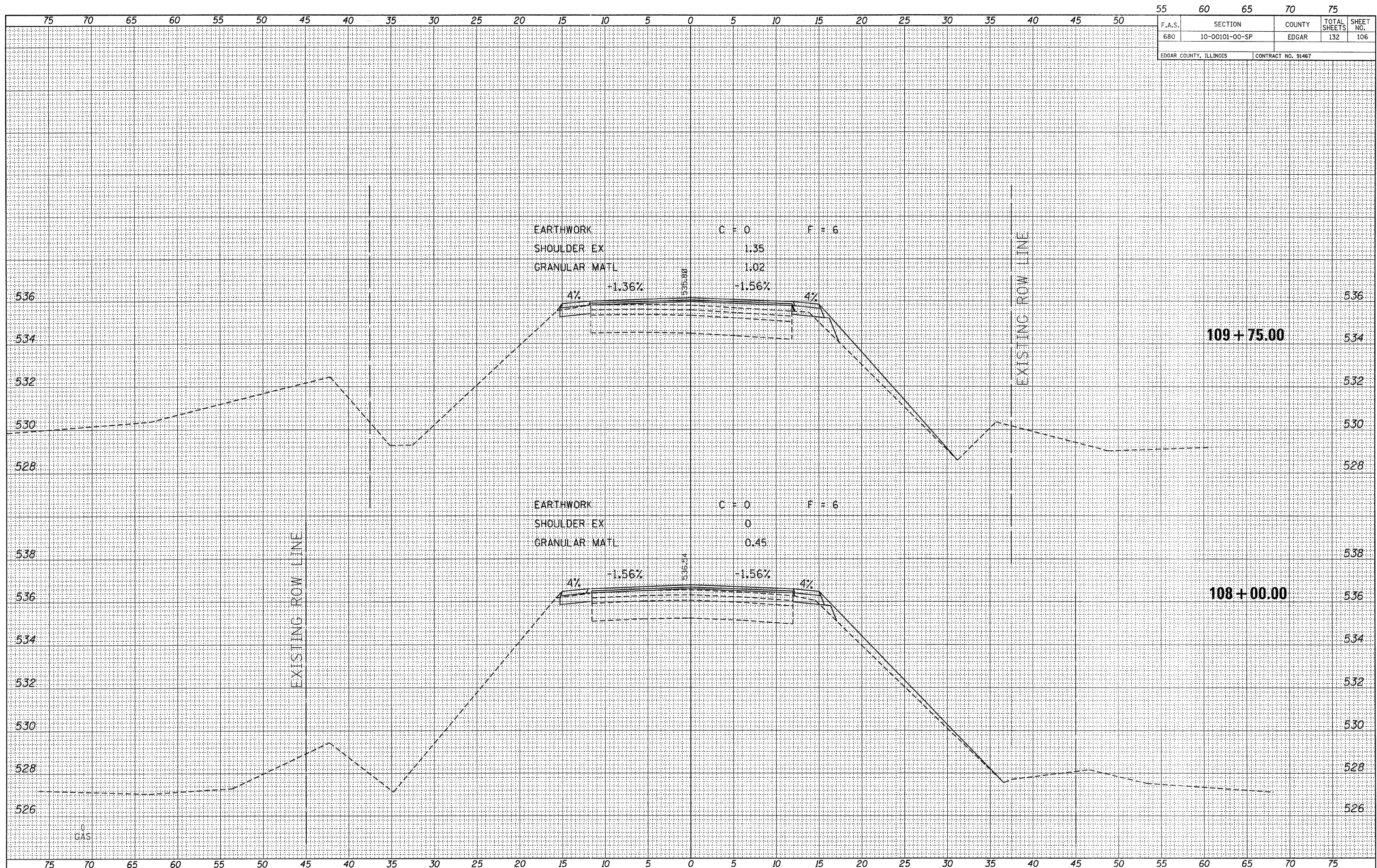

FILE NAME = 110330-sht-sxs.dgn
 PLOT DATE = 1/19/2012
 SCALE: 1" = 5' HORZ, 1" = 2' VERT



**EDGAR COUNTY
 HIGHWAY DEPARTMENT**

CROSS SECTIONS EAST OF ELBRIDGE
 STATION 108+00 TO STATION 109+75