

ROUTE	SECTION	CITY	TOTAL SHEETS	SHEET NO.
F.A.U. 8526	10-00054-00-PV	FLORA	34	15
CONTRACT NO. 95672		ILLINOIS	PROJECT M-5023(011)	

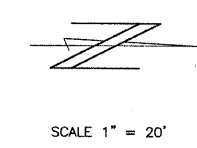

TEMPORARY EROSION CONTROL SEEDING POUND
STA. 1+08.73 TO 18+00 510

TEMPORARY DITCH CHECKS FOOT
STA. 1+08.73 TO 18+00 23

INLET AND PIPE PROTECTION EACH
LT. STA. 1+08.73 TO 18+00 24
RT. STA. 1+08.73 TO 18+00 7
TOTAL 31 EACH

TEMPORARY EROSION CONTROL SEEDING SHALL BE USED AS DIRECTED BY THE ENGINEER THROUGHOUT THE LIFE OF THIS PROJECT

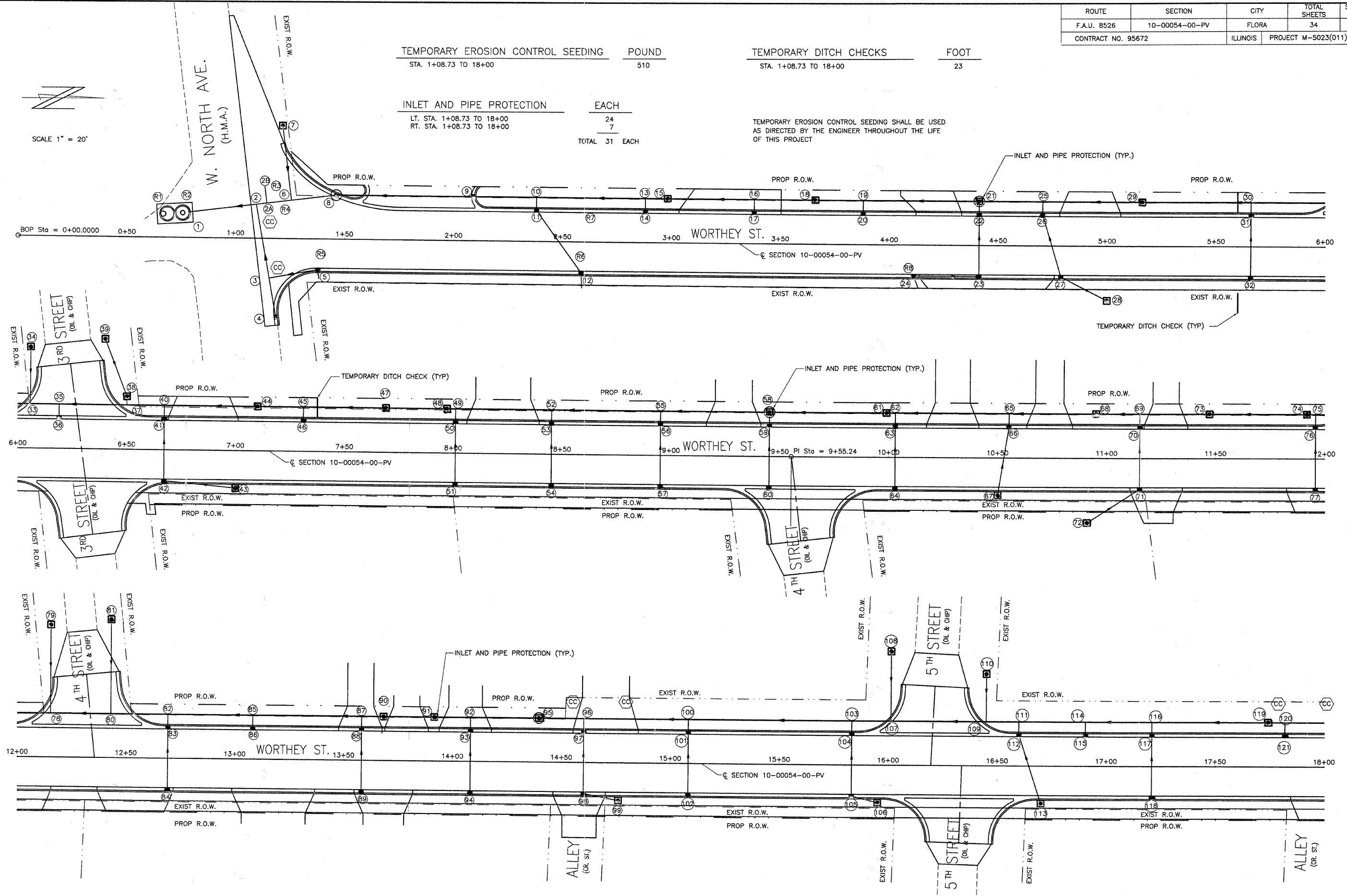

EROSION CONTROL DETAILS