

ROUTE	SECTION	CITY	TOTAL SHEETS	SHEET NO.
F.A.U. 8526	10-00054-00-PV	FLORA	34	16
CONTRACT NO. 95672		ILLINOIS	PROJECT M-5023(011)	

SCALE 1" = 20'

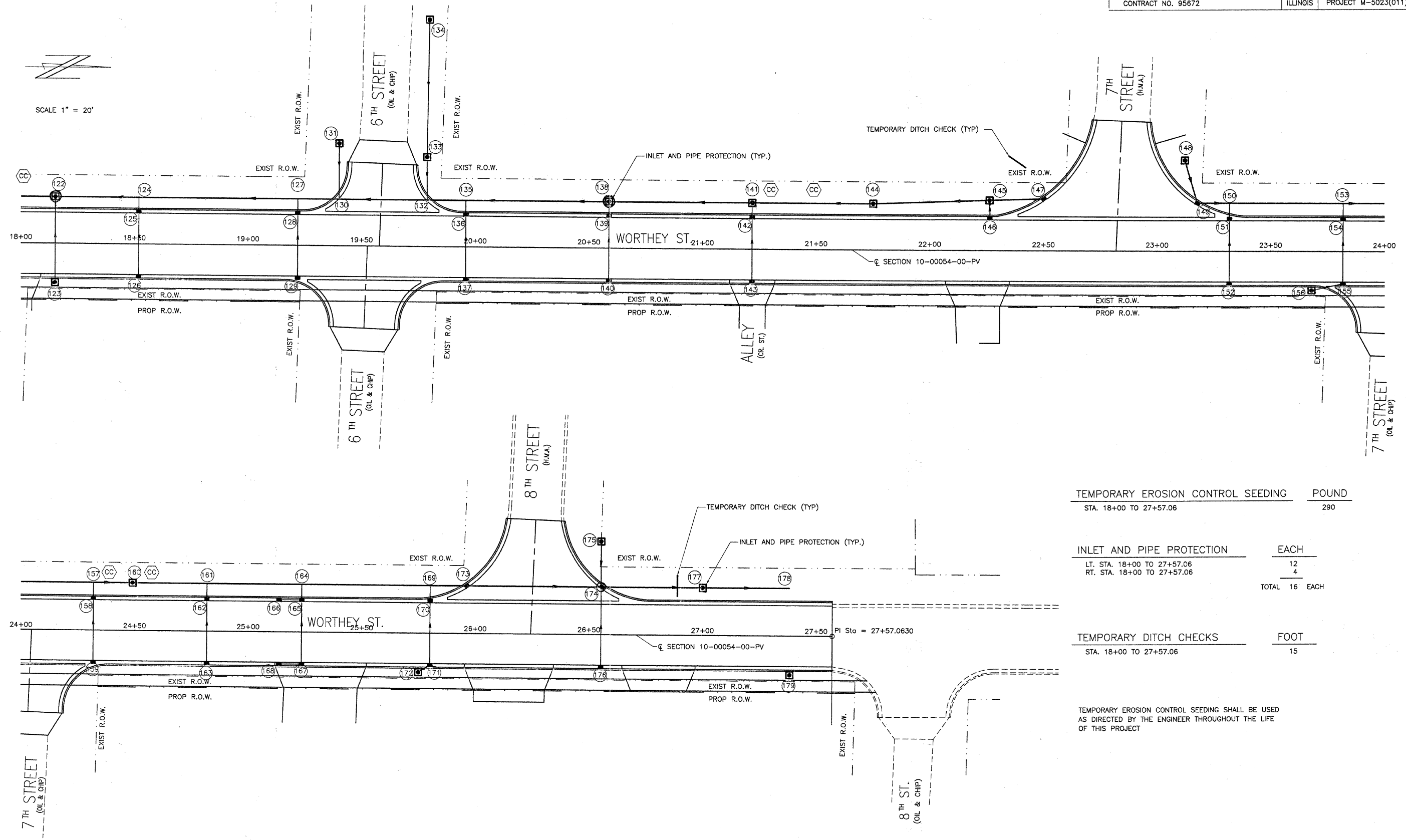

TEMPORARY EROSION CONTROL SEEDING	POUND
STA. 18+00 TO 27+57.06	290
INLET AND PIPE PROTECTION	
LT. STA. 18+00 TO 27+57.06	12
RT. STA. 18+00 TO 27+57.06	4
TOTAL	16 EACH
TEMPORARY DITCH CHECKS	
STA. 18+00 TO 27+57.06	15

TEMPORARY EROSION CONTROL SEEDING SHALL BE USED AS DIRECTED BY THE ENGINEER THROUGHOUT THE LIFE OF THIS PROJECT

EROSION CONTROL DETAILS