

INDEX OF SHEETS

04-27-2018 LETTING ITEM 064

SHEET NO. DESCRIPTION

1. COVER SHEET
2. GENERAL NOTES AND HIGHWAY STANDARDS
- 3.-4. SUMMARY OF QUANTITIES
5. TYPICAL SECTIONS
6. ALIGNMENT
7. SCHEDULES OF QUANTITIES
8. JO DAVIESS COUNTY LOCATION MAP
- 9.-19. JO DAVIESS COUNTY PLAN VIEWS
20. GUARDRAIL DETAILS
21. DELINEATOR AND POST ORIENTATION (DISTRICT STANDARD 37.4)
TYPICAL BENCHING ON EXISTING EMBANKMENT (DISTRICT STANDARD 50.4)
22. TRAFFIC CONTROL TYPICAL WEAVE (DISTRICT STANDARD 39.1)

**STATE OF ILLINOIS
DEPARTMENT OF TRANSPORTATION
DIVISION OF HIGHWAYS**

**PROPOSED
HIGHWAY PLANS**

**FAP ROUTE 301 (US 20)
SECTION (30, 31, 43, 44, 45)J
PROJECT HSIP-FLTI (993)
HSIP-GUARDRAIL END SECTION REPLACEMENT
JO DAVIESS COUNTY**

| F.A.P. RTE. | SECTION | COUNTY | TOTAL SHEETS | SHEET NO. |
|---------------------|-----------------------|--------------------|--------------|-----------|
| 301 | (30, 31, 43, 44, 45)J | JO DAVIESS | 22 | 1 |
| FED. ROAD DIST. NO. | ILLINOIS | CONTRACT NO. 64M33 | | |

D-92-043-17



C-92-003-18

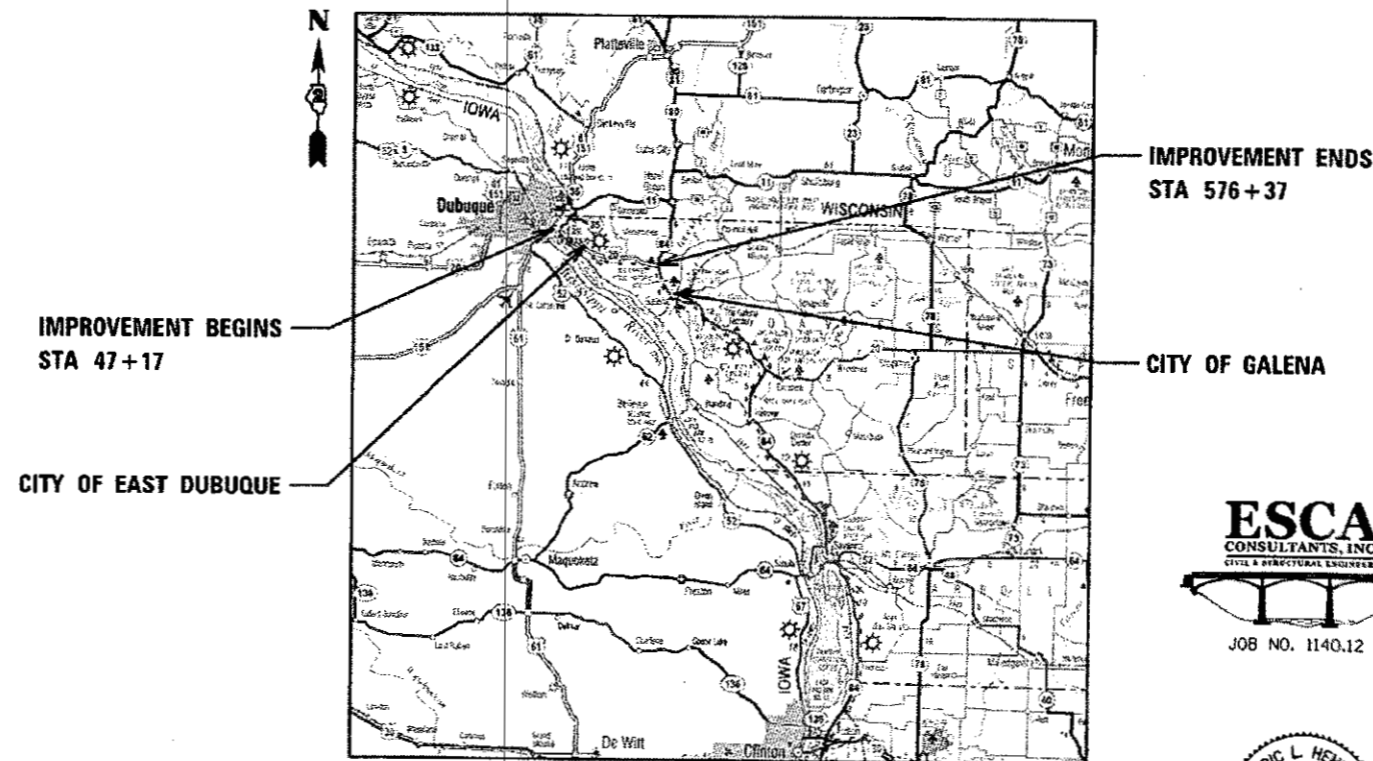

LOCATION MAP

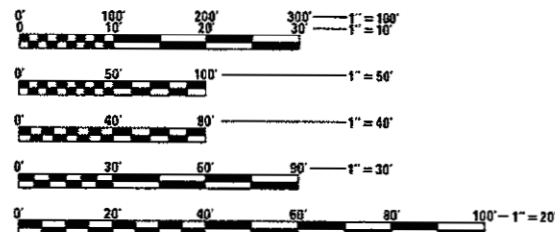

FULL SIZE PLANS HAVE BEEN PREPARED USING STANDARD ENGINEERING SCALES. REDUCED SIZED PLANS WILL NOT CONFORM TO STANDARD SCALES. IN MAKING MEASUREMENTS ON REDUCED PLANS, THE ABOVE SCALES MAY BE USED.

J.U.L.I.E.
JOINT UTILITY LOCATION INFORMATION FOR EXCAVATION
1-800-892-0123
OR 811

PROJECT MANAGER: TRACI DUDEN
815-284-5932
TRACI.DUDEN@ILLINOIS.GOV

PROJECT ENGINEER: STEVE ROBERY
CONSULTANT SERVICES: ERIC HENKEL
217-384-0505
ELH@ESCACONSULTANTS.COM

CONTRACT NO. 64M33
JO DAVIESS COUNTY SECTION (30, 31, 43, 44, 45)J US 20



EXPIRES 11-30-19
Eric Henkel
SIGNATURE
01/08/18
DATE

STATE OF ILLINOIS
DEPARTMENT OF TRANSPORTATION
DIVISION OF HIGHWAYS

SUBMITTED Jun 22 2018
K. Markel
REGION TWO ENGINEER

Mar 23 2018
Steve Robery
ENGINEER OF DESIGN AND ENVIRONMENT

Eric Henkel
DIRECTOR OF HIGHWAYS PROJECT IMPLEMENTATION

**PRINTED BY THE AUTHORITY
OF THE STATE OF ILLINOIS**

GENERAL NOTES

- THE FINAL TOP FOUR INCHES OF SOIL IN ANY RIGHT-OF-WAY AREA DISTURBED BY THE CONTRACTOR MUST BE CAPABLE OF SUPPORTING VEGETATION. THE SOIL MUST BE FROM THE A HORIZON (ZERO TO 2' DEEP) OF SOIL PROFILES OF LOCAL SOILS. THE COST OF THIS WORK SHALL BE INCLUDED IN THE UNIT PRICES BID AND NO ADDITIONAL COMPENSATION WILL BE ALLOWED.
- IT IS ESTIMATED THAT 345 CUBIC YARDS OF EARTH WILL BE HAULED TO THE JOB FROM OUTSIDE THE PROJECT LIMITS. A SHRINKAGE FACTOR OF 25% HAS BEEN USED.
- ALL BORROW/WASTE/USE SITES MUST BE APPROVED BY THE DEPARTMENT PRIOR TO REMOVING ANY MATERIAL FROM THE PROJECT OR INITIATING ANY EARTHMOVING ACTIVITIES, INCLUDING TEMPORARY STOCKPILING OUTSIDE THE LIMITS OF CONSTRUCTION.
- THE CONTRACTOR SHALL SEED ALL DISTURBED AREAS WITHIN THE PROJECT LIMITS. SEEDING CLASS 2A SHALL BE USED. THIS WORK WILL BE INCLUDED IN THE CONTRACT UNIT PRICE PER CUBIC YARD FOR FURNISHED EXCAVATION.
- FERTILIZER SHALL BE APPLIED TO ALL DISTURBED AREAS AND INCORPORATED INTO THE SEEDBED PRIOR TO SEEDING AT THE RATE SPECIFIED IN SECTION 250 OF THE STANDARD SPECIFICATIONS. THIS WORK SHALL BE INCLUDED IN THE COST OF FURNISHED EXCAVATION.
- MULCH METHOD II SHALL BE APPLIED OVER ALL SEEDED AREAS. THIS SHALL BE INCLUDED IN THE COST OF FURNISHED EXCAVATION.
- EMBANKMENT QUANTITIES FOR THE CONSTRUCTION OF THE TRAFFIC BARRIER TERMINALS AS SHOWN IN THE PLANS ARE INCLUDED IN QUANTITIES FOR FURNISHED EXCAVATION. QUANTITIES SHOWN ARE APPROXIMATE. EARTHWORK COMPACTION SHALL BE TO THE SATISFACTION OF THE ENGINEER.
- THE CONTRACTOR SHALL SUPPLY THE RESIDENT ENGINEER WITH THE MANUFACTURER'S INSTALLATION REQUIREMENTS FOR THE TYPE OF STEEL PLATE BEAM GUARDRAIL TERMINAL TYPE 1 SPECIAL (TANGENT) OR STEEL PLATE BEAM GUARDRAIL TERMINAL TYPE 1 SPECIAL (FLARED).
- ONE 16d GALVANIZED NAIL SHALL BE USED TO TOE NAIL THE WOOD BLOCK OUT TO THE WOOD POST ON ALL TRAFFIC BARRIER TERMINAL TYPE 1 SPECIALS.
- THE CONTRACTOR SHALL BE RESPONSIBLE FOR LOCATING AND PROTECTING UTILITY PROPERTY DURING CONSTRUCTION OPERATIONS AS OUTLINED IN ARTICLE 107.39 OF THE STANDARD SPECIFICATIONS. A MINIMUM OF 48 HOURS ADVANCE NOTICE IS REQUIRED FOR NON-EMERGENCY WORK. THE JULIE NUMBER IS 800-892-0123. THE FOLLOWING LISTED UTILITIES LOCATED WITHIN THE PROJECT LIMITS OR IMMEDIATELY ADJACENT TO THE PROJECT CONSTRUCTION LIMITS ARE MEMBERS OF JULIE:

IDOT IS NOT A MEMBER OF JULIE. IF YOU ARE NEAR ANY OVERHEAD LIGHTING, INTERSECTION LIGHTING OR TRAFFIC SIGNALS, CONTACT THE IDOT TRAFFIC OFFICE AT 815-284-5469 AT LEAST 48 HOURS PRIOR TO WORK.
- ALL EXCAVATED MATERIAL, WHICH INCLUDES DIGGING OR GRADING OF ANY SOIL OR FILL MATERIAL, WITH THE EXCEPTION OF AGGREGATE FILLS, MUST BE INCORPORATED WITHIN THE IDOT RIGHT-OF-WAY DUE TO ENVIRONMENTAL DOCUMENTATION REQUIREMENTS.
- GUARDRAIL POSTS THAT NEED TO BE DRIVEN THROUGH THE EXISTING HMA SHOULDER OR CONCRETE SHOULDER SHALL NOT BE PAID FOR SEPARATELY, BUT SHALL BE INCLUDED IN THE COST OF THE STEEL PLATE BEAM GUARDRAIL.
- GUARDRAIL THAT IS REMOVED WILL NOT BE SALVAGED BY THE DISTRICT.
- THE STEEL PLATE BEAM GUARDRAIL QUANTITIES SHOWN ASSUME THAT THE SPLICE LOCATIONS FALL 3'-1/2" SHORT OF THE PAY LIMITS OF TRAFFIC BARRIER TERMINAL TYPE 1, SPECIAL. THEREFORE, AN ADDITIONAL QUARTER PANEL OF STEEL PLATE BEAM GUARDRAIL IS INCLUDED IN THE QUANTITIES AT EACH LOCATION AND IS INCLUDED IN THE LENGTH OF NEED. ADJUSTMENTS OF QUANTITIES AND OF LOCATIONS OF TERMINAL ENDS MAY BE NECESSARY IN THE FIELD AS DIRECTED BY THE ENGINEER.

GENERAL NOTES CONTINUED

- THE STATIONING PROVIDED IN THE PLANS IS FOR THE LOCATION OF THE END POST OF THE EXISTING TRAFFIC BARRIER TERMINALS.
- THE FACE OF PROPOSED GUARDRAIL IS TO BE PLACED AT THE SAME DISTANCE FROM THE TRAVELED WAY AS THE EXISTING GUARDRAIL UNLESS NOTED OTHERWISE.
- GUARDRAIL REMOVAL IS REQUIRED AT ALL PROPOSED GUARDRAIL LOCATIONS. REMOVAL QUANTITIES WILL BE ADJUSTED BY THE ENGINEER TO MATCH FIELD CONDITIONS. SEE THE SCHEDULE FOR THE LENGTHS TO BE REMOVED.
- AGGREGATE WEDGE SHOULDER, TYPE B IS TO BE USED TO RAISE THE ELEVATION OF THE AGGREGATE SHOULDERS TO MATCH THE ADJACENT PAVED SHOULDERS AND TO PROVIDE A SMOOTH SURFACE PRIOR TO INSTALLATION OF GUARDRAIL. IT SHALL BE USED AS DIRECTED BY THE ENGINEER AT ALL NEW OR REPLACED GUARDRAIL LOCATIONS WHERE EXISTING AGGREGATE SHOULDERS ARE PRESENT.
- ADJUST GUARDRAIL POST LOCATIONS TO CLEAR OUTLET PIPES AT BRIDGE APPROACH SLAB DRAINS AND PIPE UNDERDRAINS.
- EXISTING DELINEATORS SHALL BE REMOVED WHERE TRAFFIC BARRIER TERMINALS ARE REMOVED, COST INCLUDED IN GUARDRAIL REMOVAL. A NEW DELINEATOR SHALL BE INSTALLED AT THE END OF EACH NEW TYPE 1 TRAFFIC BARRIER TERMINAL.
- TIE BARS SHALL BE INSTALLED TO TIE PCC APPURTENANCE TO ADJACENT EXISTING CONCRETE PAVEMENT.

TIE THE FOLLOWING TO LENGTH, SIZE, AND THE EXISTING CONCRETE PAVEMENT SPACING OF TIE BARS

CONCRETE CURB, TYPE B STD. 606001 12" LONG NO. 6 @ 24" CENTERS

TIE BARS ARE TO BE INSTALLED IN ACCORDANCE WITH THE APPLICABLE PORTIONS OF ARTICLE 420.05(b) OF THE STANDARD SPECIFICATIONS. SEE HIGHWAY STANDARD 420001 FOR DETAIL ON LONGITUDINAL CONSTRUCTION JOINT GROUTED-IN-PLACE TIE BAR. THE COST OF THE TIE BARS IS INCLUDED IN THE COST OF CONCRETE CURB.
- THERE ARE SEVERAL AREAS THROUGHOUT THE PROJECT WHERE THERE IS EXISTING HMA SHOULDER WHERE CONCRETE CURB IS TO BE PLACED. SAWCUTTING AND REMOVAL OF THE HMA SHOULDER SHALL NOT BE PAID FOR SEPARATELY, BUT SHALL BE INCLUDED IN THE COST OF CONCRETE CURB.
- THE COST TO CONSTRUCT CONCRETE CURB, TYPE B SHALL INCLUDE ANY EXCAVATION, SAWCUTS, PARTIAL REMOVAL OF THE EXISTING CURB, PARTIAL REMOVAL OF THE EXISTING SHOULDER, WIDENING OF THE EXISTING SHOULDER, AND DRILLING AND GROUTING TIE BARS.
- DELINEATORS SHALL BE INSTALLED AS SHOWN IN STANDARD 635001, EXCEPT THAT THE POST SHALL BE ROTATED 180° AND ONLY METAL-BACKED DELINEATORS SHALL BE PERMITTED. DELINEATORS SHALL BE PLACED AT THE ENDS OF APPROACH GUARDRAIL TERMINAL SECTIONS, AND AT EACH HEADWALL OR END SECTION OF AN CULVERTS. THIS WORK WILL BE PAID FOR AT THE CONTRACT UNIT PRICE EACH FOR DELINEATORS.
- CADD DATA WILL BE AVAILABLE TO CONTRACTORS AND CONSULTANTS WORKING ON THIS PROJECT. THIS INFORMATION WILL BE PROVIDED UPON REQUEST AS MICROSTATION CADD FILES AND GEOPAK COORDINATE GEOMETRY FILES ONLY. IF DATA IS REQUIRED IN OTHER FORMATS IT WILL BE YOUR RESPONSIBILITY TO MAKE THESE CONVERSIONS. IF ANY DISCREPANCY OR INCONSISTENCY ARISES BETWEEN THE ELECTRONIC DATA AND THE INFORMATION ON THE HARD COPY, THE INFORMATION ON THE HARD COPY SHOULD BE USED. CONTACT THE DISTRICT'S PROJECT ENGINEER TO REQUEST THESE FILES.
- IT SHALL BE THE CONTRACTOR'S RESPONSIBILITY TO CONTACT THE MUNICIPALITY TO DETERMINE APPROVED METHODS OF UTILITY STRUCTURE ADJUSTMENT. UTILITY STRUCTURES MAY INCLUDE, BUT ARE NOT LIMITED TO, MANHOLES, WATER VALVES, HANDHOLES, ETC. ALL MATERIALS AND WORK NECESSARY TO COMPLETE ADJUSTMENTS PER MUNICIPALITY REQUIREMENTS SHALL BE CONSIDERED INCLUDED IN THE COST OF THE ASSOCIATED ADJUSTMENT PAY ITEM.

HIGHWAY STANDARDS

| | |
|-----------|--|
| 000001-06 | STANDARD SYMBOLS, ABBREVIATIONS AND PATTERNS |
| 001001-02 | AREAS OF REINFORCEMENT BARS |
| 001006 | DECIMAL OF AN INCH AND OF A FOOT |
| 280001-07 | TEMPORARY EROSION CONTROL SYSTEMS |
| 420001-09 | PAVEMENT JOINTS |
| 606001-07 | CONCRETE CURB TYPE B AND COMBINATION CONCRETE CURB AND GUTTER |
| 630001-12 | STEEL PLATE BEAM GUARDRAIL |
| 630106-02 | LONG-SPAN GUARDRAIL OVER CULVERT |
| 630201-07 | PCC/HMA STABILIZATION AT STEEL PLATE BEAM GUARDRAIL |
| 630301-08 | SHOULDER WIDENING FOR TYPE 1 (SPECIAL) GUARDRAIL TERMINALS |
| 631011-10 | TRAFFIC BARRIER TERMINAL, TYPE 2 |
| 631026-06 | TRAFFIC BARRIER TERMINAL, TYPE 5 |
| 631031-15 | TRAFFIC BARRIER TERMINAL, TYPE 6 |
| 635001-02 | DELINEATORS |
| 701101-05 | OFF-ROAD OPERATIONS, MULTILANE, 15' (4.5 m) TO 24" (600 mm) FROM PAVEMENT EDGE |
| 701106-02 | OFF-ROAD OPERATIONS, MULTILANE, MORE THAN 15' (4.5 m) AWAY |
| 701400-09 | APPROACH TO LANE CLOSURE, FREEWAY/EXPRESSWAY |
| 701401-11 | LANE CLOSURE, FREEWAY/EXPRESSWAY |
| 701406-11 | LANE CLOSURE, FREEWAY/EXPRESSWAY, DAY OPERATIONS ONLY |
| 701421-08 | LANE CLOSURE, MULTILANE, DAY OPERATIONS ONLY, FOR SPEEDS ≥ 45 MPH TO 55 MPH |
| 701428-01 | TRAFFIC CONTROL, SETUP AND REMOVAL, FREEWAY/EXPRESSWAY |
| 701901-07 | TRAFFIC CONTROL DEVICES |
| 720011-01 | METAL POSTS FOR SIGNS, MARKERS & DELINEATORS |
| 725001-01 | OBJECT AND TERMINAL MARKERS |
| 728001-01 | TELESCOPING STEEL SIGN SUPPORT |
| 729001-01 | APPLICATIONS OF TYPES A&B METAL POSTS (FOR SIGNS & MARKERS) |
| 782006 | GUARDRAIL AND BARRIER WALL REFLECTOR MOUNTING DETAILS |

PRINTED BY: ESCA CONSULTANTS, INC.
 DATE: 01/18/18
 TIME: 3:38:06 PM



| | | |
|---------------------------------|-------------------|-----------|
| USER NAME = k.jk | DESIGNED - KJK | REVISED - |
| ESCA PROJECT NO. 1148J2 | DRAWN - KJK | REVISED - |
| PLOT SCALE = 8.1667' / 1" = | CHECKED - SKM/ELH | REVISED - |
| PLOT DATE = 1/8/2018 3:38:06 PM | DATE - 01/18 | REVISED - |

**STATE OF ILLINOIS
DEPARTMENT OF TRANSPORTATION**

GENERAL NOTES AND HIGHWAY STANDARDS

SCALE: NA SHEET NO. 1 OF 1 SHEETS STA. TO STA.

| F.A.P. RTE. | SECTION | COUNTY | TOTAL SHEETS | SHEET NO. |
|---|-----------------------|------------|--------------|-----------|
| 301 | (30, 31, 43, 44, 45)J | JD DAVIESS | 22 | 2 |
| CONTRACT NO. 64M33 | | | | |
| FED. ROAD DIST. NO. [ILLINOIS] FED. AID PROJECT | | | | |

| SUMMARY OF QUANTITIES | | | | | 90% FEDERAL 10% STATE ROADWAY CONST. CODE 0021 JO DAVIESS COUNTY |
|-----------------------|--|-------|----------------|--|---|
| CODE NO. | ITEM | UNIT | TOTAL QUANTITY | | |
| 20400800 | FURNISHED EXCAVATION | CU YD | 345 | | 345 |
| 28000400 | PERIMETER EROSION BARRIER | FOOT | 960 | | 960 |
| 48102100 | AGGREGATE WEDGE SHOULDER, TYPE B | TON | 266 | | 266 |
| 60600605 | CONCRETE CURB, TYPE B | FOOT | 10 | | 10 |
| 63000003 | STEEL PLATE BEAM GUARDRAIL, TYPE A, 9 FOOT POSTS | FOOT | 10272 | | 10272 |
| 63000350 | LONG-SPAN GUARDRAIL OVER CULVERT, 12 FT 6 IN SPAN | FOOT | 75 | | 75 |
| 63100045 | TRAFFIC BARRIER TERMINAL, TYPE 2 | EACH | 15 | | 15 |
| 63100070 | TRAFFIC BARRIER TERMINAL, TYPE 5 | EACH | 1 | | 1 |
| 63100085 | TRAFFIC BARRIER TERMINAL, TYPE 6 | EACH | 2 | | 2 |
| 63100167 | TRAFFIC BARRIER TERMINAL, TYPE 1 (SPECIAL) TANGENT | EACH | 13 | | 13 |
| 63100169 | TRAFFIC BARRIER TERMINAL, TYPE 1 (SPECIAL) FLARED | EACH | 3 | | 3 |
| 63200310 | GUARDRAIL REMOVAL | FOOT | 10967 | | 10967 |
| 63500105 | DELINEATORS | EACH | 16 | | 16 |
| 67100100 | MOBILIZATION | LSUM | 1 | | 1 |

14

PRINTED AT THE ESCA OFFICE
 1100 S. WASHINGTON ST.
 CHICAGO, ILL. 60607-4000



| | | |
|----------------------------------|-------------------|-----------|
| USER NAME = kjk | DESIGNED - KJK | REVISED - |
| ESCA PROJECT NO. 1148.12 | DRAWN - KJK | REVISED - |
| PLOT SCALE = 0.1667" = 1' | CHECKED - SKM/ELH | REVISED - |
| PLOT DATE = 8/31/2007 4:25:27 PM | DATE - 08/17 | REVISED - |

STATE OF ILLINOIS
DEPARTMENT OF TRANSPORTATION

SUMMARY OF QUANTITIES

SCALE: NA SHEET NO. 1 OF 2 SHEETS STA. TO STA.

| F.A.P. RTE. | SECTION | COUNTY | TOTAL SHEETS | SHEET NO. |
|--------------------|-----------------------|------------|---|-----------|
| 301 | (30, 31, 43, 44, 45)J | JD DAVIESS | 22 | 3 |
| CONTRACT NO. 64M33 | | | FED. ROAD DIST. NO. ILLINOIS FED. AID PROJECT | |

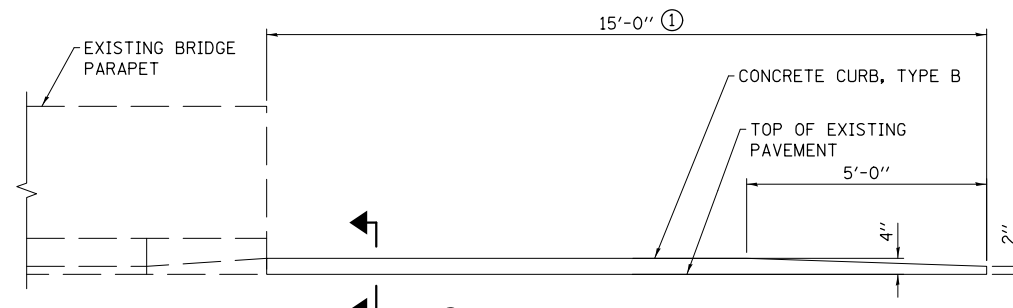

① AT EXISTING CURB LOCATIONS WHERE THE LENGTH IS LESS THAN 15', REMOVE EXISTING TAPERED END AND CONSTRUCT NEW CURB TO REACH THE 15' TOTAL LENGTH. PARTIAL REMOVAL OF EXISTING CURB IS INCLUDED IN CONCRETE CURB, TYPE B.

INSIDE ELEVATION OF PARAPET AND CURB

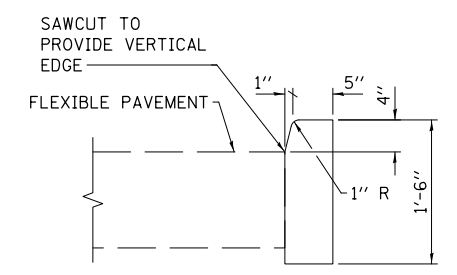

SECTION AT FLEXIBLE PAVEMENT

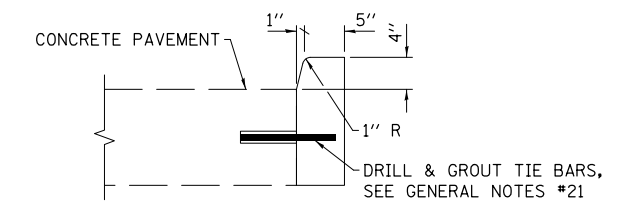

SECTION AT CONCRETE PAVEMENT

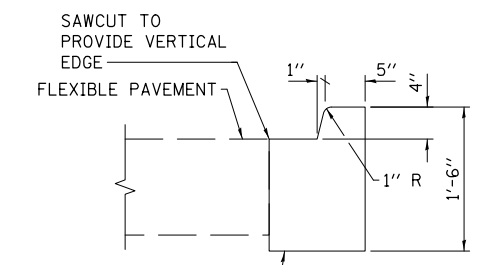

SECTION AT WIDENING AT FLEXIBLE PAVEMENT

CONCRETE CURB, TYPE B

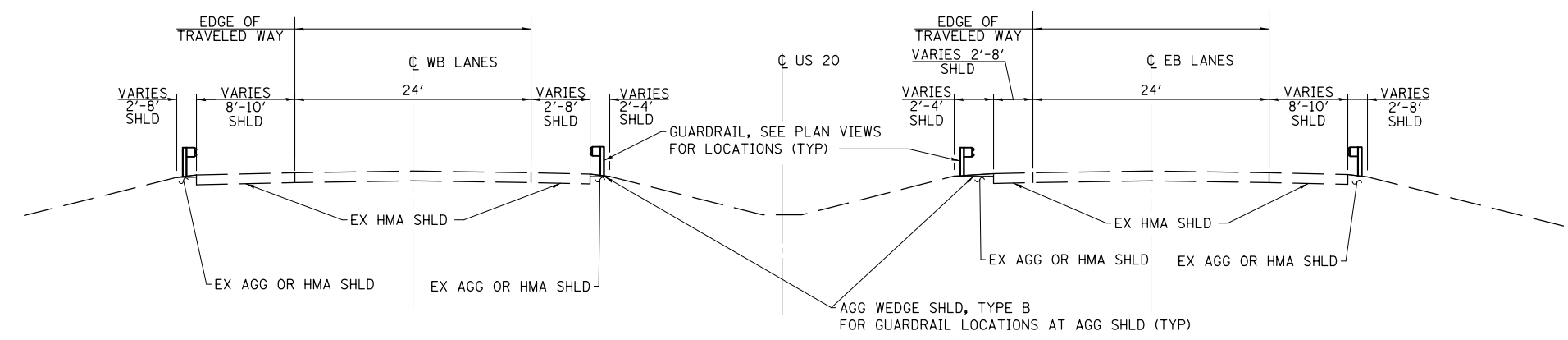

ROADWAY TYPICAL SECTION

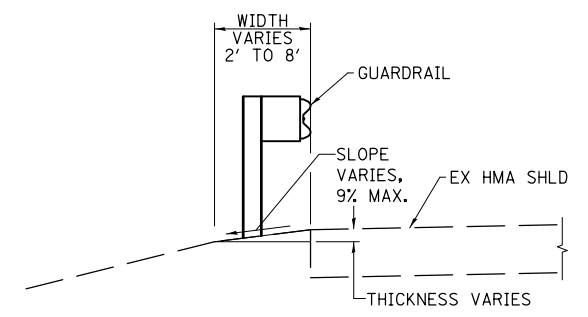

SECTION AT AGGREGATE WEDGE SHOULDER

PRINT DRIVER = L:\E-Books\1079
 USER NAME = PJL
 PLOT DATE = 8/31/2017 4:25:30 PM



| | | |
|----------------------------------|-------------------|-----------|
| USER NAME = kjk | DESIGNED - KJK | REVISED - |
| ESCA PROJECT NO. 1140.12 | DRAWN - KJK | REVISED - |
| PLOT SCALE = 0.1667' / 1" | CHECKED - SKM/ELH | REVISED - |
| PLOT DATE = 8/31/2017 4:25:30 PM | DATE - 05/17 | REVISED - |

**STATE OF ILLINOIS
DEPARTMENT OF TRANSPORTATION**

TYPICAL SECTIONS

SCALE: NONE SHEET NO. 1 OF 1 SHEETS STA. TO STA.

| F.A.P. RTE. | SECTION | COUNTY | TOTAL SHEETS | SHEET NO. |
|---|-----------------------|------------|--------------|-----------|
| 301 | (30, 31, 43, 44, 45)J | JO DAVIESS | 22 | 5 |
| CONTRACT NO. 6M33 | | | | |
| FED. ROAD DIST. NO. ILLINOIS FED. AID PROJECT | | | | |

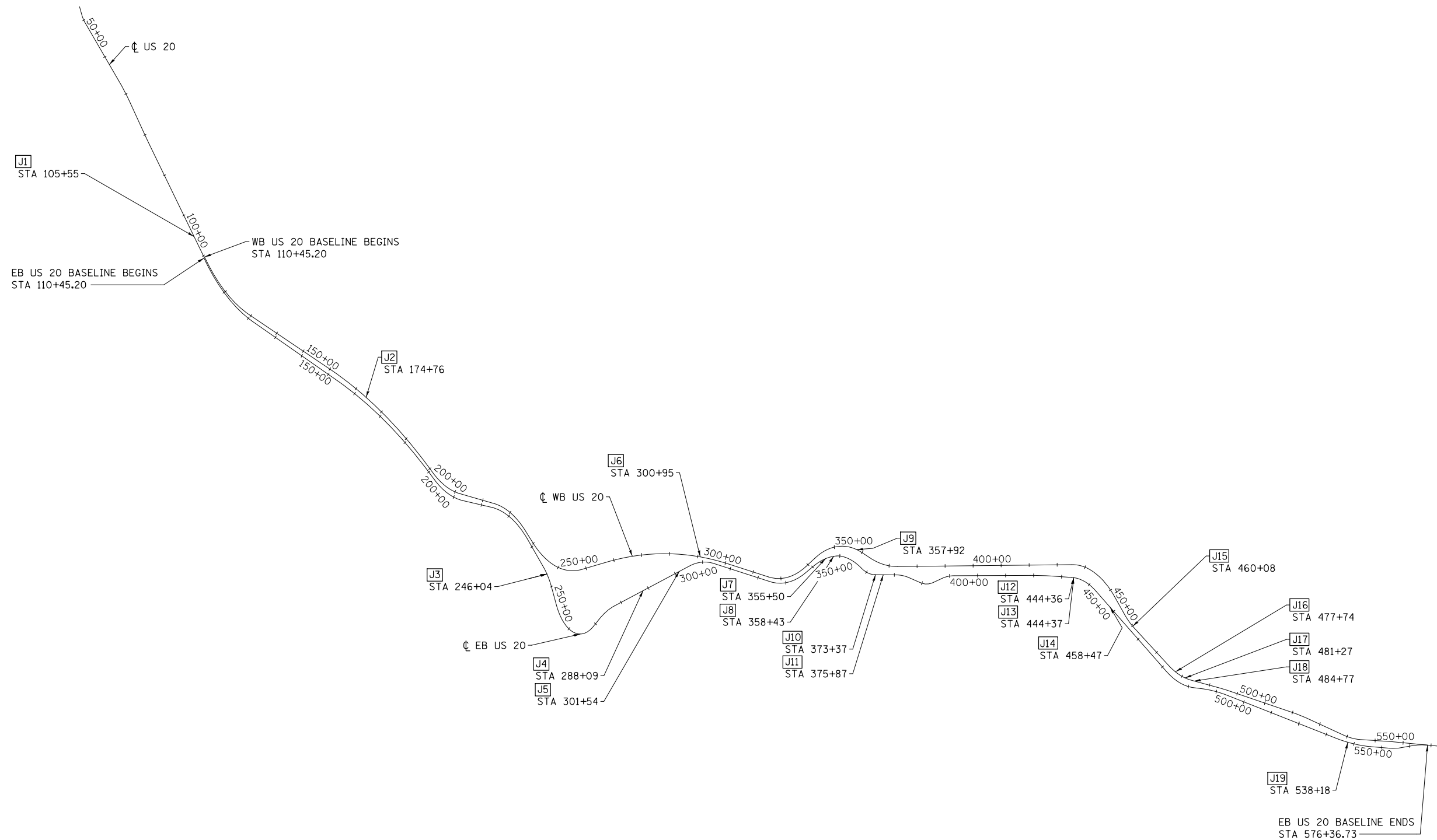

ALIGNMENT PLAN

PRINT DRIVER = L:\0-EB\Bates\9
 SCALE = 1" = 100'
 PLOT DATE = 8/31/2017 4:25:32 PM



| | | |
|----------------------------------|-------------------|-----------|
| USER NAME = kjk | DESIGNED - KJK | REVISED - |
| ESCA PROJECT NO. 1140.12 | DRAWN - KJK | REVISED - |
| PLOT SCALE = 0.1667' / in. | CHECKED - SKM/ELH | REVISED - |
| PLOT DATE = 8/31/2017 4:25:32 PM | DATE - 05/17 | REVISED - |

**STATE OF ILLINOIS
 DEPARTMENT OF TRANSPORTATION**

| | |
|------------------|-------------------------|
| ALIGNMENT | |
| SCALE: NONE | SHEET NO. 1 OF 1 SHEETS |
| STA. 47+17 | TO STA. 574+08 |

| F.A.P. RTE. | SECTION | COUNTY | TOTAL SHEETS | SHEET NO. |
|---|-----------------------|------------|--------------|-----------|
| 301 | (30, 31, 43, 44, 45)J | JO DAVIESS | 22 | 6 |
| CONTRACT NO. 64M33 | | | | |
| FED. ROAD DIST. NO. ILLINOIS FED. AID PROJECT | | | | |

JO DAVIESS COUNTY PROPOSED GUARDRAIL

| MAP LOCATION | EXISTING END POST STATION | STRUCTURE NUMBER / LOCATION | DIRECTION | LANE | 63000003 | 63000350 | 63100045 | 63100070 | 63100085 | 63100167 | 63100169 | 63500105 | 72501000 | 78200005 | NOTES |
|---------------------------------|---------------------------|-------------------------------|-----------|---------|-----------------|------------------------|-----------|-----------|-----------|---------------------|-----------------------|-------------|-----------------|---------------------|------------------------------|
| | | | | | SPBGR, TY A, 9' | LONG-SPAN GRAIL, 12.5' | TBT, TY 2 | TBT, TY 5 | TBT, TY 6 | TBT, TY 1 (SPL) TAN | TBT, TY 1 (SPL) FLARE | DELINEATORS | TERMINAL MARKER | GUARDRAIL REF, TY A | |
| | | | | | FOOT | FOOT | EACH | EACH | EACH | EACH | EACH | EACH | EACH | EACH | |
| J1 | 105+55 | SN 043-1076 | WB | DRIVING | | | | | | | | | | | REATTACH WEST TERMINAL CABLE |
| J2 | 174+76 | E DUBUQUE WATER TOWER | WB | DRIVING | 79 | | 1 | | | | 1 | 1 | 1 | 4 | |
| J3 | 246+04 | 17602 US 20 | WB | DRIVING | 1179 | | 1 | | | 1 | 1 | 1 | 1 | 8 | |
| J4 | 288+09 | 16701 US 20 | EB | PASSING | 141 | | 1 | | | 1 | 1 | 1 | 1 | 4 | |
| J5 | 301+54 | SANDRIDGE ROAD | EB | PASSING | 366 | | 1 | | | 1 | 1 | 1 | 1 | 6 | |
| J6 | 300+95 | N. MAIN STREET | WB | DRIVING | 816 | | 1 | | | 1 | 1 | 1 | 1 | 7 | |
| J7 | 355+50 | ROCKY & IMBUS RD INTERSECTION | EB | PASSING | 954 | | 1 | | | 1 | 1 | 1 | 1 | 7 | |
| J8 | 358+43 | ROCKY & IMBUS RD INTERSECTION | EB | DRIVING | 241 | | 1 | | | 1 | 1 | 1 | 1 | 4 | |
| J9 | 357+92 | ROCKY & IMBUS RD INTERSECTION | WB | DRIVING | 1791 | | 1 | | | 1 | 1 | 1 | 1 | 9 | |
| J10 | 373+37 | 15475 US 20 | EB | DRIVING | 466 | 75 | | | | 1 | 1 | 1 | 1 | 6 | COMBINE WITH LOC J11 |
| J11 | 375+87 | 15475 US 20 | EB | DRIVING | | | 1 | | | | | | | | COMBINE WITH LOC J10 |
| J12 | 444+36 | N MENOMINEE ROAD | EB | DRIVING | 116 | | 1 | | | 1 | 1 | 1 | 1 | 4 | |
| J13 | 444+37 | N MENOMINEE ROAD | EB | PASSING | 766 | | 1 | | | 1 | 1 | 1 | 1 | 7 | |
| J14 | 458+47 | EVERGREEN LANE | EB | PASSING | 1254 | | 1 | | | 1 | 1 | 1 | 1 | 8 | |
| J15 | 460+08 | EVERGREEN LANE | WB | PASSING | 254 | | 1 | | | 1 | 1 | 1 | 1 | 4 | EXISTING HMA STABILIZATION |
| J16 | 477+74 | SN 043-0047 | WB | PASSING | 113 | | 1 | 1 | | | | | | 4 | EXISTING HMA STABILIZATION |
| J17 | 481+27 | SN 043-0047 | WB | PASSING | 129 | | | | 1 | | 1 | 1 | 1 | 4 | EXISTING HMA STABILIZATION |
| J18 | 484+77 | SN 043-0047 | WB | DRIVING | 141 | | | | 1 | | 1 | 1 | 1 | 4 | EXISTING HMA STABILIZATION |
| J19 | 538+18 | 12242 US 20 | EB | DRIVING | 1466 | | 1 | | | 1 | 1 | 1 | 1 | 8 | |
| JO DAVIESS COUNTY TOTALS | | | | | 10272 | 75 | 15 | 1 | 2 | 13 | 3 | 16 | 16 | 98 | |

JO DAVIESS COUNTY OTHER ITEMS

| MAP LOCATION | EXISTING END POST STATION | STRUCTURE NUMBER / LOCATION | DIRECTION | LANE | 20400800 | 28000400 | 48102100 | 60600605 | 63200310 | Z0052410 | NOTES |
|---------------------------------|---------------------------|-------------------------------|-----------|---------|----------------------|---------------------------|----------------------|----------------|-------------------|---------------------------|------------------------------|
| | | | | | FURNISHED EXCAVATION | PERIMETER EROSION BARRIER | AGG WEDGE SHLD, TY B | CONC CURB TY B | GUARDRAIL REMOVAL | REPAIR TBT TY 1 (SPL) TAN | |
| | | | | | CU YD | FOOT | TON | FOOT | FOOT | EACH | |
| J1 | 105+55 | SN 043-1076 | WB | DRIVING | | | | | | 1 | REATTACH WEST TERMINAL CABLE |
| J2 | 174+76 | E DUBUQUE WATER TOWER | WB | DRIVING | 50 | 60 | 6 | | 106 | | |
| J3 | 246+04 | 17602 US 20 | WB | DRIVING | 15 | 60 | 24 | | 1229 | | |
| J4 | 288+09 | 16701 US 20 | EB | PASSING | 15 | 60 | 14 | | 200 | | |
| J5 | 301+54 | SANDRIDGE ROAD | EB | PASSING | 15 | 60 | 9 | | 263 | | |
| J6 | 300+95 | N. MAIN STREET | WB | DRIVING | 15 | 60 | 17 | | 875 | | |
| J7 | 355+50 | ROCKY & IMBUS RD INTERSECTION | EB | PASSING | 15 | 60 | 39 | | 1012 | | |
| J8 | 358+43 | ROCKY & IMBUS RD INTERSECTION | EB | DRIVING | 15 | 60 | 15 | | 300 | | |
| J9 | 357+92 | ROCKY & IMBUS RD INTERSECTION | WB | DRIVING | 15 | 60 | 35 | | 1847 | | |
| J10 | 373+37 | 15475 US 20 | EB | DRIVING | 15 | 60 | 12 | | 163 | | COMBINE WITH LOC J11 |
| J11 | 375+87 | 15475 US 20 | EB | DRIVING | | | | | 337 | | COMBINE WITH LOC J10 |
| J12 | 444+36 | N MENOMINEE ROAD | EB | DRIVING | 15 | 60 | 4 | | 150 | | |
| J13 | 444+37 | N MENOMINEE ROAD | EB | PASSING | 15 | 60 | 24 | | 825 | | |
| J14 | 458+47 | EVERGREEN LANE | EB | PASSING | 15 | 60 | 38 | | 1312 | | |
| J15 | 460+08 | EVERGREEN LANE | WB | PASSING | 15 | 60 | | | 312 | | EXISTING HMA STABILIZATION |
| J16 | 477+74 | SN 043-0047 | WB | PASSING | | | | | 136 | | EXISTING HMA STABILIZATION |
| J17 | 481+27 | SN 043-0047 | WB | PASSING | 50 | 60 | | 6 | 151 | | EXISTING HMA STABILIZATION |
| J18 | 484+77 | SN 043-0047 | WB | DRIVING | 50 | 60 | | 4 | 226 | | EXISTING HMA STABILIZATION |
| J19 | 538+18 | 12242 US 20 | EB | DRIVING | 15 | 60 | 29 | | 1523 | | |
| JO DAVIESS COUNTY TOTALS | | | | | 345 | 960 | 266 | 10 | 10967 | 1 | |

PRINT DRIVER = L:\ESCA\Projects\64M33\JO DAVIESS COUNTY GUARDRAIL.dwg
 PLOT DATE = 1/22/2018 11:54:49 PM
 PLOT SCALE = 0.1667' / 1"



| | | |
|-----------------------------------|-------------------|-----------|
| USER NAME = kjk | DESIGNED - KJK | REVISED - |
| ESCA PROJECT NO. 1140.12 | DRAWN - KJK | REVISED - |
| PLOT SCALE = 0.1667' / 1" | CHECKED - SKM/ELH | REVISED - |
| PLOT DATE = 1/22/2018 11:54:49 PM | DATE - 01/18 | REVISED - |

**STATE OF ILLINOIS
DEPARTMENT OF TRANSPORTATION**

SCHEDULES OF QUANTITIES

SCALE: NA SHEET NO. 1 OF 1 SHEETS STA. TO STA.

| F.A.P. RTE. | SECTION | COUNTY | TOTAL SHEETS | SHEET NO. |
|---|-----------------------|------------|--------------------|-----------|
| 301 | (30, 31, 43, 44, 45)J | JO DAVIESS | 22 | 7 |
| FED. ROAD DIST. NO. ILLINOIS FED. AID PROJECT | | | CONTRACT NO. 64M33 | |

LOCATION MAP

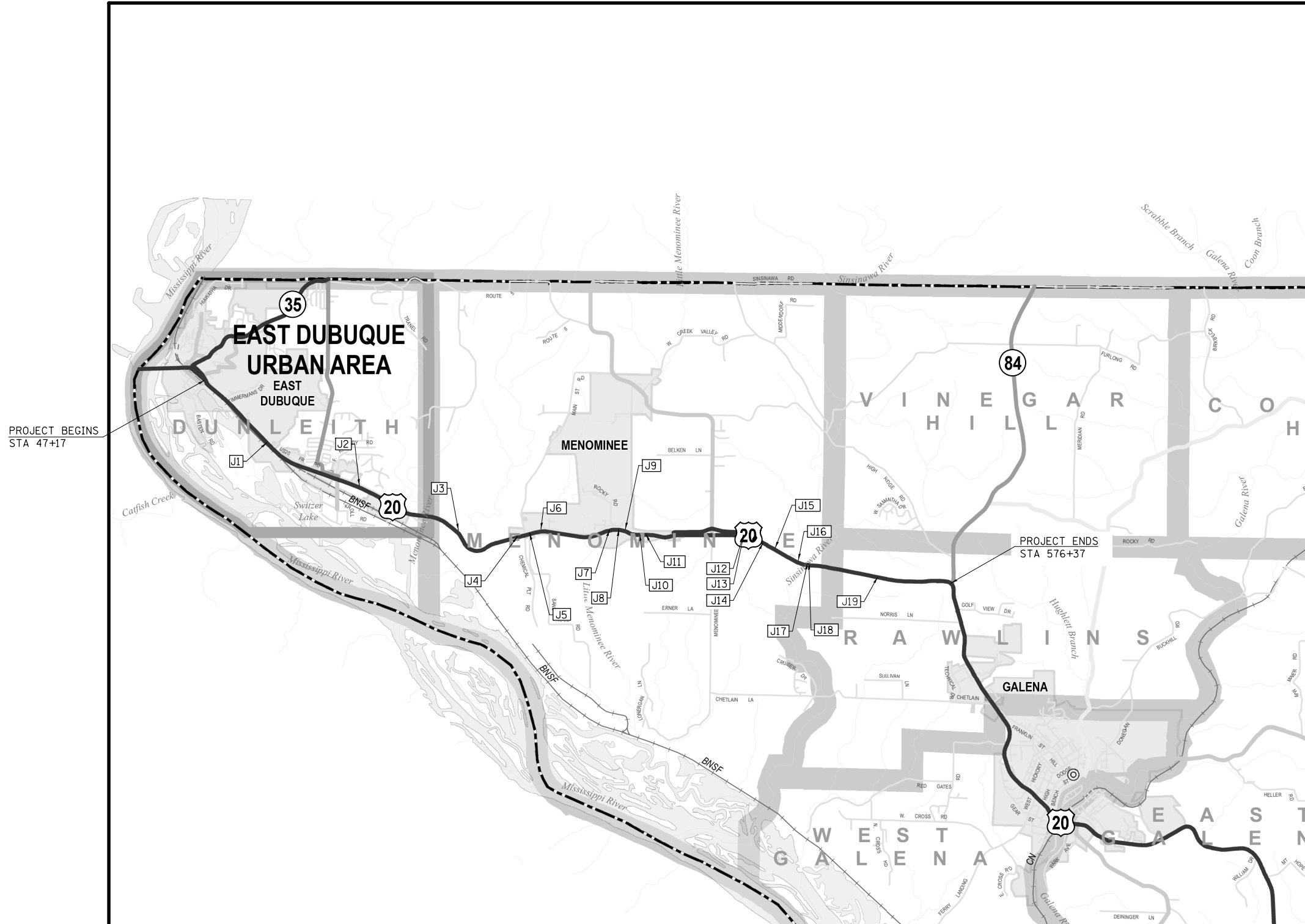

JO DAVIESS COUNTY

STATE OF ILLINOIS
DEPARTMENT OF TRANSPORTATION

JO DAVIESS COUNTY
LOCATION MAP

SCALE: NONE SHEET NO. 1 OF 1 SHEETS STA. TO STA.

| F.A.P. RTE. | SECTION | COUNTY | TOTAL SHEETS | SHEET NO. |
|---|-----------------------|------------|--------------|-----------|
| 301 | (30, 31, 43, 44, 45)J | JO DAVIESS | 22 | 8 |
| CONTRACT NO. 64M33 | | | | |
| FED. ROAD DIST. NO. ILLINOIS FED. AID PROJECT | | | | |

PRINT DRIVER = L:\E\B\B\1719
 PLOT DATE = 8/31/2017 4:25:44 PM
 SCALE NAME = 0.1667 / 1" = 100'
 FILE NAME = 20170831_1719.dwg



| | | |
|----------------------------------|-------------------|-----------|
| USER NAME = kjk | DESIGNED - KJK | REVISED - |
| ESCA PROJECT NO. 1140.12 | DRAWN - KJK | REVISED - |
| PLOT SCALE = 0.1667 / 1" = 100' | CHECKED - SKM/ELH | REVISED - |
| PLOT DATE = 8/31/2017 4:25:44 PM | DATE - 08/17 | REVISED - |



LOCATION 1
WEST OF CAMILLUS DRIVE

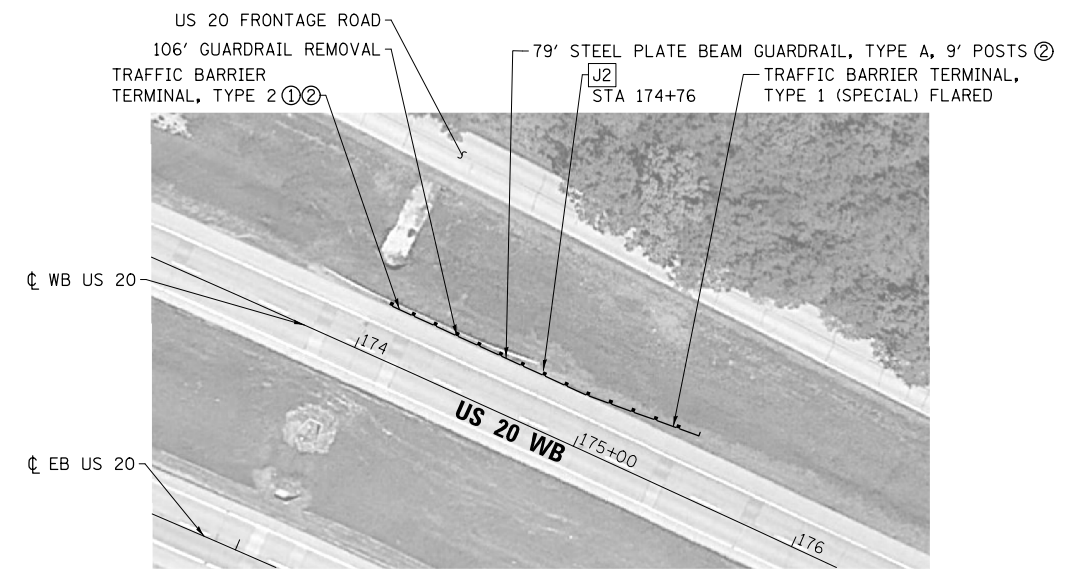

LOCATION 2
NEAR EAST DUBUQUE WATER TOWER

- ① LOCATE END POST AT APPROACH END OF HEADWALL
- ② LOCATE FACE OF RAIL 10.1' FROM EDGE OF TRAVELED WAY

PRINT DRIVER = L:\05-EB\Bates\9
 SCALE NAME = PLOT
 FILE NAME = 20170831.usd\17482.dwg



| | | |
|----------------------------------|-------------------|-----------|
| USER NAME = kjk | DESIGNED - KJK | REVISED - |
| ESCA PROJECT NO. 1140.12 | DRAWN - KJK | REVISED - |
| PLOT SCALE = 0.1667' / 1" = | CHECKED - SKM/ELH | REVISED - |
| PLOT DATE = 8/31/2017 4:26:18 PM | DATE - 08/17 | REVISED - |

STATE OF ILLINOIS
DEPARTMENT OF TRANSPORTATION

JO DAVIESS COUNTY PLAN VIEWS

SCALE: NONE SHEET NO. 1 OF 11 SHEETS STA. TO STA.

| F.A.P. RTE. | SECTION | COUNTY | TOTAL SHEETS | SHEET NO. |
|---|-----------------------|------------|--------------------|-----------|
| 301 | (30, 31, 43, 44, 45)J | JO DAVIESS | 22 | 9 |
| FED. ROAD DIST. NO. ILLINOIS FED. AID PROJECT | | | CONTRACT NO. 64M33 | |



**LOCATION 3
NEAR 17602 US 20**

① SET END POST NEAR SAME
LOCATION AS EXISTING

PRINT DRIVER = L:\E-Books\17602 US 20
 SCALE NAME = PLOT
 FILE NAME = 17602 US 20.dwg



| | | |
|----------------------------------|-------------------|-----------|
| USER NAME = kjk | DESIGNED - KJK | REVISED - |
| ESCA PROJECT NO. 1140.12 | DRAWN - KJK | REVISED - |
| PLOT SCALE = 0.1667' / 1" = | CHECKED - SKM/ELH | REVISED - |
| PLOT DATE = 8/31/2017 4:26:27 PM | DATE - 05/17 | REVISED - |

**STATE OF ILLINOIS
DEPARTMENT OF TRANSPORTATION**

JO DAVIESS COUNTY PLAN VIEWS

SCALE: NONE SHEET NO. 2 OF 11 SHEETS STA. TO STA.

| F.A.P. RTE. | SECTION | COUNTY | TOTAL SHEETS | SHEET NO. |
|--|-----------------------|------------|--------------|-----------|
| 301 | (30, 31, 43, 44, 45)J | JO DAVIESS | 22 | 10 |
| CONTRACT NO. 64M33 | | | | |
| FED. ROAD DIST. NO. ILLINOIS FED. AID PROJECT | | | | |

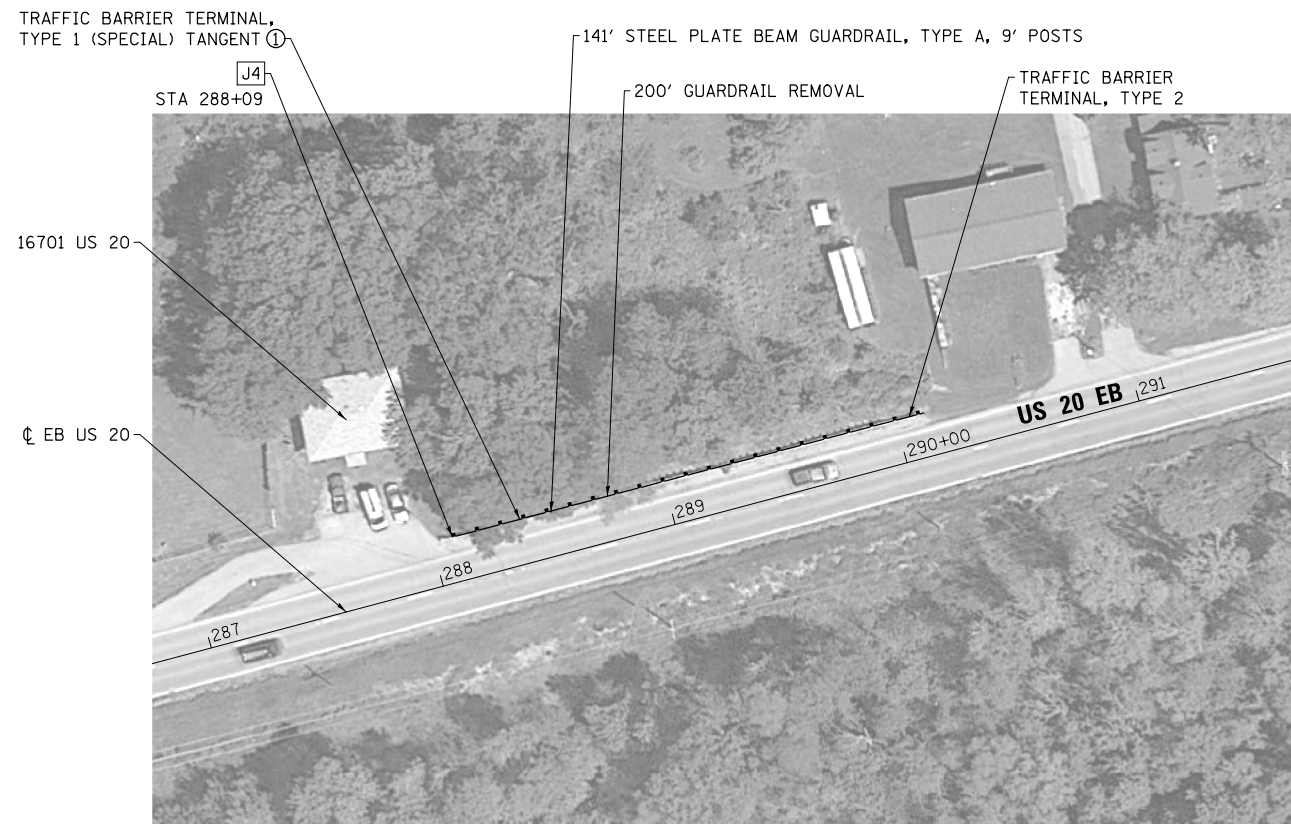

LOCATION 4
NEAR 16701 US 20

① LOCATE END OF TERMINAL TO MATCH EXISTING

PRINT DRIVER = L:\E-Books\16701 US 20
 SCALE NAME = PLOT
 FILE NAME = 16701 US 20.dwg



| | | |
|----------------------------------|-------------------|-----------|
| USER NAME = kjk | DESIGNED - KJK | REVISED - |
| ESCA PROJECT NO. 1140.12 | DRAWN - KJK | REVISED - |
| PLOT SCALE = 0.1667' / 1" = | CHECKED - SKM/ELH | REVISED - |
| PLOT DATE = 8/31/2017 4:26:36 PM | DATE - 05/17 | REVISED - |

STATE OF ILLINOIS
DEPARTMENT OF TRANSPORTATION

JO DAVIESS COUNTY PLAN VIEWS

SCALE: NONE SHEET NO. 3 OF 11 SHEETS STA. TO STA.

| F.A.P. RTE. | SECTION | COUNTY | TOTAL SHEETS | SHEET NO. |
|---|-----------------------|------------|--------------------|-----------|
| 301 | (30, 31, 43, 44, 45)J | JO DAVIESS | 22 | 11 |
| FED. ROAD DIST. NO. ILLINOIS FED. AID PROJECT | | | CONTRACT NO. 64M33 | |



PRINT DRIVER = L:\05-2017\1140\12\1140_12.dwg
 PLOT DATE = 8/31/2017 4:26:41 PM
 PLOT SCALE = 0.1667' / 1"



| | | |
|----------------------------------|-------------------|-----------|
| USER NAME = kjk | DESIGNED - KJK | REVISED - |
| ESCA PROJECT NO. 1140.12 | DRAWN - KJK | REVISED - |
| PLOT SCALE = 0.1667' / 1" | CHECKED - SKM/ELH | REVISED - |
| PLOT DATE = 8/31/2017 4:26:41 PM | DATE - 08/17 | REVISED - |

**STATE OF ILLINOIS
DEPARTMENT OF TRANSPORTATION**

JO DAVIESS COUNTY PLAN VIEWS

SCALE: NONE SHEET NO. 4 OF 11 SHEETS STA. TO STA.

| F.A.P. RTE. | SECTION | COUNTY | TOTAL SHEETS | SHEET NO. |
|---|-----------------------|------------|--------------------|-----------|
| 301 | (30, 31, 43, 44, 45)J | JO DAVIESS | 22 | 12 |
| FED. ROAD DIST. NO. ILLINOIS FED. AID PROJECT | | | CONTRACT NO. 64M33 | |



MATCH LINE WB US 20 STA 348 + 90.05
SEE SHEET 14

**LOCATIONS 7, 8, & 9
NEAR INTERSECTION OF ROCKY ROAD AND IMBUS ROAD**

J7
STA 355+50
TRAFFIC BARRIER TERMINAL,
TYPE 1 (SPECIAL) TANGENT

1012' GUARDRAIL REMOVAL

① LOCATE END POST
TO MATCH EXISTING

PRINT DRIVER = L:\05-EB\Bates\p9
SCALE NAME = PLOT
FILE NAME = 20170831-us20-7-8-9.dwg



| | | |
|----------------------------------|-------------------|-----------|
| USER NAME = kjk | DESIGNED - KJK | REVISED - |
| ESCA PROJECT NO. 1140.12 | DRAWN - KJK | REVISED - |
| PLOT SCALE = 0.1667' / 1" = 1/6" | CHECKED - SKM/ELH | REVISED - |
| PLOT DATE = 8/31/2017 4:26:48 PM | DATE - 05/17 | REVISED - |

**STATE OF ILLINOIS
DEPARTMENT OF TRANSPORTATION**

JO DAVIESS COUNTY PLAN VIEWS

SCALE: NONE SHEET NO. 5 OF 11 SHEETS STA. TO STA.

| F.A.P. RTE. | SECTION | COUNTY | TOTAL SHEETS | SHEET NO. |
|---|-----------------------|------------|--------------------|-----------|
| 301 | (30, 31, 43, 44, 45)J | JO DAVIESS | 22 | 13 |
| FED. ROAD DIST. NO. ILLINOIS FED. AID PROJECT | | | CONTRACT NO. 64M33 | |



MATCH LINE WB US 20 STA 348 + 90.05
SEE SHEET 13



**LOCATIONS 7, 8, & 9
NEAR INTERSECTION OF ROCKY ROAD AND IMBUS ROAD**

J8
STA 358+43
TRAFFIC BARRIER TERMINAL,
TYPE 1 (SPECIAL) TANGENT
241' STEEL PLATE BEAM
GUARDRAIL, TYPE A, 9' POSTS

300' GUARDRAIL REMOVAL
TRAFFIC BARRIER TERMINAL,
TYPE 2 ①

① EB US 20
954' STEEL PLATE BEAM GUARDRAIL, TYPE A, 9' POSTS

TRAFFIC BARRIER TERMINAL,
TYPE 2 ①

① LOCATE END POST
TO MATCH EXISTING

PRINT DRIVER = L:\05-EB\05-EB-179
SCALE NAME = PLOT
FILE NAME = 20170523-1117-179.dwg



| | | |
|----------------------------------|-------------------|-----------|
| USER NAME = kjk | DESIGNED - KJK | REVISED - |
| ESCA PROJECT NO. 1140.12 | DRAWN - KJK | REVISED - |
| PLOT SCALE = 0.1667' / 1" = 1/6" | CHECKED - SKM/ELH | REVISED - |
| PLOT DATE = 8/31/2017 4:26:56 PM | DATE - 05/17 | REVISED - |

**STATE OF ILLINOIS
DEPARTMENT OF TRANSPORTATION**

JO DAVIESS COUNTY PLAN VIEWS

SCALE: NONE SHEET NO. 6 OF 11 SHEETS STA. TO STA.

| F.A.P. RTE. | SECTION | COUNTY | TOTAL SHEETS | SHEET NO. |
|--|-----------------------|------------|--------------|-----------|
| 301 | (30, 31, 43, 44, 45)J | JO DAVIESS | 22 | 14 |
| CONTRACT NO. 64M33 | | | | |
| FED. ROAD DIST. NO. ILLINOIS FED. AID PROJECT | | | | |

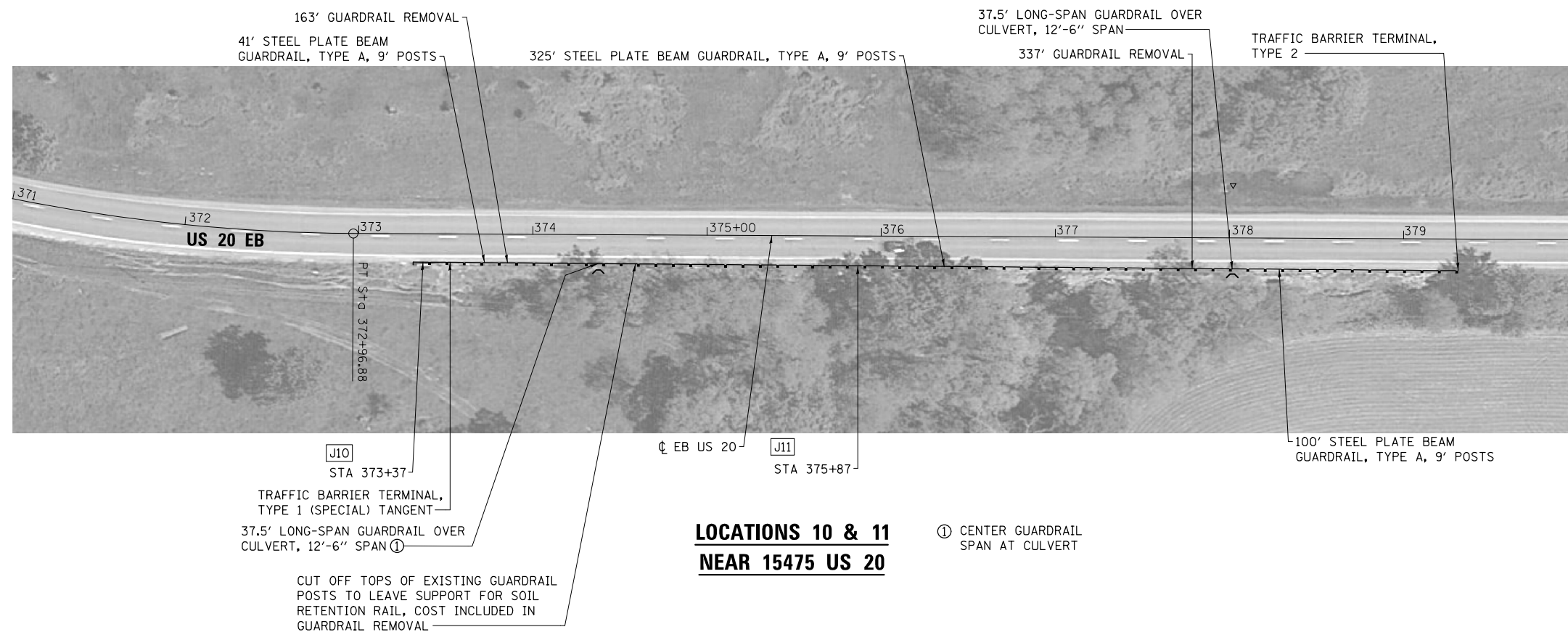

**LOCATIONS 10 & 11
NEAR 15475 US 20**

① CENTER GUARDRAIL SPAN AT CULVERT

PRINT DRIVER = L:\E-Books\10-11-17\10-11-17.dwg
 PLOT DATE = 8/31/2017 4:27:04 PM
 PLOT SCALE = 0.1667 / 1"



| | | |
|----------------------------------|-------------------|-----------|
| USER NAME = kjk | DESIGNED - KJK | REVISED - |
| ESCA PROJECT NO. 1140.12 | DRAWN - KJK | REVISED - |
| PLOT SCALE = 0.1667 / 1" | CHECKED - SKM/ELH | REVISED - |
| PLOT DATE = 8/31/2017 4:27:04 PM | DATE - 08/17 | REVISED - |

**STATE OF ILLINOIS
DEPARTMENT OF TRANSPORTATION**

JO DAVIESS COUNTY PLAN VIEWS

SCALE: NONE SHEET NO. 7 OF 11 SHEETS STA. TO STA.

| F.A.P. RTE. | SECTION | COUNTY | TOTAL SHEETS | SHEET NO. |
|---|-----------------------|------------|--------------|-----------|
| 301 | (30, 31, 43, 44, 45)J | JO DAVIESS | 22 | 15 |
| CONTRACT NO. 64M33 | | | | |
| FED. ROAD DIST. NO. ILLINOIS FED. AID PROJECT | | | | |

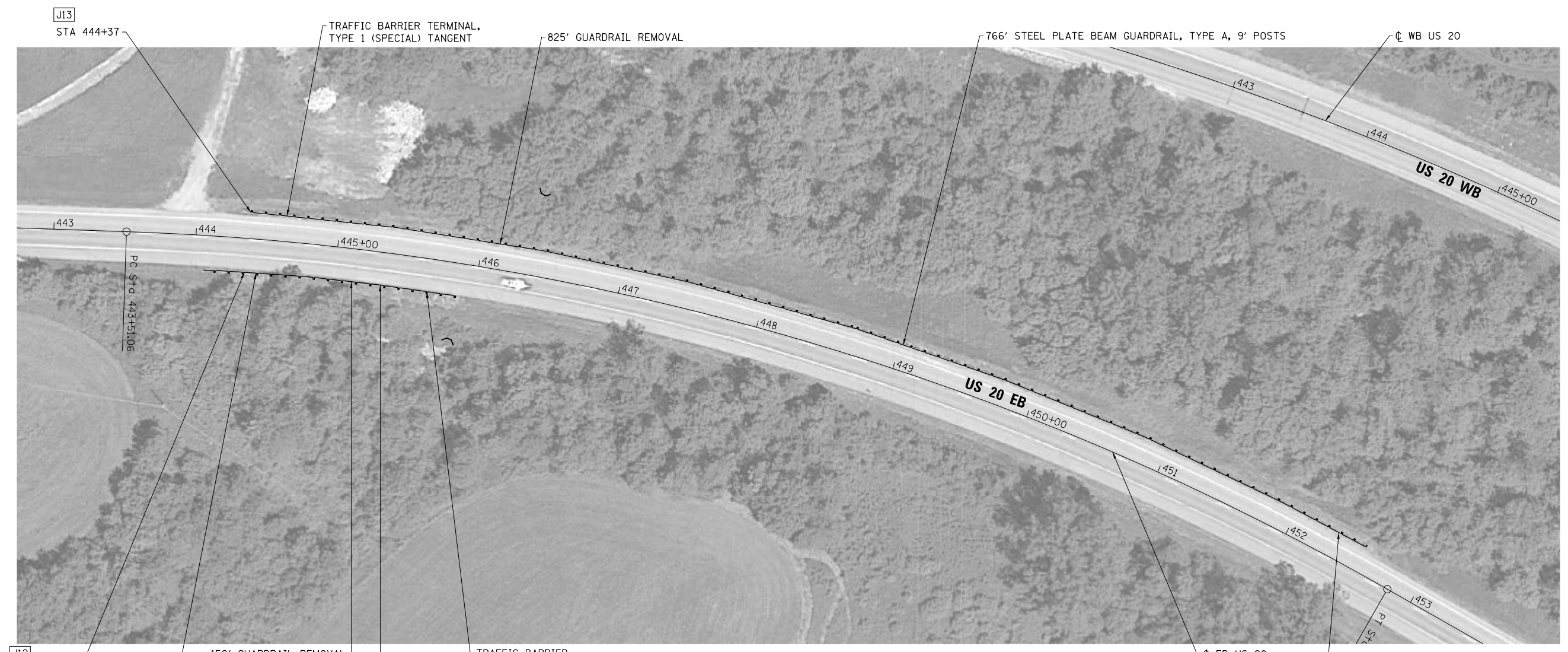

**LOCATIONS 12 & 13
NEAR NORTH MENOMINEE ROAD**

① LOCATE END POST TO MATCH EXISTING
TRAFFIC BARRIER TERMINAL, TYPE 2 ①

J12 STA 444+36
TRAFFIC BARRIER TERMINAL, TYPE 1 (SPECIAL) TANGENT
150' GUARDRAIL REMOVAL
116' STEEL PLATE BEAM GUARDRAIL, TYPE A, 9' POSTS
TRAFFIC BARRIER TERMINAL, TYPE 2 ①

PRINT DRIVER = L:\E-Books\...
 USER NAME = J12
 PLOT DATE = 8/31/2017 4:27:11 PM



| | | |
|----------------------------------|-------------------|-----------|
| USER NAME = kjk | DESIGNED - KJK | REVISED - |
| ESCA PROJECT NO. 1140.12 | DRAWN - KJK | REVISED - |
| PLOT SCALE = 0.1667' / 1" = 1/6" | CHECKED - SKM/ELH | REVISED - |
| PLOT DATE = 8/31/2017 4:27:11 PM | DATE - 05/17 | REVISED - |

**STATE OF ILLINOIS
DEPARTMENT OF TRANSPORTATION**

JO DAVIESS COUNTY PLAN VIEWS

SCALE: NONE SHEET NO. 8 OF 11 SHEETS STA. TO STA.

| F.A.P. RTE. | SECTION | COUNTY | TOTAL SHEETS | SHEET NO. |
|---|-----------------------|------------|--------------------|-----------|
| 301 | (30, 31, 43, 44, 45)J | JO DAVIESS | 22 | 16 |
| FED. ROAD DIST. NO. ILLINOIS FED. AID PROJECT | | | CONTRACT NO. 64M33 | |

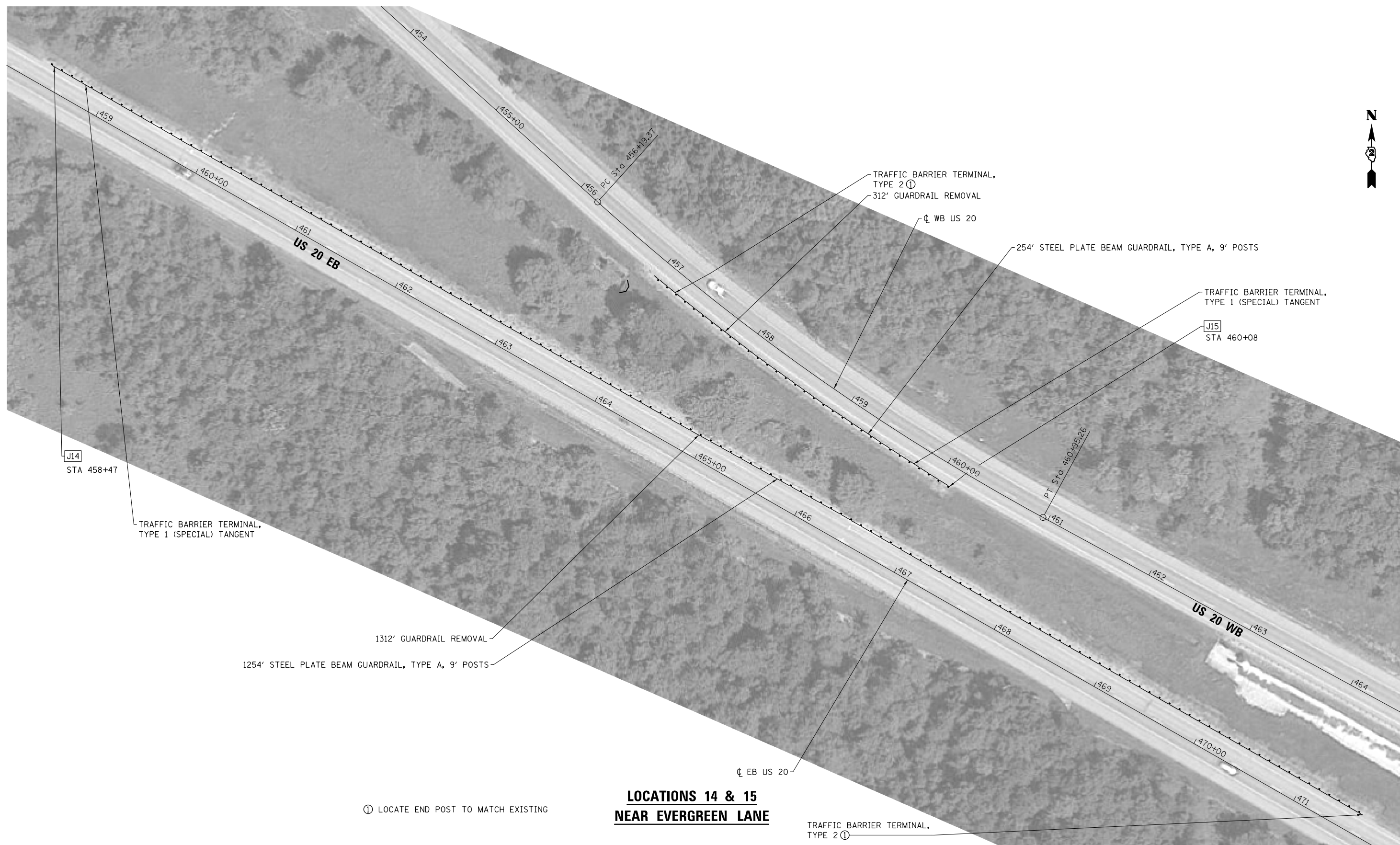

**LOCATIONS 14 & 15
NEAR EVERGREEN LANE**

① LOCATE END POST TO MATCH EXISTING

PRINT DRIVER = L:\05-2017\1140\12\1140_12.dwg
 PLOT DATE = 8/31/2017 4:27:18 PM
 PLOT SCALE = 0.1667' / 1"



| | | |
|----------------------------------|-------------------|-----------|
| USER NAME = kjk | DESIGNED - KJK | REVISED - |
| ESCA PROJECT NO. 1140.12 | DRAWN - KJK | REVISED - |
| PLOT SCALE = 0.1667' / 1" | CHECKED - SKM/ELH | REVISED - |
| PLOT DATE = 8/31/2017 4:27:18 PM | DATE - 05/17 | REVISED - |

**STATE OF ILLINOIS
DEPARTMENT OF TRANSPORTATION**

JO DAVIESS COUNTY PLAN VIEWS

SCALE: NONE SHEET NO. 9 OF 11 SHEETS STA. TO STA.

| F.A.P. RTE. | SECTION | COUNTY | TOTAL SHEETS | SHEET NO. |
|---|-----------------------|------------|--------------|-----------|
| 301 | (30, 31, 43, 44, 45)J | JO DAVIESS | 22 | 17 |
| CONTRACT NO. 64M33 | | | | |
| FED. ROAD DIST. NO. ILLINOIS FED. AID PROJECT | | | | |

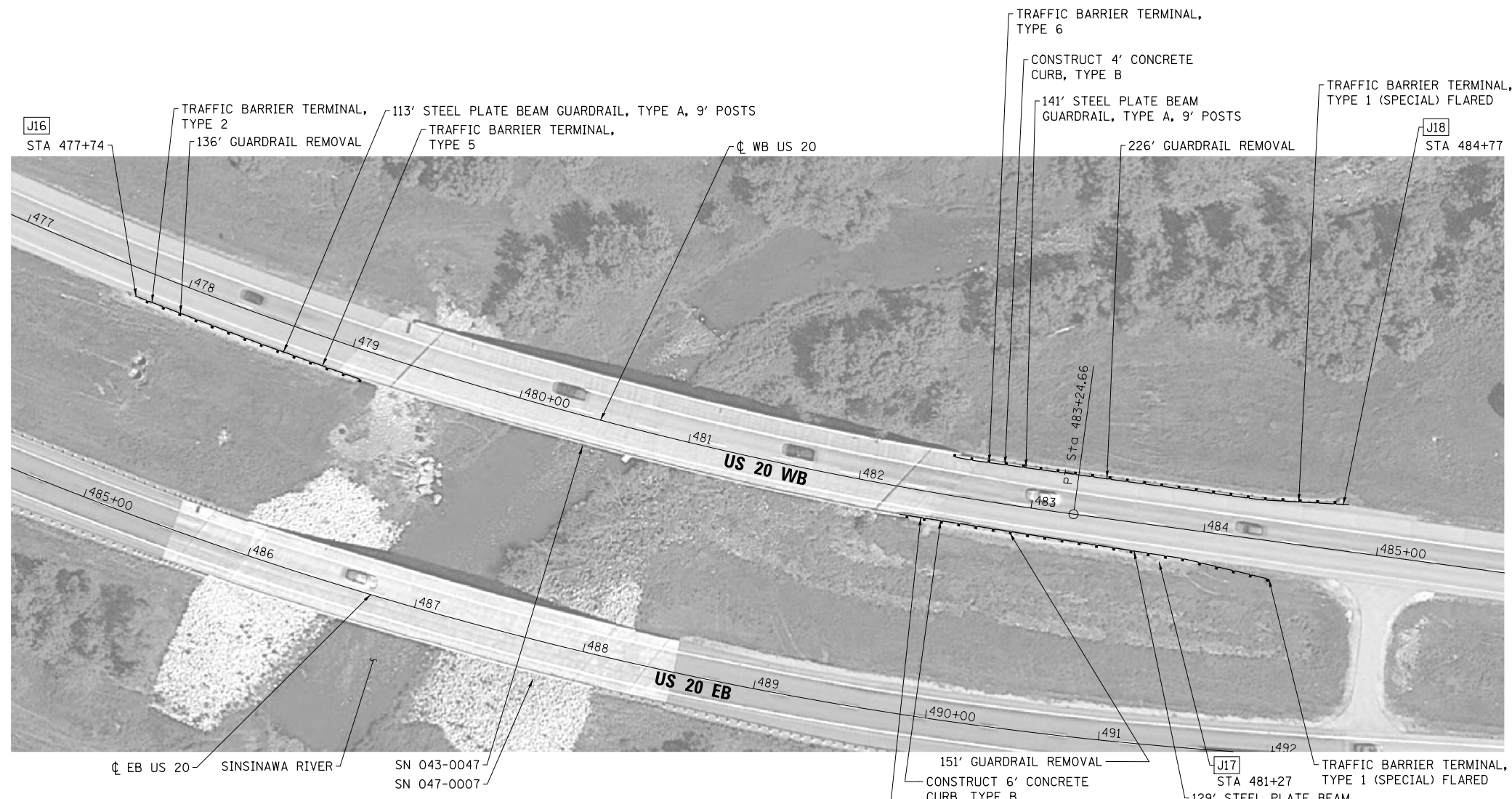

**LOCATIONS 16, 17, & 18
SN 043-0047 OVER THE SIN SINAWA RIVER**

PRINT DRIVER = L:\05-EB\Bates\9
 SCALE NAME = PLOT
 FILE NAME = 080303-ent-plan-16.dwg



| | | |
|----------------------------------|-------------------|-----------|
| USER NAME = kjk | DESIGNED - KJK | REVISED - |
| ESCA PROJECT NO. 1140.12 | DRAWN - KJK | REVISED - |
| PLOT SCALE = 0.1667' / 1" = | CHECKED - SKM/ELH | REVISED - |
| PLOT DATE = 8/31/2017 4:27:28 PM | DATE - 08/17 | REVISED - |

**STATE OF ILLINOIS
DEPARTMENT OF TRANSPORTATION**

JO DAVIESS COUNTY PLAN VIEWS

SCALE: NONE SHEET NO. 10 OF 11 SHEETS STA. TO STA.

| F.A.P. RTE. | SECTION | COUNTY | TOTAL SHEETS | SHEET NO. |
|---|-----------------------|------------|--------------|-----------|
| 301 | (30, 31, 43, 44, 45)J | JO DAVIESS | 22 | 18 |
| CONTRACT NO. 64M33 | | | | |
| FED. ROAD DIST. NO. ILLINOIS FED. AID PROJECT | | | | |



LOCATION 19
NEAR 12242 US 20

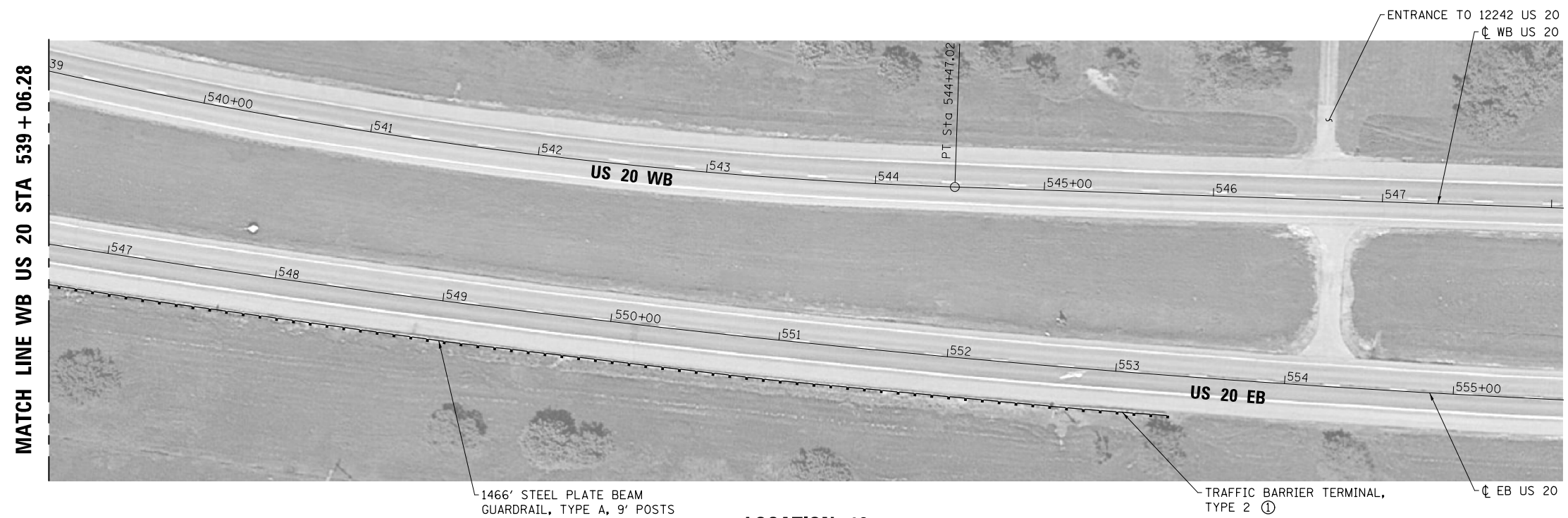

LOCATION 19
NEAR 12242 US 20

① LOCATE END POST TO MATCH EXISTING

PRINT DRIVER = L:\05-EB\Bates\9
SCALE NAME = PLOT
FILE NAME = 20180323-us20-19.dwg



| | | |
|----------------------------------|-------------------|-----------|
| USER NAME = kjk | DESIGNED - KJK | REVISED - |
| ESCA PROJECT NO. 1140.12 | DRAWN - KJK | REVISED - |
| PLOT SCALE = 0.1667' / 1" = 1/6" | CHECKED - SKM/ELH | REVISED - |
| PLOT DATE = 8/31/2017 4:27:35 PM | DATE - 05/17 | REVISED - |

STATE OF ILLINOIS
DEPARTMENT OF TRANSPORTATION

JO DAVIESS COUNTY PLAN VIEWS

SCALE: NONE SHEET NO. 11 OF 11 SHEETS STA. TO STA.

| F.A.P. RTE. | SECTION | COUNTY | TOTAL SHEETS | SHEET NO. |
|---|-----------------------|------------|--------------------|-----------|
| 301 | (30, 31, 43, 44, 45)J | JO DAVIESS | 22 | 19 |
| FED. ROAD DIST. NO. ILLINOIS FED. AID PROJECT | | | CONTRACT NO. 64M33 | |

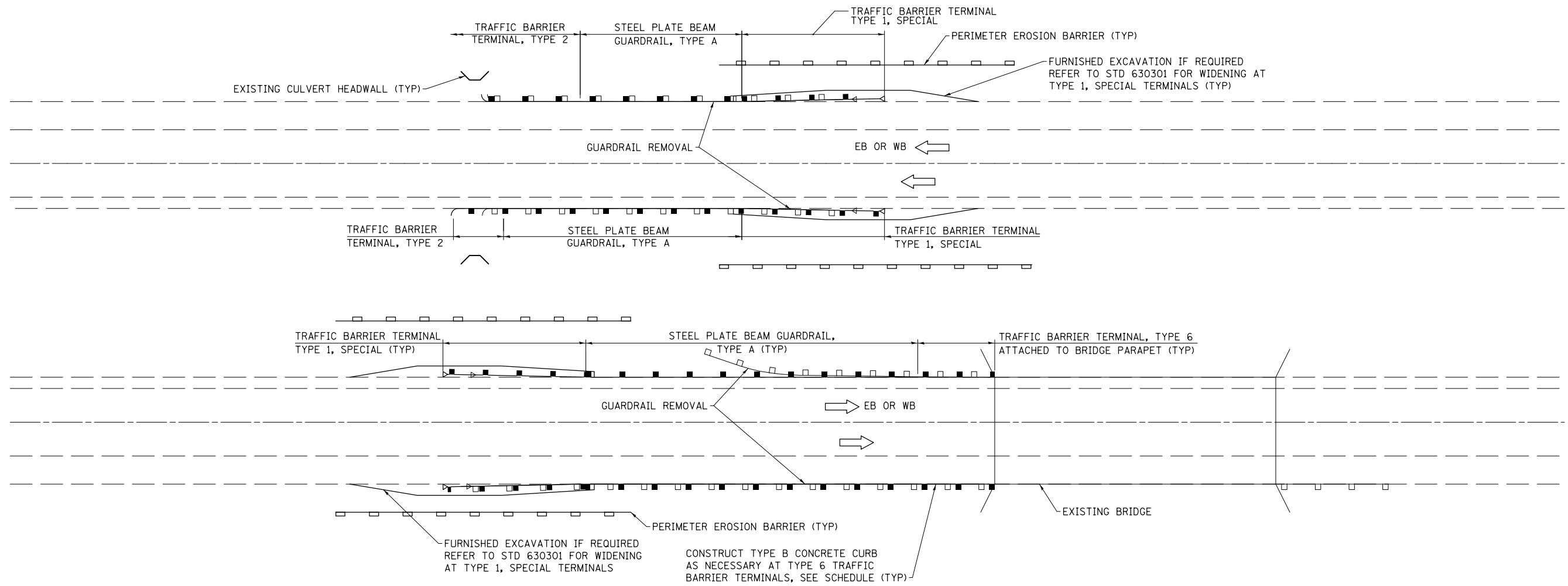

TYPICAL APPLICATION OF GUARDRAIL AT STRUCTURES

PRINT DRIVER = L:\E-Books\10179
 SCALE NAME = PLOT
 FILE NAME = 644333-111-111.dwg



| | | |
|----------------------------------|-------------------|-----------|
| USER NAME = kjk | DESIGNED - KJK | REVISED - |
| ESCA PROJECT NO. 1140.12 | DRAWN - KJK | REVISED - |
| PLOT SCALE = 0.1667' / 1" = | CHECKED - SKM/ELH | REVISED - |
| PLOT DATE = 8/31/2017 4:27:43 PM | DATE - 05/17 | REVISED - |

**STATE OF ILLINOIS
DEPARTMENT OF TRANSPORTATION**

GUARDRAIL DETAILS

SCALE: NONE SHEET NO. 1 OF 1 SHEETS STA. TO STA.

| F.A.P. RTE. | SECTION | COUNTY | TOTAL SHEETS | SHEET NO. |
|---|-----------------------|------------|--------------|-----------|
| 301 | (30, 31, 43, 44, 45)J | JO DAVIESS | 22 | 20 |
| CONTRACT NO. 64M33 | | | | |
| FED. ROAD DIST. NO. ILLINOIS FED. AID PROJECT | | | | |

TRAFFIC CONTROL TYPICAL WEAVE

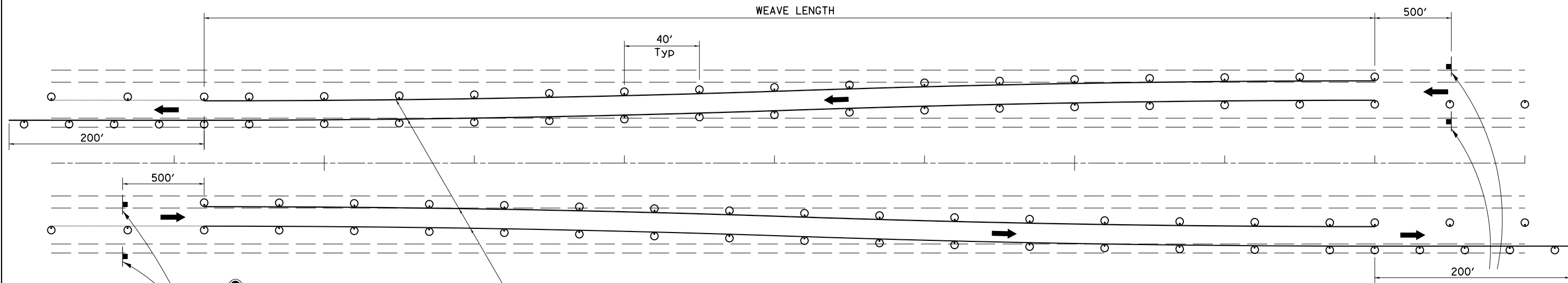

Temporary Pavement Marking required if Typical Weave is used for 14 days or more.

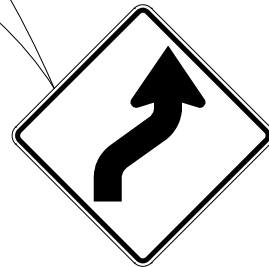

W1-4R(0)-48

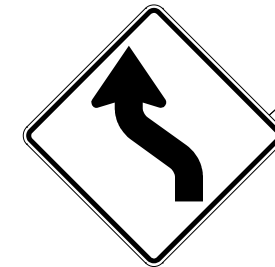

W1-4L(0)-48

SYMBOLS

- DRUM WITH STEADY BURN MONO-DIRECTIONAL LIGHT
- SIGN

GENERAL NOTES:

USE ON LONG 4-LANE PROJECTS WHERE THE CONTRACTOR MAY CHANGE A PORTION OF THE WORK TO THE OPPOSITE LANE.

USE WHERE THE PROJECT IS ADJACENT TO ANOTHER AND THE CONTRACTOR COULD BE WORKING ON DIFFERENT LANES.

TEMPORARY PAVEMENT MARKING SHALL BE USED WHEN TYPICAL WEAVE IS USED FOR 14 DAYS OR MORE.

TRAFFIC CONTROL TYPICAL WEAVE SHALL BE INCLUDED IN THE COST OF THE SPECIFIC TRAFFIC CONTROL STANDARDS OF ITEMS.

STANDARD WEAVE CONDITIONS FOR DIFFERENT SPEED LIMITS

| POSTED SPEED LIMIT | WEAVE LENGTH |
|--------------------|--------------|
| 65 MPH OR HIGHER | 780 FT. |
| 55 MPH | 660 FT. |
| 45 MPH | 540 FT. |

ALL DIMENSIONS ARE IN INCHES UNLESS OTHERWISE NOTED.

PRINT DRIVER = L:\E-Books\10179
 USER NAME = PLOT
 FILE NAME = 39.1\39.1.dwg



| | | |
|----------------------------------|-------------------|--------------------|
| USER NAME = kjk | DESIGNED - KJK | REVISED - 1-05-16 |
| ESCA PROJECT NO. 1140.12 | DRAWN - KJK | REVISED - 6-27-14 |
| PLOT SCALE = 0.1667' / 1" = 1/6" | CHECKED - SKM/ELH | REVISED - 8-27-13 |
| PLOT DATE = 8/31/2017 4:27:48 PM | DATE - 05/17 | REVISED - 10-17-11 |

STATE OF ILLINOIS
DEPARTMENT OF TRANSPORTATION

REGION 2 / DISTRICT 2 STANDARD

SCALE: NONE SHEET NO. 2 OF 2 SHEETS STA. TO STA.

| F.A.P. RTE. | SECTION | COUNTY | TOTAL SHEETS | SHEET NO. |
|---|-----------------------|------------|--------------------|-----------|
| 301 | (30, 31, 43, 44, 45)J | JO DAVIESS | 22 | 22 |
| FED. ROAD DIST. NO. ILLINOIS FED. AID PROJECT AID | | | CONTRACT NO. 64M33 | |