

HIGHWAY STANDARDS

NO.	DESCRIPTION
000001-06	ABBREVIATIONS, SYMBOLS AND PATTERNS
001006	DECIMAL OF AN INCH AND OF A FOOT
280001-07	TEMPORARY EROSION CONTROL SYSTEMS
420001-09	PAVEMENT JOINTS
424001-10	PERPENDICULAR CURB RAMPS FOR SIDEWALKS
602301-04	INLET TYPE A
602401-04	MANHOLE TYPE A
602306-03	INLET TYPE B
604001-04	FRAME AND LIDS TYPE 1
604006-05	FRAME AND GRATE TYPE 3
606001-07	CONCRETE CURB TYPE B AND COMBINATION CURB AND GUTTER
606301-04	PC CONCRETE ISLAND AND MEDIANS
630301-08	SHOULDER WIDENING FOR TYPE 1 (SPECIAL) GUARDRAIL TERMINALS
631031-15	TRAFFIC BARRIER TERMINAL, TYPE 6
667101-02	PERMANENT SURVEY MARKERS
701006-05	OFF-ROAD OPERATIONS
701101-05	OFF-ROAD OPERATIONS, MULTILANE
701301-04	LANE CLOSURE, 2L, 2W, SHORT TERM OPERATIONS
701311-03	LANE CLOSURE, 2L, 2W, MOVING OPERATIONS
701411-09	LANE CLOSURE, MULTILANE, AT ENTRANCE OR EXIT RAMP
701422-10	LANE CLOSURE, MULTILANE
701427-05	LANE CLOSURE, MULTILANE, MOVING OPERATIONS
701502-08	URBAN LANE CLOSURE, 2L, 2W, BI-DIRECTIONAL TURN LANE
701801-06	SIDEWALK CLOSURES
701901-07	TRAFFIC CONTROL DEVICES
720001-01	SIGN PANEL MOUNTING DETAILS
720006-04	SIGN PANEL ERECTION DETAILS
780001-05	TYPICAL PAVEMENT MARKINGS
878001-10	CONCRETE FOUNDATION DETAILS
DIST 5 70200000	ROAD & SIDEROAD CLOSURES
DIST 5 7800AAAA	PAVEMENT MARKING AND MARKERS (RURAL & URBAN APPLICATIONS)

SHEET LEGEND

-----	EX. CENTERLINE	⊙	EX. STORM MANHOLE (CLOSED LID)	⊙	EX. UTILITY POLE
-----	SECTION LINE	⊙	EX. STORM MANHOLE (OPEN LID)	⊙	EX. TELEPHONE POLE
-----	PROPERTY LINE	⊙	EX. CURB INLET	⊙	EX. TRAFFIC SIGNAL
-----	EX. RIGHT-OF-WAY LINE	⊙	EX. FLARED END SECTION	⊙	EX. SIGN
-----	EX. SANITARY SEWER	⊙	EX. SANITARY MANHOLE	⊙	EX. DECIDUOUS TREE
-----	EX. STORM SEWER	⊙	EX. SANITARY CLEANOUT	⊙	EX. DECIDUOUS BUSH
-----	EX. OVERHEAD AERIAL	⊙	EX. FIRE HYDRANT	⊙	EX. EVERGREEN TREE
-----	EX. WATERMAIN / WATER SERVICE	⊙	EX. WATER VALVE	⊙	EX. EVERGREEN BUSH
-----	EX. 4" WATERMAIN	⊙	EX. WATER METER	⊙	EX. STUMP
-----	EX. 6" WATERMAIN	⊙	EX. WATER CURB STOP	⊙	EX. FLAG POLE
-----	EX. 12" WATERMAIN	⊙	EX. WATER MANHOLE	⊙	EX. BOLLARD
-----	EX. UNDERGROUND CATV	⊙	EX. GAS VALVE	⊙	EX. MAIL BOX
-----	EX. UNDERGROUND TELEPHONE	⊙	EX. GAS CURB STOP	⊙	EX. LAMP POST
-----	EX. UNDERGROUND ELECTRIC	⊙	EX. TELEPHONE PEDESTAL	⊙	EX. ELECTRICAL TRANSFORMER
-----	EX. OVERHEAD ELECTRIC	⊙	EX. TELEPHONE MANHOLE	⊙	EX. WOOD POLE
-----	EX. OVERHEAD TELEPHONE	⊙	EX. CATV PEDESTAL	⊙	EX. ROW MARKER
-----	EX. OVERHEAD CATV	⊙	EX. HANDHOLE	⊙	EX. SURVEY MARKER
-----	EX. GAS LINE	⊙	EX. LIGHT POLE	⊙	EX. IRON PIPE / PIN FOUND
-----	EX. FENCE	⊙			EX. SET CONTROL POINT
-----	EX. RAILROAD TRACKS	⊙			EX. HOUSE NUMBER
-----	EX. CULTIVATION LINE	⊙			EX. STRUCTURE NUMBER
-----	EX. CONTOUR	⊙			

MISCELLANEOUS KEYS

KEY	NOTATION	AS SHOWN IN: NOTES ON DRAWINGS: SCHEDULES & SPECS	KEY	NOTATION	AS SHOWN IN: NOTES ON DRAWINGS: SCHEDULES & SPECS
2/3	SECTION NUMBER	SECTION 2,3	3	DETAIL NUMBER	DETAIL 2,3
2/3	SHEET NUMBER WHERE TAKEN & SHOWN		3	SHEET NUMBER WHERE TAKEN & SHOWN	
2/3	SECTION NUMBER	SECTION 2,2/3	2/3	DETAIL NUMBER	DETAIL 2,2/3
2/3	SHEET NUMBER WHERE TAKEN		2/3	SHEET NUMBER WHERE TAKEN	
2/3	SHEET NUMBER WHERE SHOWN		2/3	SHEET NUMBER WHERE SHOWN	
⊙	IRON PIPE / PIN FOUND				
⊙	SET CONTROL POINT				
100	HOUSE NUMBER				
100	STRUCTURE NUMBER				

HMA MIXTURE REQUIREMENTS TABLE		
LOCATION	RTE 1 & SOUTHGATE DR	RTE 1 & SOUTHGATE DR
MIXTURE USE:	POLYMER SURFACE	POLYMER LEVEL BINDER
AC / PG	SBS PG 70-22	SBS PG 70-22
DESIGN AIR VOIDS	4.0% @ N _{Deg} = 70	4.0% @ N _{Deg} = 70
MIX COMPOSITION (GRADATION)	IL-9.5	IL-9.5 F.G.
FRICTIONAL AGGREGATE	MIX D	N/A
MIXTURE WEIGHT	112.0 LBS / SQ YD / INCH	112.0 LBS / SQ YD / INCH
QUALITY MANAGEMENT PROGRAM	QA/QC	QA/QC
SUBLOT SIZE	N/A	N/A

RATES OF APPLICATION TABLE

AGGREGATE (SURFACE, BASE OR BACKFILL)	2.05 TON/CU YD
SUBBASE GRANULAR MATERIAL, TYPE A	2.05 TON/CU YD
HOT-MIX ASPHALT BITUMINOUS MATERIAL (PRIME COAT)	
-ON PAVEMENT	0.1 GAL / SQ YD (.851 LBS/SQ YD)
-ON AGGREGATE	0.3 GAL / SQ YD (2.55 LBS / SQ YD)
HOT-MIX ASPHALT SURFACE / BINDER COURSES (112 LBS.)	.0056 TON / SQ YD * IN

GENERAL NOTES

- ALL CONSTRUCTION SHALL BE DONE IN ACCORDANCE WITH THE ILLINOIS DEPARTMENT OF TRANSPORTATION "STANDARD SPECIFICATIONS FOR ROAD AND BRIDGE CONSTRUCTION", ADOPTED APRIL 1, 2016, AND "STANDARD SPECIFICATIONS FOR WATER AND SEWER CONSTRUCTION", ADOPTED 2014, THESE PLANS AND THE SPECIAL PROVISIONS INCLUDED IN THE CONTRACT DOCUMENTS.
- THE ENGINEER SHALL NOT BE RESPONSIBLE FOR THE MEANS, METHODS, PROCEDURES, TECHNIQUES, OR SEQUENCES OF CONSTRUCTION, NOR SAFETY ON THE JOB SITE, NOR SHALL THE ENGINEER BE RESPONSIBLE FOR THE CONTRACTOR'S FAILURE TO CARRY OUT THE WORK IN ACCORDANCE WITH THE CONTRACT DOCUMENTS. NEITHER THE PROFESSIONAL ACTIVITIES OF THE ENGINEER NOR THE PRESENCE OF THE ENGINEER AT A CONSTRUCTION SITE SHALL RELIEVE THE CONTRACTOR OF THEIR OBLIGATIONS, DUTIES, AND RESPONSIBILITIES INCLUDING ANY HEALTH AND SAFETY PRECAUTIONS REQUIRED BY ANY REGULATORY AGENCIES.

IN ADDITION, THE "STANDARD SPECIFICATIONS FOR ROAD AND BRIDGE CONSTRUCTION" SHALL BE MODIFIED AS FOLLOWS:

UNDER SECTION 105.01, ADD THE FOLLOWING SENTENCE:

NOTHING CONTAINED HEREIN SHALL RELIEVE THE CONTRACTOR OF ITS DUTY TO OBSERVE AND COMPLY WITH ALL APPLICABLE LAWS, NOR SHALL THE ENGINEER BE RESPONSIBLE FOR CONTRACTOR'S COMPLIANCE OR NON-COMPLIANCE WITH SUCH LAWS.

UNDER SECTION 107.01, ADD THE FOLLOWING SENTENCE:

THE ENGINEER SHALL NOT BE RESPONSIBLE FOR CONTRACTOR'S DUTY TO OBSERVE AND COMPLY WITH THE PROVISIONS OF THIS SECTION, OR FOR CONTRACTOR'S FAILURE TO DO SO.
- EXISTING VILLAGE-OWNED AND MAINTAINED UTILITIES ARE SHOWN ON THE PLANS. THE CONTRACTOR SHALL COORDINATE THE LOCATING OF THESE UTILITIES WITH THE VILLAGE PRIOR TO COMMENCING ANY EXCAVATION OR BORING IN THEIR VICINITY. SHOULD THESE UTILITIES BE DAMAGED BY THE CONTRACTOR'S OPERATIONS, THE CONTRACTOR SHALL REPAIR THEM TO THE SATISFACTION OF, AND AT NO COST TO, THE VILLAGE.
- UTILITY LINES WERE PLOTTED FROM INFORMATION FURNISHED BY THE VARIOUS UTILITY COMPANIES INVOLVED AND THEIR ACCURACY SHOULD BE CONSIDERED APPROXIMATE ONLY. THESE UTILITY COMPANIES MAY BE ADJUSTING THEIR FACILITIES DURING CONSTRUCTION. THE CONTRACTOR SHALL COOPERATE WITH THESE ORGANIZATIONS WHILE THESE ADJUSTMENTS ARE BEING PERFORMED.
- J.U.L.I.E. - JOINT UTILITY LOCATION INFORMATION FOR EXCAVATORS SYSTEM. 1-800-892-0123 OR 811.
- CONTRACTOR SHALL VERIFY LOCATION OF ALL EXISTING UTILITIES BEFORE BEGINNING CONSTRUCTION. THE CONTRACTOR SHALL BE RESPONSIBLE FOR PROTECTING ALL UTILITIES AND SHALL BE LIABLE FOR ANY DAMAGE TO THEM RESULTING FROM HIS OPERATIONS.
- ANY STANDARDS REFERENCED THROUGHOUT THE PLANS SHALL BE INTERPRETED TO BE THE LATEST HIGHWAY STANDARDS OF THE ILLINOIS DEPARTMENT OF TRANSPORTATION AS SHOWN ON THE SCHEDULE OF HIGHWAY STANDARDS ON THE HIGHWAY STANDARDS AND LEGEND SHEET.
- ALL ELEVATIONS SHOWN ON THE PLANS ARE BASED ON NORTH AMERICAN VERTICAL DATUM OF 1988 (NAVD 88).
- ACCESS TO ALL ENTRANCES AND SIDE ROADS SHALL BE MAINTAINED AT ALL TIMES UNLESS THE CONTRACTOR OBTAINS WRITTEN PERMISSION FROM THE OWNER OR OCCUPANTS. THE COST OF AGGREGATE FOR TEMPORARY ACCESS IS INCLUDED IN PAVEMENT SCHEDULE.
- ALL SAW CUTS NECESSARY TO COMPLETE THE WORK DETAILED IN THESE PLANS SHALL BE INCLUDED IN THE COST FOR THE VARIOUS PAY ITEMS INVOLVED, UNLESS OTHERWISE NOTED.
- THE AREA TO BE SEEDED SHALL CONSIST OF ALL EARTH SURFACES DISTURBED DURING CONSTRUCTION AS DIRECTED BY THE ENGINEER. PAYMENT SHALL ONLY BE MADE FOR DISTURBANCE WITHIN THE CONSTRUCTION LIMITS. DISTURBANCE OUTSIDE OF CONSTRUCTION LIMITS IS CONSIDERED INCIDENTAL.
- WHEN REQUIRED BY ARTICLE 420.18, A PROTECTIVE COAT SHALL BE APPLIED TO CONCRETE PAVEMENT, GUTTER FLAGS, CURB SURFACES AND OTHER CONCRETE APPURTENANCES ADJACENT TO THE PAVEMENT INCIDENTAL TO CONCRETE PLACEMENT.
- TREES THAT INTERFERE WITH THE CONSTRUCTION OPERATIONS SHALL BE REMOVED AS DIRECTED BY THE ENGINEER. ANY TREE DUE TO ITS LOCATION AND DEEMED SUITABLE FOR SAVING BY THE ENGINEER SHALL BE PROTECTED DURING CLEARING AND SUBSEQUENT CONSTRUCTION OPERATIONS.
- GRADING SHALL BE DONE BY HAND AROUND LIGHT POLES, UTILITY POLES, SIGN POST, SHRUBS, TREES OR OTHER NATURAL OR MANMADE OBJECTS WHERE SHALLOW FILLS OR CUTS ARE ADJACENT TO THE ITEMS. IT IS THE INTENT THAT THE LIMITS OF CONSTRUCTION ARE SUCH AS TO PRESERVE IN THE ORIGINAL STATE AS MUCH AREA OF TEMPORARY EASEMENTS AS POSSIBLE. THE DECISION AS TO ITEMS TO REMAIN IN PLACE SHALL BE AS DIRECTED BY THE ENGINEER. THIS WORK WILL NOT BE PAID FOR SEPARATELY, BUT SHALL BE CONSIDERED INCLUDED IN THE CONTRACT UNIT PRICE PER CUBIC YARD FOR EARTH EXCAVATION AND NO ADDITIONAL COMPENSATION SHALL BE ALLOWED.
- RIM ELEVATIONS ON CURB CASTINGS ARE TO THE EDGE OF PAVEMENT, UNLESS OTHERWISE NOTED.
- THE CONTRACTOR SHALL PROTECT AND CAREFULLY PRESERVE ALL SECTION OR SUBSECTION MARKERS, RIGHT-OF-WAY MONUMENTS AND PROPERTY MARKERS UNTIL AN AUTHORIZED SURVEYOR OR AGENT HAS WITNESSED OR OTHERWISE REFERENCED THEIR LOCATION.
- THE CONTRACTOR SHALL NOTIFY THE ENGINEER (PH. 217-586-1803) AND THE VILLAGE OF TILTON (PH. 217-477-0800) AT LEAST 72 HOURS IN ADVANCE OF THE START OR RESTART OF CONSTRUCTION.
- EXCAVATION FOR STRUCTURES SHALL INCLUDE ALL MATERIALS ENCOUNTERED, REGARDLESS OF THEIR NATURE IN ACCORDANCE WITH SECTION 502.03
- THE CONTRACTOR SHALL DISPOSE OF ALL REMOVAL ITEMS OFF OF THE RIGHT-OF-WAY.
- ALL DESIGNATED PIPE LENGTHS ARE MEASURED FROM CENTER TO CENTER OF MANHOLES.
- BEFORE ORDERING DRAINAGE STRUCTURES OR PIPES, THE CONTRACTOR SHALL CONTACT THE ENGINEER FOR EXACT LENGTHS, SIZES AND QUANTITIES REQUIRED.
- WHEN CONNECTIONS ARE TO BE MADE TO EXISTING PIPING AND STRUCTURES, THE LOCATION, ELEVATION AND SIZE OF THE EXISTING PIPING SHALL BE FIELD VERIFIED AND NOTIFICATION GIVEN TO THE ENGINEER IF THE EXISTING PIPING OR STRUCTURE IS FOUND TO BE DIFFERENT THAN WHAT IS SHOWN ON THE DRAWINGS. WHERE SUCH DISCREPANCY IS FOUND, WORK SHALL NOT PROCEED UNTIL DIRECTED ACCORDINGLY BY THE ENGINEER.
- COARSE AGGREGATE GRADATION CA-10 MAY BE USED WHENEVER COARSE AGGREGATE CA-8 IS SPECIFIED IN THE STANDARD SPECIFICATIONS.
- WHERE SECTION OR SUBSECTION MONUMENTS, BENCHMARKS, OR IRON PIPE MONUMENTS ARE ENCOUNTERED, THE ENGINEER SHALL BE NOTIFIED BEFORE SUCH MONUMENTS ARE REMOVED. THE CONTRACTOR SHALL PROTECT AND CAREFULLY PRESERVE ALL MONUMENTS UNTIL AN ILLINOIS REGISTERED LAND SURVEYOR OR AGENT HAS WITNESSED OR OTHERWISE REFERENCED THEIR LOCATION. THE CONTRACTOR SHALL BE RESPONSIBLE FOR HAVING AN ILLINOIS REGISTERED LAND SURVEYOR RE-ESTABLISH AND MONUMENTS UNNECESSARILY DESTROYED BY HIS OR HER OPERATIONS.
- ALL STREET RETURNS HAVE RADI DESIGNATED TO THE EDGE OF PAVEMENT UNLESS OTHERWISE NOTED ON THE PLANS.
- ONLY EXISTING PAVEMENT, BASE COURSES AND DRIVEWAY PAVEMENTS COMPOSED OF PORTLAND CEMENT CONCRETE, ASPHALT OR BRICK WILL BE MEASURED AND PAID FOR AS "PAVEMENT REMOVAL" OR "DRIVEWAY PAVEMENT REMOVAL" AS THE CASE MAY BE IN ACCORDANCE WITH SECTION 440 OF THE STANDARD SPECIFICATIONS AND THE SPECIAL PROVISIONS. NO ADDITIONAL COMPENSATION WILL BE ALLOWED FOR PAVEMENT REMOVAL ITEMS DUE TO VARIATIONS IN PAVEMENT TYPES, THICKNESSES OR AMOUNT OF REINFORCEMENT. THE ADJUSTMENT OF QUANTITIES AS SPECIFIED IN ARTICLE 444.07 OF THE STANDARD SPECIFICATION SHALL NOT APPLY. REMOVAL OF OTHER TYPES OF PAVEMENT COMPOSITION SUCH AS AGGREGATE OR A MIX OF AGGREGATE/OIL AND CHIP WILL BE MEASURED AND PAID FOR AS "EARTH EXCAVATION" IN ACCORDANCE WITH SECTION 202 OF THE STANDARD SPECIFICATION.
- WHEN CONNECTIONS ARE TO BE MADE TO EXISTING PIPING AND STRUCTURES, THE LOCATION AND ELEVATION OF THE EXISTING PIPING SHALL BE FIELD VERIFIED AND NOTIFICATION GIVEN TO THE ENGINEER IF THE EXISTING PIPING OR STRUCTURE IS FOUND TO BE DIFFERENT THAN THAT SHOWN ON THE DRAWINGS. WHERE SUCH DISCREPANCY IS FOUND, WORK SHALL NOT PROCEED UNTIL DIRECTED ACCORDINGLY BY THE ENGINEER.
- WHERE THE PROPOSED COMBINATION CONCRETE CURB AND GUTTER JOINS THE EXISTING CURB AND GUTTER, A TRANSITION BETWEEN THE TWO CONFIGURATIONS MAY BE REQUIRED. THIS WORK WILL BE CONSIDERED INCLUDED IN THE CONTRACT UNIT PRICE FOR CURB AND GUTTER OF THE SIZE AND TYPE SPECIFIED IN THE PLANS.

NEWWAY COMMUNICATIONS (CABLE) 1219 N. STATE ST. WESTVILLE, IL 61863 (217) 663-9844 DANNY RUDD	AT&T (TELECOMMUNICATIONS) 201 S. NEIL ST CHAMPAIGN, IL 61820 (217) 398-7979 MIKE MURPHY	COMCAST (CABLE TELEVISION) 303 E. FAIRLAWN DR. URBANA, IL 61801 (217) 202-2644 ROBERT VALENTINE	NOW WIRELESS, LLC (TELECOMMUNICATIONS) 607 S. STATE ST. JERSEYVILLE, IL 62052 (618) 948-5940 JOE MCKENNON	VILLAGE OF TILTON (STORM/SANITARY SEWER) 1001 TILTON ROAD TILTON, IL 61833 (217) 477-0800 MAYOR DAVID PHILLIPS	AMEREN IP - (NORTH) (POWER AND GAS) 115 E. VOORHEES ST. SUITE B, MC Q-15 DANVILLE, IL 61832 (217) 431-9703 QUINTON COMBS	AQUA ILLINOIS, INC. (WATER) 322 N. GILBERT ST. P.O. BOX 1130 DANVILLE, IL 61834 (217) 442-3083 EXT. 58131 ANDY PRICE
---	---	---	---	--	---	---

Phoenix Consulting Engineers, Ltd.
Professional Design Firm No. 184,005835
421 E. Main Street • Mahomet, IL 61853
PH 217-586-1803 • Fax 217-586-6757

GENERAL NOTES
TILTON CORRIDOR IMPROVEMENTS
VILLAGE OF TILTON
VERMILION COUNTY, ILLINOIS

DRAWN BY: MLN		DATE: 2/23/17	
NO.	DATE	BY	DESCRIPTION
1	3/28/17	JW	DOT REVIEW COMMENTS
2	3/29/18	BWS	UPDATED HIGHWAY STANDARDS REVISIONS
3	4/12/18	BWS	ADD HIGHWAY STANDARD DOT REVISION
APPROVED BY: TLD		DATE: 2/23/17	

PAY ITEM NO.	DESCRIPTION	UNIT	QUANTITY
20200100	EARTH EXCAVATION	CU YD	2800
20900150	TRENCH BACKFILL	CU YD	10
21101615	TOPSOIL FURNISH AND PLACE, 4"	SQ YD	488
25000100	SEEDING, CLASS 1	ACRE	3.5
25000400	NITROGEN FERTILIZER NUTRIENT	POUND	312
25000500	PHOSPHORUS FERTILIZER NUTRIENT	POUND	312
25000600	POTASSIUM FERTILIZER NUTRIENT	POUND	312
25100125	MULCH, METHOD 3	ACRE	3.5
25200100	SODDING	SQ YD	488
25200200	SUPPLEMENTAL WATERING	UNIT	3.0
28000400	PERIMETER EROSION BARRIER	FOOT	1338
29000500	INLET AND PIPE PROTECTION	EACH	34
31100100	SUBBASE GRANULAR MATERIAL, TYPE A	TON	1075
31100300	SUBBASE GRANULAR MATERIAL, TYPE A, 4"	SQ YD	2524
* 35301400	PORTLAND CEMENT CONCRETE BASE COURSE (VARIABLE DEPTH)	SQ YD	2373
40500200	BITUMINOUS MATERIALS (TACK COAT)	POUND	24137
* 40500847	POLYMERIZED LEVELING BINDER (MACHINE METHOD), IL-9.5FG, N90	TON	1265
40500882	HOT-MIX ASPHALT SURFACE REMOVAL - BUTT JOINT	SQ YD	1327
40500960	TEMPORARY RAMP	SQ YD	213
40503245	POLYMERIZED HOT-MIX ASPHALT SURFACE COURSE, MIX "D", N90	TON	1191
42000301	PORTLAND CEMENT PAVEMENT 8" (JOINTED)	SQ YD	2103
42400300	PORTLAND CEMENT CONCRETE SIDEWALK 6 INCH	SQ FT	484
42400900	DETECTABLE WARNING	SQ FT	15
44000100	PAVEMENT REMOVAL	SQ YD	6291
44000150	HOT-MIX ASPHALT SURFACE REMOVAL, 2 1/4"	SQ YD	1516
44000200	DRIVEWAY PAVEMENT REMOVAL	SQ YD	95
44000500	COMBINATION CURB AND GUTTER REMOVAL	FOOT	2491
44000600	SIDEWALK REMOVAL	SQ FT	490
44001980	CONCRETE BARRIER REMOVAL	FOOT	780
44213200	SAW CUTS	FOOT	2837
44300200	STRIP REFLECTIVE CRACK CONTROL TREATMENT	FOOT	2005
50200400	ROCK EXCAVATION FOR STRUCTURES	CU YD	1.1
54248910	CONCRETE COLLAR	CU YD	1.0
550A0050	STORM SEWERS, CLASS A, TYPE 1 12"	FOOT	70
Δ* 58109210	WATER VALVES TO BE ADJUSTED	EACH	1
* 59300100	CONTROLLED LOW-STRENGTH MATERIAL	CU YD	27
60235700	INLETS, TYPE A, TYPE 3 FRAME AND GRATE	EACH	11
60240220	INLETS, TYPE B, TYPE 3 FRAME AND GRATE	EACH	4
60235900	MANHOLES TO BE ADJUSTED	EACH	5
60260100	INLETS TO BE ADJUSTED	EACH	3
60260400	INLETS TO BE ADJUSTED WITH NEW TYPE 1 FRAME, CLOSED LID	EACH	1
60300300	FRAMES AND LIDS TO BE ADJUSTED	EACH	6
60500040	REMOVING MANHOLES	EACH	9
60500060	REMOVING INLETS	EACH	16
60500800	COMBINATION CONCRETE CURB AND GUTTER, TYPE B-6.12	FOOT	427
60504400	COMBINATION CONCRETE CURB AND GUTTER, TYPE B-6.18	FOOT	489

* DENOTES SPECIAL PROVISION Δ SPECIALTY ITEMS

PAY ITEM NO.	DESCRIPTION	UNIT	QUANTITY
60605000	COMBINATION CONCRETE CURB AND GUTTER, TYPE B-6.24	FOOT	1574
* 60605100	COMBINATION CONCRETE CURB AND GUTTER, TYPE B-6.24 (ABUTTING EXISTING PAVEMENT)	FOOT	1153
63200310	GUARDRAIL REMOVAL	FOOT	484
67100100	MOBILIZATION	L SUM	1
Δ 68900200	NON-SPECIAL WASTE DISPOSAL	CU YD	650
Δ 68900450	SPECIAL WASTE PLANS AND REPORTS	L SUM	1
Δ 68900530	SOIL DISPOSAL ANALYSIS	EACH	6
70106800	CHANGEABLE MESSAGE SIGN	CAL MO	2
70300100	SHORT TERM PAVEMENT MARKING	FOOT	573
70300150	SHORT TERM PAVEMENT MARKING REMOVAL	SQ FT	191
70300220	TEMPORARY PAVEMENT MARKING - LINE 4"	FOOT	21958
70300290	TEMPORARY PAVEMENT MARKING - LINE 12"	FOOT	72
70800340	IMPACT ATTENUATORS, RELOCATE (NON-REDIRECTIVE), TEST LEVEL 2	EACH	1
Δ 72000100	SIGN PANEL - TYPE 1	SQ FT	6
Δ 72400100	REMOVE SIGN PANEL ASSEMBLY-TYPE A	EACH	19
Δ 72400310	REMOVE SIGN PANEL TYPE 1	SQ FT	10
Δ 72400730	RELOCATE SIGN PANEL - TYPE 3	SQ FT	120
Δ 72700100	STRUCTURAL STEEL SIGN SUPPORT - BREAKAWAY	POUND	450
Δ 72900200	METAL POST - TYPE B	FOOT	14
Δ 73400100	CONC FOUNDATION	CU YD	2
Δ * 73700200	REMOVE CONCRETE FOUNDATION - GROUND MOUNT	EACH	2
Δ 78000500	MODIFIED URETHANE PAVEMENT MARKING - LETTERS AND SYMBOLS	SQ FT	593
Δ 78009004	MODIFIED URETHANE PAVEMENT MARKING - LINE 4"	FOOT	9503
Δ 78009012	MODIFIED URETHANE PAVEMENT MARKING - LINE 12"	FOOT	45
Δ 78009024	MODIFIED URETHANE PAVEMENT MARKING - LINE 24"	FOOT	249
Δ 81028350	UNDERGROUND CONDUIT, PVC, 2" DIA.	FOOT	3940
Δ 81028360	UNDERGROUND CONDUIT, PVC, 2 1/2" DIA.	FOOT	188
Δ 81028370	UNDERGROUND CONDUIT, PVC, 3" DIA.	FOOT	370
Δ 81028390	UNDERGROUND CONDUIT, PVC, 4" DIA.	FOOT	291
Δ 81400700	HANDHOLE, PORTLAND CEMENT CONCRETE	EACH	4
Δ 81400720	DOUBLE HANDHOLE, PORTLAND CEMENT CONCRETE	EACH	1
Δ 81500120	GULFBOX JUNCTION, COMPOSITE CONCRETE	EACH	1
Δ 81500130	GULFBOX JUNCTION REMOVAL	EACH	5
Δ 81702110	ELECTRIC CABLE IN CONDUIT, 600V (XLP-TYPE USE) 1/2" NO. 10	FOOT	430
Δ 81702130	ELECTRIC CABLE IN CONDUIT, 600V (XLP-TYPE USE) 1/2" NO. 6	FOOT	10380
Δ 84200500	REMOVAL OF LIGHTING UNIT, SALVAGE	EACH	4
Δ 84200804	REMOVAL OF POLE FOUNDATION	EACH	8
Δ 84400105	RELOCATE EXISTING LIGHTING UNIT	EACH	4
Δ 85700200	FULL-ACTUATED CONTROLLER AND TYPE IV CABINET	EACH	1
Δ 86200200	UNINTERRUPTABLE POWER SUPPLY, STANDARD	EACH	1
Δ 87301215	ELECTRIC CABLE IN CONDUIT, SIGNAL NO. 14 2C	FOOT	1790
Δ 87301225	ELECTRIC CABLE IN CONDUIT, SIGNAL NO. 14 3C	FOOT	4280
Δ 87301245	ELECTRIC CABLE IN CONDUIT, SIGNAL NO. 14 5C	FOOT	5840
Δ 87301255	ELECTRIC CABLE IN CONDUIT, SIGNAL NO. 14 7C	FOOT	5880
Δ 87301900	ELECTRIC CABLE IN CONDUIT, EQUIPMENT GROUNDING CONDUCTOR, NO. 6 1C	FOOT	1470
Δ 87502640	TRAFFIC SIGNAL POST, ALUMINUM 10 FT.	EACH	2
Δ 63100167	TRAFFIC BARRIER TERMINAL, TYPE 1 (SPECIAL) TANGENT	EACH	1
Δ 63302700	REMOVE AND REERECT TRAFFIC BARRIER TERMINALS TYPE 6	EACH	1

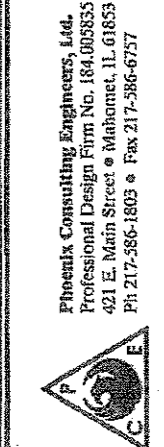

Phoenix Consulting Engineers, Ltd.
Professional Design Firm No. 184.005553
421 E. Main Street • Mahomet, IL 61853
PH 217-566-1803 • Fax 217-566-6757

SUMMARY OF QUANTITIES
TILTON CORRIDOR IMPROVEMENTS
VILLAGE OF TILTON
VERMILION COUNTY, ILLINOIS

REVISIONS	
NO.	DESCRIPTION
1	DOT REVIEW COMMENTS
2	REVISED QUANTITIES

PROJECT NO.
14TIL009

PAY ITEM NO.	DESCRIPTION	UNIT	QUANTITY
Δ	67502680	TRAFFIC SIGNAL POST, ALUMINUM 14 FT.	EACH 6
Δ *	67702970	STEEL COMBINATION MAST ARM ASSEMBLY AND POLE 48 FT.	EACH 2
Δ *	67702980	STEEL COMBINATION MAST ARM ASSEMBLY AND POLE 50 FT.	EACH 1
Δ *	67703020	STEEL COMBINATION MAST ARM ASSEMBLY AND POLE 58 FT.	EACH 1
Δ	67800100	CONCRETE FOUNDATION, TYPE A	FOOT 24
Δ	67800150	CONCRETE FOUNDATION, TYPE C	FOOT 4
Δ	67800415	CONCRETE FOUNDATION, TYPE E 36-INCH DIAMETER	FOOT 95
Δ	67800420	CONCRETE FOUNDATION, TYPE E 42-INCH DIAMETER	FOOT 21
Δ	67900200	DRILL EXISTING HANDHOLE	EACH 14
Δ	68040090	SIGNAL HEAD, POLYCARBONATE, LED, 1-FACE, 3-SECTION, MAST ARM MOUNTED	EACH 9
Δ	68040110	SIGNAL HEAD, POLYCARBONATE, LED, 1-FACE, 4-SECTION, BRACKET MOUNTED	EACH 3
Δ	68040120	SIGNAL HEAD, POLYCARBONATE, LED, 1-FACE, 4-SECTION, MAST ARM MOUNTED	EACH 6
Δ	68040160	SIGNAL HEAD, POLYCARBONATE, LED, 1-FACE, 5-SECTION, MAST ARM MOUNTED	EACH 3
Δ	68040250	SIGNAL HEAD, POLYCARBONATE, LED, 2-FACE, 1-3-SECTION, 1-4-SECTION, BRACKET MOUNTED	EACH 2
Δ	68040280	SIGNAL HEAD, POLYCARBONATE, LED, 2-FACE, 1-4-SECTION, 1-5-SECTION, BRACKET MOUNTED	EACH 3
Δ	68102225	PEDESTRIAN SIGNAL HEAD POLYCARBONATE, LED, 1-FACE, BRACKET MOUNTED WITH COUNTDOWN TIMER	EACH 6
Δ	68200100	TRAFFIC SIGNAL BACKPLATE	EACH 20
Δ	68300100	PEDESTRIAN PUSH-BUTTON	EACH 6
Δ	68300100	TEMPORARY TRAFFIC SIGNAL INSTALLATION	EACH 1
Δ	68300100	RELOCATE EXISTING SIGNAL HEAD	EACH 9
Δ	68301150	RELOCATE EXISTING TRAFFIC SIGNAL POST	EACH 1
Δ	68302385	REMOVE EXISTING CONCRETE FOUNDATION	EACH 6
Δ *	X0321973	MODIFY EXISTING SERVICE INSTALLATION	EACH 1
Δ *	X0322281	WIDE AREA VIDEO DETECTION SYSTEM COMPLETE	EACH 2
Δ *	X0325258	ETHERNET SWITCH	EACH 2
Δ *	X0327098	LED INTERNALLY ILLUMINATED STREET NAME SIGN	EACH 0
*	X0327979	PAVEMENT MARKING REMOVAL - GRINDING	SQ. FT. 8437
Δ *	X1200139	REMOVAL OF LIGHTING LUMINAIRE, SALVAGE	EACH 6
Δ *	X1490008	FIBER OPTIC CABLE IN CONDUIT, 12 FIBERS, SINGLE MODE	FOOT 1300
Δ *	X1490238	LUMINAIRE, LED, SPECIAL	EACH 6
*	X4400188	CONCRETE BARRIER REMOVAL (SPECIAL)	FOOT 393
*	X5060122	CONCRETE MEDIAN, TYPE SM-6.12 (SPECIAL)	SQ. FT. 7677
*	X7010218	TRAFFIC CONTROL AND PROTECTION, (SPECIAL)	LSUM 1
Δ *	X8980112	SERVICE INSTALLATION, TYPE A (MODIFIED)	EACH 1
Δ *	X8130110	JUNCTION BOX (SPECIAL)	EACH 13
Δ *	X8140115	HANDHOLE TO BE ADJUSTED	EACH 1
Δ *	X8360120	LIGHT POLE FOUNDATION, SPECIAL	EACH 4
Δ *	X8630104	CONTROLLER CABINET TYPE IV, SPECIAL	EACH 1
Δ *	X8770136	STEEL COMBINATION MAST ARM ASSEMBLY AND POLE 66 FT. (SPECIAL)	EACH 1
Δ *	X8770140	STEEL COMBINATION MAST ARM ASSEMBLY AND POLE 48 FT. (SPECIAL)	EACH 1
Δ *	X8770154	STEEL COMBINATION MAST ARM ASSEMBLY AND POLE 54 FT. (SPECIAL)	EACH 2
Δ *	XX005703	REMOVE EXISTING TRAFFIC SIGNAL EQUIPMENT, SPECIAL	LSUM 1
Δ *	XX008068	LUMINAIRE INSTALLATION, TYPE 1	EACH 10
Δ *	XX008069	LUMINAIRE INSTALLATION, TYPE 2	EACH 2
Δ *	Z0001110	GAS VALVE TO BE ADJUSTED	EACH 1
Δ	78100100	RAISED REFLECTIVE PAVEMENT MARKER	EACH 225
Δ	78300200	RAISED REFLECTIVE PAVEMENT MARKER REMOVAL	EACH 120

Δ SPECIALTY ITEMS

Phoenix Consulting Engineers, Ltd.
Professional Design Firm No. 184,005835
421 E. Main Street • Mahomet, IL 61853
Ph 217-586-1808 • Fax 217-586-6757



SUMMARY OF QUANTITIES
TILTON CORRIDOR IMPROVEMENTS
VILLAGE OF TILTON
VERMILION COUNTY, ILLINOIS

DRAWN BY: RLM	DATE: 2/23/17
DESIGN BY: MIA	DATE: 2/23/17
CHECKED BY: BWS	DATE: 2/23/17
APPROV BY: RJD	DATE: 2/23/17

REVISIONS	
NO.	DESCRIPTION
1	BY: BWS DATE: 2/23/17 REVISION COMMENTS
2	BY: BWS DATE: 2/23/17 REVISION COMMENTS

PROJECT NO.
14TIL009

PAVEMENT SCHEDULE																				
FROM STATION	TO STATION	31100100 SUB GRAN MAT A (TON)	31100300 SUB GRAN MAT A 4 (SQ YD)	35301400 PCC BSE CSE VAR DEPTH (SQ YD)	40600290 BIT MATLS TACK CT (POUND)	40600847 P LB MM IL- 9.5FG N90 (TON)	40600982 HMA SURF REM BUTT JT (SQ YD)	40600990 TEMPORARY RAMP (SQ YD)	40603545 P HMA SC "D" N90 (TON)	42000301 PCC PVMT 8 (JOINTED) (SQ YD)	42400300 PCC SIDEWALK 6 (SQ FT)	42400800 DETECT WARNING (SQ FT)	44300200 STRIP CRACK CONTROL (FOOT)	60603800 COMB CC&G TB6.12 (FOOT)	60604400 COMB CC&G TB6.18 (FOOT)	60605000 COMB CC&G TB6.24 (FOOT)	60605100 COMB CC&G TB6.24 (AEP) (FOOT)	63100169 TRAF BAR TERM T6 (EACH)	X6060102 CONC MED. TSM6.12 SPL (SQ FT)	
US 150 / IL RTE 1																				
3025+90.00	3033+35.63	320		737	10113	557	350	59	499		484		719			307	620			4188
3033+35.63	3041+70.00	765		1636	14024	709	977	47	692				1286			957	533	1		3349
RAMP ROAD																				
29+10.62	29+55.00		482							433							143			
30+45.00	30+89.86		530							491							114			
16TH STREET																				
30+25.55	30+65.00		188					48		186		15								
31+45.00	31.94.38		317					60		276							120			
LANE STREET																				
109+29.17	111+69.00		1008							717				427	122	309				40
TOTALS		1075	2524	2373	24137	1266	1327	213	1191	2103	484	15	2005	427	499	1574	1153	1		7577

PREPARED BY: MLN 11/14/16
CHECKED BY: BWS 10/16/17

REVISED 4/12/18

TEMPORARY PAVEMENT MARKING SCHEDULE					
FROM STATION	TO STATION	70300100 SHORT TERM PVT MK LINE 4 (FOOT)	70300150 SHORT TERM PVT MK REMOVALS (SQ FT)	70300220 TEMP PVT MK LINE 4 (FOOT)	70300260 TEMP PVT MK LINE 12 (FOOT)
ROUTE 1 STAGE 1					
3024+84.11	3042+76.80	144	48	11332	
ROUTE 1 STAGE 2					
3026+30.59	3042+76.80	429	143	10626	72
TOTALS		573	191	21958	72

PREPARED BY: MLN 11/14/16
CHECKED BY: BWS 1/9/17

REVISED 3/16/18

PAVEMENT MARKING SCHEDULE								
FROM STATION	TO STATION	78009000 MOD URETH PM LTR- SYM (SQ FT)	78009004 MOD URETH PM LINE 4 (FOOT)	78009012 MOD URETH PM LINE 12 (FOOT)	78009024 MOD URETH PM LINE 24 (FOOT)	78100100 RAISED REFL PAVT MKR (EACH)	78300200 RAISED REF PVT MK REM (EACH)	X0327979 PAVMT MRKG REM GRIND (SQ FT)
US 150 / IL RTE 1								
3025+90.00	3033+35.63	239	3797	45	61	83	50	4418
3033+35.63	3041+70.00	265	4990		60	130	70	4019
RAMP ROAD								
29+10.62	29+55.00	42	91		37			
30+45.00	30+89.86	31	130		47			
16TH STREET								
30+25.55	30+65.00				12			
31+45.00	31.94.38	16	10		32			
LANE STREET								
109+29.17	111+69.00		485			12		
TOTALS		593	9503	45	249	225	120	8437

PREPARED BY: MLN 11/16/16
CHECKED BY: BWS 10/17/17

REVISED 4/12/18

SIGN SCHEDULE												
FROM STATION	FROM OFFSET	TO STATION	TO OFFSET	TYPE	72000100 SIGN PANEL - TYPE 1 (SQ FT)	72400100 REMOV SIN PAN ASSY TA (EACH)	72400310 REMOVE SIGN PANEL TY 1 (SQ FT)	72400730 RELOC SIN PAN T3 (SQ FT)	72700100 STR STL SIN SUP BA (POUND)	72900200 METAL POST - TYPE B (FOOT)	73400100 CONC FOUNDATI ON (CU YD)	73700200 REM CONC FDN-GR MT (EACH)
US 150/IL RTE 1												
3032+95	41.08' RT			STREET SIGN		1						
3037+36	32.64' LT			LANE MERGING		1						
3038+33	41.89' RT			EXIT SIGN		1						
3038+73	50.48' RT	3038+73	67.48' RT	I-74 SIGN			120	450		2.0	2	
3038+88	209.14' RT			STOP SIGN AHEAD		1						
3039+22	207.39' LT			STOP SIGN AHEAD		1						
3039+83	47.97' LT			EXIT SIGN		1						
3039+88	336.35' RT			WRONG WAY		1						
3040+05	310.70' RT			WRONG WAY		1						
3040+13	35.00' RT			LANE MERGING		1						
3040+20	69.98' LT			SPEED SIGN		1						
3041+25	329.07' RT			WRONG WAY		1						
3041+27	367.03' RT			WRONG WAY		1						
3041+36	55.35' LT			STREET SIGN		1						
3041+61	331.38' RT			DO NOT ENTER		1						
3041+80	281.95' RT			FREEWAY ENTRANCE		1						
3041+85	372.776' RT			ONE WAY		1						
3042+07	332.98' RT			STOP SIGN		1						
3042+09	333.26' RT			KEEP RIGHT		1						
3042+11	214.94' RT			ROAD SIGN		1						
LANE STREET												
112+82	42.80' LT						10					
16TH STREET												
31+55	41.85' LT				6.25					13.5		
TOTALS					6	19	10	120	450	14	2	2

PREPARED BY: BWS 11/14/16
CHECKED BY: MLN 3/15/17

PAVEMENT REMOVAL SCHEDULE											
FROM STATION	TO STATION	44000100 PAVEMENT REMOVAL (SQ YD)	44000158 HMA SURF REM 2 1/4 (SQ YD)	44000200 DRIVEWAY PAVEMENT REMOVAL (SQ YD)	44000500 CURBS AND GUTTER REMOVAL (FOOT)	44000600 SIDEWALK REMOVAL (SQ FT)	44001980 CONCRETE BARRIER REMOVAL (FOOT)	44213200 SAW CUTS (FOOT)	63200310 GUARDRAIL REMOVAL (FOOT)	63302700 REM RE-E T 8 TERM T6 (EACH)	X4400198 CONCRETE BARRIER REM (FOOT)
US 150 / IL RTE 1											
3025+90.00	3033+35.63	314	1516	96	1049		147	1212	257		393
3033+35.63	3041+75.64	1512			1333		633	1725	315	1	
RAMP A		915									
RAMP B		1081									
RAMP C		522									
RAMP D		542									
16TH STREET											
30+25.55	30+65.00	196			45	490					
31+45.00	31.94.38	331			64						
LANE STREET											
109+29.17	111+69.00	668									
TOTALS		6291	1516	96	2491	490	780	2937	571	1	393

PREPARED BY: MLN 1/11/17
CHECKED BY: BWS 3/16/17

REVISED 4/12/18

Phoenix Consulting Engineers, Ltd.
 Professional Design Firm No. 184,005835
 421 E. Main Street • Mahomet, IL 61853
 Ph: 217-586-1803 • Fax: 217-586-6757

SCHEDULE OF QUANTITIES
 TILTON CORRIDOR IMPROVEMENTS
 VILLAGE OF TILTON
 VERMILION COUNTY, ILLINOIS

REVISIONS		NO.	DATE	BY	DESCRIPTION
1	10/27	BWS	10/27/17	BWS	DESIGN BY: MLN DATE: 2/23/17
2	11/21	BWS	11/21/17	BWS	DESIGN BY: MLN DATE: 2/23/17
3	3/19/18	BWS	3/19/18	BWS	CHECKED BY: BWS DATE: 2/23/17
4	4/12/18	BWS	4/12/18	BWS	CHECKED BY: BWS DATE: 2/23/17

PROJECT NO. 14TIL009

5

SHEET 5 OF 73

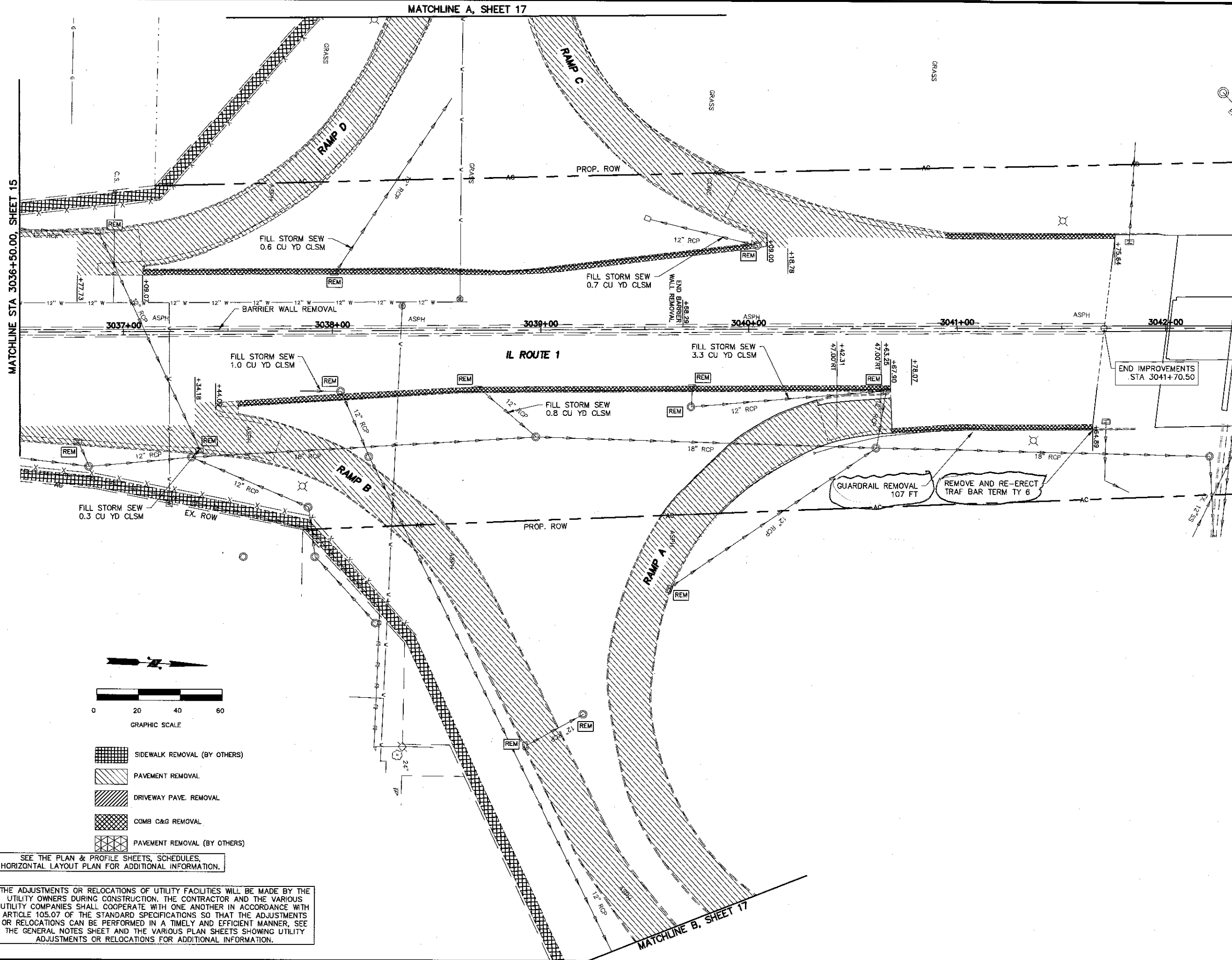

SEE THE PLAN & PROFILE SHEETS, SCHEDULES, HORIZONTAL LAYOUT PLAN FOR ADDITIONAL INFORMATION.

THE ADJUSTMENTS OR RELOCATIONS OF UTILITY FACILITIES WILL BE MADE BY THE UTILITY OWNERS DURING CONSTRUCTION. THE CONTRACTOR AND THE VARIOUS UTILITY COMPANIES SHALL COOPERATE WITH ONE ANOTHER IN ACCORDANCE WITH ARTICLE 105.07 OF THE STANDARD SPECIFICATIONS SO THAT THE ADJUSTMENTS OR RELOCATIONS CAN BE PERFORMED IN A TIMELY AND EFFICIENT MANNER. SEE THE GENERAL NOTES SHEET AND THE VARIOUS PLAN SHEETS SHOWING UTILITY ADJUSTMENTS OR RELOCATIONS FOR ADDITIONAL INFORMATION.

Phoenix Consulting Engineers, Ltd.
 Professional Design Firm No. 184-005835
 421 E. Main Street • Mahomet, IL 61853
 Ph 217-586-1803 • Fax 217-586-6757

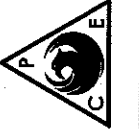

REMOVAL PLANS - ROUTE 1
 TILTON CORRIDOR IMPROVEMENTS
 VILLAGE OF TILTON
 VERMILION COUNTY, ILLINOIS

REVISIONS		
NO.	DATE	DESCRIPTION
1	3/15/18	BWS UTILITY ADJUSTMENT REVISION
1	3/15/18	BWS GUARDRAIL REMOVAL AND TY 6 R&R

PROJECT NO.
14TIL009

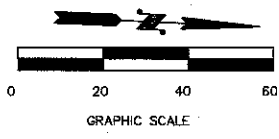

- 63
INLET TB T3 F&G
STA 3038+11.76
RIM = 639.87
INV = 632.62 (12" E (FIELD VERIFY))
- 64
INLET TA T3 F&G
STA 3038+14.29
RIM = 639.86
INV = 637.31 (12" W (FIELD VERIFY))
- 65
INLET TB T3 F&G
STA 3038+92.89
RIM = 639.85
INV = 633.16 (12" E (FIELD VERIFY))
- 66
INLET TA T3 F&G
STA 3039+77.14
RIM = 639.43
INV = 636.20 (12" N (FIELD VERIFY))
- 67
INLET TA T3 F&G
STA 3040+42.31
RIM = 639.21
INV = 635.58 (12" N (FIELD VERIFY))
- 68
INLET TB T3 F&G
STA 3040+63.25
RIM = 639.19
INV = 635.20 (12" S (FIELD VERIFY))
INV = 634.98 (12" E (FIELD VERIFY))
INV = 634.93 (12" W (FIELD VERIFY))

PCC BASE COURSE
 NON-SPECIAL WASTE DISPOSAL

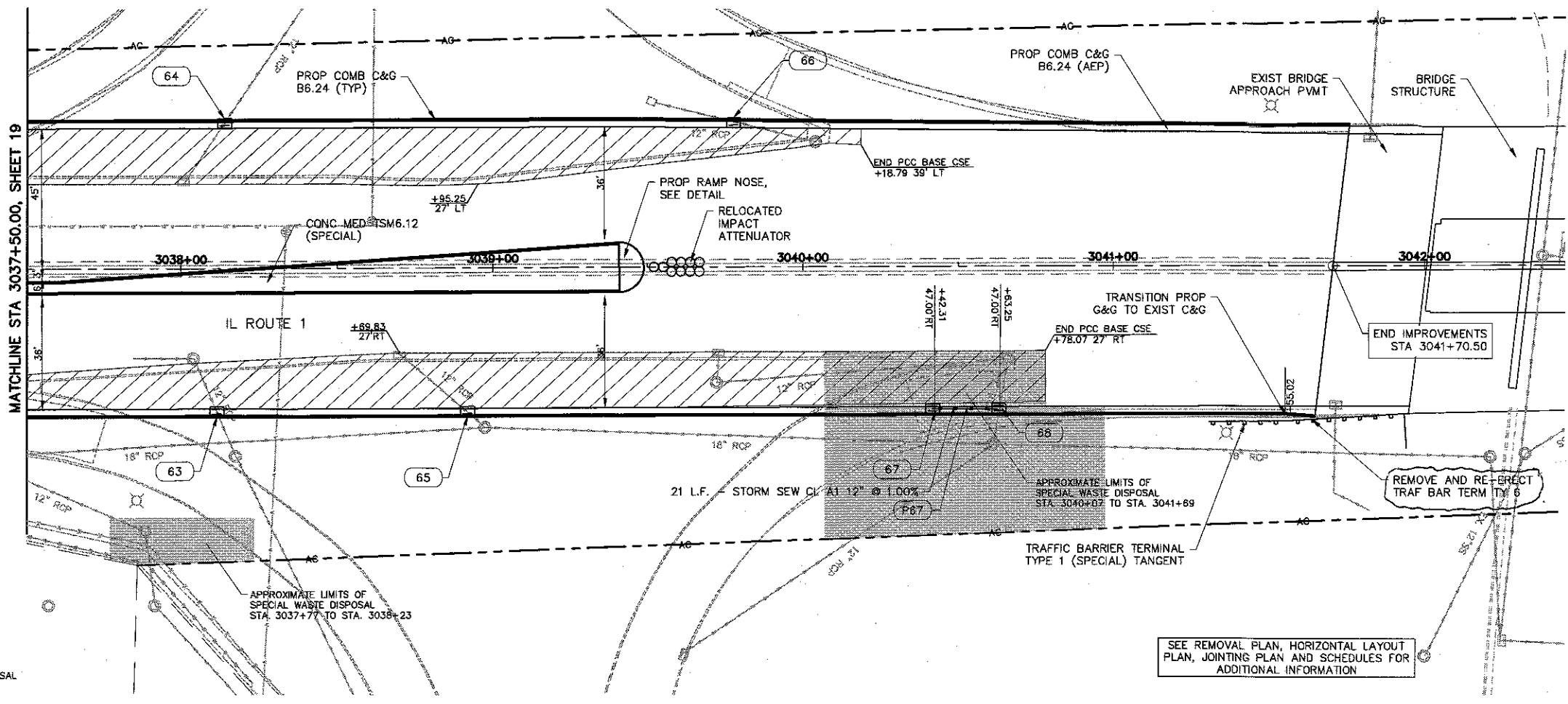

SEE REMOVAL PLAN, HORIZONTAL LAYOUT PLAN, JOINTING PLAN AND SCHEDULES FOR ADDITIONAL INFORMATION

THE LOCATION OF UTILITIES SHOWN ARE DETERMINED FROM THE BEST AVAILABLE DATA & ARE SHOWN FOR INFORMATION ONLY AND ARE NOT INTENDED TO ILLUSTRATE THE ACTUAL LOCATION OF SUCH UTILITIES. THE CONTRACTOR SHALL VERIFY THE LOCATION OF THE UTILITIES IN THE FIELD AT THE TIME OF CONSTRUCTION. THE CONTRACTOR SHALL BE RESPONSIBLE FOR PROTECTION ALL UTILITIES AND SHALL BE LIABLE FOR ANY DAMAGES TO THEM RESULTING FROM HIS OPERATIONS.

CONTRACTOR SHALL FIELD VERIFY PROPOSED RIM ELEVATIONS AND EXISTING INVERTS PRIOR TO CONSTRUCTION/CASTING OF PROPOSED MANHOLES & INLETS

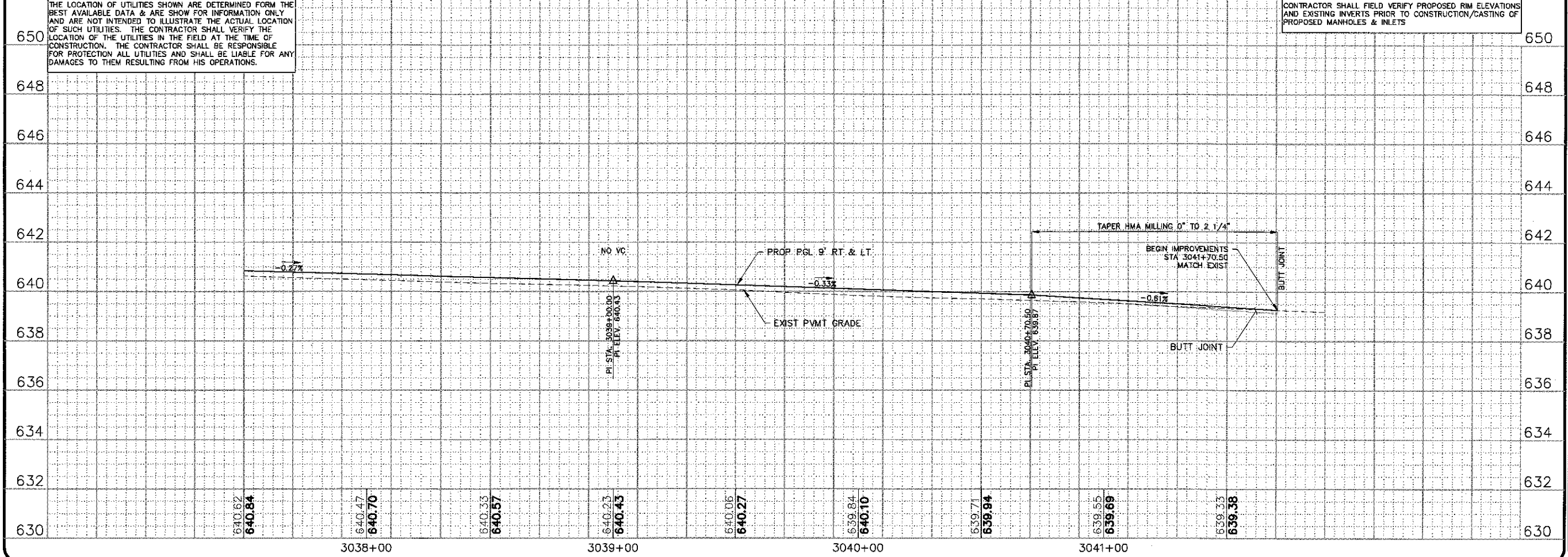

PLAN & PROFILE - IL RTE 1
 TILTON CORRIDOR IMPROVEMENTS
 VILLAGE OF TILTON
 VERMILION COUNTY, ILLINOIS

NO	DATE	BY	DESCRIPTION
1	4/12/16	BWS	ADD TRAFFIC BARRIER TERMINALS

PROJECT NO.
 14TIL009
 20
 SHEET 20 OF 73

Phoenix Consulting Engineers, Ltd.
 Professional Design Firm No. 184.005835
 421 E. Main Street • Mahomet, IL 61853
 Ph 217-586-1803 • Fax 217-586-6757



DRAWN BY: JDW
 DATE: 2/23/17
 DESIGN BY: JDW
 DATE: 2/23/17
 CHECKED BY: BWS
 DATE: 2/23/17
 APPVD BY: TLO
 DATE: 2/23/17