

CONTRACT NO.			
F.A. RTE.	SECTION	COUNTY	TOTAL SHEET NO.
530-N-2		COOK	53 20
STA. 100+00		TO STA. 111+54.3046	
FED. ROAD DIST. NO.		ILLINOIS FED. AID PROJECT	

CONTRACT NO. 60A61

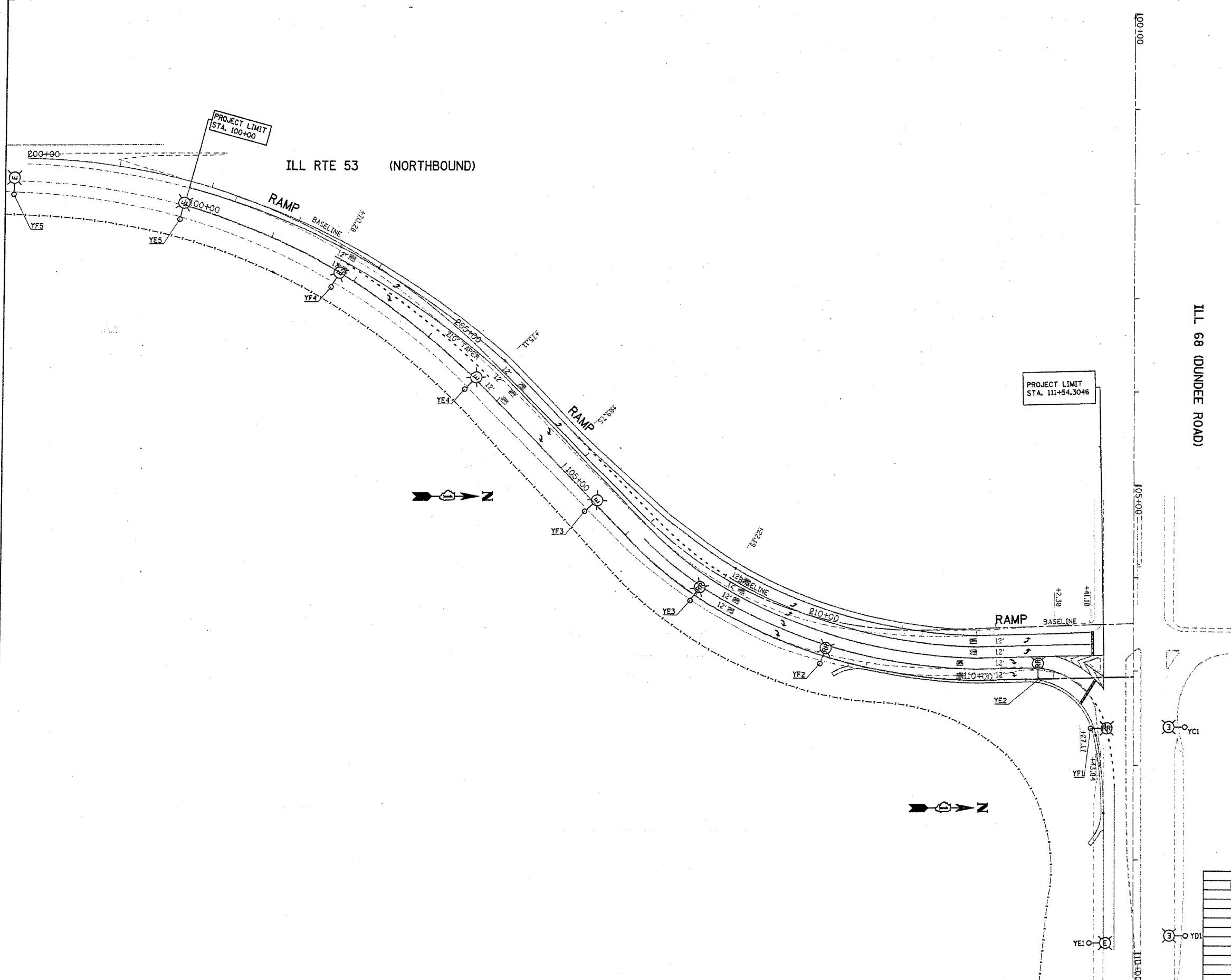

- RELOCATED EXISTING LIGHT POLE WITH LUMINAIRE, 47.5' POLE 12' MA, 400 W HPS
- GROUND ROD
- EXISTING LIGHT POLE
- 3-1/2" & 1-1/2" GND NEW 2" UNIT DUCT
- PUSHED RGS CONDUIT UNDER PAVED SURFACE SIZE AS SHOWN ON PLAN
- EXISTING LIGHTING UNIT TO BE REMOVED AND RELOCATED

PLOT DATE = 12/21/2005  
 PLOT SCALE = 1/4"=50'  
 USER NAME = ahrokkd

REVISIONS	
NAME	DATE

ILLINOIS DEPARTMENT OF TRANSPORTATION

EXISTING ROADWAY LIGHTING PLAN  
 IL-53 NORTH EXIT RAMP "C"  
 FOR IL. 68 (E&W)

SCALE: VERT. 1"=50'  
 HORIZ. DATE 12/21/2005

DRAWN BY CADD  
 CHECKED BY