

PROFILE SURVEYS
 PLOTTED
 GRADES CHECKED
 STRUCTURE NOTATIONS OK'D
 NO. _____ DATE _____

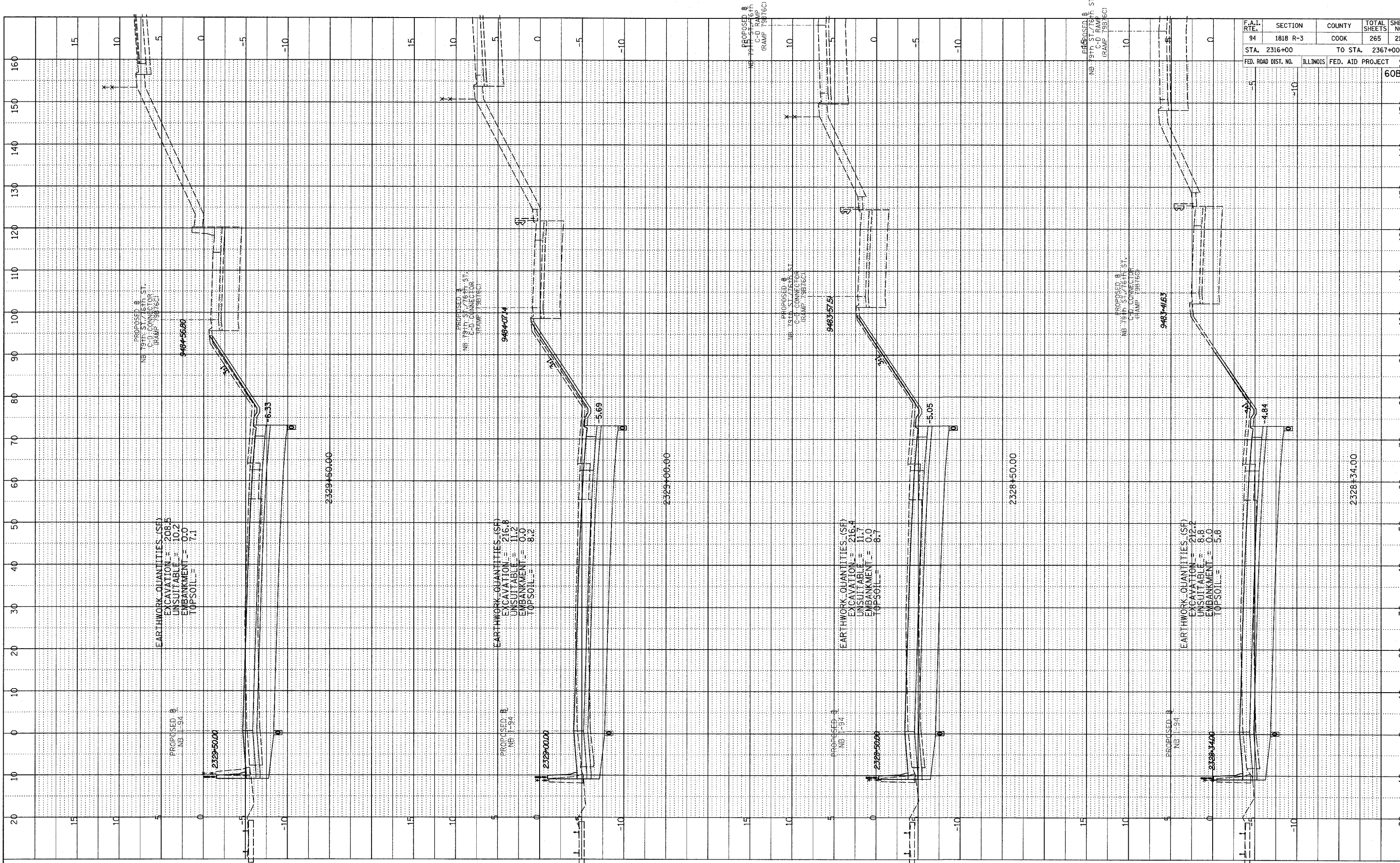

F.A.I. RTE.	SECTION	COUNTY	TOTAL SHEETS	SHEET NO.
94	1818 R-3	COOK	265	213
STA. 2316+00		TO STA. 2367+00		
FED. ROAD DIST. NO.		ILLINOIS FED. AID PROJECT		
		60BI7		

TYLIN INTERNATIONAL

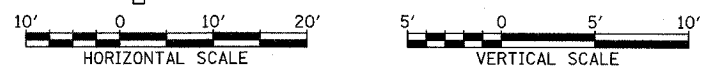

NORTHBOUND I-94 (DAN RYAN EXPWY)
 STA. 2329+00 TO STA. 2330+41

P:\023731\000\2006\0409\23\040923.DWG 04/09/23 PM