

PROFILE	DRAWN BY	DATE
NO.	BY	
NOTE BOOK	CHECKED	
NO.	BY	
NO.	BY	
NO.	BY	

F.A.I. RTE.	SECTION	COUNTY	TOTAL SHEETS	SHEET NO.
94	1818 R-3	COOK	265	222
STA. 2316+00	TO STA. 2367+00			
FED. ROAD DIST. NO.	ILLINOIS FED. AID PROJECT		60B77	

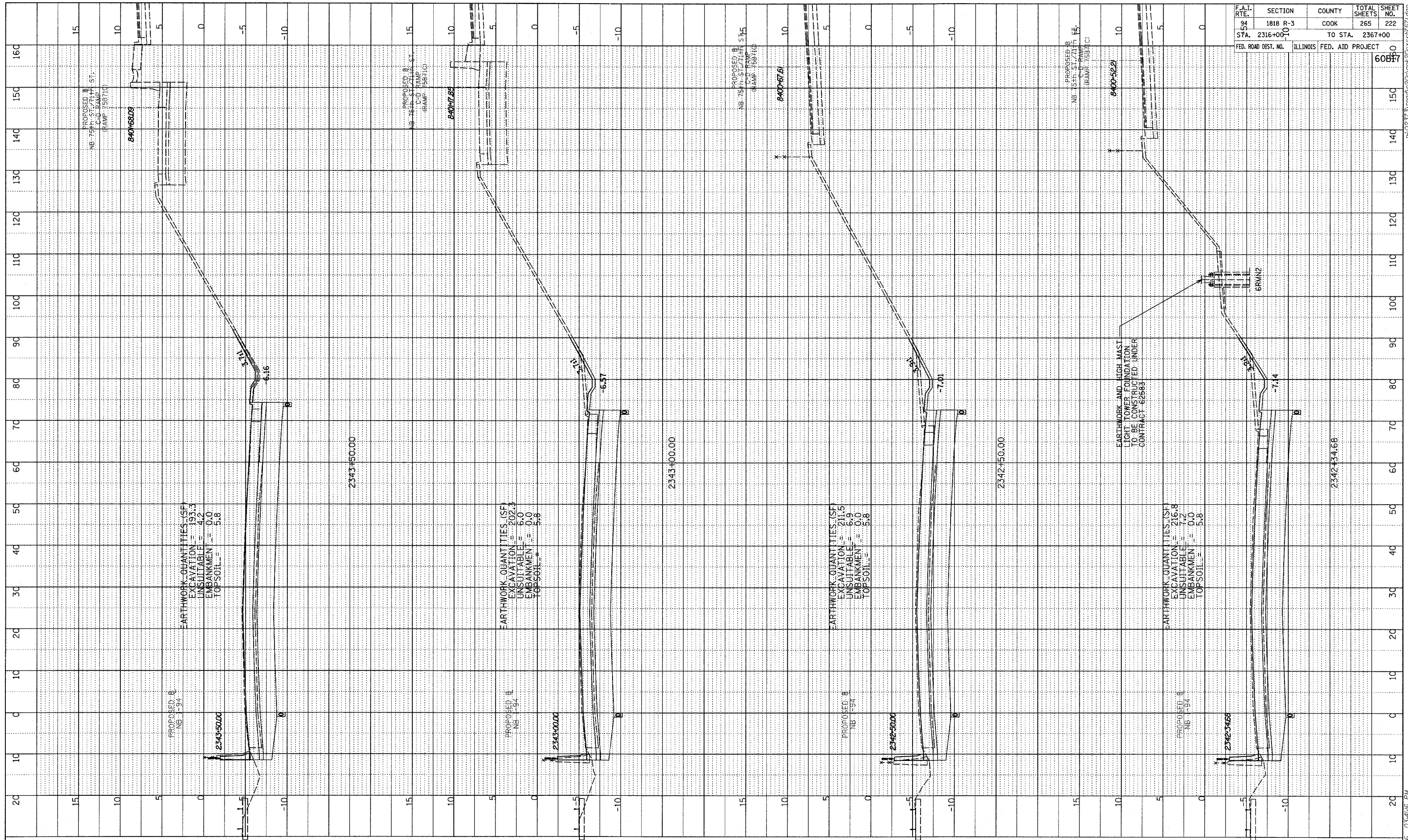

TYLIN INTERNATIONAL

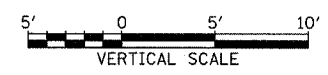
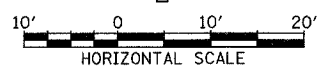

NORTHBOUND I-94 (DAN RYAN EXPWY)
STA. 2342+50 TO STA. 2344+00

03/03/2006 03:41:16 PM