

EXISTING CONDITIONS
PROPOSED IMPROVEMENTS

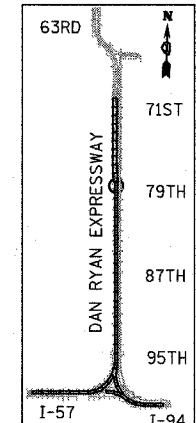
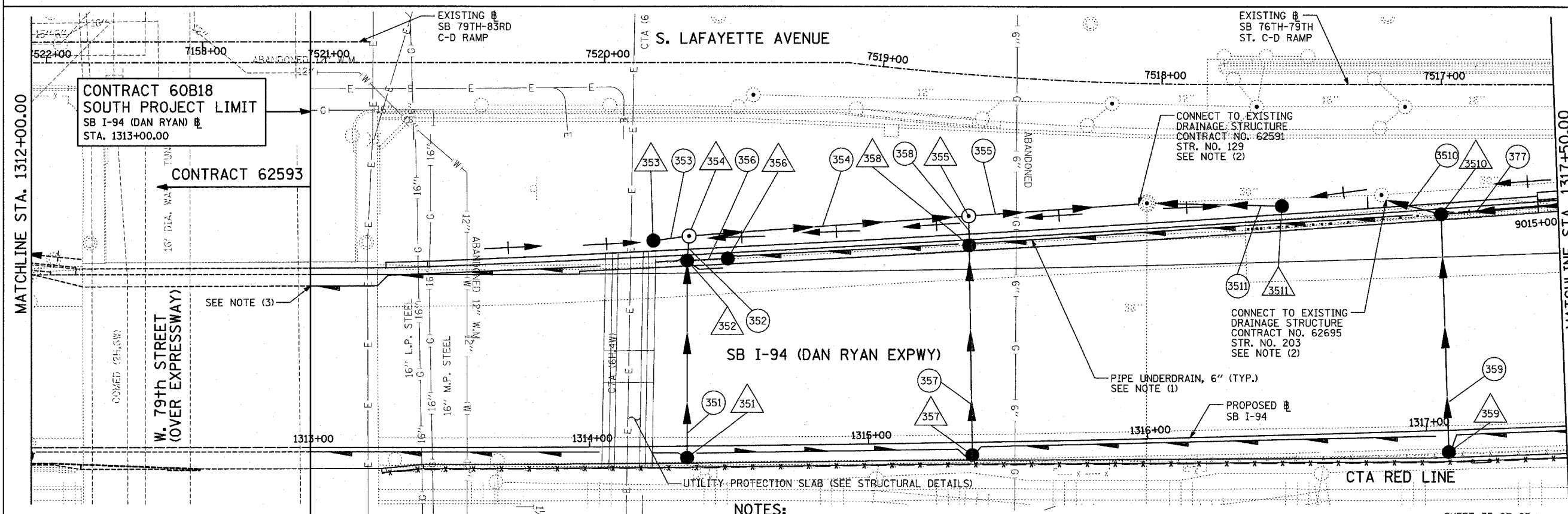

LOCATION MAP

NOTES:

- FOR CLARITY, PIPE UNDERDRAINS ARE SHOWN OFFSET FROM THEIR PROPOSED LOCATIONS. FOR DETAILED PLACEMENT, SEE SHEET "PIPE UNDERDRAINS DETAIL."
- CORE DRILL AND CONNECT TO EXISTING DRAINAGE STRUCTURE. CONNECTION COST SHALL BE INCLUDED IN THE COST TO CONSTRUCT THE STORM SEWER.
- PROPOSED PIPE UNDERDRAIN SYSTEM LOCATION SHALL BE COORDINATED WITH PROPOSED ELECTRICAL DUCT BANK AND EXISTING FOOTING. SEE TYPICAL SECTIONS AND DETAILS FOR OVERPASS FOOTING. COORDINATION WITH CONTRACT 62593 IS REQUIRED FOR PIPE UNDERDRAIN INSTALLATION TO ENSURE CONTINUOUS FLOW.

LEGEND:

- EXISTING COMBINED SEWER
- PROPOSED STORM SEWER NUMBER (X=SHEET NO., Y=PIPE NO.)
- PROPOSED STRUCTURE NUMBER (X=SHEET NO., Y=STRUCTURE NO.)
- PIPE STUBOUT TO BE PLUGGED
- S P SEWER PLUG
- F.V. FIELD VERIFY
- UTILITY REMOVAL

SHEET 35 OF 65

REVISIONS	
NAME	DATE

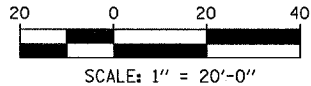

ILLINOIS DEPARTMENT OF TRANSPORTATION
F.A.I. 94 (DAN RYAN EXPRESSWAY)
DRAINAGE AND UTILITY PLAN
SB I-94 (DAN RYAN EXPRESSWAY)
SB I-94 STA. 1312+00.00 TO 1317+50.00
SCALE: 1"=20'
DATE: MARCH 1, 2006
DRAWN BY: NSB
CHECKED BY: DA