

DATE: _____
 BT
 PROFILE SURVEYED _____
 PLOTTED & CHECKED _____
 NOTE BOOK _____
 NO. _____
 STRUCTURE NOTATION: CHRD

F.A.I. RTE. 94	SECTION 1818 R-6	COUNTY COOK	TOTAL SHEETS 290	SHEET NO. 236
STA. 1313+00	TO STA. 1367+00			
FED. ROAD DIST. NO.	ILLINOIS	FED. AID PROJECT	60B18	

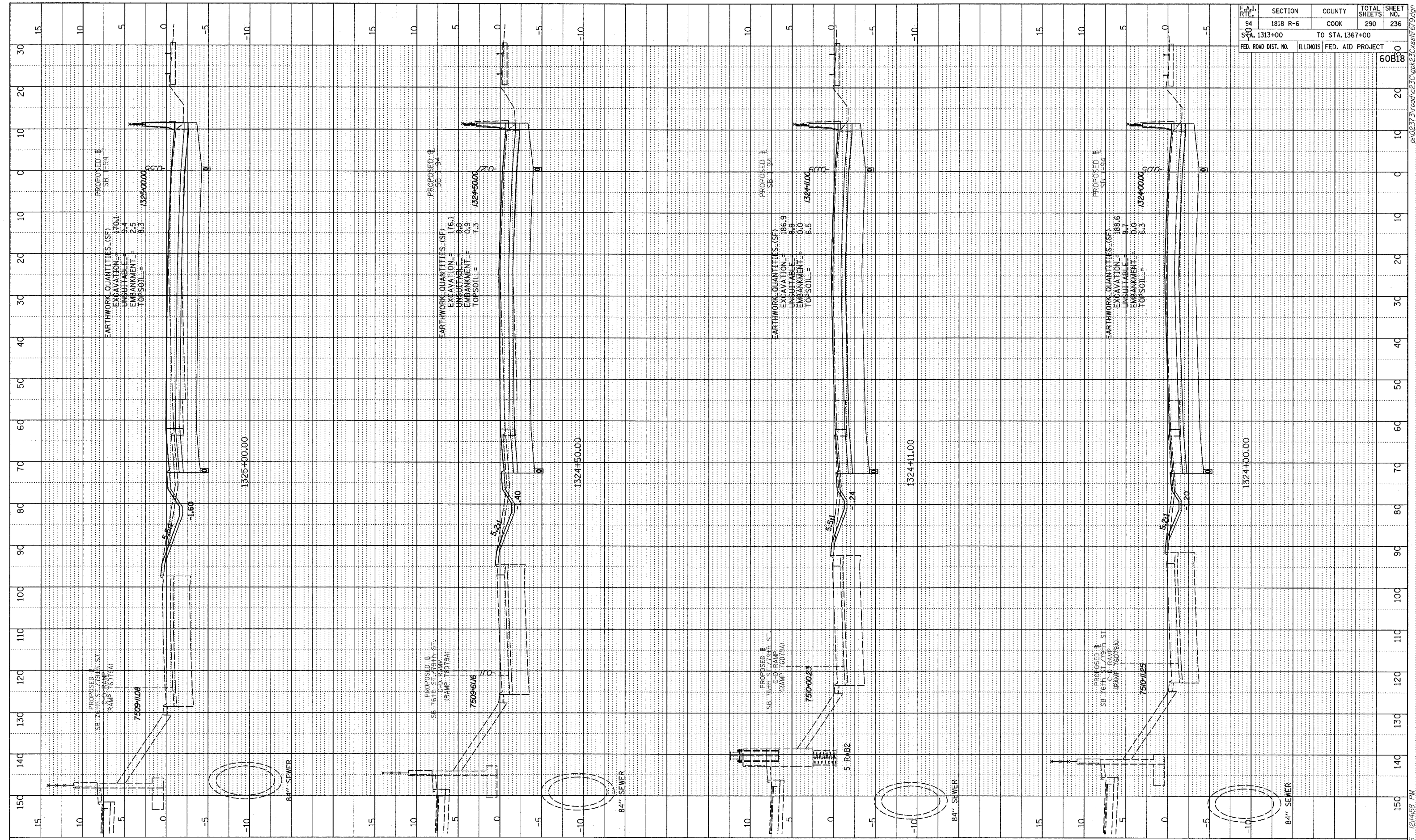

TYLIN INTERNATIONAL

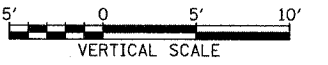
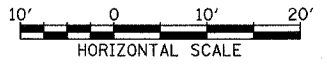

I-94 SOUTHBOUND (DAN RYAN EXPWY)
 STA. 1324+00 TO STA. 1325+00

02/27/2006 12:45:58 PM