

PROF. ILL  
 SURVEYED  
 GRADES CHECKED  
 E.M. NOTED  
 STRUCTURE NOTATIONS COR'D  
 NO.

SECTION	COUNTY	TOTAL SHEETS	SHEET NO.
1818 R-6	COOK	290	257
STATION 1313+00 TO STA. 1367+00			
FED. ROAD DIST. NO.		ILLINOIS FED. AID PROJECT	

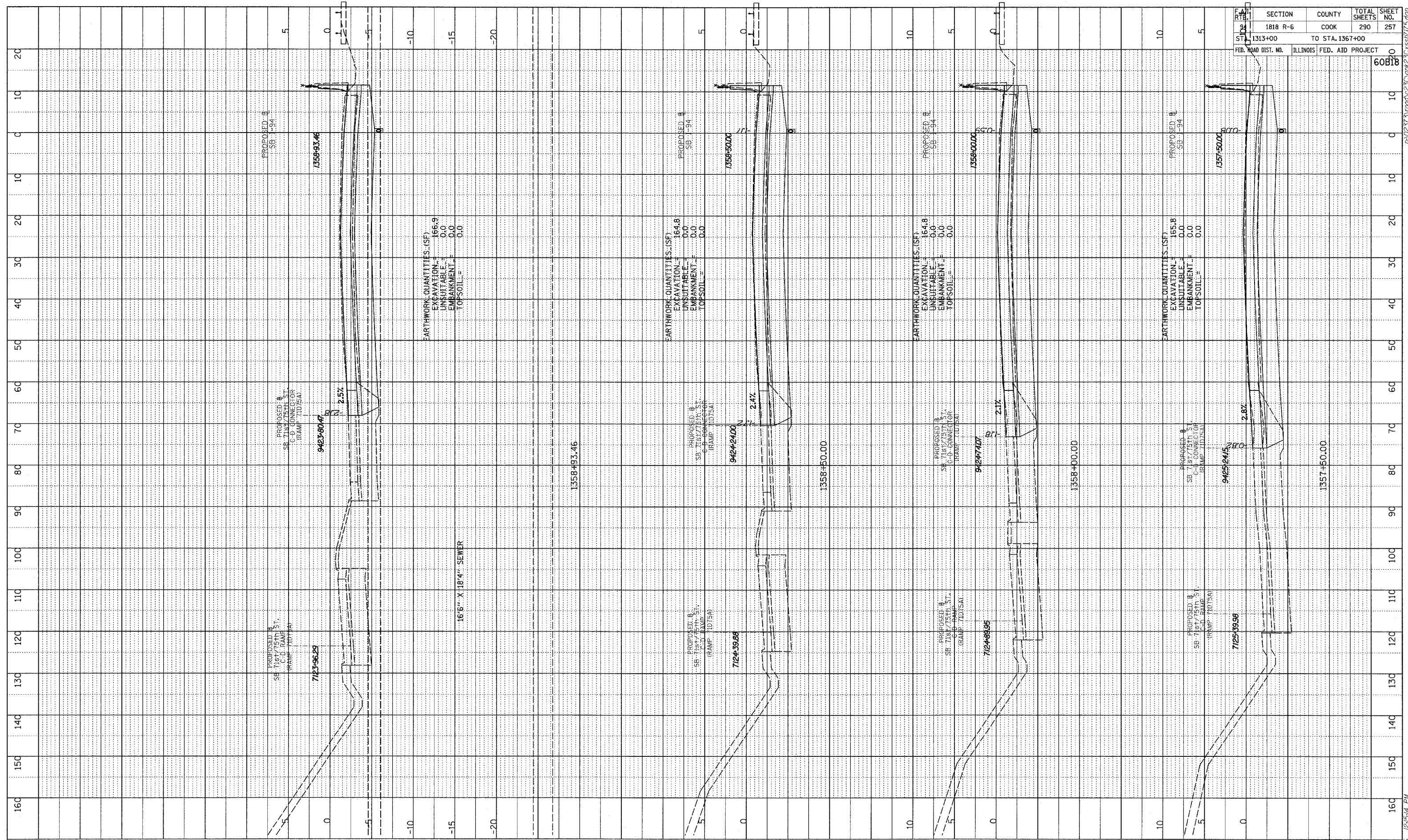

TYLIN INTERNATIONAL

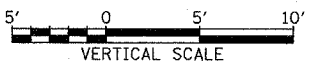
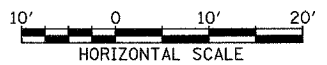

I-94 SOUTHBOUND (DAN RYAN EXPWY)  
 STA. 1357+50 TO STA. 1358+93.46

02/27/2006 12:54 PM