

PROFILE SUBMITTED
 PLOTTED & REVISIONS
 DATE NOTED
 NO. STRUCTURE NOTATIONS CHD

F.A.I. RTE.	SECTION	COUNTY	TOTAL SHEETS	SHEET NO.
94	1818 R-6	COOK	290	262
STA. 1313+00 TO STA. 1367+00		ILLINOIS FED. AID PROJECT		
FED. ROAD DIST. NO.		60B18		

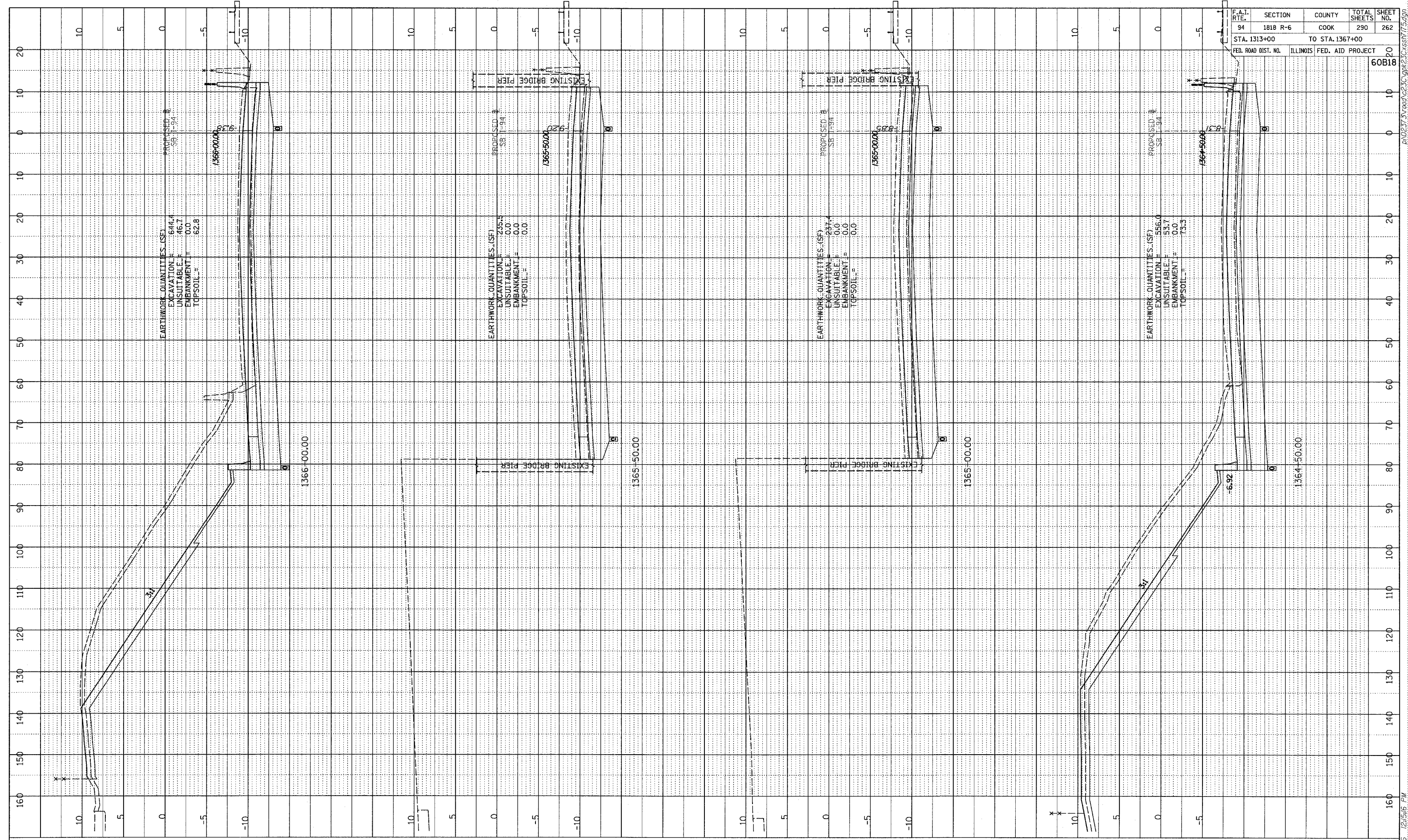

TYLIN INTERNATIONAL

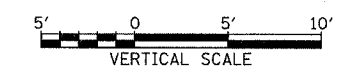
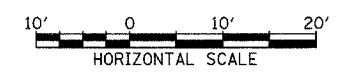

I-94 SOUTHBOUND (DAN RYAN EXPWY)
STA. 1364+50 TO STA. 1366+00

02/27/2006 12:56 PM P:\0237\3\road\262\c\p\230\ss\175.dgn