

F.A.I. RTE.	SECTION	COUNTY	TOTAL SHEETS	SHEET NO.
94		COOK	916	68
STA. 190+65 (NB I-57) TO STA. 199+48 (NB FORD)		TO STA. 2316+00 (NB RYAN)		
FED. ROAD DIST. NO.		ILLINOIS		FED. AID PROJECT
		(1516.1, 1717, & 1818) R-4		6230

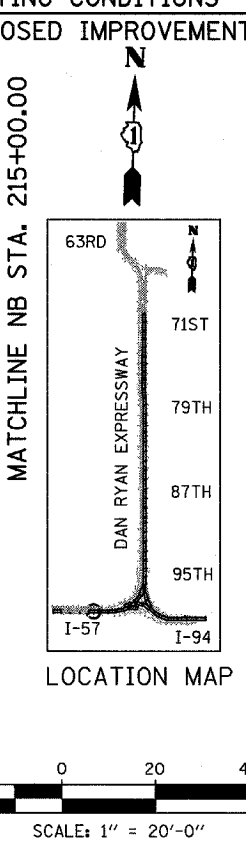
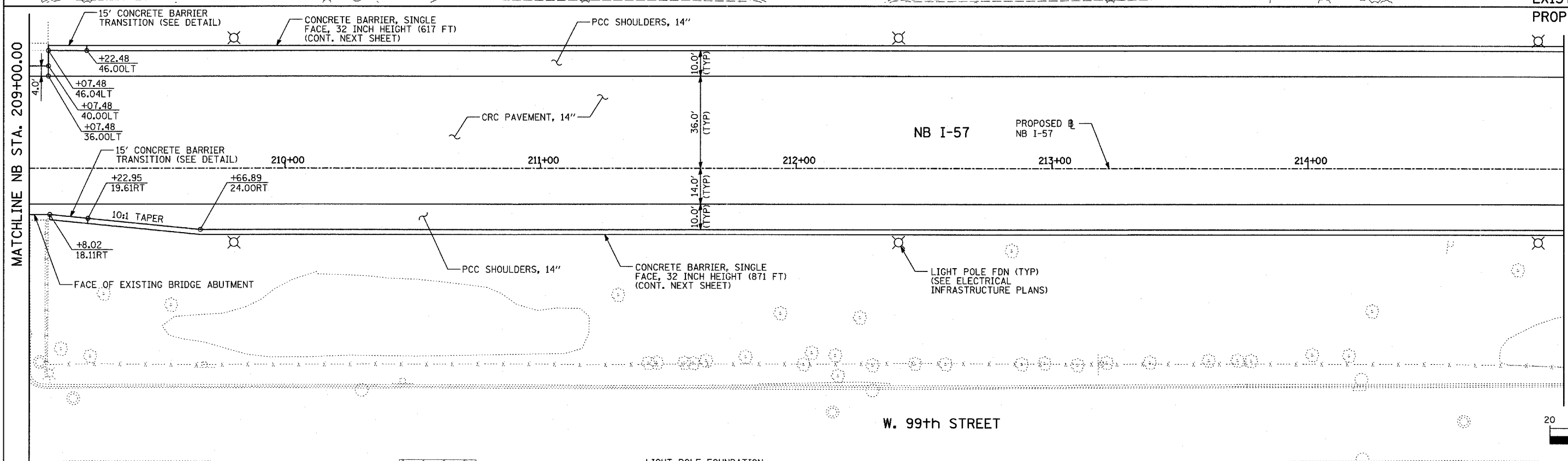
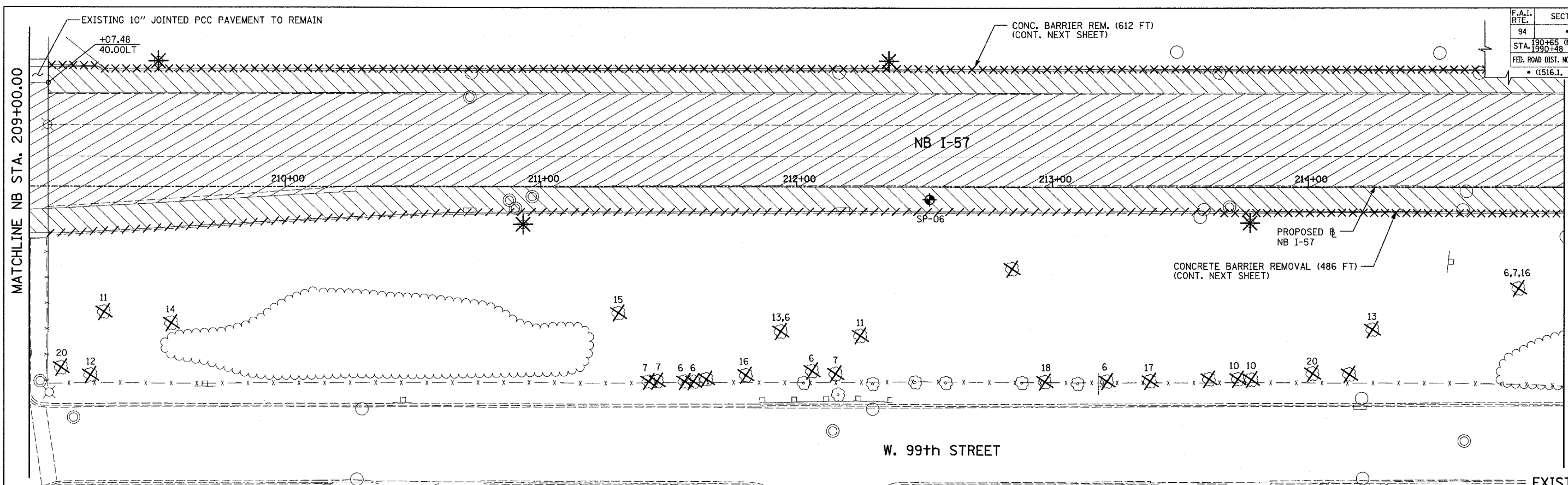

LEGEND:

	COMB CONC CURB & GUTTER REMOVAL		PAVEMENT REMOVAL		LIGHT POLE FOUNDATION REMOVAL (SEE ROADWAY LIGHTING & SURVEILLANCE PLANS)
	CHAIN LINK FENCE REMOVAL		PAVED SHOULDER REMOVAL		+XX.XX MAINLINE #
	CONCRETE BARRIER/GUARDRAIL REMOVAL		PAVEMENT/SHOULDER REMOVAL, SPECIAL		XX.XXRT STATION/OFFSET
	TREE REMOVAL (UNITS) (NO UNIT SHOWN = 6)		BITUMINOUS SURFACE REMOVAL, 4"	PLAN NOTES:	
	SOIL BORING LOCATIONS		BITUMINOUS SURFACE REMOVAL, 1 1/2" OR 1 3/4" (SEE CALLOUT)	- ALL STATION/OFFSET/RADIUS CALLOUTS MEASURED TO EDGE OF PAVEMENT UNLESS OTHERWISE NOTED.	
				- EXACT LOCATIONS OF EXISTING PIERS/ABUTMENTS TO BE FIELD VERIFIED	

TYLIN INTERNATIONAL

SHEET 5 OF 47

REVISIONS	
NAME	DATE

ILLINOIS DEPARTMENT OF TRANSPORTATION
 F.A.I. 94 (DAN RYAN EXPRESSWAY)
 EXISTING AND PROPOSED PLAN
 NB I-57
 NB I-57 STA. 209+00.00 TO 215+00.00

SCALE: 1"=20'
 DATE: MARCH 7, 2006

DRAWN BY: RTM
 CHECKED BY: MPG