

PA 02/23/06 3:33:53 PM

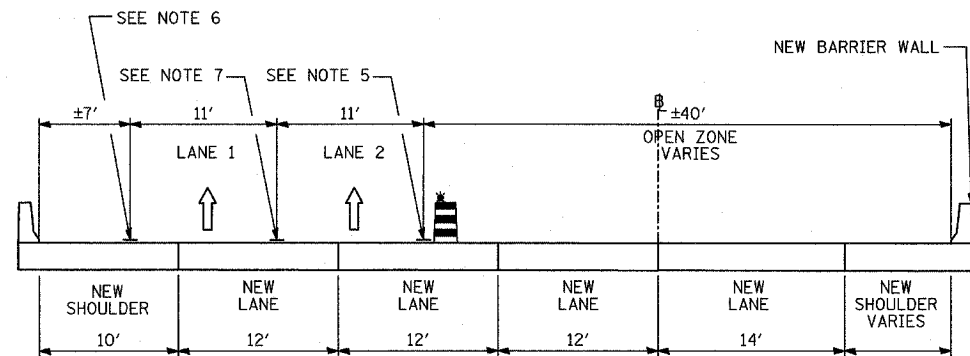

**SS-SS**

STAGE 3A: NB I-57; STA. 209+07 TO STA. 218+71

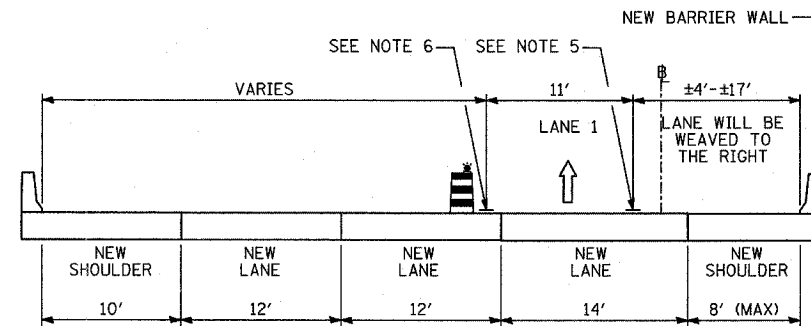

**VV-VV**

STAGE 3A: NB I-57; STA. 233+00 TO STA. 235+68  
STAGE 3A: NB I-57; STA. 240+96 TO STA. 247+28

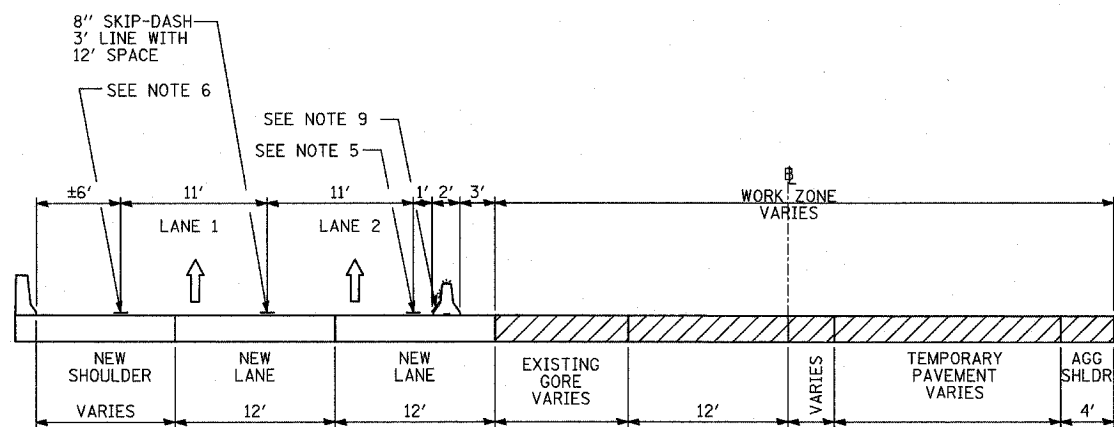

**TT-TT**

STAGE 3A: NB I-57; STA. 219+18 TO STA. 222+68

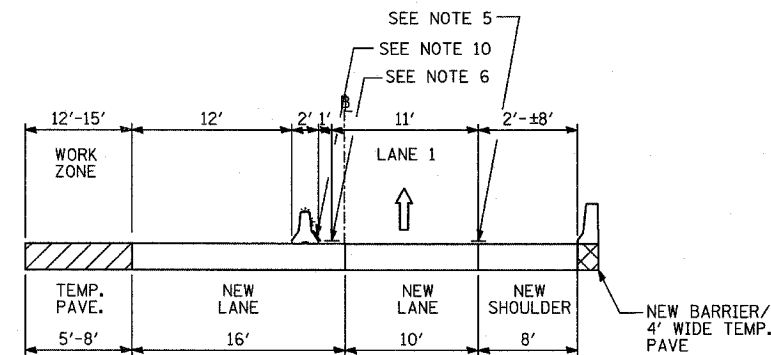

**WW-WW**

STAGE 3A: WB CONNECTOR; STA. 330+65 TO STA. 340+29

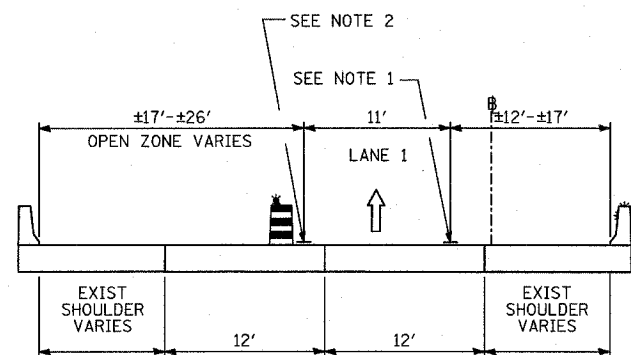

**UU-UU**

STAGE 3A: WB CONNECTOR; STA. 324+70 TO STA. 329+67

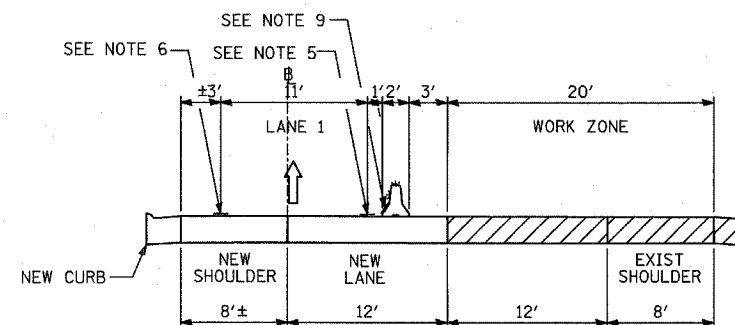

**XX-XX**

STAGE 3A: EB CONNECTOR; STA. 408+41 TO STA. 415+06

- NOTE 1 - EPOXY PAVEMENT MARKING-LINE 4" (WHITE)
- NOTE 2 - EPOXY PAVEMENT MARKING-LINE 4" (YELLOW)
- NOTE 3 - EPOXY PAVEMENT MARKING-SKIP-DASH 5" (WHITE), 10' LINE WITH 30' SPACE
- NOTE 4 - EPOXY PAVEMENT MARKING LINE 8" (WHITE)
- NOTE 5 - PAVEMENT MARKING TAPE, TYPE III 4" LINE (WHITE)
- NOTE 6 - PAVEMENT MARKING TAPE, TYPE III 4" LINE (YELLOW)
- NOTE 7 - PAVEMENT MARKING TAPE, TYPE III 5" SKIP-DASH (WHITE), 10' LINE WITH 30' SPACE
- NOTE 8 - PAVEMENT MARKING TAPE, TYPE III 8" LINE (WHITE)
- NOTE 9 - TEMPORARY PAVEMENT MARKING-LINE 6" (WHITE)
- NOTE 10 - TEMPORARY PAVEMENT MARKING-LINE 6" (YELLOW)

**LEGEND:**

- TEMPORARY CONCRETE BARRIER (WITH REFLECTORS ON TOP AND SIDE FACING TRAFFIC)
- TRAFFIC MOVEMENT
- DRUM WITH MONO-DIRECTIONAL STEADY BURNING LIGHT
- SINGLE-FACE CONCRETE BARRIER, 32"
- SINGLE-FACE CONCRETE BARRIER, 32" (WITH REFLECTORS ON TOP AND SIDE FACING TRAFFIC)
- PAVEMENT REMOVAL AREA
- TEMPORARY PAVEMENT

\* ALL NOT TYPICAL SECTIONS ARE DRAWN IN THE DIRECTION OF TRAFFIC

REVISIONS	
NAME	DATE

ILLINOIS DEPARTMENT OF TRANSPORTATION  
F.A.I. 94 (DAN RYAN EXPRESSWAY)  
GENERAL NOTES  
CONSTRUCTION STAGING NOTES  
MAINTENANCE OF TRAFFIC DETAILS  
SHEET 10 OF 13

SCALE: NO SCALE DRAWN BY: RTM  
DATE: MARCH 7, 2006 CHECKED BY: TGB