

EXISTING CONDITIONS  
 PROPOSED IMPROVEMENTS

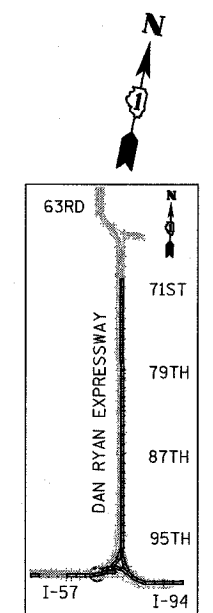

LOCATION MAP

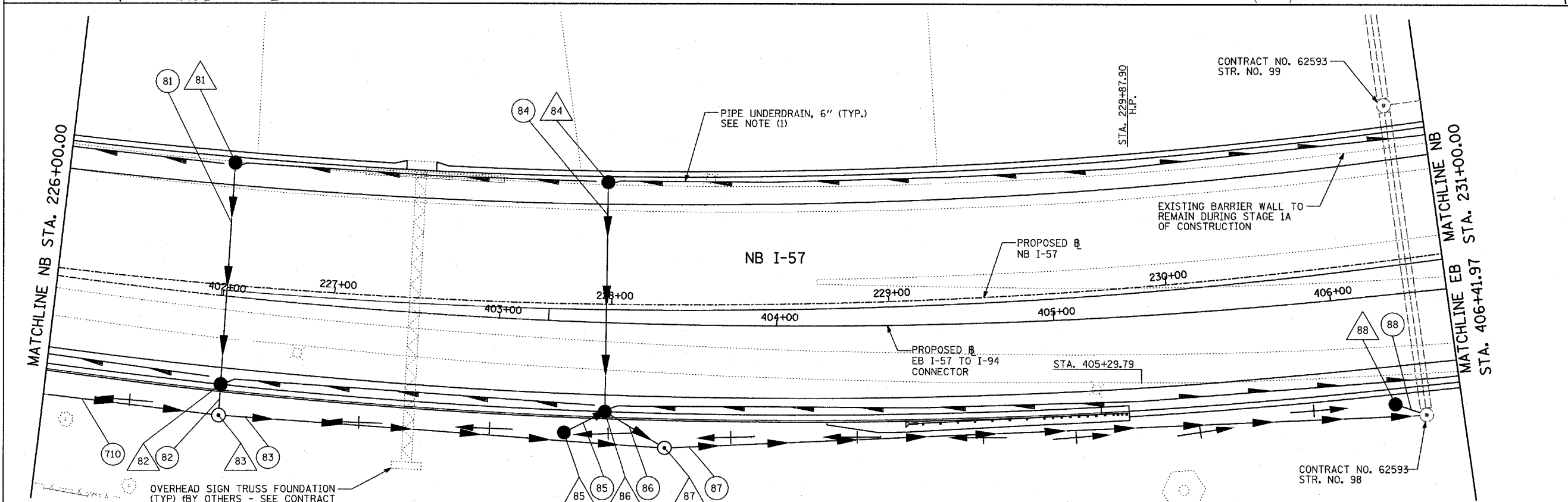
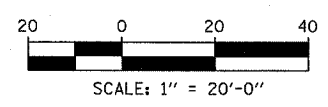

**LEGEND:**

- EXISTING COMBINED SEWER
- (XY) PROPOSED STORM SEWER NUMBER (X=SHEET NO., Y=PIPE NO.)
- (XY) PROPOSED STRUCTURE NUMBER (X=SHEET NO., Y=STRUCTURE NO.)
- |— PIPE STUBOUT TO BE PLUGGED
- P SEWER PLUG
- F.V. FIELD VERIFY
- ////// UTILITY REMOVAL
- PROPOSED CATCH BASIN CONSTRUCTED IN CONCURRENT CONTRACT 62593
- PROPOSED STORM SEWER CONSTRUCTED IN CONCURRENT CONTRACT 62593

**NOTES:**

- FOR CLARITY, PIPE UNDERDRAINS ARE SHOWN OFFSET FROM THEIR PROPOSED LOCATIONS. FOR DETAILED PLACEMENT, SEE SHEET "PIPE UNDERDRAINS DETAIL."
- COORDINATION BETWEEN CONTRACTS FOR RESTORATION, EROSION CONTROL AND ACCESS IS REQUIRED WHEN JACKING PITS OCCUR ON CURRENT CONTRACT SIDE.

REVISIONS	
NAME	DATE

ILLINOIS DEPARTMENT OF TRANSPORTATION  
 F.A.I. 94 (DAN RYAN EXPRESSWAY)  
 DRAINAGE AND UTILITY PLAN  
 NB I-57 MAINLINE AND EB I-57 TO I-94 CONNECTOR  
 NB I-57 STA. 226+00.00 TO 231+00.00 AND EB STA. 406+50.00

SCALE: 1"=20'  
 DATE: MARCH 7, 2006

DRAWN BY: MB  
 CHECKED BY: DA

TYLIN INTERNATIONAL