

F.A.I. RTE.	SECTION	COUNTY	TOTAL SHEETS	SHEET NO.
94	*	COOK	916	500
STA. 217+92		TO STA. 231+50		
FED. ROAD DIST. NO.	ILLINOIS FED. AID PROJECT			
* (1516.1, 1717, & 1818) R-4		62304		

NOTES:
 1. REFER TO SHEETS EI-102 AND EI-103 FOR DUCTBANK INSTALLATION DETAILS.

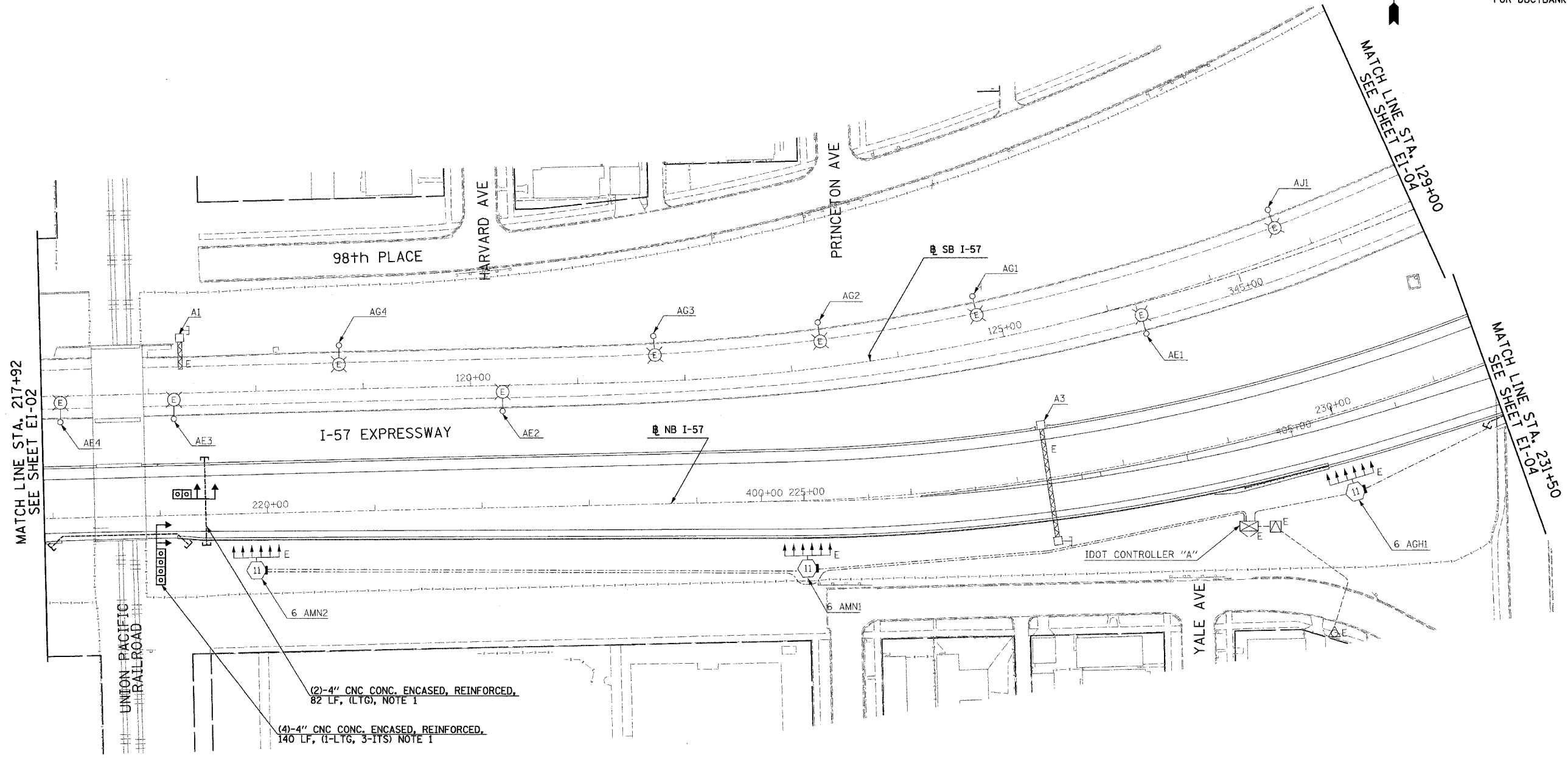

(2)-4" CNC CONC. ENCASED, REINFORCED,
 82 LF, (1-LTG), NOTE 1

(4)-4" CNC CONC. ENCASED, REINFORCED,
 140 LF, (1-LTG, 3-ITS) NOTE 1

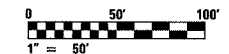

20/EI-03

SINGH
 SINGH & ASSOCIATES, INC.
 CONSULTING ENGINEERS

300 W. ADAMS ST.
 CHICAGO, IL 60606
 TEL: (312) 629-0240
 FAX: (312) 629-8449

REVISIONS	
NAME	DATE

ILLINOIS DEPARTMENT OF TRANSPORTATION
 F.A.I. 94 (DAN RYAN EXPRESSWAY)

ELECTRICAL INFRASTRUCTURE PLANS
 PROPOSED IMPROVEMENTS
 STA. 217+92 TO STA. 231+50

SCALE: 1"=50' DRAWN BY: VK
 DATE: MARCH 7, 2006 CHECKED BY: TM

3/2/2006 12:15:52 PM