

PROFILE SURVEYED
 NOTE BOOK GRADES CHECKED
 NO. B.M. NOTED
 STRUCTURE NOTATIONS SHOWN
 BY: _____ DATE: _____

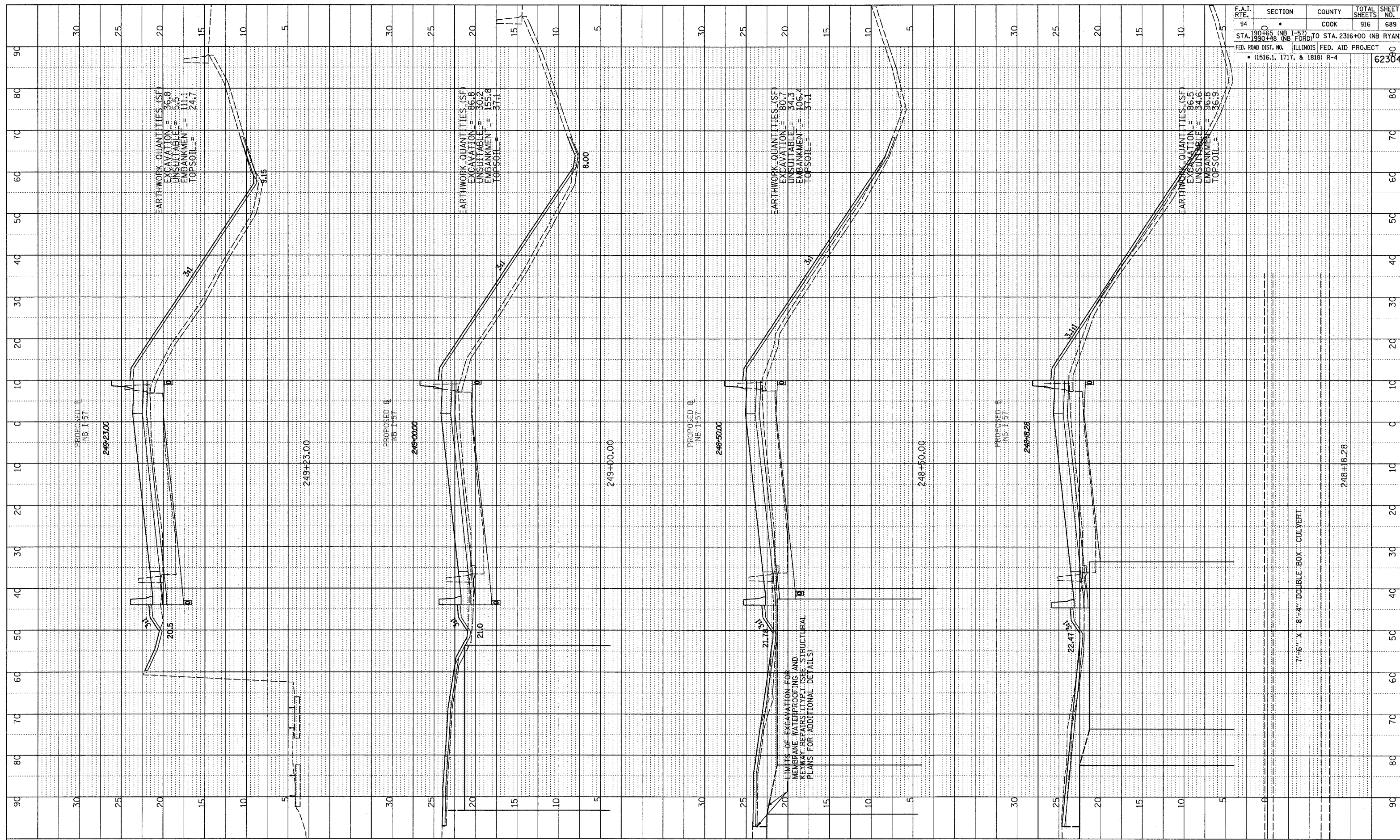

F.A.I. RTE.	SECTION	COUNTY	TOTAL SHEETS	SHEET NO.
94	190+95 (NB I-57) TO STA. 2316+00 (NB RYAN)	COOK	916	689
STA. 190+95 (NB I-57) TO STA. 2316+00 (NB RYAN) STA. 190+95 (NB I-57) TO STA. 2316+00 (NB RYAN) FED. ROAD DIST. NO. ILLINOIS FED. AID PROJECT • (1516.1, 1717, & 1818) R-4				
				62304

TYLIN INTERNATIONAL

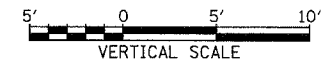

NORTHBOUND I-57
 STA. 248+18.28 TO STA. 249+23

03/03/2006 04:02:42 PM P:\0237\road\2006\20060303\20060303.dgn