

PROFILE
 SURVEYED
 PLOTTED
 GRADES CHECKED
 NOTE BOOK
 STRUCTURE NOTATIONS CHKD
 NO. _____
 BY _____
 DATE _____

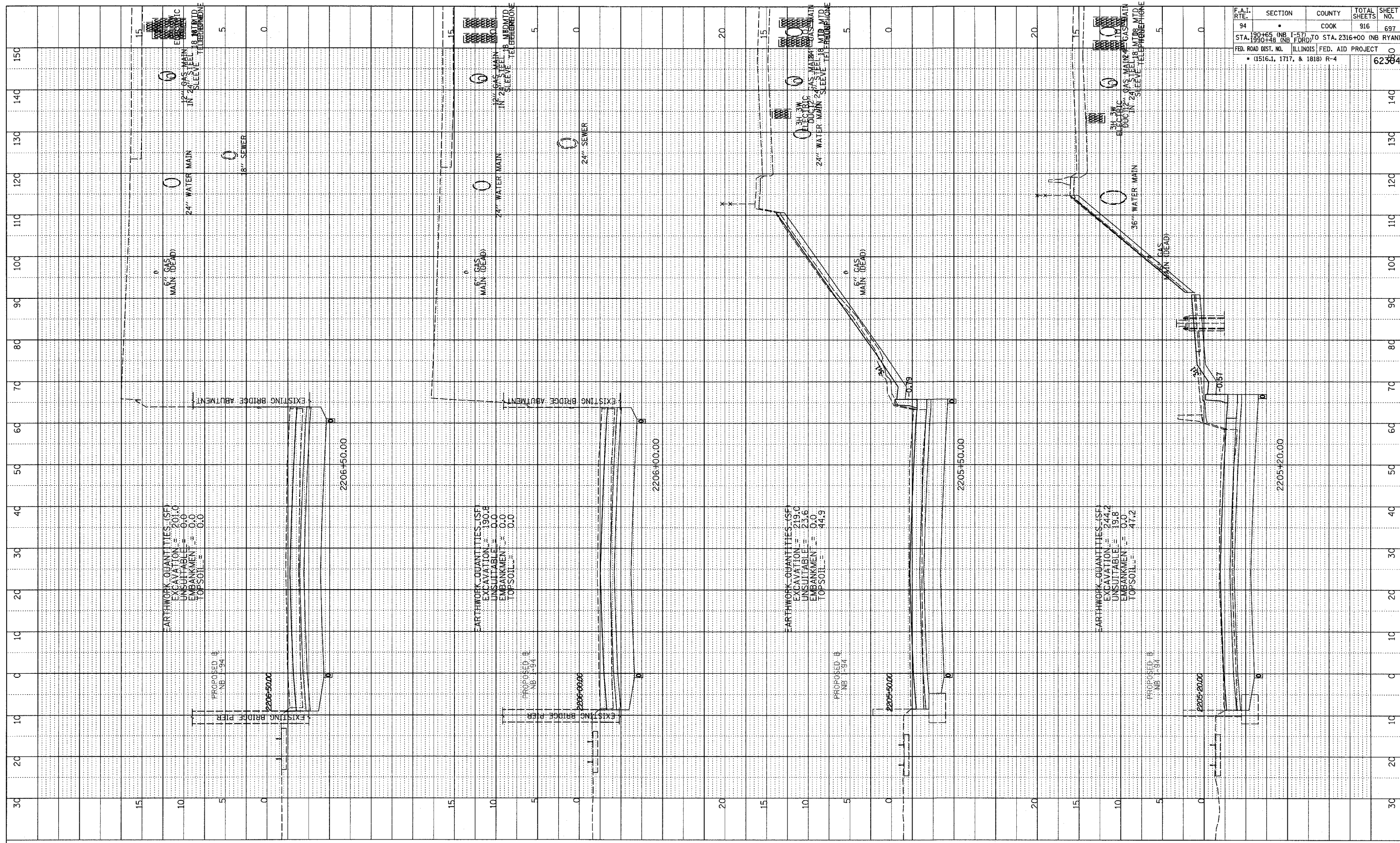

F.A.I. RTE.	SECTION	COUNTY	TOTAL SHEETS	SHEET NO.
94	190+65 (NB I-57) TO STA. 190+48 (NB FORD)	COOK	916	697
FED. ROAD DIST. NO. ILLINOIS FED. AID PROJECT				
• (1516.1, 1717, & 1818) R-4				
				62384

TYLIN INTERNATIONAL

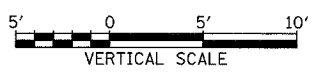

NORTHBOUND I-94 (DAN RYAN EXPWY)
 STA. 2205+20 TO STA. 2206+50

03/03/2006 04:00:50 PM P:\02373\road\2205\2206\220520to220650.dgn