

PROFILE SURVEYED  
 PLOTTED  
 GRADES CHECKED  
 NOTE BOOK  
 NO. STRUCTURE NOTATIONS OK'D

DATE

BY

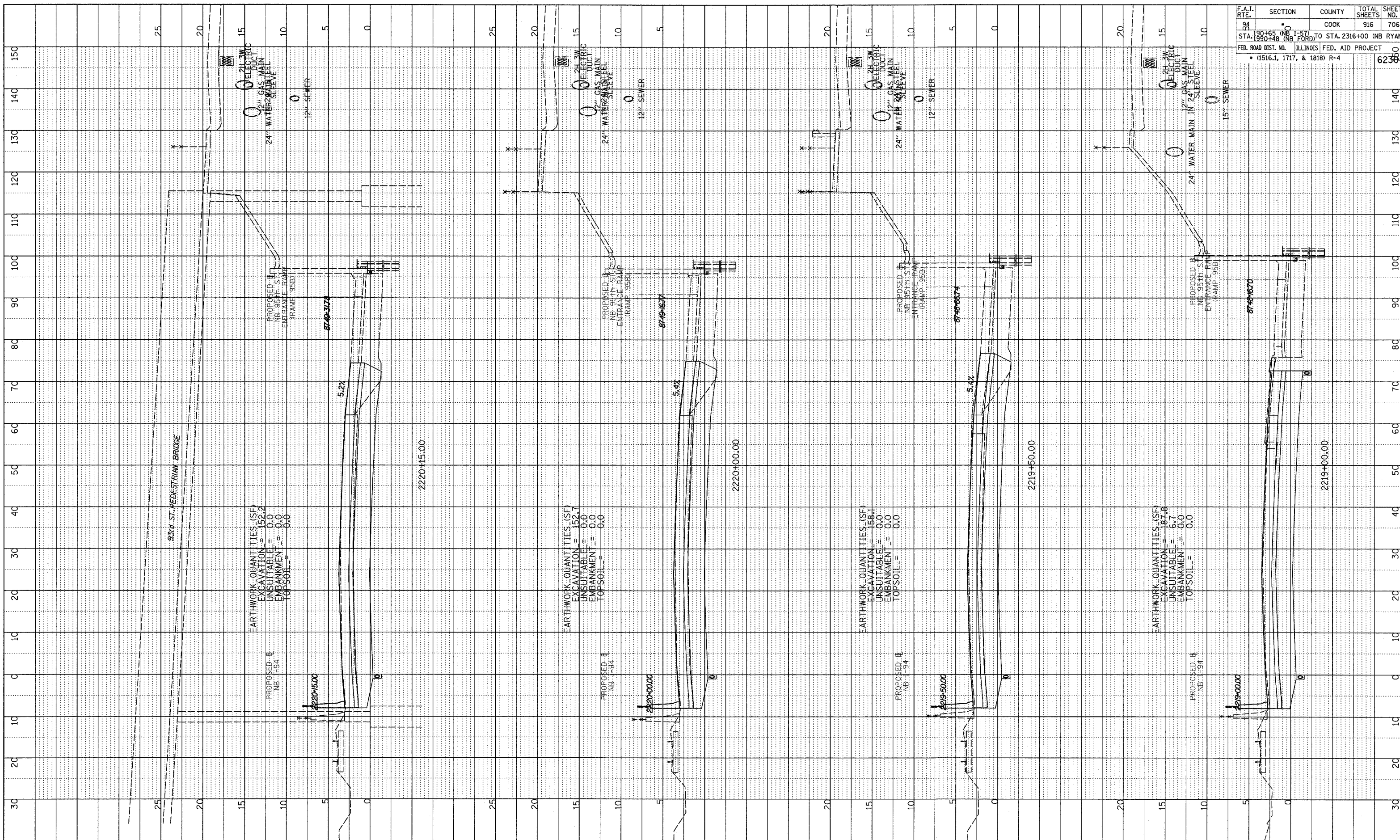

F.A.I. RTE.	SECTION	COUNTY	TOTAL SHEETS	SHEET NO.
94	190+65 (NB I-57) TO 190+48 (NB I-57)	COOK	916	706
FED. ROAD DIST. NO. ILLINOIS FED. AID PROJECT				
• (1516.1, 1717, & 1818) R-4				

TYLIN INTERNATIONAL

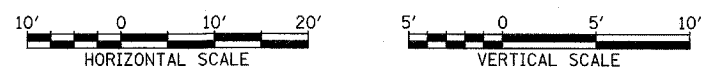

NORTHBOUND I-94 (DAN RYAN EXPWY)  
 STA. 2219+00 TO STA. 2220+15

03/03/2006 04:10:56 PM  
 I:\02\21\2006\20\98\20\858195.dgn