

PROFILE SURVEYED _____ DATE _____
 GRADES CHECKED _____
 NOTE BOOK _____
 STRUCTURE NOTATIONS CHWD _____

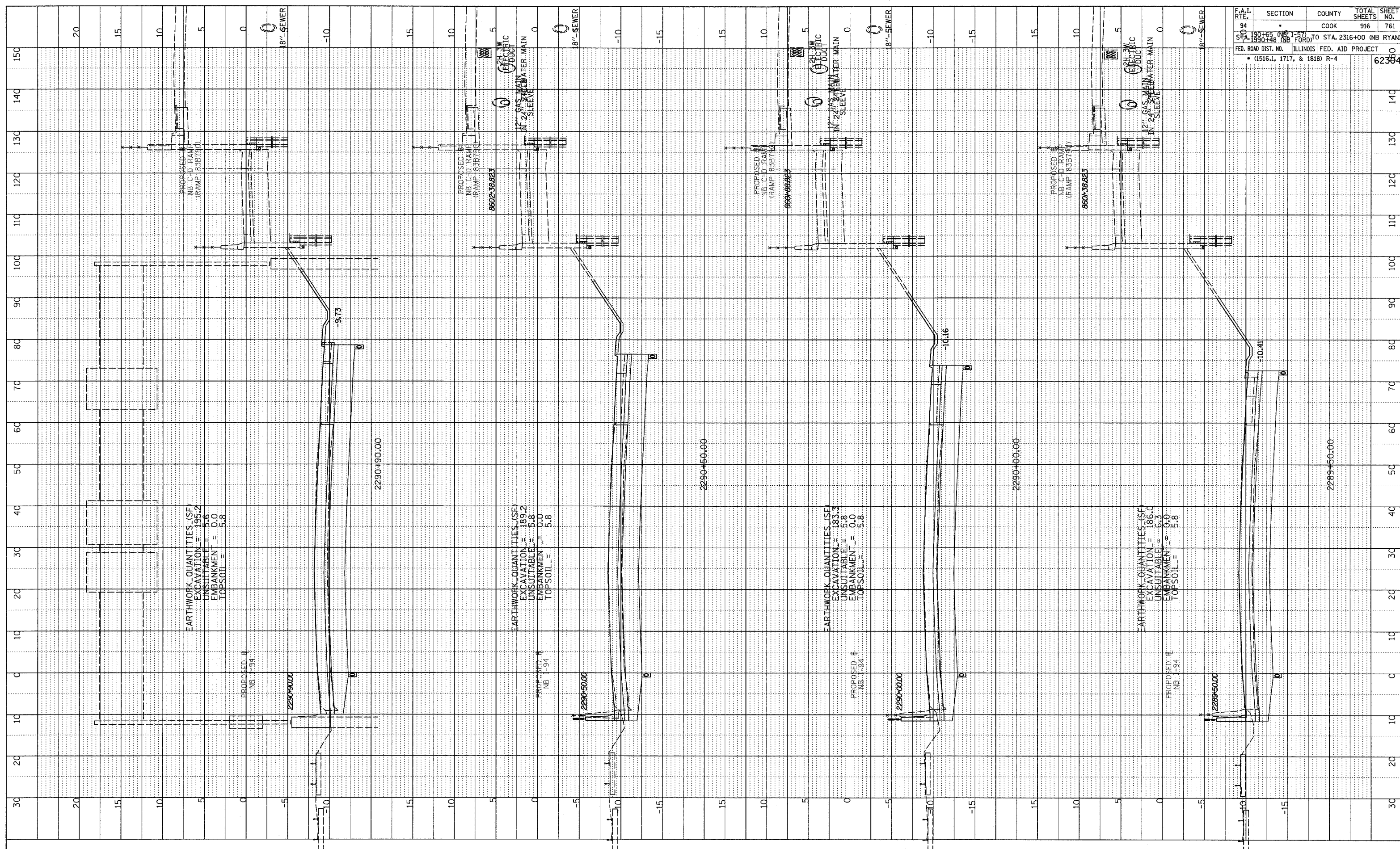

F.A.I. RT.F.	SECTION	COUNTY	TOTAL SHEETS	SHEET NO.
94		COOK	916	761
STA. 190+65 (NB I-57) TO STA. 2316+00 (NB RYAN)				
FED. ROAD DIST. NO. ILLINOIS FED. AID PROJECT				
• (1516.1, 1717, & 1818) R-4				

TYLIN INTERNATIONAL



NORTHBOUND I-94 (DAN RYAN EXPWY)
 STA. 2289+50 TO STA. 2290+90

03/03/2006 04:48:48 PM