

DATE	BY
REVISIONS	PLANNED
ALIGNED	CHECKED
PAID	FILE NAME
NO.	

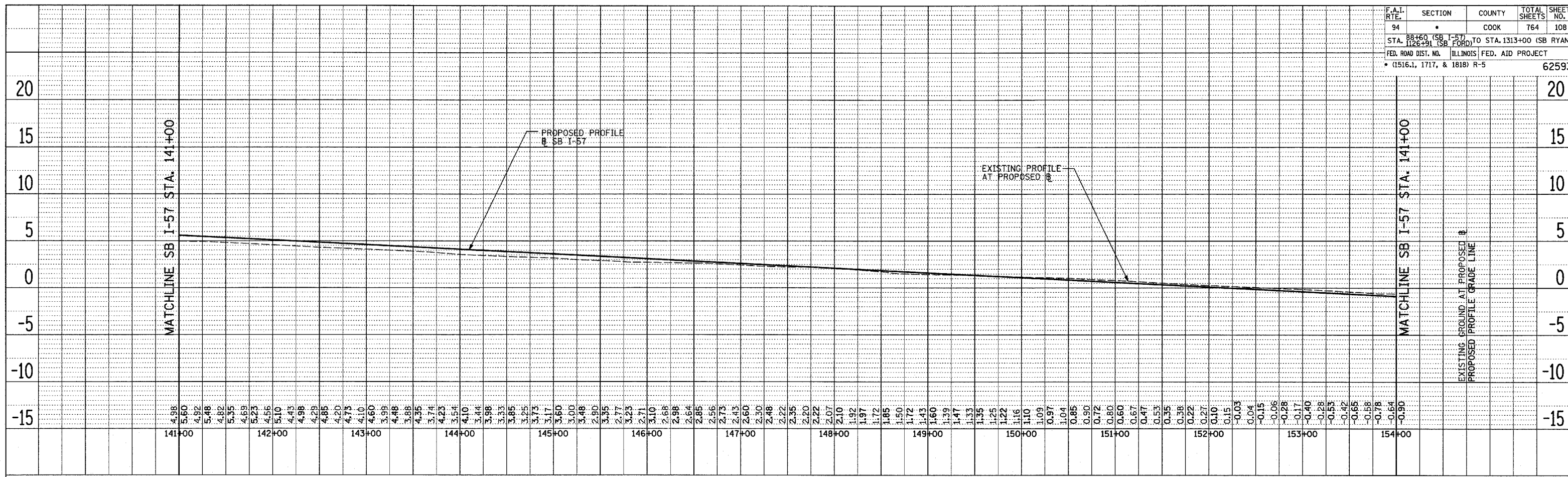

DATE	BY
REVISIONS	PLANNED
ALIGNED	CHECKED
PAID	FILE NAME
NO.	

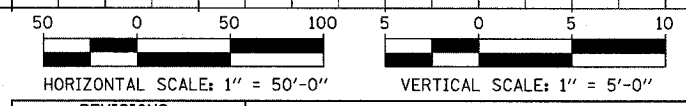
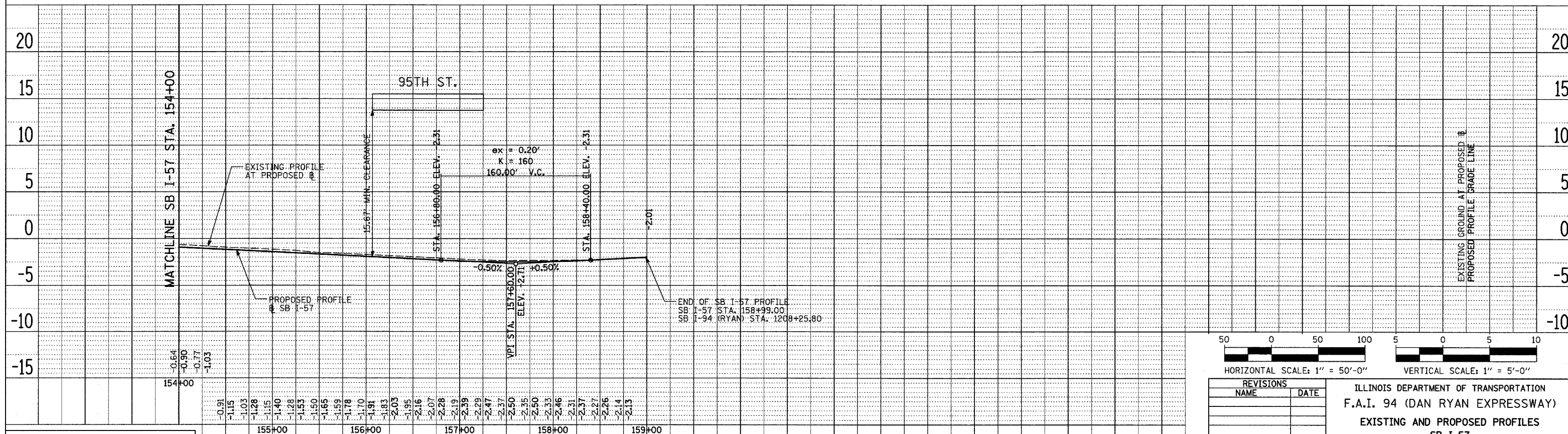

REVISIONS	
NAME	DATE

ILLINOIS DEPARTMENT OF TRANSPORTATION
 F.A.I. 94 (DAN RYAN EXPRESSWAY)
 EXISTING AND PROPOSED PROFILES
 SB I-57
 STA. 141+00 TO 158+99

SCALE: 1"=50' HORIZ.
 1"=5' VERT.
 DATE: MARCH 1, 2006

DRAWN BY: JPM
 CHECKED BY: MPG

TYLIN INTERNATIONAL

SB I-57