

LEGEND - WHITE BACKGROUND - GREEN 10" D LETTERS
 STA. 1277+00
 TEMPORARY INFORMATION SIGNING - 56 SF

SIGNING LEGEND:

- EXISTING GROUND MOUNTED SIGN
- EXISTING OVERHEAD TRUSS MOUNTED SIGN
- EXISTING OVERHEAD SIGN STRUCTURE-BRIDGE MOUNTED
- EXISTING OVERHEAD CANTILEVER MOUNTED SIGN
- PROPOSED GROUND MOUNTED SIGN
- PROPOSED OVERHEAD SIGN STRUCTURE - TRUSS
- CONSTRUCTION ZONE
- EXISTING SIGN
- EXISTING SIGN TO BE REMOVED
- PROPOSED SIGN

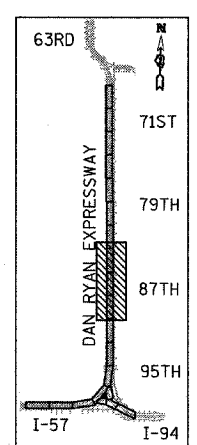

LOCATION MAP

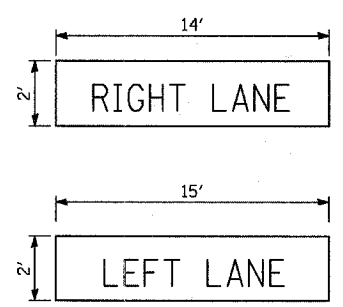

LEGEND - WHITE BACKGROUND - GREEN 10" E LETTERS
 STA. 1251+43
 TEMPORARY INFORMATION SIGNING - 28 SF

LEGEND - WHITE BACKGROUND - GREEN 10" E LETTERS
 STA. 1251+43
 TEMPORARY INFORMATION SIGNING - 30 SF

STA. 1277+00, 40.7' LT FOR STAGE 2 (SKID MOUNT IN CENTER OF GORE) SEE DETAILS ON SAME SHEET. REMOVE AT THE END OF STAGE 2.

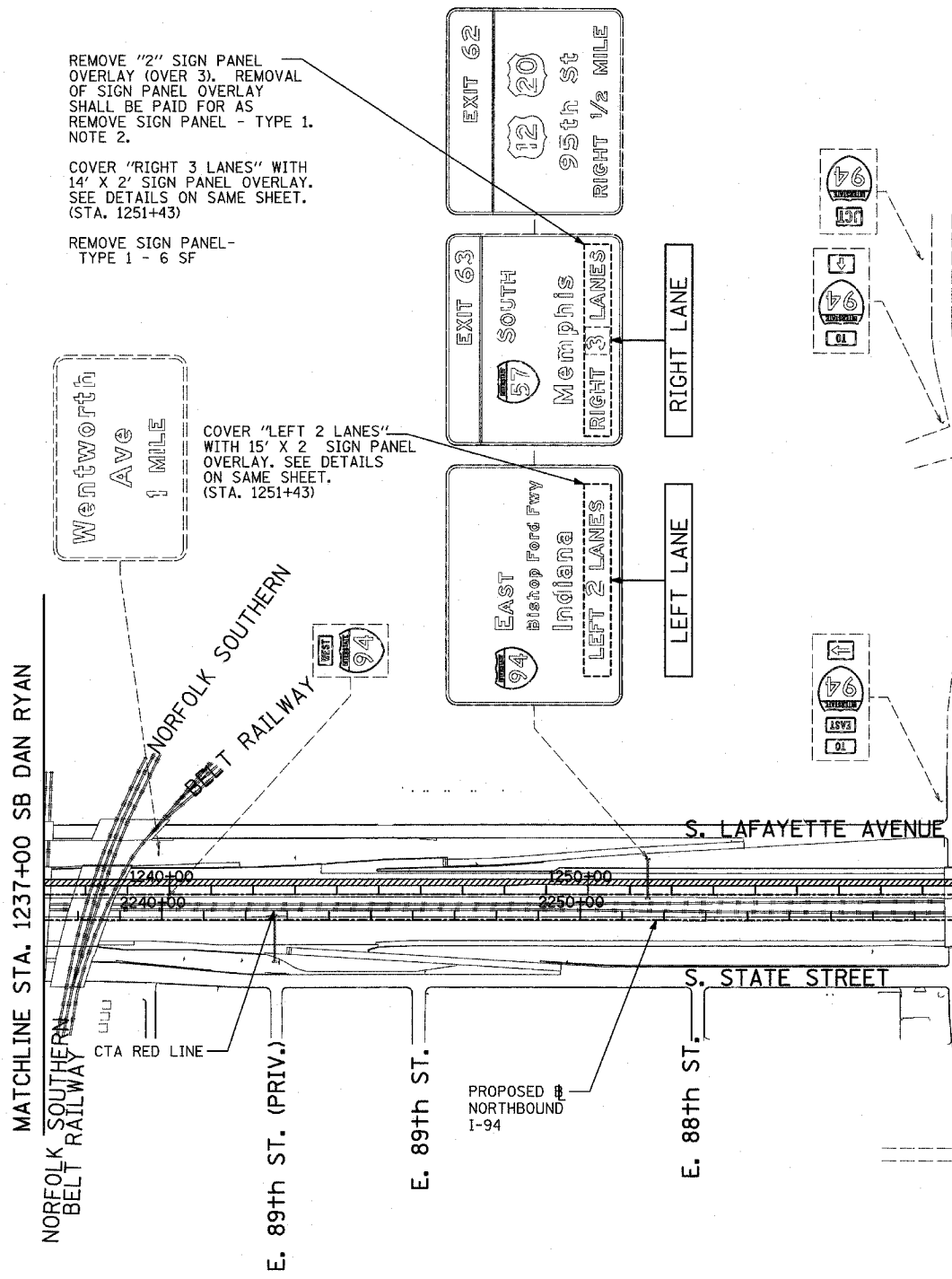

REMOVE "2" SIGN PANEL OVERLAY (OVER 3). REMOVAL OF SIGN PANEL OVERLAY SHALL BE PAID FOR AS REMOVE SIGN PANEL - TYPE 1. NOTE 2.

COVER "RIGHT 3 LANES" WITH 14' X 2' SIGN PANEL OVERLAY. SEE DETAILS ON SAME SHEET. (STA. 1251+43)

REMOVE SIGN PANEL - TYPE 1 - 6 SF

COVER "LEFT 2 LANES" WITH 15' X 2' SIGN PANEL OVERLAY. SEE DETAILS ON SAME SHEET. (STA. 1251+43)

- NOTES:**
1. PROPOSED DETOUR TRAILBLAZER TO BE REMOVED AFTER APPROPRIATE ENTRANCE RAMP HAS BEEN OPENED. COST SHALL BE INCLUDED IN TEMPORARY INFORMATION SIGNING. SEE SHEET 1 OF STAGE 1 CONSTRUCTION SIGNING PLANS FOR TRAILBLAZER SIZE.
 2. REMOVED SIGN PANEL SHALL BECOME THE PROPERTY OF CONTRACTOR AND BE DISPOSED OFFSITE.
 3. RELOCATION OF SIGNS SHALL BE INCLUDED IN THE COST OF TEMPORARY INFORMATION SIGNING.

TYLIN INTERNATIONAL

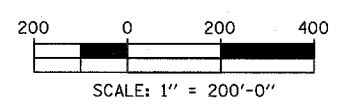

| REVISIONS | |
|-----------|------|
| NAME | DATE |
| | |
| | |
| | |
| | |
| | |
| | |
| | |

ILLINOIS DEPARTMENT OF TRANSPORTATION
 F.A.I. 94 (DAN RYAN EXPRESSWAY)
CONSTRUCTION SIGNING-STAGE 2
 STA. 1237+00 TO STA 1287+00
 SHEET 3 OF 4

SCALE: 1" = 200'
 DATE: MARCH 1, 2006
 DRAWN BY: AMB
 CHECKED BY: TGB