

F.A.I. RTE.	SECTION	COUNTY	TOTAL SHEETS	SHEET NO.
94		COOK	764	248
88+60 (SB I-57) TO STA. 1313+00 (SB RYAN)				
STA. 1126+91 (SB FORD)				
FED. ROAD DIST. NO. ILLINOIS FED. AID PROJECT				
• (1516.1, 1717, & 1818) R-5 62593				

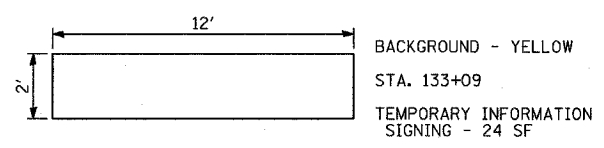

SIGNING LEGEND:

- EXISTING GROUND MOUNTED SIGN
- EXISTING OVERHEAD TRUSS MOUNTED SIGN
- EXISTING OVERHEAD SIGN STRUCTURE-BRIDGE MOUNTED
- EXISTING OVERHEAD CANTILEVER MOUNTED SIGN
- PROPOSED GROUND MOUNTED SIGN
- PROPOSED OVERHEAD SIGN STRUCTURE - TRUSS
- CONSTRUCTION ZONE
- EXISTING SIGN
- EXISTING SIGN TO BE REMOVED
- PROPOSED SIGN



COVER "EXIT (ARROW) ONLY" WITH WITH 12" X 2" BLANK SIGN PANEL OVERLAY.
SEE DETAILS ON SAME SHEET. (STA 133+09).

SIGNS TO BE INSTALLED. SEE PROPOSED SIGNING SCHEDULE AND PROPOSED SIGNING PLANS.

SIGN PANEL AND WOOD SIGN SUPPORTS SHALL BE REMOVED WHEN PROPOSED SIGN STRUCTURE AT STA. 133+09 IS INSTALLED.
REMOVAL OF SIGN PANEL AND SUPPORTS SHALL BE INCLUDED IN THE COST OF TEMPORARY INFORMATION SIGNING.

BLANK SIGN PANEL OVERLAYS TO REMAIN.

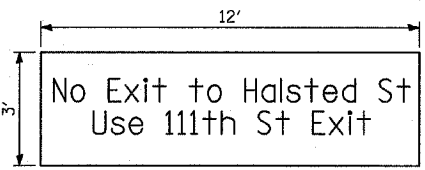
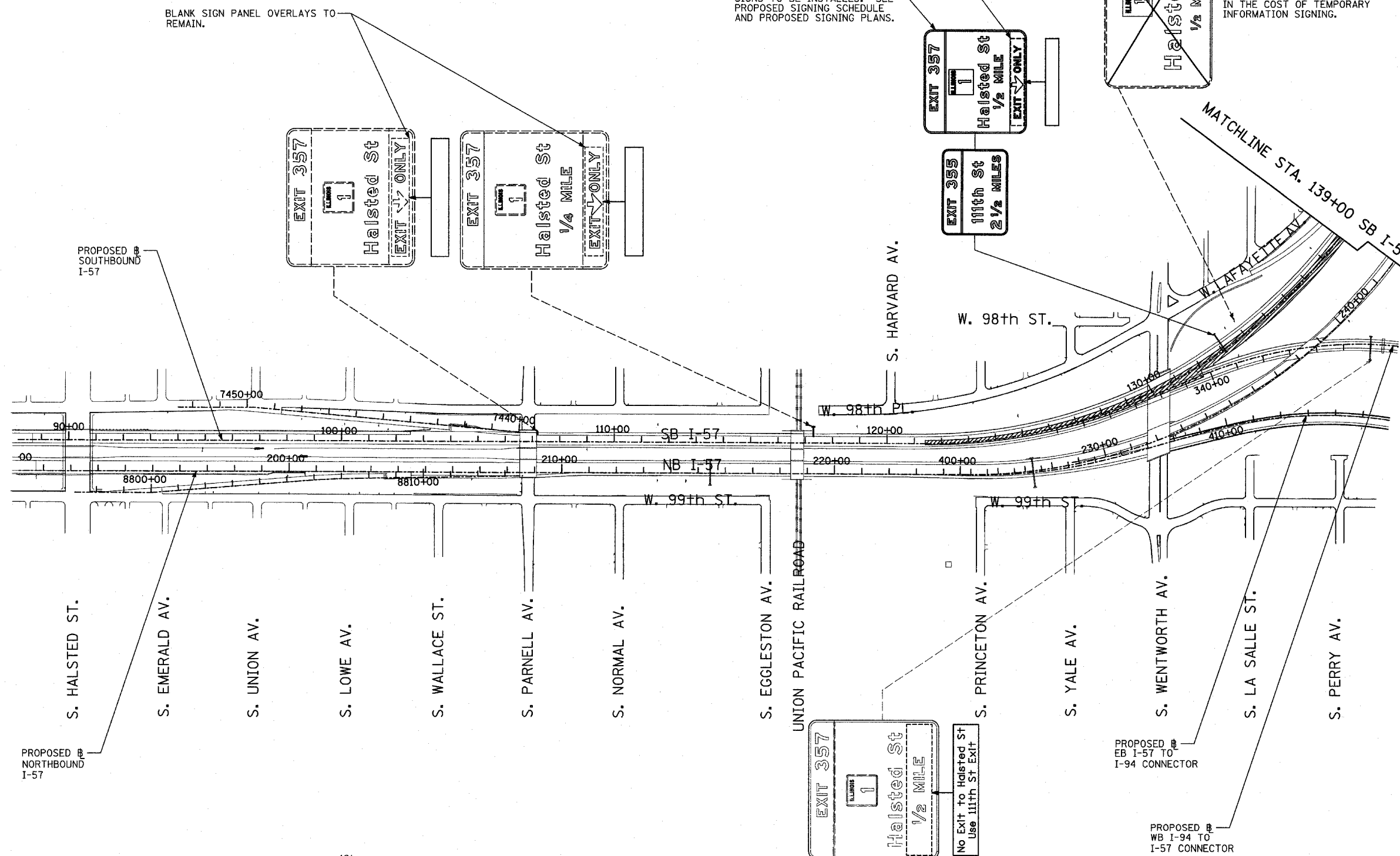

LEGEND - BLACK BACKGROUND - ORANGE 10" E LETTERS
STA. 334+00
TEMPORARY INFORMATION SIGNING - 36 SF

COVER 1/2 MILE WITH 12'X3' SIGN PANEL OVERLAY. REMOVE AT END OF STAGE 3A. SEE DETAILS ON SAME SHEET. (STA. 334+00)

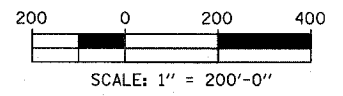

REVISIONS	
NAME	DATE

ILLINOIS DEPARTMENT OF TRANSPORTATION
F.A.I. 94 (DAN RYAN EXPRESSWAY)
CONSTRUCTION SIGNING-STAGE 3A
SB I-57 STA. 100+00 TO STA 139+00
SHEET 1 OF 2

SCALE: 1" = 200'
DATE: MARCH 1, 2006
DRAWN BY: AMB
CHECKED BY: TGB

