

DATE	REVISED	BY
	PLotted	
	Checked	
	Drawn	
	Structure	
	Notations	
	Checked	
	Drawn	
	Structure	
	Notations	

F.A.I. RTE.	SECTION	COUNTY	TOTAL SHEETS	SHEET NO.
94	88+60 (SB I-57) TO STA. 1313+00 (SB RYAN)	COOK	764	552
	126+91 (SB FORD)			
	FED. ROAD DIST. NO. ILLINOIS	FED. AID PROJECT		
	(1516.1, 1717, & 1818) R-5			62593

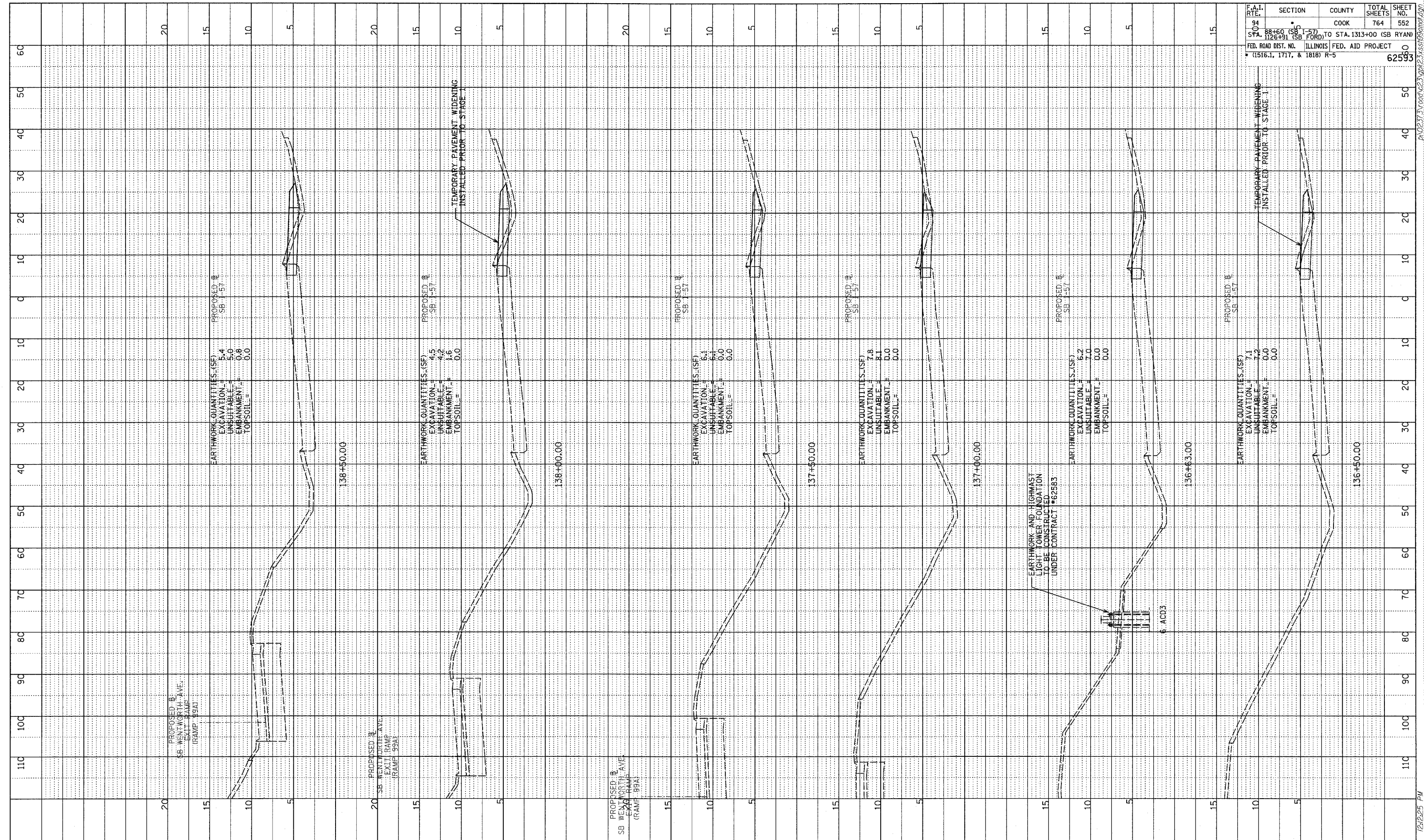

TYLIN INTERNATIONAL

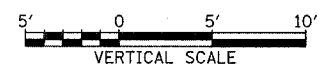
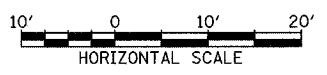

PRE STAGE 1 TEMP PAVEMENT FOR MOT I-57 SOUTHBOUND STA.136+50 TO STA. 138+50

02/27/2006 12:25 PM