

PROFILE DATE
 NOTE BOOK GRADES CHECKED
 NO. DATE BY
 EARTHWORK QUANTITIES CHECKED
 EARTHWORK QUANTITIES CHECKED

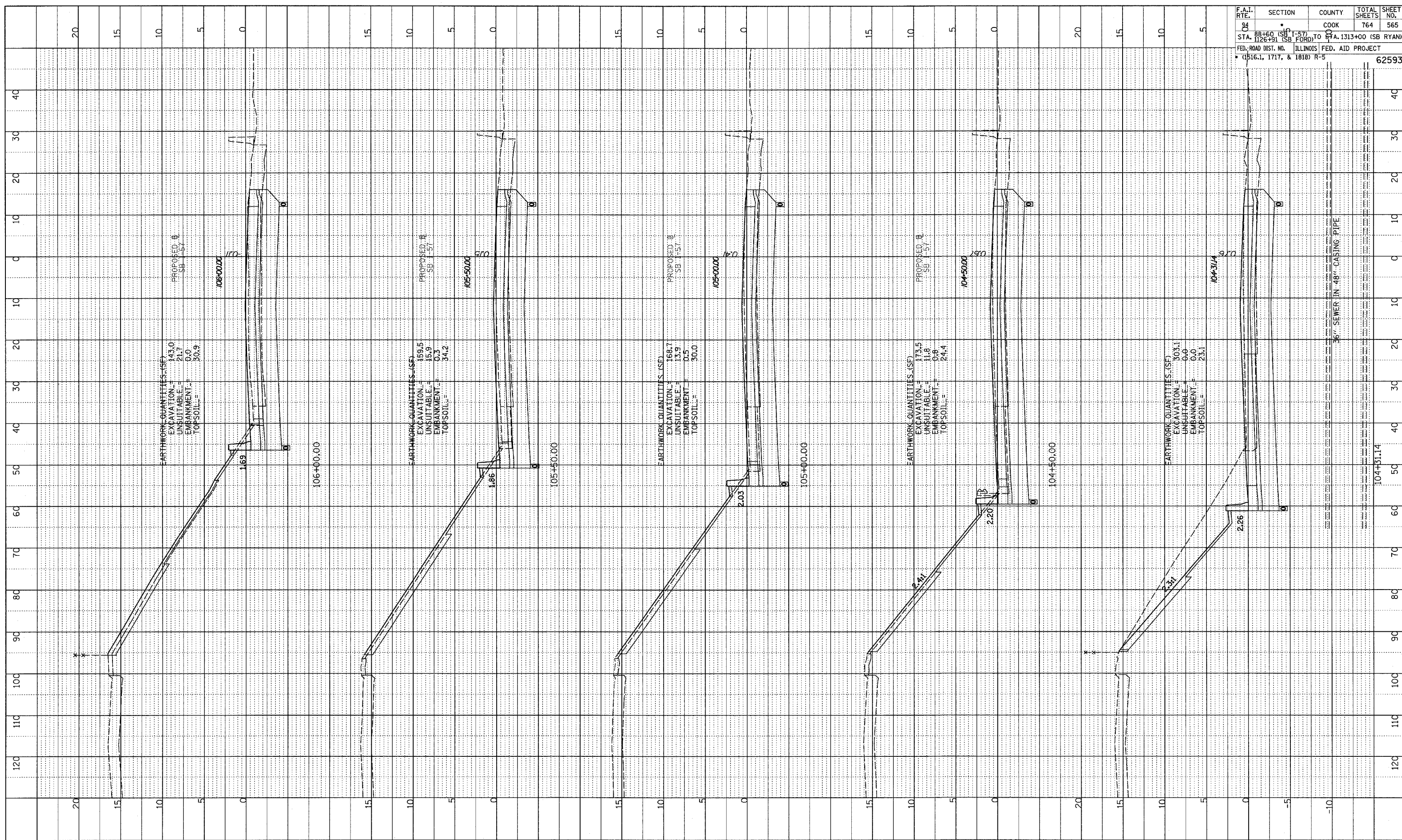

F.A.I. RTE.	SECTION	COUNTY	TOTAL SHEETS	SHEET NO.
84	1	COOK	764	565
STA. 1026+51 (SB FORD) TO STA. 1313+00 (SB RYAN)		ILLINOIS FED. AID PROJECT		
FED. ROAD DIST. NO. (1516.1, 1717, & 1818) R-5		62593		

TYLIN INTERNATIONAL

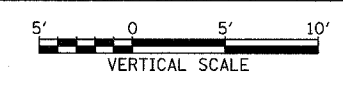
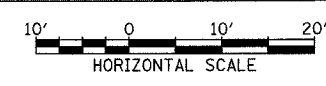

I-57 SOUTHBOUND
 STA. 104+31.14 TO STA. 106+00

02/27/2006 12:23:33 PM
 A:\0237\Roadwork\3\94\23\565\H\565.dwg