

SURVEYED  
 GRADES CHECKED  
 E.M. NOTED  
 STRUCTURE NOTATIONS C/P/D

F.A.I. RTE.	SECTION	COUNTY	TOTAL SHEETS	SHEET NO.
94	88+60 (SB I-57) STA. 1126+91 (SB FORD) TO STA. 1313+00 (SB RYAN)	COOK	764	586
FED. ROAD DIST. NO.		ILLINOIS FED. AID PROJECT		625930
(1516.1, 1717, & 1818) R-5				

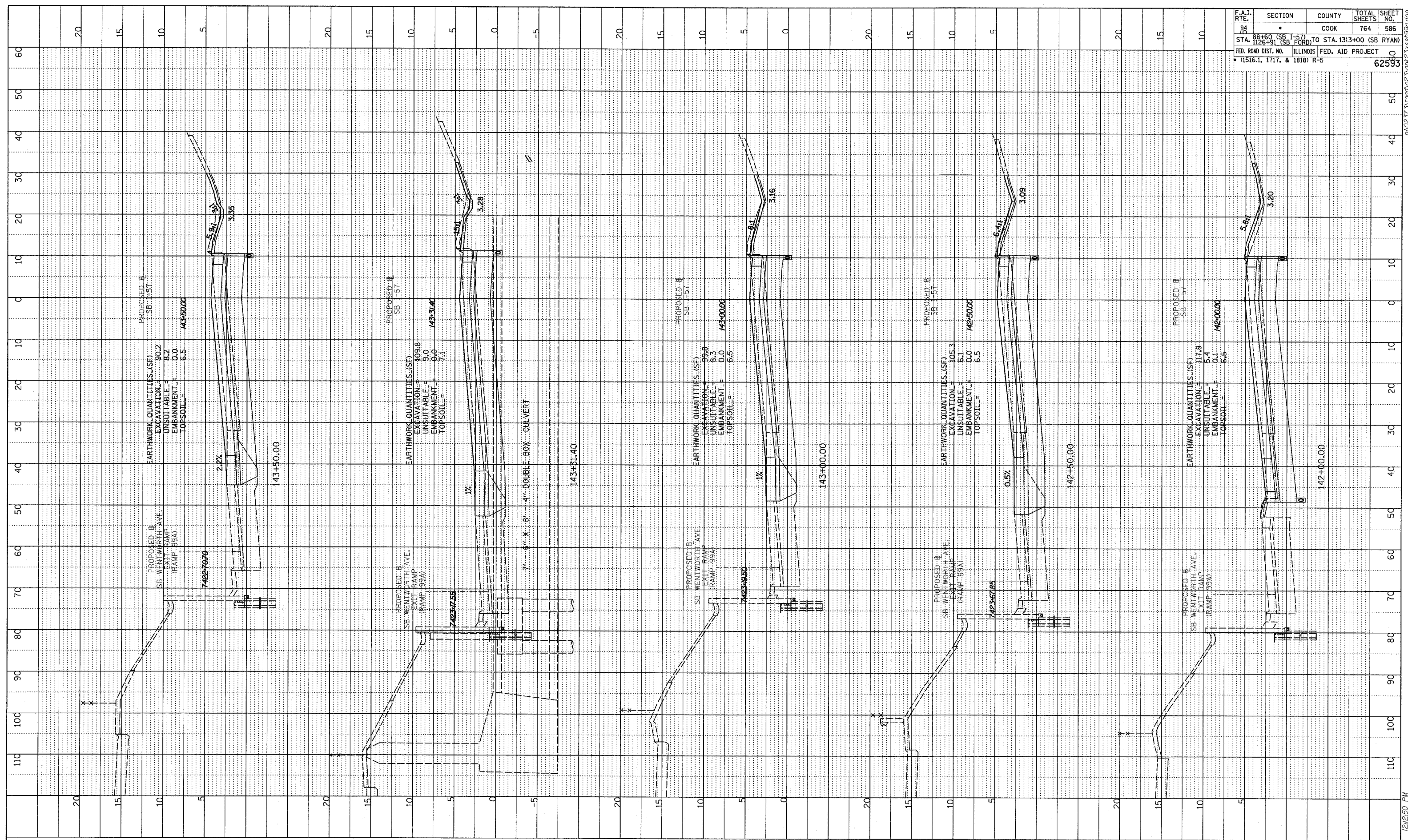

TYLIN INTERNATIONAL

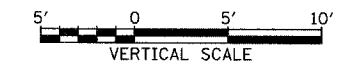

I-57 SOUTHBOUND  
 STA. 142+00 TO STA. 143+50

02/27/2006 12:12:50 PM