

DRAWING NO. _____
 PROJECT NO. _____
 SHEET NO. _____
 DATE _____
 BY _____
 CHECKED BY _____
 TITLE _____

F.A.I. RTE.	SECTION	COUNTY	TOTAL SHEETS	SHEET NO.
94	10	COOK	764	605
STA. 88+60 (SB I-94) TO STA. 1313+00 (SB RYAN) S.P.A. 1126+91 (SB I-94)				
FED. ROAD DIST. NO. ILLINOIS FED. AID PROJECT (1516.1, 1717, & 1818) R-5				
				62593

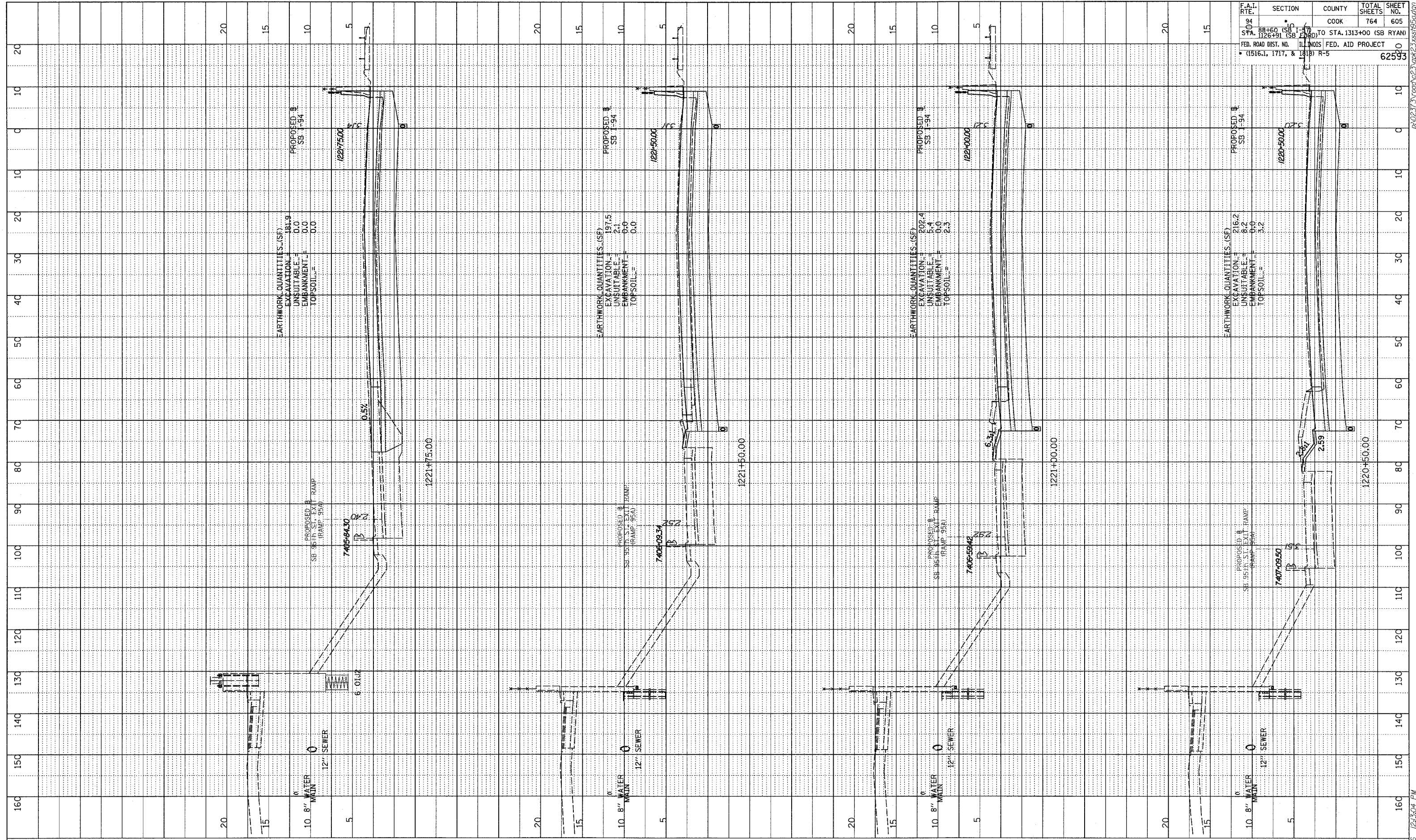

TYLIN INTERNATIONAL

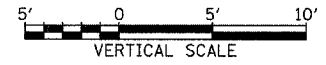
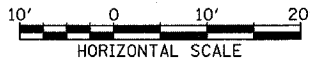

I-94 SOUTHBOUND (DAN RYAN EXPWY)
 STA. 1220+50 TO STA. 1221+75

02/27/2006 12:304 PM